

PLANTING NOTES

- THE DETAILS ON THIS SHEET DO NOT REPRESENT ANY PARTICULAR SPECIES.
- TREES AND SHRUBS AS INDICATED IN THE DETAILS REPRESENT BOTH CONIFEROUS AND DECIDUOUS SPECIES.
- MATERIAL PLANTED IN GROUP SHALL BE SET IN CONTINUOUS PLANTING BEDS.
- CENTRE LINE OF SHRUBS SHALL NOT BE CLOSER THAN 2.4m FROM BUILDING FACE TO PROTECT BUILDING FOOTINGS AND INSULATION.
- PRUNING - TO SUIT SPECIES - PRUNE BRANCHES BY 1/3 TO REMOVE DAMAGED OR OBJECTIONABLE BRANCHES FOLLOWING PROPER HORTICULTURAL PRACTICE. DO NOT PRUNE LEADERS.
- FIRMLY COMPACT BACKFILLED PLANTING MIXTURE TO ELIMINATE AIR POCKETS OR PREVENT SETTLEMENT.
- PLANTING MATERIAL QUALITY STANDARDS:
 - ALL PLANT MATERIALS TO CONFORM TO THE CANADIAN NURSERY LANDSCAPE ASSOCIATION FOR VARIETY, SIZE AND CONDITION;
 - PLANT MATERIAL COLLECTED FROM WILD SOURCES WILL NOT BE ACCEPTED; LANDSCAPE ARCHITECT RESERVES THE RIGHT TO REFUSE ACCEPTANCE OF ANY PLANT DISPLAYING POOR GROWTH HABITS, INJURY OR DISEASE;
 - ANY PLANTS THAT DO NOT CONFORM TO THE ABOVE STANDARDS WILL BE PROMPTLY REMOVED FROM THE SITE BY THE CONTRACTOR AND REPLACED WITH MATERIAL OF ACCEPTABLE QUALITY AT NO ADDITIONAL COST TO THE PROJECT.

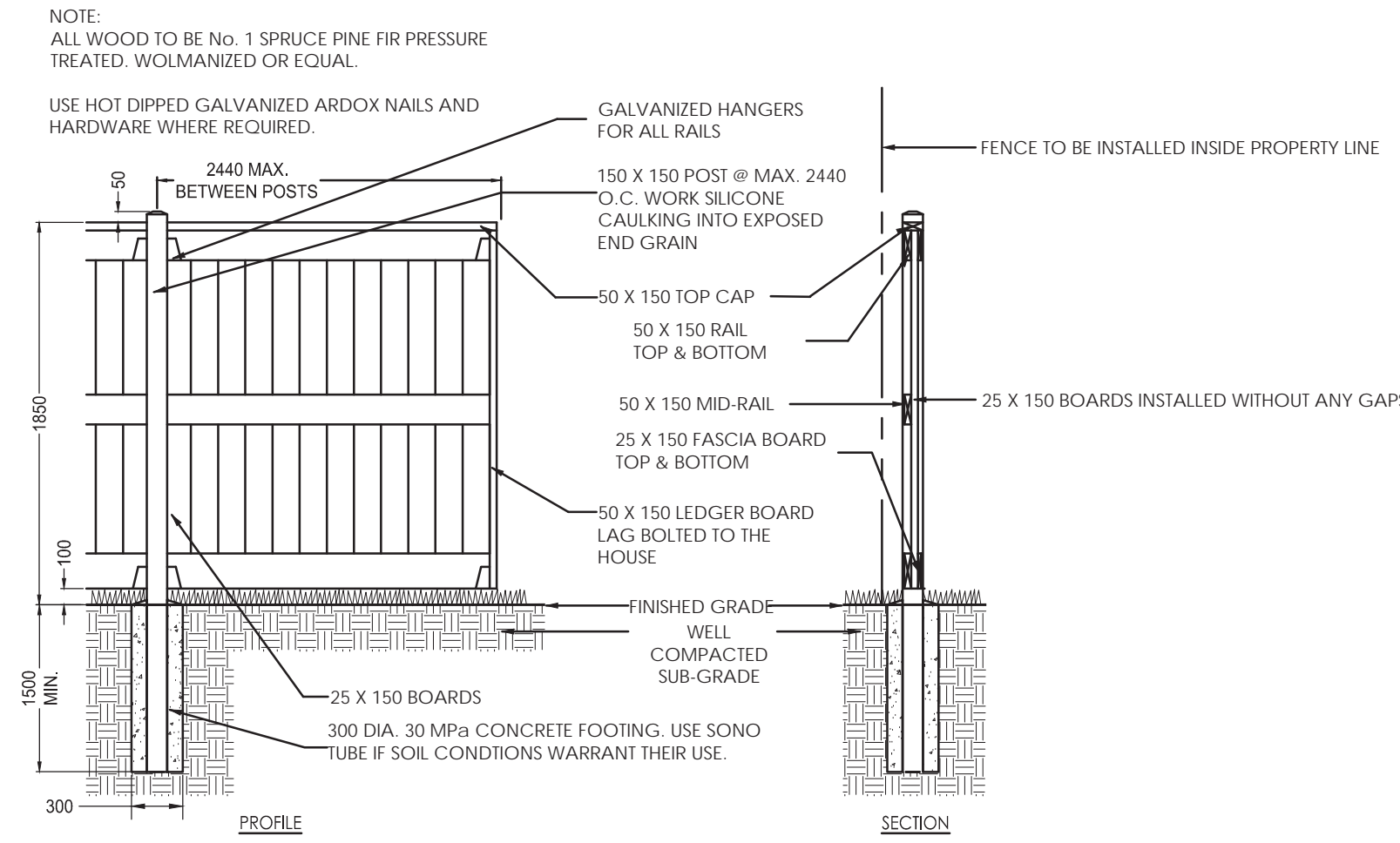
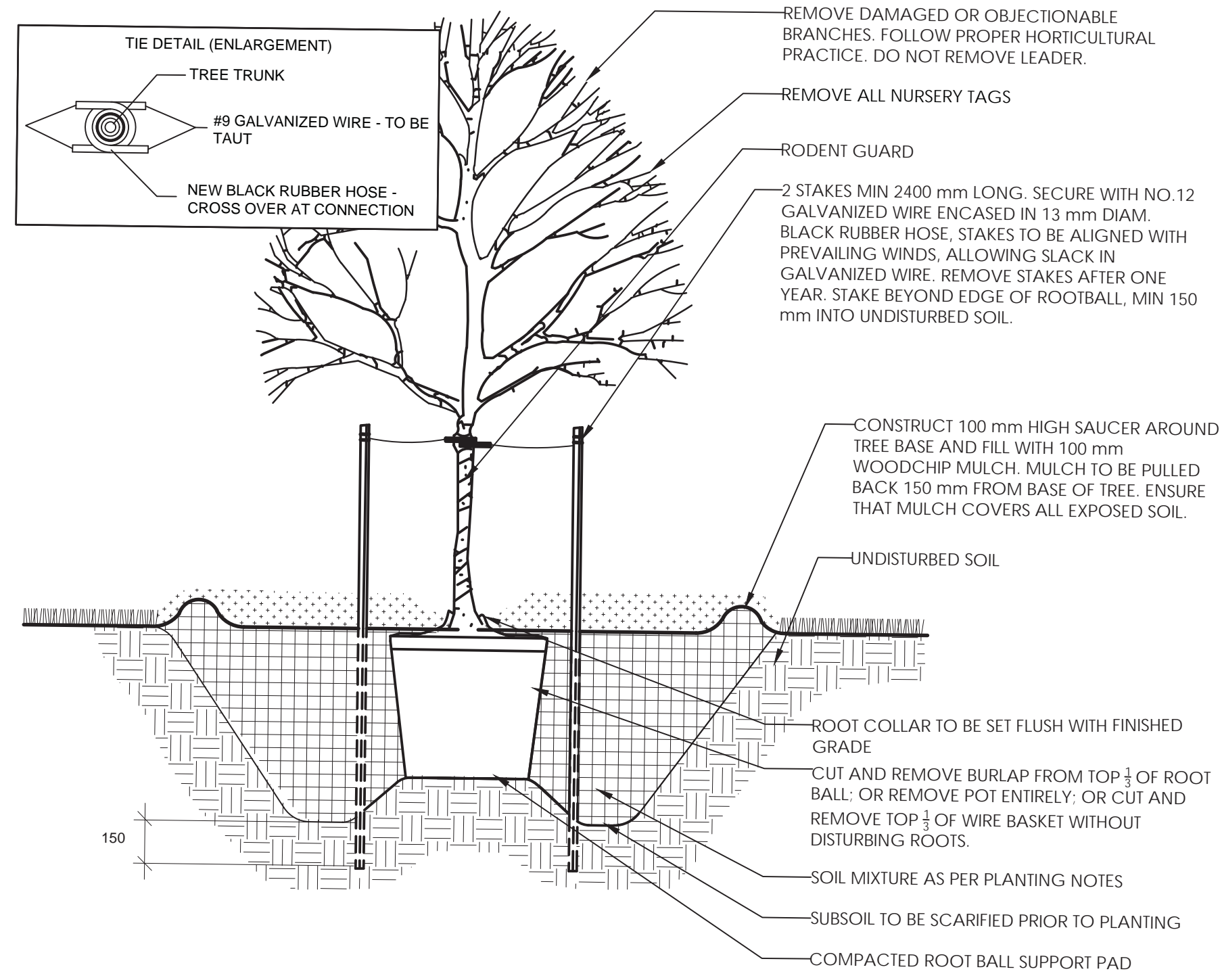

4 BOARD ON BOARD WOODEN FENCE N.T.S.

1 DECIDUOUS TREE PLANTING N.T.S.

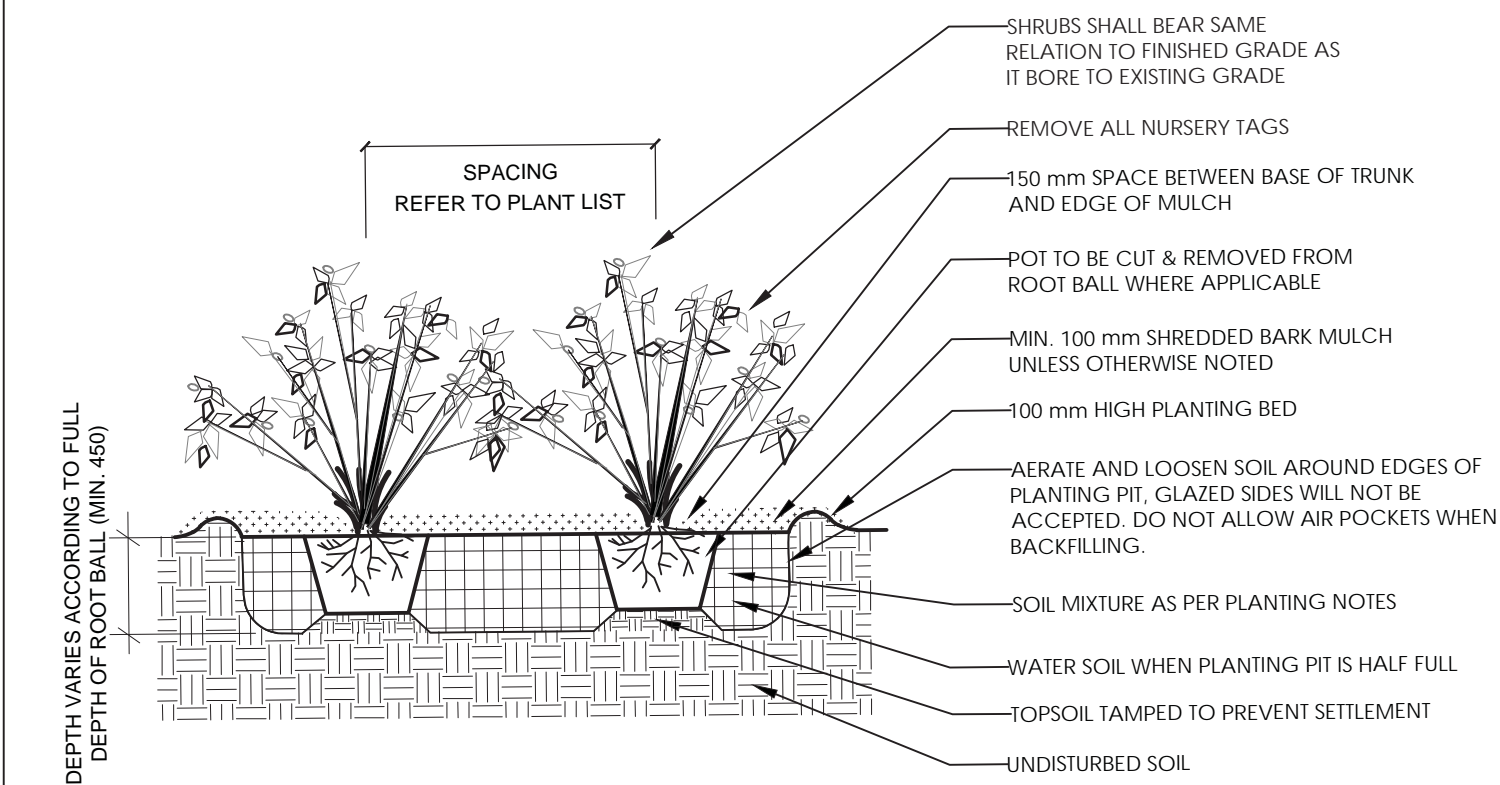

2 SHRUB PLANTING N.T.S.

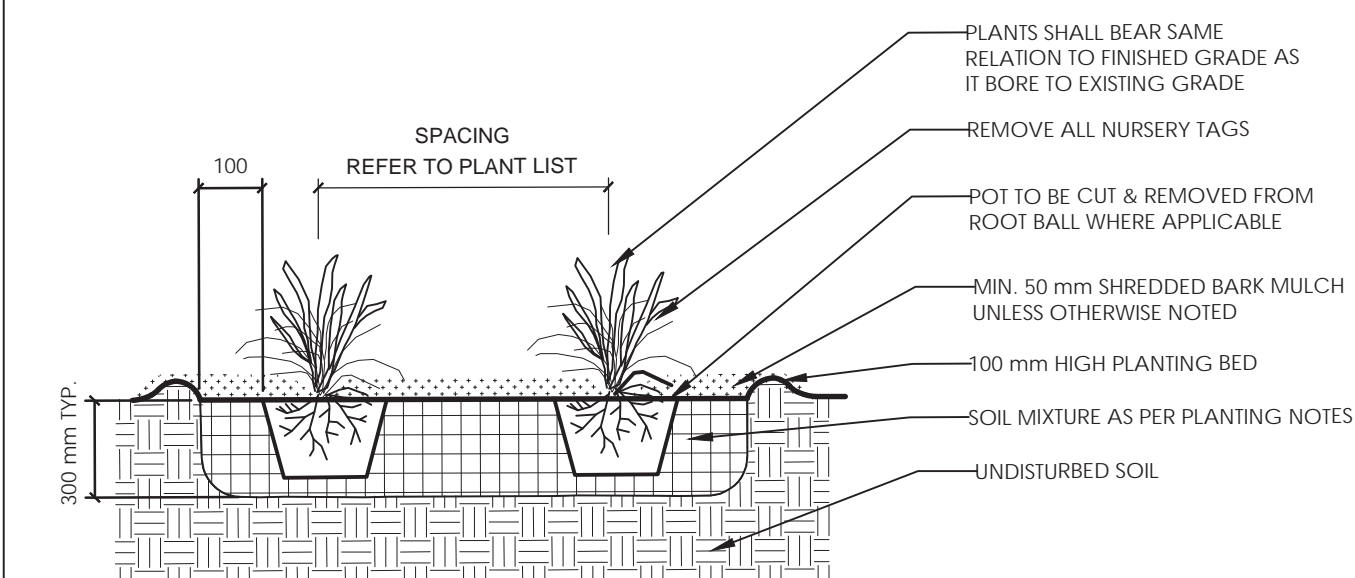

3 PERENNIAL PLANTING N.T.S.

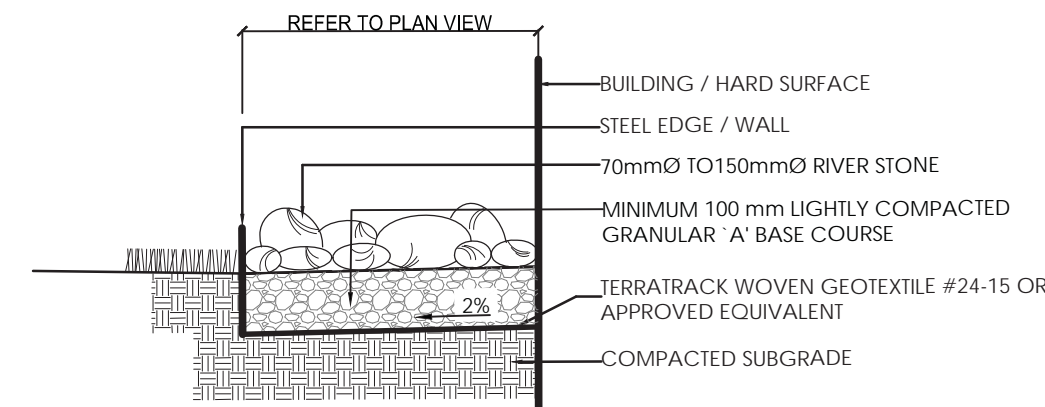

5 RIVERWASHED STONES N.T.S.

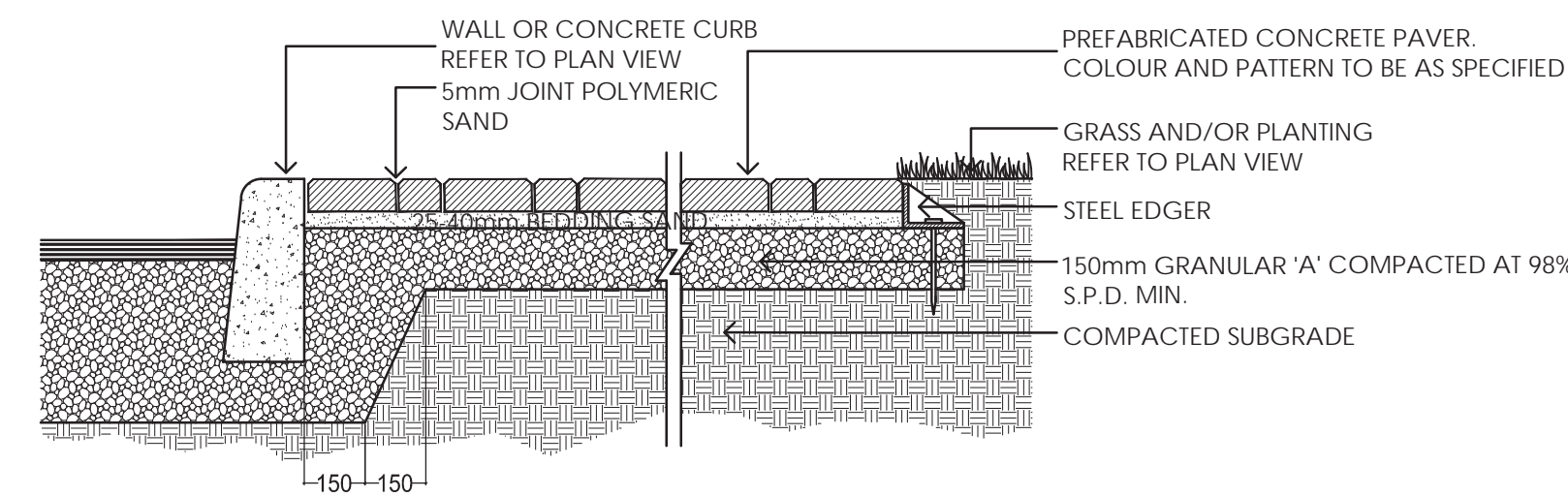

6 PAVERS N.T.S.

Notes

- TOPOGRAPHIC SURVEY AND BENCHMARK COMPLETED BY STANTEC GEOMATICS LTD. DATED AUGUST 16, 2018
- SITE PLAN PREPARED BY RUBIN & ROTMAN ARCHITECTS DATED OCTOBER 2018

Revision	By	Appd.	YYYY.MM.DD	
1	ISSUED FOR SITE PLAN APPROVAL	LZ	ILL	2018.11.07

File Name: 160401443_LB LZ ILL ILL 2018.10.04
Dwn. Dign. Chkd. YYYY.MM.DD

Permit-Seal



Client/Project
ROBINSON VILLAGE III
LIMITED PARTNERSHIP
3 STOREY APARTMENT
134 ROBINSON AVENUE
OTTAWA, ONTARIO

Title
LANDSCAPE DETAILS

Project No.	Scale	
160401443	VARIES	
Drawing No.	Sheet	Revision
L300	1 of 1	1