

- EXISTING DECIDUOUS TREE TO REMAIN
- EXISTING CONIFEROUS TREE TO REMAIN
- PROPOSED DECIDUOUS TREE
- PROPOSED DECIDUOUS SHRUBS
- PROPOSED CONIFEROUS SHRUBS
- PROPOSED PERENNIALS AND ORNAMENTAL GRASSES
- PLANT SPECIES/QUANTITY KEY
- PROPOSED PLANTING BED
- PROPOSED RIVER STONES REFER TO DETAIL 5/L300
- PROPOSED PAVERS REFER TO DETAIL 6/L300
- T/SOD PROPOSED TOPSOIL AND SOD
- PROPOSED FENCE
- PROPERTY LINE

Notes

TOPOGRAPHIC SURVEY AND BENCHMARK COMPLETED BY STANTEC GEOMATICS LTD. DATED JULY 10, 2009  
1. SITE PLAN PREPARED BY RUBIN & ROTMAN ARCHITECTS DATED JULY 2018

Revision	By	Appd.	Date
1	MS	ILL	2018.11.19
ISSUED FOR SITE PLAN APPROVAL			

Permit Seal



Client/Project

ROBINSON VILLAGE I  
LIMITED PARTNERSHIP  
3 STOREY APARTMENT  
19 ROBINSON AVENUE  
OTTAWA, ONTARIO

Title

LANDSCAPE PLAN

Project No. 160401438	Scale 1:100	Sheet 1	Revision
--------------------------	----------------	------------	----------

PLANT LIST

QTY	KEY	BOTANICAL NAME	COMMON NAME	SIZE	REMARKS
<b>DECIDUOUS TREES - REFER TO DETAIL 1/ L300</b>					
1	AC	<i>Amelanchier canadensis 'Glenform'</i>	Rainbow Pillar Serviceberry	Clump: 1500mm (H) Potted	
2	SR	<i>Syringa reticulata 'Ivory Silk'</i>	Ivory Silk Lilac	60 mm (cal.)	W.B.
<b>DECIDUOUS SHRUBS - REFER TO DETAIL 2/ L300</b>					
23	SJ	<i>Spiraea japonica 'Anthony Waterer'</i>	Anthony Waterer Spiraea	3 Gallon	C.G. Plant at 750 mm o/c
<b>CONIFEROUS SHRUBS - REFER TO DETAIL 2/ L300</b>					
9	PM	<i>Pinus mugo 'Slowmound'</i>	Slowmound Mugo Pine	3 Gallon	Potted Plant at 1200 mm o/c
<b>PERENNIALS / ORNAMENTAL GRASSES - REFER TO DETAIL 3/ L300</b>					
19	DC	<i>Deschampsia cespitosa 'Northern Lights'</i>	Northern Lights Tufted Hairgrass	1 Gallon	Potted Plant at 600 mm o/c
32	RF	<i>Rudbeckia fulgida 'Gold Strum'</i>	Gold Strum Coneflower	1 Gallon	Potted Plant at 500 mm o/c
62	VM	<i>Vinca minor</i>	Periwinkle	Plugs	Plant at 500 mm o/c

GENERAL LANDSCAPE PLAN NOTES

- REFER TO TREE PRESERVATION PLAN FOR INFORMATION RELATED TO TREE REMOVAL / TREE PROTECTION DIRECTIONS. UNLESS OTHERWISE NOTED, EXISTING VEGETATED AREAS ON ADJACENT PROPERTIES SHALL REMAIN AND BE PROTECTED BEFORE, DURING, AND AFTER CONSTRUCTION.
- SOD SHALL BE KENTUCKY BLUEGRASS SOD INSTALLED OVER 135mm OF TOPSOIL. SOD SHALL BE INSTALLED THROUGHOUT WITHIN LIMIT OF WORK AND IN ALL DISTURBED AREAS OUTSIDE THE LIMIT OF WORK. SOD SHALL BE INSTALLED AS PER OPSS 803.
- CONTRACTOR TO LOCATE AND STAKE ALL UTILITIES PRIOR TO ANY WORK ON THE SITE. DO NOT PLANT DIRECTLY ABOVE UNDERGROUND UTILITIES. REPORT ANY DISCREPANCIES TO THE LANDSCAPE ARCHITECT FOR DIRECTION.
- MAINTAIN A MINIMUM DISTANCE OF 2.0m FROM ALL UNDERGROUND UTILITIES.
- NO TREES SHALL BE PLANTED UNDER OVERHEAD WIRES.
- THE LANDSCAPE ARCHITECT MAY ADJUST THE LOCATION OF PLANTING PRIOR TO PLANTING TO MINIMIZE CONFLICTS WITH UTILITIES, DRIVEWAYS AND INTERSECTION VISIBILITY.
- CONTRACTOR SHALL SUPPLY ALL MATERIALS IN QUANTITIES SUFFICIENT TO COMPLETE WORK SHOWN ON THESE DRAWINGS. ANY DISCREPANCIES SHALL BE REPORTED TO THE LANDSCAPE ARCHITECT FOR DIRECTION.
- DO NOT MAKE SUBSTITUTIONS OF MATERIALS, PRODUCTS OR QUANTITIES WITHOUT PRIOR WRITTEN PERMISSION OF THE LANDSCAPE ARCHITECT.
- THE CONTRACTOR TO MAKE GOOD TO THE SATISFACTION OF THE LANDSCAPE ARCHITECT ANY AREAS DAMAGED BY THE WORK.
- UPON THE COMPLETION OF WORK EACH DAY, REMOVE ALL DEBRIS, GARBAGE AND SURPLUS MATERIALS FROM THE SITE. KEEP THE SITE CLEAN AND USEABLE AT ALL TIMES.
- ALL WORKMANSHIP AND MATERIALS (INCLUDING PLANTS) TO BE GUARANTEED FOR ONE FULL YEAR FOLLOWING FINAL ACCEPTANCE OF THE PROJECT.
- THE CONTRACTOR SHALL REMOVE ALL T-BAR AND WOODEN TREE STAKES PRIOR TO ASSUMPTION BY THE OWNER.
- AT THE TIME OF INSPECTION FOR ACCEPTANCE ALL TREE PITS, AND BEDS SHALL BE CULTIVATED, FREE OR WEEDS, LEAVES, BROKEN BRANCHES AND DEBRIS.

PROPOSED BOARD ON BOARD PRIVACY FENCE REFER TO DETAIL 4/ L300

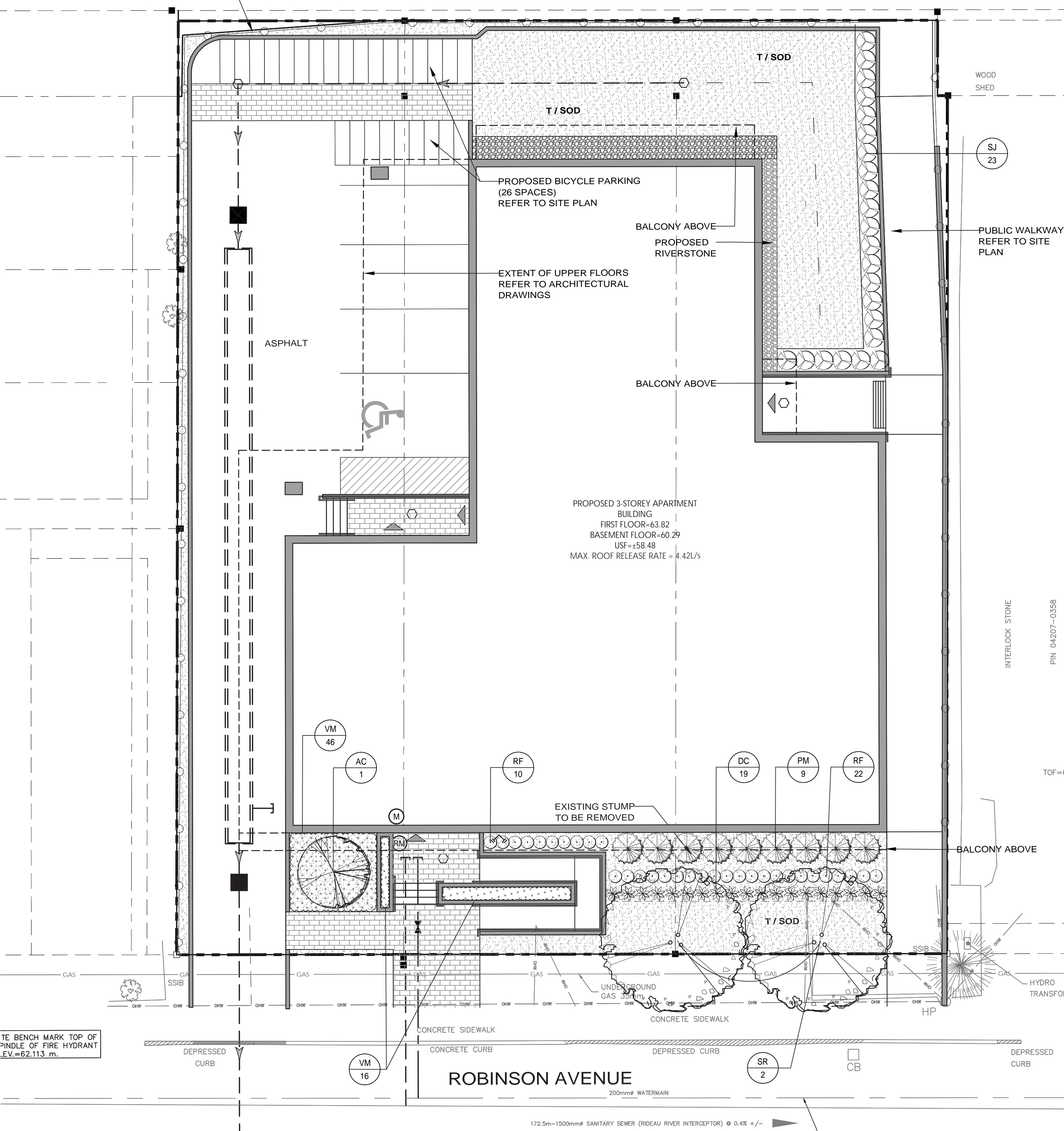

THE BENCHMARK TOP OF HANDLE OF FIRE HYDRANT E.V. = 62.113 m.

1 LANDSCAPE PLAN  
1:100