

Copyright Reserved

The Contractor shall verify and be responsible for all dimensions. DO NOT scale the drawing - any errors or omissions shall be reported to Stantec without delay.
The Copyrights to all designs and drawings are the property of Stantec. Reproduction or use for any purpose other than that authorized by Stantec is forbidden.

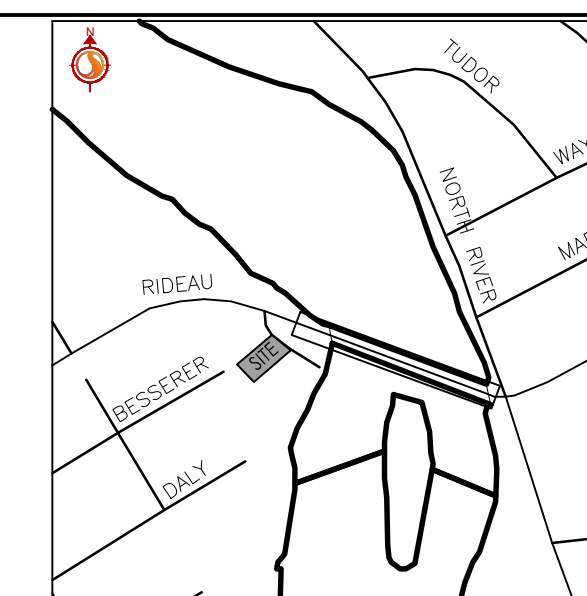

KEY PLAN
N.T.S.

Legend

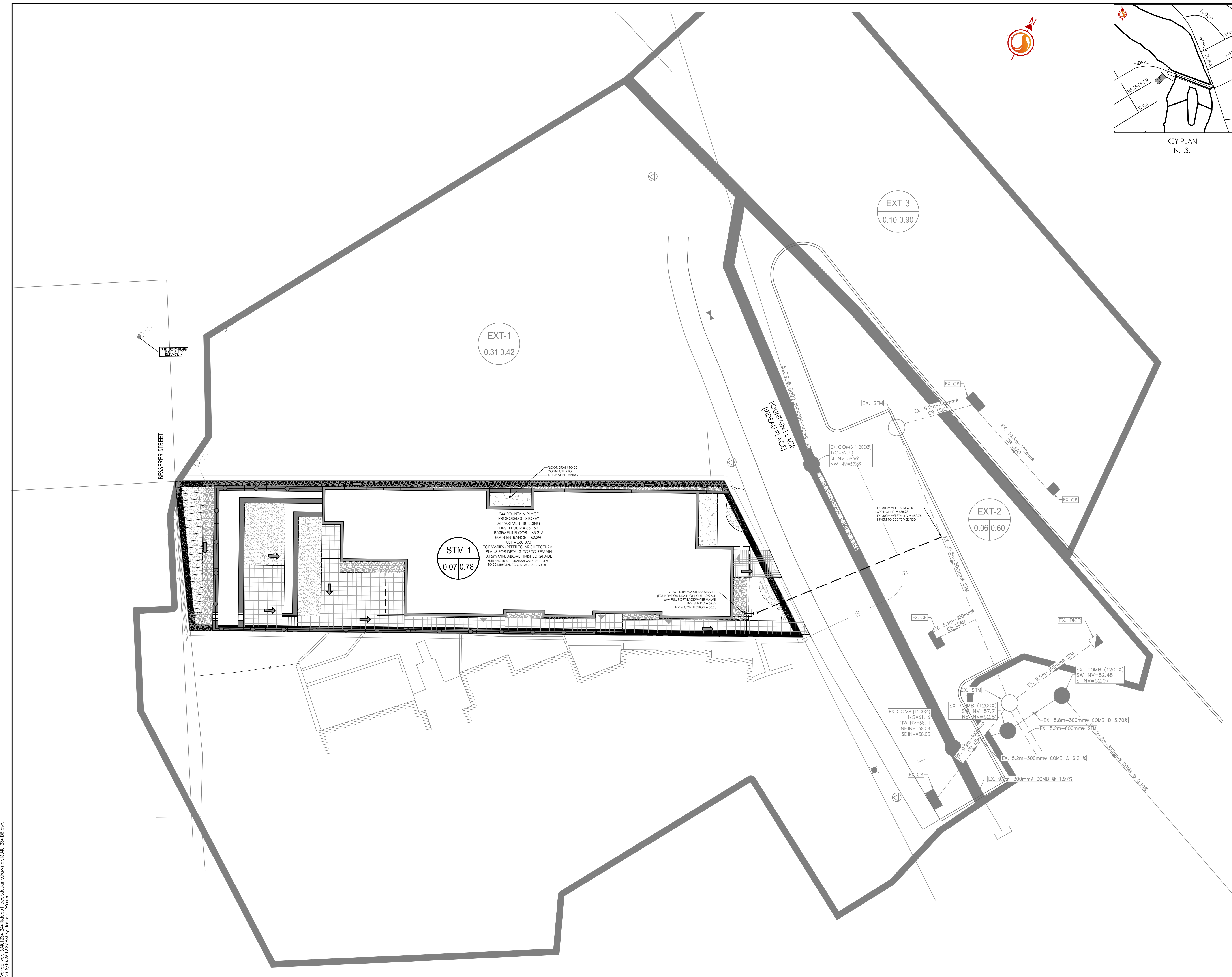
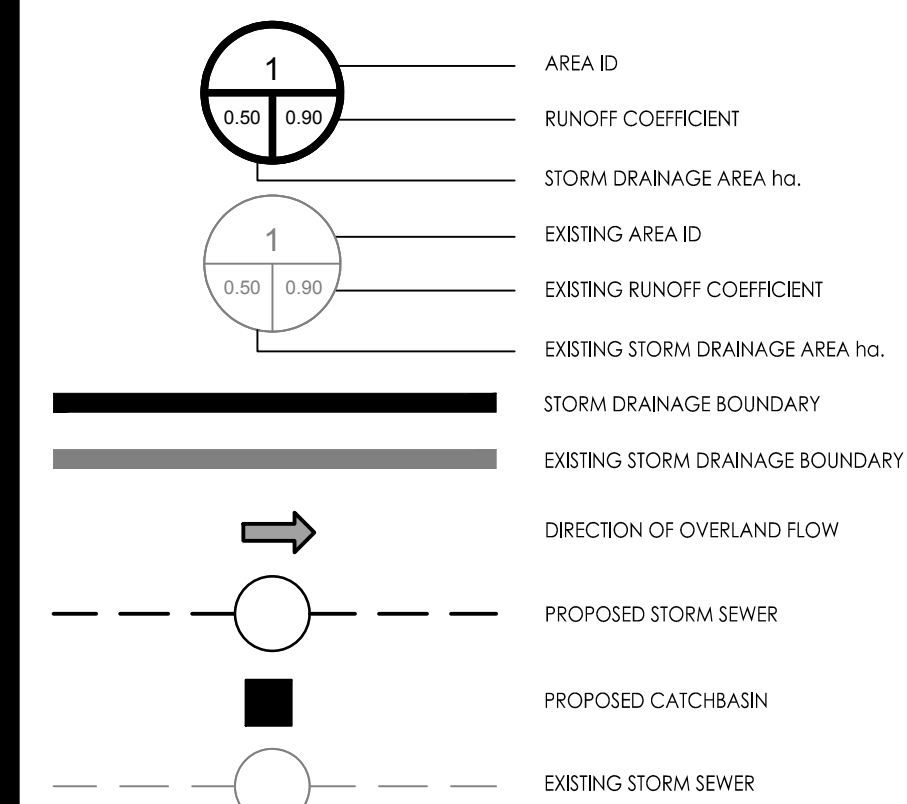

EXT-1
0.31/0.42

STM-1
0.07/0.78

EXT-3
0.10/0.90

EXT-2
0.06/0.60

244 FOUNTAIN PLACE
PROPOSED 3 - STOREY
APARTMENT BUILDING
FIRST FLOOR = 66.162
BASEMENT FLOOR = 63.215
MAIN ENTRANCE = 63.200
USF = 140,290
TOF VARIES (REFER TO ARCHITECTURAL
PLANS FOR DETAILS. TOF TO REMAIN
0.15m MIN. ABOVE FINISHED GRADE.
BUILDING ROOF DRAINAGE SYSTEMS
TO BE DIRECTED TO SURFACE AT GRADE.

Revision	By	Appd.	YY.MM.DD
3	WAJ	SGG	18.10.26
2	SL	SGG	18.08.22
1	WAJ	DCT	16.10.14

File Name: 160401234-08
Dwn. Chkd. Dsgn. Y.Y.MM.DD

Permit-Seal

Client/Project
TC UNITED GROUP
800 INDUSTRIAL AVENUE
APARTMENT BUILDING
244 FOUNTAIN PLACE
OTTAWA, ONTARIO

Title
STORM DRAINAGE PLAN

Project No. 160401234	Scale 1:150	Sheet 5 of 5	Revision 3
--------------------------	----------------	-----------------	---------------

SD-1 3 #