

1. DETAIL - BF PARKING SIGN
A.102 1/10

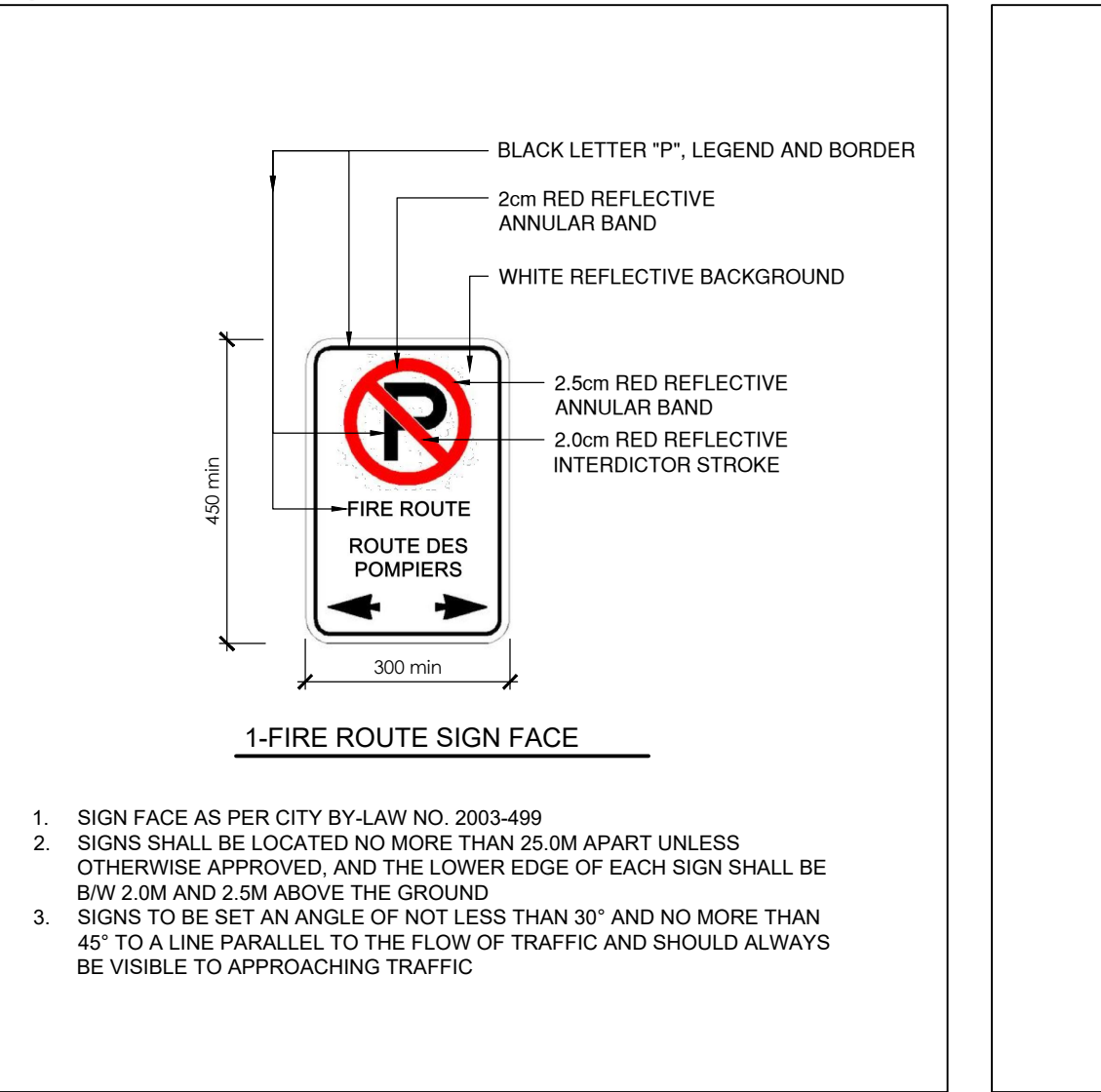

2. DETAIL - FIRE ROUTE SIGN
A.102 1/15

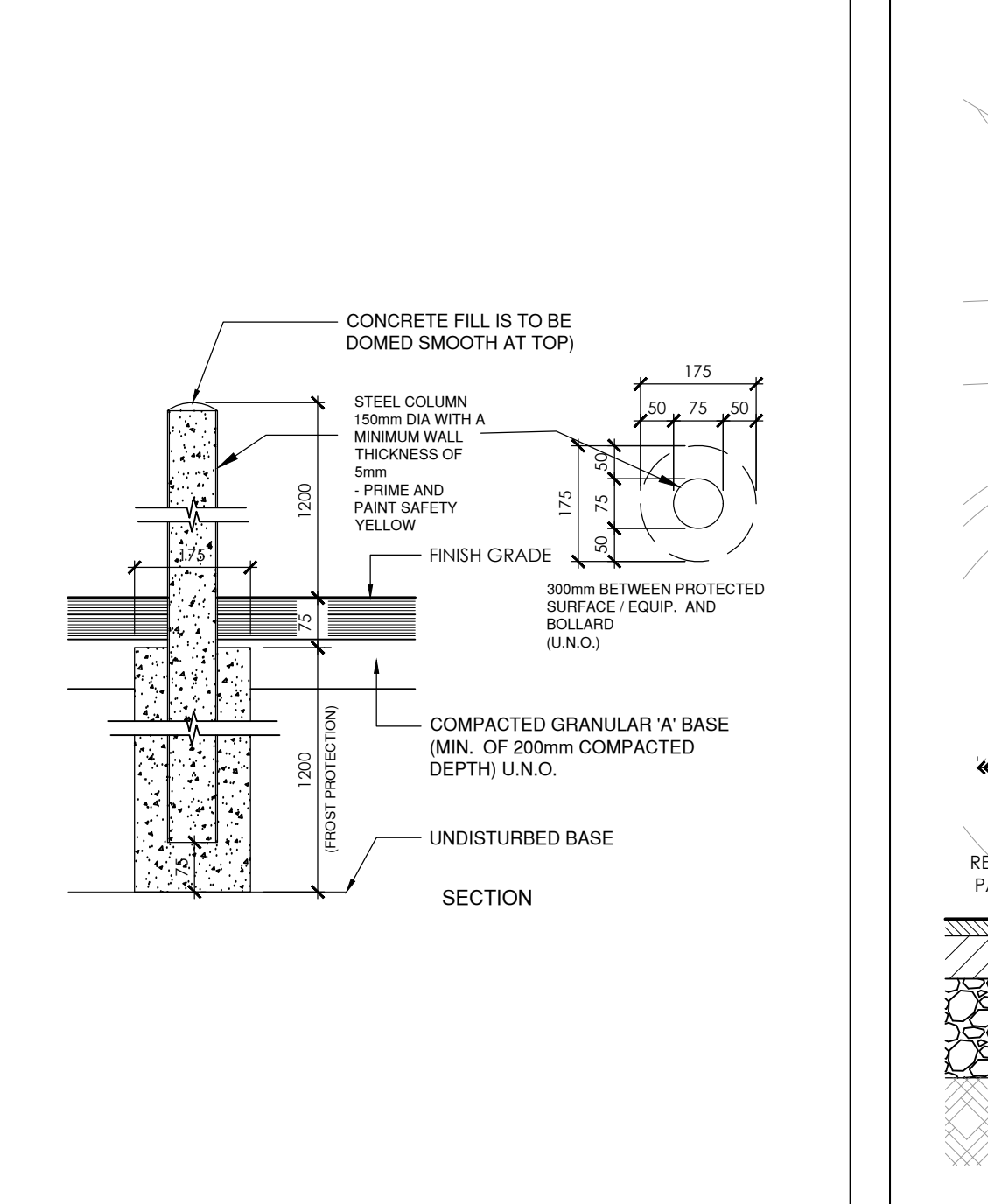

3. DETAIL - TYP BOLLARD
A.102 1/10

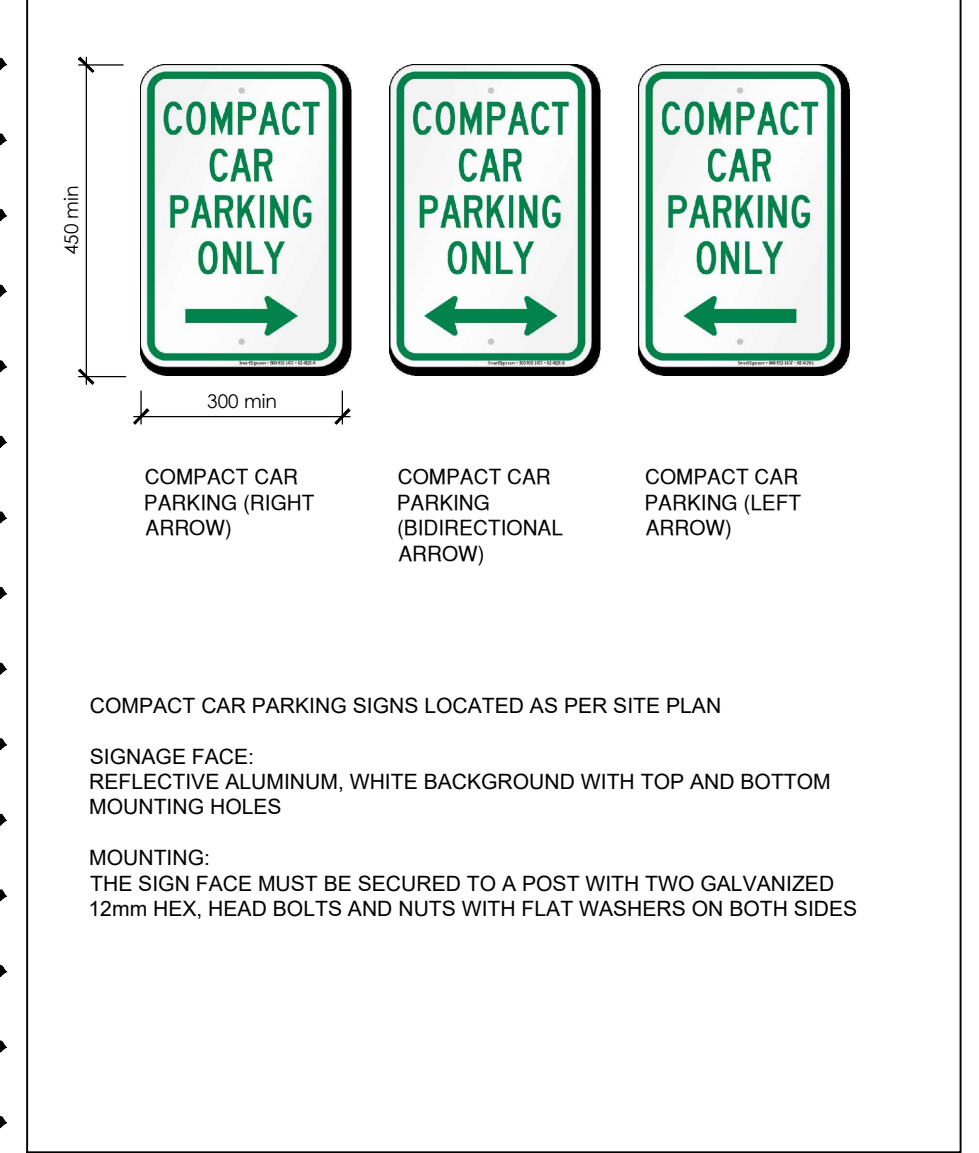

4. DETAIL - COMPACT CAR PARKING SIGN
A.102 1/10

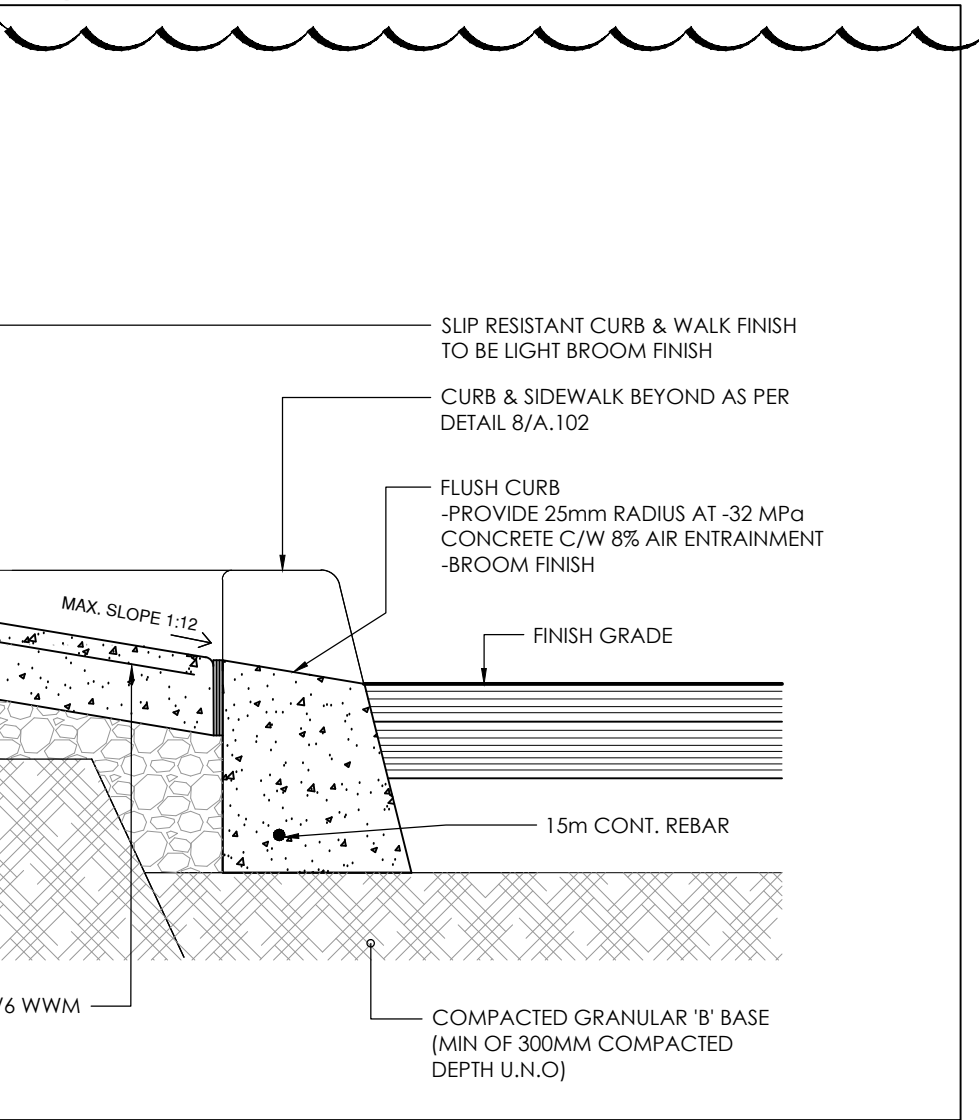

5. SECTION DETAIL - FLUSH CURB @ SIDEWALK
A.102 1/10

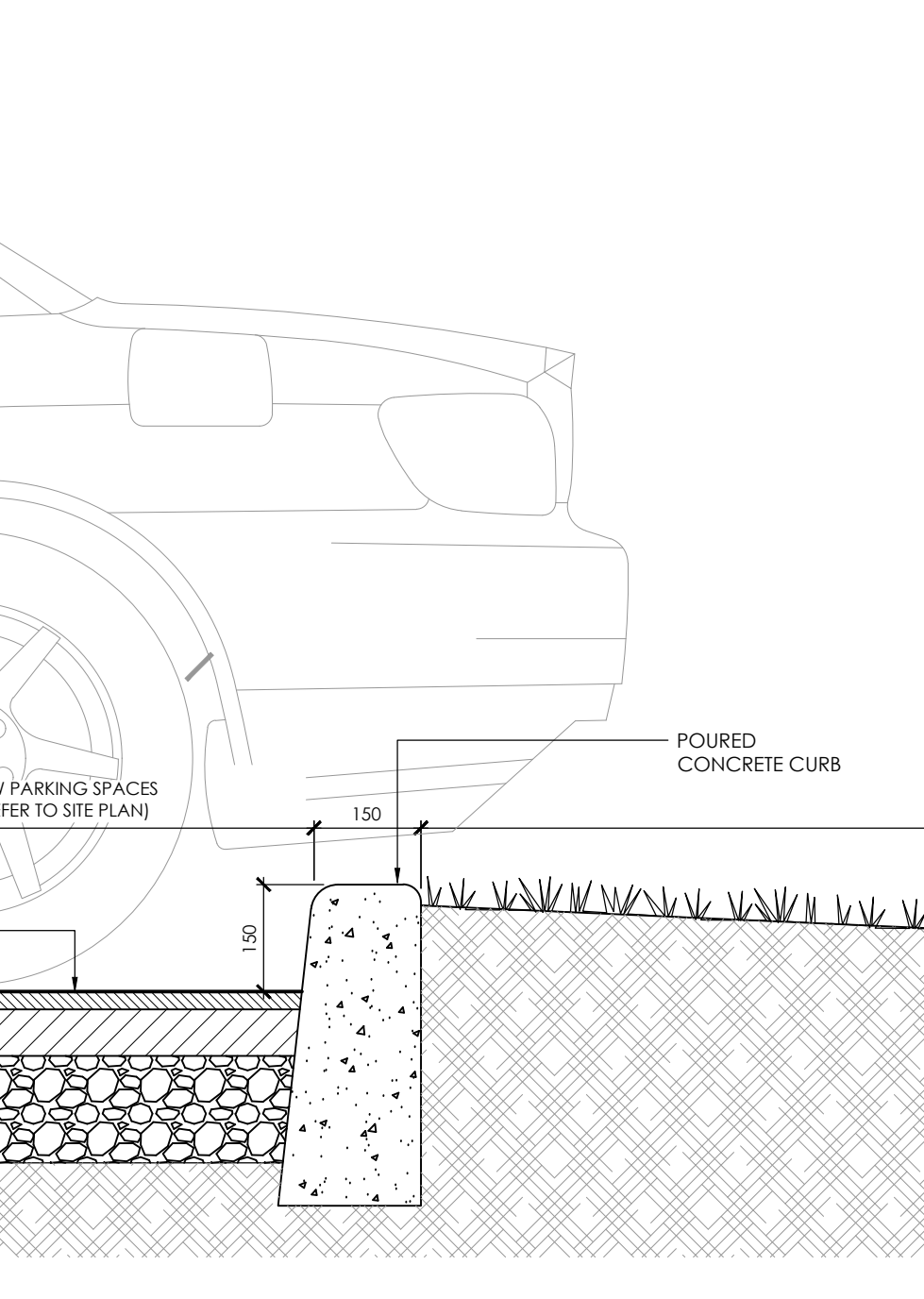

6. DETAIL - CURB AT PARKING
A.102 1/10

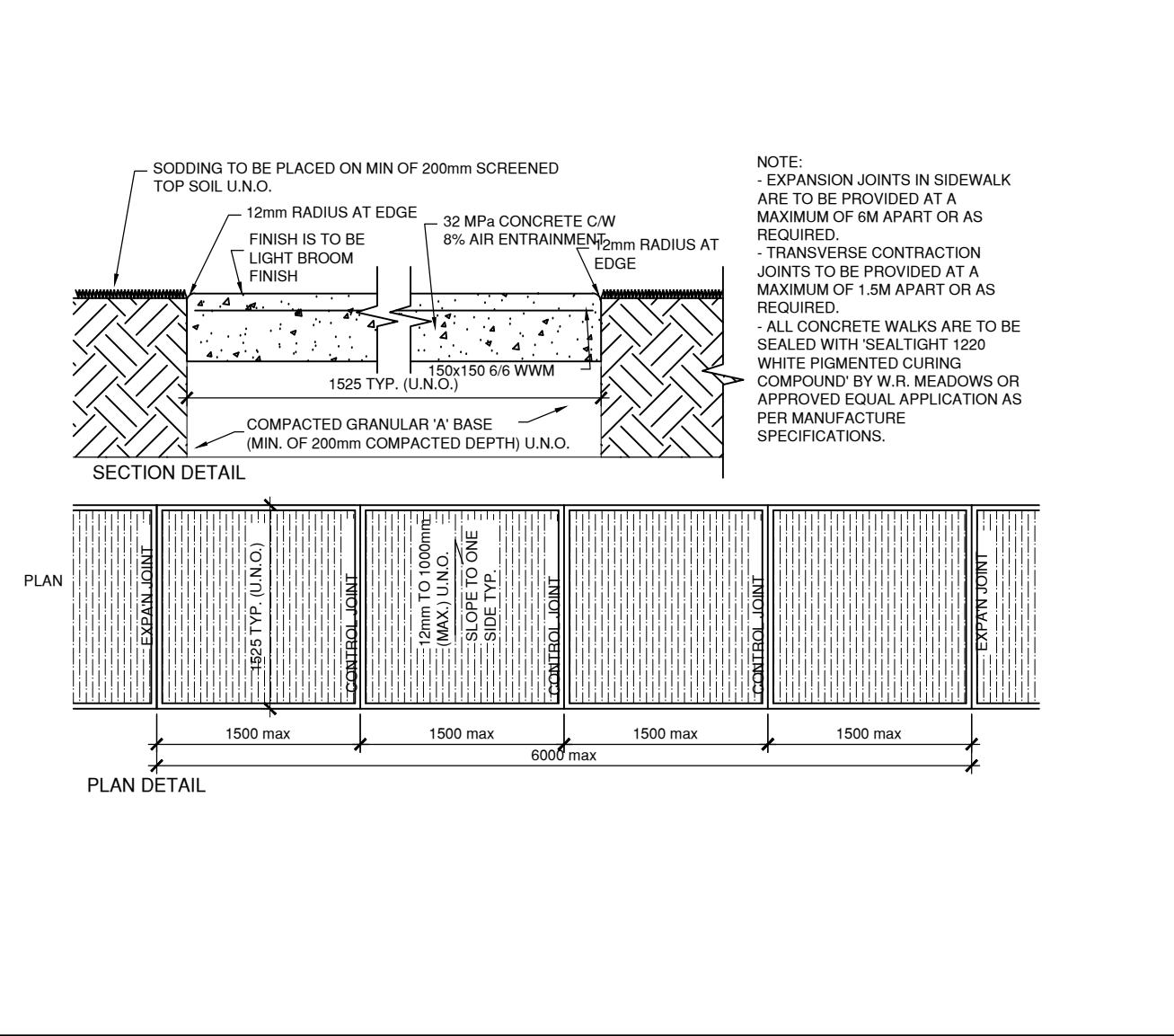

7. DETAIL - CONC SIDEWALK
A.102 1/10

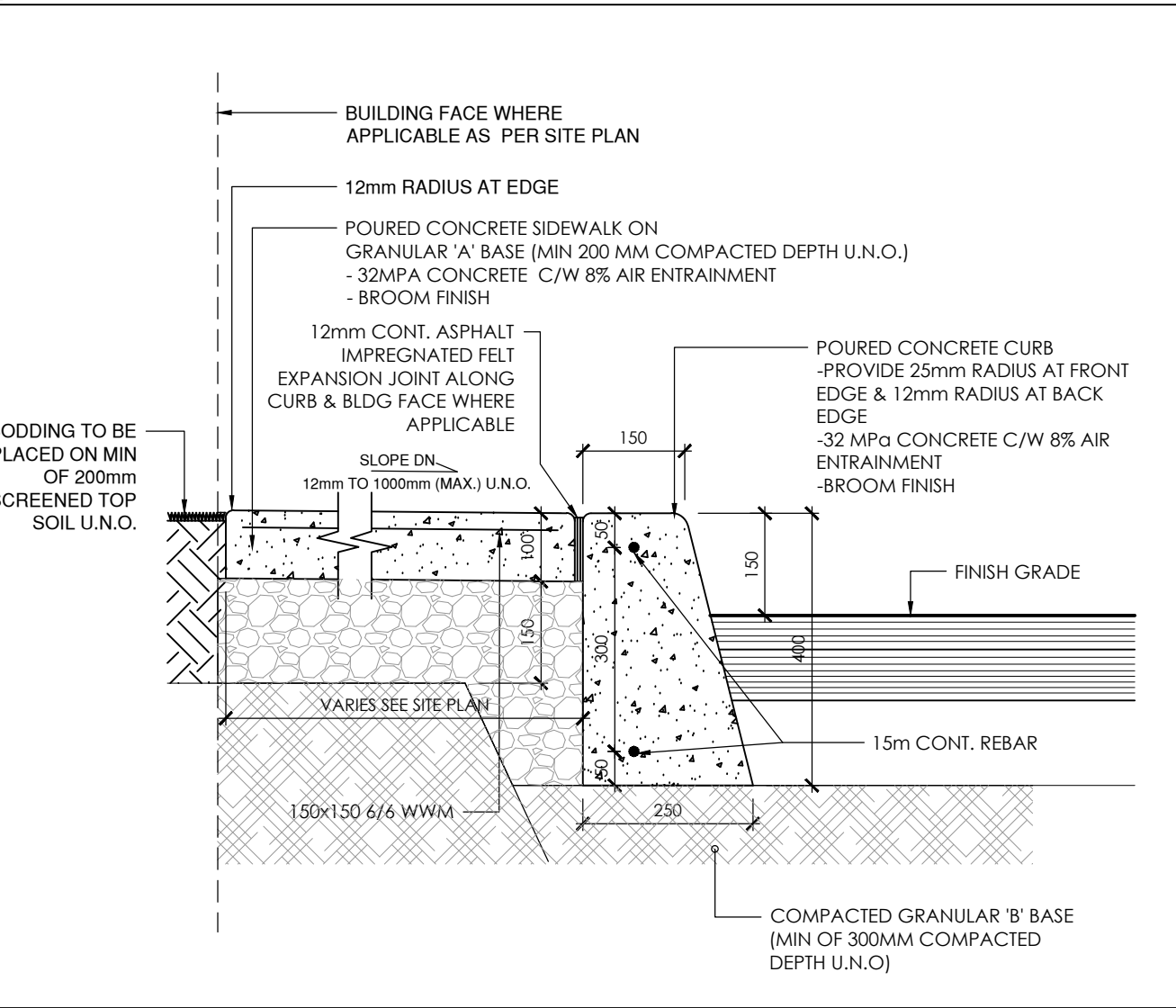

8. SECTION DETAIL - CONC CURB @ SIDEWALK
A.102 1/10

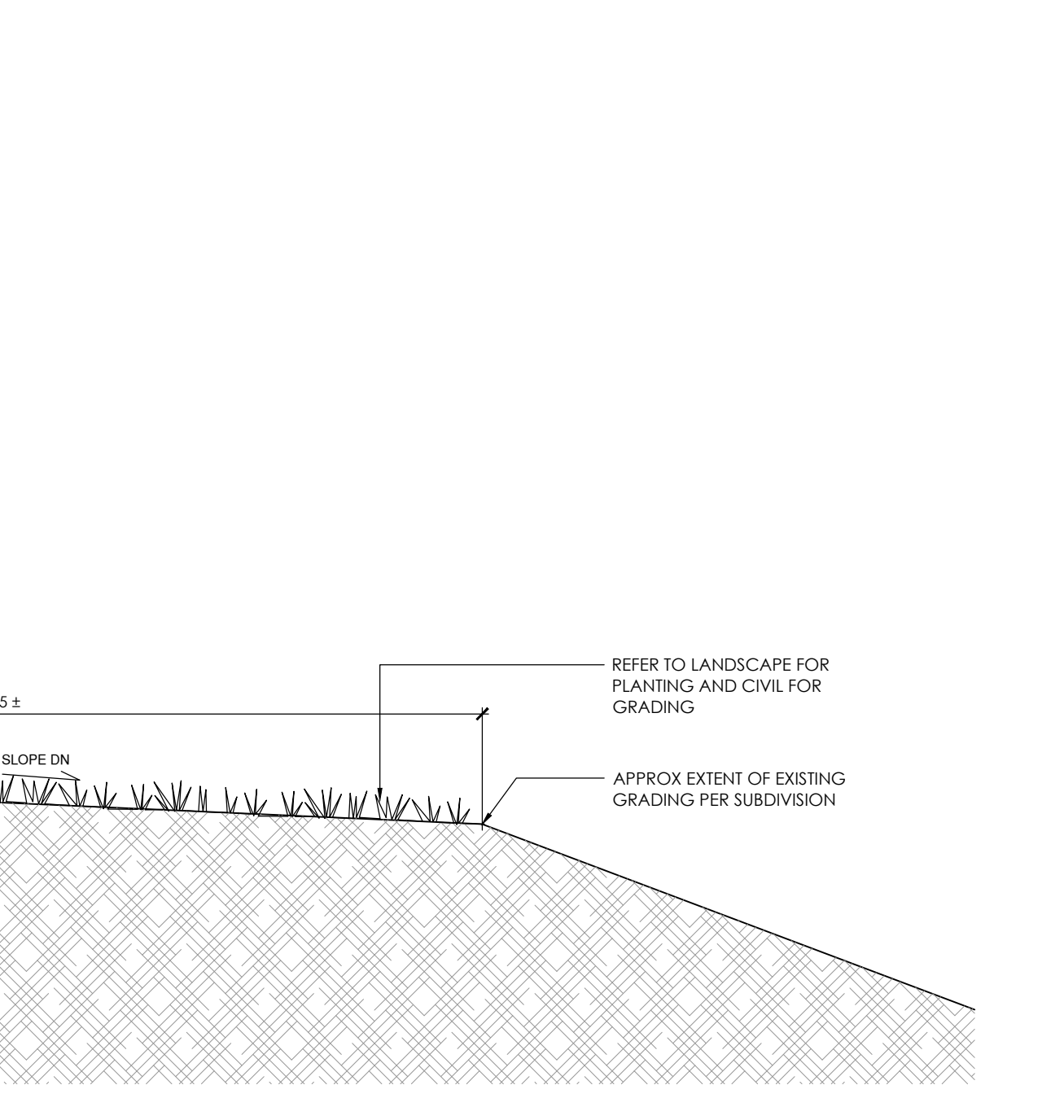

9. DETAIL - TYP BOLLARD
A.102 1/10

SITE STATISTICS				
ZONING	IP - BUSINESS PARK INDUSTRIAL			
	IP[2265]H[24]-h			
COVERAGE CALCULATIONS				
	SM	SF	ACRES	%
TOTAL SITE AREA	8,441.3	90,861	2.086	100.0%
BUILDING AREA (MAX LOT COVERAGE= 55%)	1248.2	13,436	0.308	14.8%
PAVED AREA	4634.1	49,881	1.145	54.9%
LANDSCAPED AREA -INCL SIDEWALK AND PATIO	2559	27,545	0.632	30.3%
SETBACKS (TABLE 205-IP ZONE PROVISIONS)				
	MIN REQ'D (m)	PROVIDED (m)		
FRONT YARD	6.0	13.28		
REAR YARD	6.0	46.67		
INTERIOR SIDE	3.0	17.65		
INTERIOR SIDE	3.0	16.01		
WIDTH OF LANDSCAPE STRIP				
(i) ABUTTING A RESIDENTIAL OR INSTITUTIONAL ZONE	N/A	-		
(ii) ABUTTING A STREET	3.0	3.0		
(iii) IN ALL OTHER CASES	NO MIN	(1.4m to 3m)		
HEIGHT OF BUILDING				
	MAX	PROVIDED		
MAX 24m (PER EXCEPTION DESIGNATED W / (H-24)				
(MEASURED TO T/O ROOF DECK)	24.0m	18.7		
MAX FLOOR SPACE INDEX (2)	2	0.49		
GROSS FLOOR AREA (GFA)				
(W / DEDUCTIONS AS DEFINED IN BYLAW)	SM	SF		
HOTEL	4021.9	43291.9		
PLACE OF ASSEMBLY (MEETING ROOM)	124.0	1334.7		
TOTAL GFA	4145.9	44626.6		
PARKING REQUIREMENTS (BASED ON TABLE 101; AREA "C" ON SCHEDULE 1A)				
- SPACES @ 2.75W x 5.5L (per Brand requirement)	RMS/ GFA(sm)	REQ'D	PROVIDED	
- 25% of stalls are compact stalls (size at 2.4W x 4.6L per zoning standards)				
-HOTEL: 1 SPACE PER GUEST UNIT	ROOMS:	102	102	102
-PLACE OF ASSEMBLY (10 PER 100sm OF GFA OF ASSEMBLY AREA)	MEETING RM GFA:	124.0	12	12
	TOTAL NO. OF SPACES	114	114.0	
ACCESSIBLE PARKING (CITY OF OTTAWA ACCESSIBILITY DESIGN STANDARDS)				
	REQ'D	PROVIDED		
101-133 PARKING SPACES, THEN 5 ACCESSIBLE SPACES REQ'D	5	5		
TYPE A (VAN), MIN WIDTH=3400	2	2		
TYPE B, MIN WIDTH=2400	3	3		
BICYCLE PARKING (BASED ON TABLE 111A (g)&(ii))				
	REQ'D	PROVIDED		
HOTEL = 1 PER 1000sm OF GFA	4	4		
ALL OTHER (ie. PLACE OF ASSEMBLY) = 1 PER 1500sm OF GFA	0	0		
DRIVEWAYS AND AISLE REQUIREMENTS (SECTION 107)				
	REQ'D (MIN)	PROVIDED		
TWO-WAY DRIVEWAY	6.7	6.86		
TWO-WAY PARKING AISLE	6.7	6.86		
LOADING REQUIREMENTS (SECTION 113)				
(SIZE: 3.5Wx9.0L PARALLEL; 3.5Wx7.0 OTHER: 4.2M VERT CLR)	REQ'D	PROVIDED		
ALL OTHER USES W / GFA FROM 2,000-4,999sm	2	1		

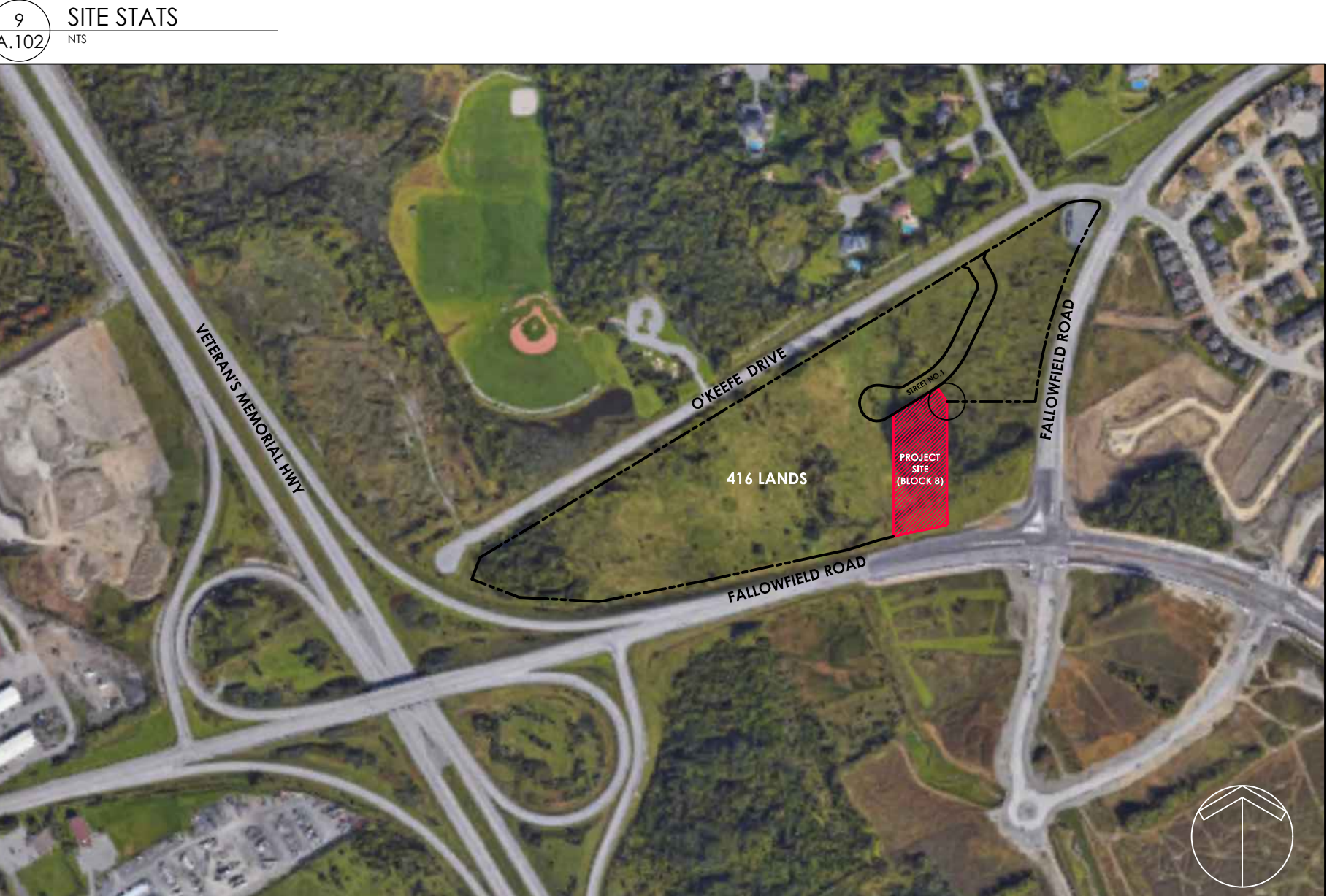

10. CONTEXT PLAN
A.102 1/10

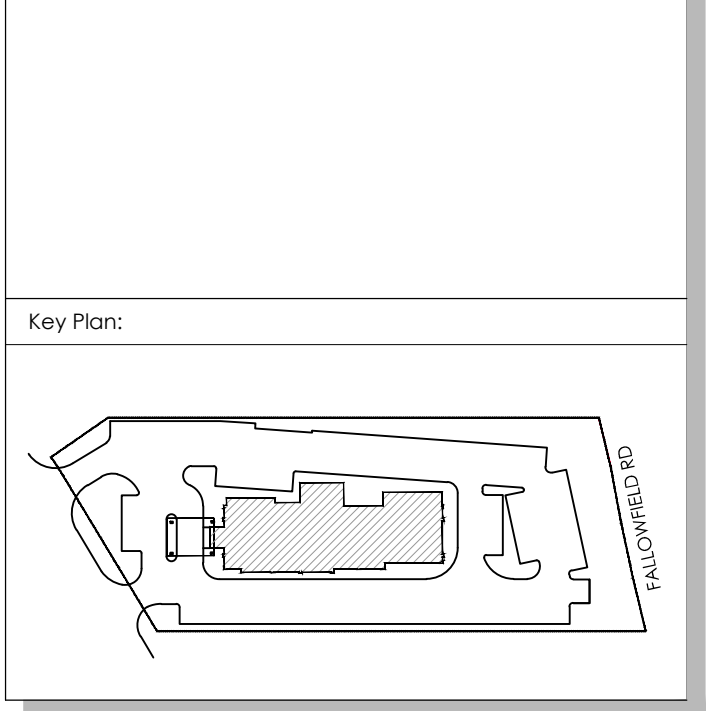

No.	Date:	Issue/Revision
4	18/10/03	ISSUED FOR SPA RESUBMISSION (rev1)
3	18/07/27	ISSUED FOR PROGRESS DRAWINGS
2	18/03/23	ISSUED FOR 50% BRAND REVIEW
1	18/02/09	ISSUED FOR SITE PLAN APPLICATION

Note:
ALL DIMENSIONS AND INFORMATION SHOWN ON THESE DRAWINGS MUST BE CHECKED AND VERIFIED ON SITE AND ANY DISCREPANCIES REPORTED TO THE ARCHITECT PRIOR TO CONSTRUCTION AND FABRICATION OF ITS COMPONENTS. SHOULD EXISTING CONDITIONS OR SERVICES BE FOUND TO VARY FROM THAT INDICATED ON THE DRAWINGS, THE ARCHITECT MUST BE NOTIFIED IMMEDIATELY.

FEATURES OF CONSTRUCTION NOT FULLY SHOWN ARE ASSUMED TO BE THE SAME CHARACTER AS THOSE NOTED FOR SIMILAR CONDITIONS.

UNLESS SPECIFICALLY NOTED OTHERWISE ON THE DRAWINGS, NO PROVISION HAS BEEN MADE IN THE DESIGN FOR CONDITIONS OCCURRING DURING CONSTRUCTION. IT SHALL BE THE RESPONSIBILITY OF THE CONTRACTOR TO PROVIDE ALL NECESSARY BRACING, SHORINGS, SHEET PILING OR OTHER TEMPORARY SUPPORTS, TO SAFEGUARD ALL EXISTING OR ADJACENT STRUCTURES AFFECTED BY THIS WORK.

ALL DRAWINGS AND RELATED DOCUMENTS SHALL REMAIN THE PROPERTY AND COPYRIGHT OF MATAJ ARCHITECTS INC. USE LATEST REVISED DRAWINGS. DO NOT SCALE DRAWINGS.



Project:
OTTAWA HAMPTON INN & SUITES
4401 FALLOWFIELD ROAD (BLOCK 8)
BARRHAVEN (OTTAWA) ON

Sheet Title:
SITE STATS & DETAILS

Design By: EM MO	Drawn By: MO	Approved By: EM
Scale: AS NOTED	Date: Jan 2018	Project No.: 17026
Drawing No.:		

A102 OF:
Drawing Series:
FILE #D07-12-18-0045