

1 LANDSCAPE PLAN
L.1 SCALE: 1:400

GENERAL NOTES:

1. It is the responsibility of the appropriate contractor or official to report any errors, omissions or discrepancies on this plan with actual site conditions to the Landscape Architect before proceeding with construction.
2. The contractor is to notify all utility companies and authorities prior to any excavation and ascertain locations of underground services.
3. The contractor is to reinstate all areas and items damaged as a result of construction activity.
4. The contractor is to comply with all pertinent codes and by-laws.
5. The contractor is to maintain a positive surface run-off throughout the entire construction period.
6. The Landscape Architect is not responsible for subsurface conditions.
7. The contractor is to identify all existing trees to remain on site with the Landscape Architect prior to construction.
8. The contractor is to stake the proposed location of all plant material in conjunction with the Landscape Architect prior to excavation.
9. Minimum distances for selected deciduous trees are as follows as per City of Ottawa:
 - Building Foundations 7.5m
 - Sidewalks 1.5m
 - Public Streets 2.5m
 - Underground Infrastructure 2.0m
10. All trees within 1m of underground utility trenches are to be excavated by hand.
11. Remove all protective wrapping from tree trunks after installation.
12. Staking of trees shall only be performed if necessary.
13. Ensure that mulch is pulled back a min. distance of 75mm from base of tree trunk.
14. The owner shall provide, at the time a site plan approval is submitted for the development of Block 322, a landscaping plan showing the street trees along the street frontages of the block. The owner shall be responsible for the installation. This shall be to the satisfaction of the General Manager, Planning, Infrastructure and Economic Development and Director, Parks, Forestry and Stormwater Services.
15. See Geotechnical Report prepared by EXP Services Inc. July 28, 2018 for planting restrictions.
16. Trees in the R.O.W. are to be planted by Developer.

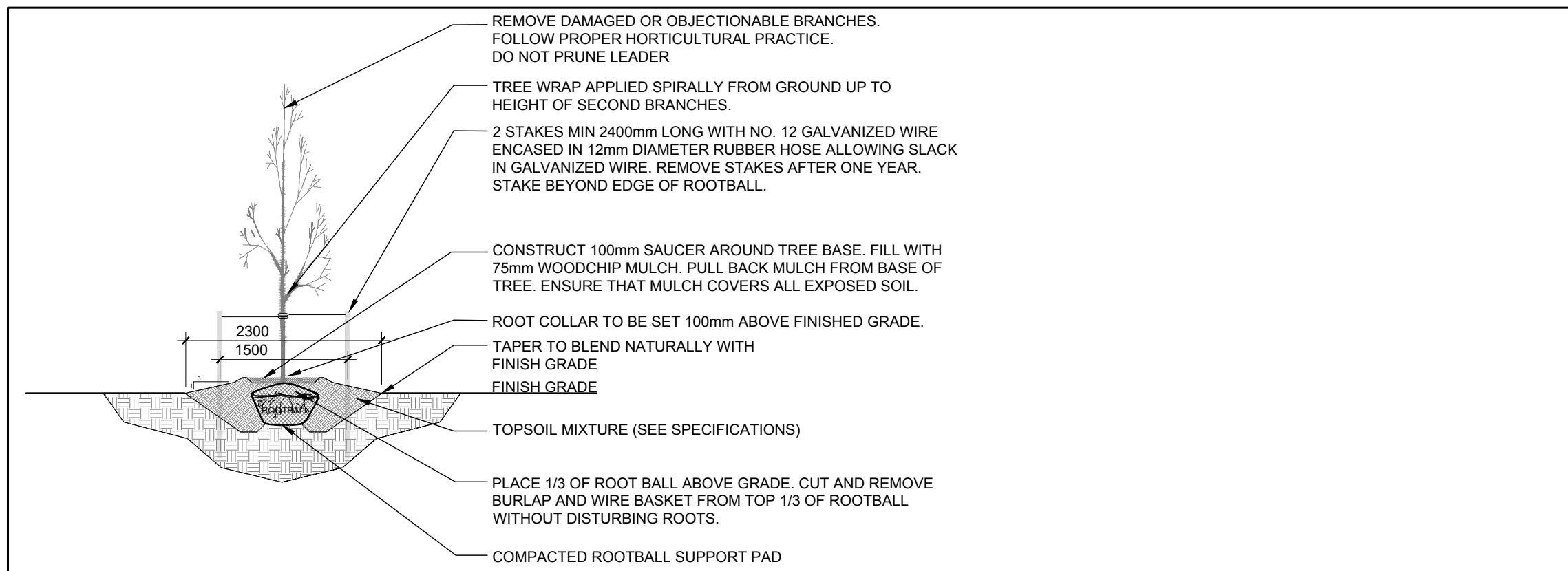

2 DECIDUOUS TREE PLANTING
L.1 SCALE: NTS

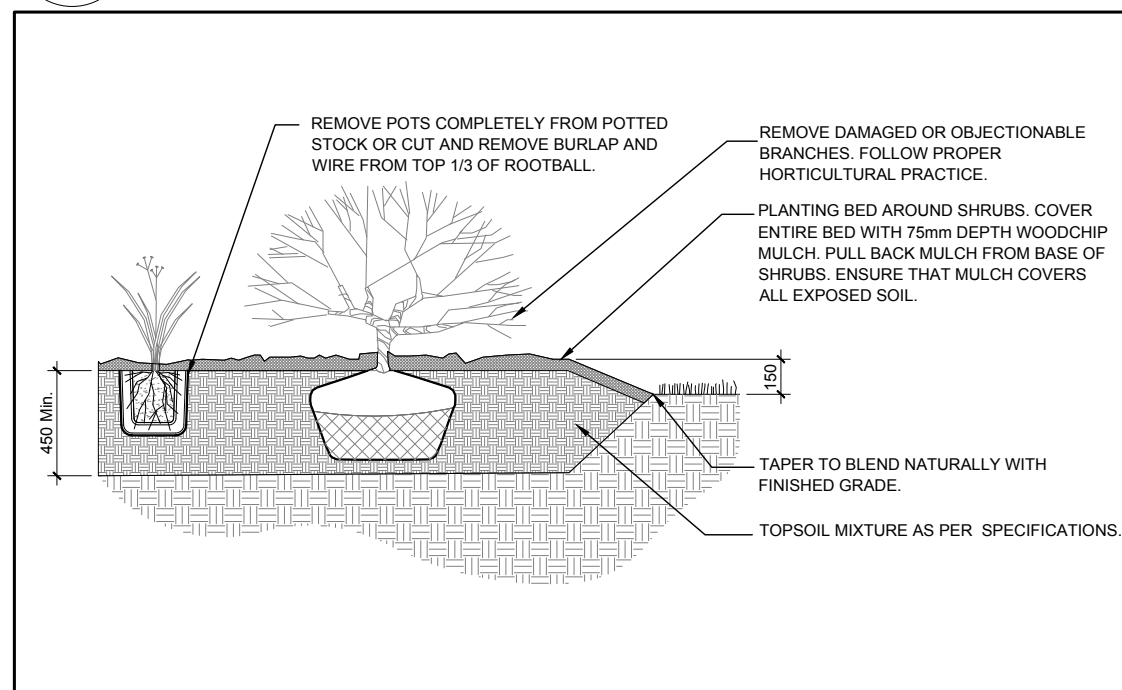

3 SHRUB AND PERENNIAL PLANTING
L.1 SCALE: NTS

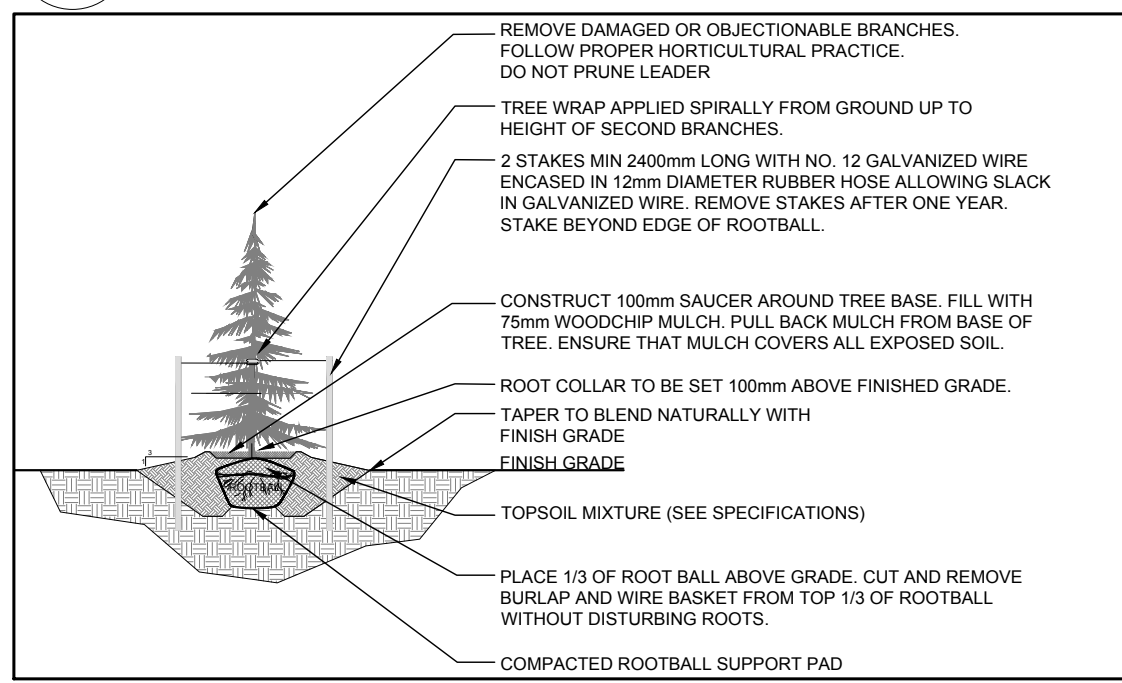

4 SEVEN (7) RING BIKE RACK
L.1 SCALE: NTS

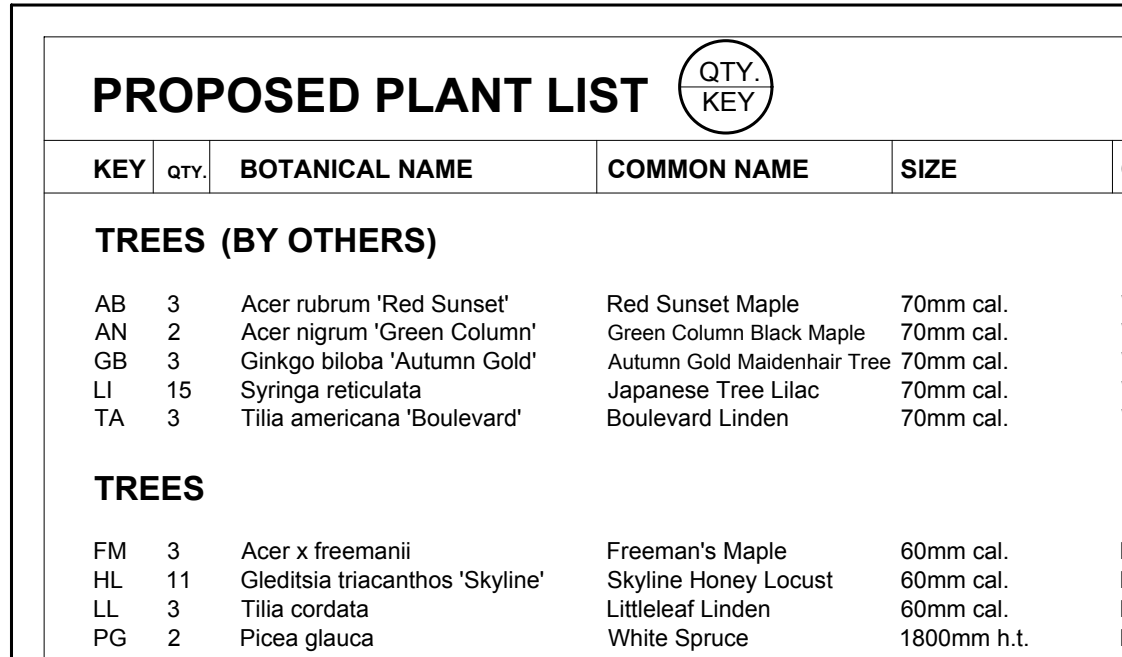

5 CONIFEROUS TREE PLANTING
L.1 SCALE: NTS

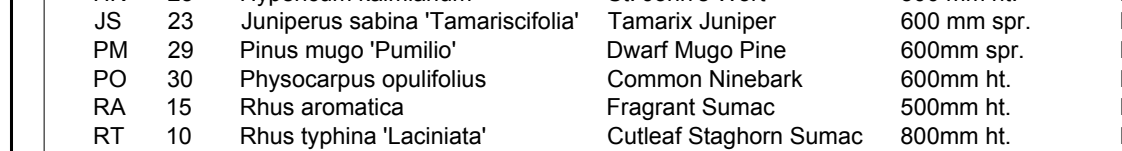

6 FIVE (5) RING BIKE RACK
L.1 SCALE: 1:75

PROPOSED PLANT LIST

KEY	qty.	BOTANICAL NAME	COMMON NAME	SIZE	CONDITION	REMARKS
TREES (BY OTHERS)						
AB	3	Acer rubrum 'Red Sunset'	Red Sunset Maple	70mm cal.	Wire Basket	
AN	2	Acer nigrum 'Green Column'	Green Column Black Maple	70mm cal.	Wire Basket	
GB	3	Ginkgo biloba 'Autumn Gold'	Autumn Gold Maidenhair Tree	70mm cal.	Wire Basket	
LI	15	Syringa reticulata	Japanese Tree Lilac	70mm cal.	Wire Basket	
TA	3	Tilia americana 'Boulevard'	Boulevard Linden	70mm cal.	Wire Basket	
TREES						
FM	3	Acer x freemanii	Freeman's Maple	60mm cal.	B&B	
HL	11	Gleditsia triacanthos 'Skyline'	Skyline Honey Locust	60mm cal.	B&B	
LL	3	Tilia cordata	Littleleaf Linden	60mm cal.	B&B	
PG	2	Picea glauca	White Spruce	1800mm h.t.	B&B	
SHRUBS						
HK	25	Hypericum kalmianum	St. John's Wort	300 mm ht.	Potted	800 mm o.c.
JS	23	Juniperus sabina 'Tamariscifolia'	Tamarix Juniper	600 mm spr.	Potted	1000 mm o.c.
PM	29	Pinus mugo 'Pumilio'	Dwarf Mugo Pine	600mm spr.	Potted	800 mm o.c.
PO	30	Physocarpus opulifolius	Common Ninebark	600mm ht.	Potted	1000 mm o.c.
RA	15	Rhus aromatica	Fragrant Sumac	500mm ht.	Potted	800 mm o.c.
RT	10	Rhus typhina 'Laciniata'	Cuttleaf Staghorn Sumac	800mm ht.	Potted	1200 mm o.c.
PERENNIALS AND ORNAMENTAL GRASSES						
AC	13	Echinacea purpurea	Purple Coneflower	250mm pot	Potted	550 mm o.c.
DL	137	Hemerocallis 'Stella D'Or'	Stella D'Or Day Lily	150mm pot	Potted	350 mm o.c.
KF	30	Calamagrostis 'Karl Foerster'	Karl Foerster Grass	250mm pot	Potted	800 mm o.c.
PA	29	Perovskia atriplicifolia	Russian Sage	250mm pot	Potted	650 mm o.c.
PV	27	Penicum virgatum	Spiraea Grass	100mm pot	Potted	800 mm o.c.
ST	91	Sedum telephium 'Autumn Joy'	Autumn Joy Sedum	250mm pot	Potted	500 mm o.c.

CONSEIL DES ÉCOLES CATHOLIQUES DU CENTRE-EST
Le meilleur conseil qu'on puisse vous donner

Conseil Des Écoles Catholiques Du Centre-Est
4000 Labelle Street,
Grouville, ON K2E 4L1
Tel: (613) 727-0865

CONSULTANTS

ARCHITECT:

Pye and Richards Architects Inc.
844 Meach Street
Ottawa, ON K1G 6E8
Tel: (613) 724-7700

CIVIL ENGINEERS:

Jp2g Consultants Inc.
1150 Morrison Dr., Suite 410
Ottawa, ON K2H 8S8
Tel: (613) 628-7800

SURVEYORS:

Annis O'Sullivan Vollebakk Ltd.
114 Concourse Gate, Suite 500
Nepean, ON K2E 7Y1
Tel: (613) 727-0905

LEGEND

- PROPOSED DECIDUOUS STREET TREE (BY OTHERS)
- PROPOSED DECIDUOUS TREE
- PROPOSED CONIFEROUS TREE
- PROPOSED SOD
- PROPOSED ENGINEERED WOOD FIBRE
- PROPOSED CSA APPROVED SAND
- PROPOSED SHRUBS / PERENNIALS / ORNAMENTAL GRASSES
- PROPOSED BIKE RACK ON CONCRETE PAD (46 TOTAL BIKE SPACES)

5	REVISED PER CITY COMMENTS	10/19/2018	ML	JL
4	REVISED PER CITY COMMENTS	09/24/2018	ML	JL
3	REVISED AS PER ARCHITECTURAL COMMENTS	07/20/2018	SS	JL
2	ISSUED FOR SITE PLAN APPROVAL	06/29/2018	SS	JL
1	ISSUED FOR COMMENTS AND REVIEW	06/28/2018	SS	JL
No.	Issue	Date	DR	CK

JAMES B. LENNOX & ASSOCIATES INC. LANDSCAPE ARCHITECTS
3332 CARLING AVE. OTTAWA, ONTARIO K2H 5A8
Tel. (613) 722-5168 Fax. (866) 343-3942

PROJECT

NOUVELLE ÉCOLE ÉLÉMENTAIRE À RIVERSIDE-SUD

925 RALPH HENNESSY AVENUE, OTTAWA ON

DRAWING

LANDSCAPE PLAN

STAMP

SCALE

AS SHOWN

START DATE

MAY 2018

PROJECT NO.

18-PR-1844

PROJECT NORTH

DRAWING NO.

L.1

PLOT SIZE ISO-B1

#17731

D07-12-18-0104