

GENERAL NOTES:

- It is the responsibility of the appropriate contractor or official to report any errors, omissions or discrepancies on this plan with actual site conditions to the Landscape Architect before proceeding with construction.
- The contractor is to notify all utility companies and authorities prior to any excavation and ascertain locations of underground services.
- The contractor is to reinstate all areas and items damaged as a result of construction activity.
- The contractor is to comply with all pertinent codes and by-laws.
- The contractor is to maintain a positive surface run-off throughout the entire construction period.
- The Landscape Architect is not responsible for subsurface conditions.
- The contractor is to identify all existing trees to remain on site with the Landscape Architect prior to construction.
- The contractor is to stake the proposed location of all plant material in conjunction with the Landscape Architect prior to excavation.
- Minimum distances for selected deciduous trees are as follows:
 - Building Foundations 7.5m
 - Sidewalks 1.5m
 - Public Streets 2.5m
 - Underground Infrastructure 2.0m
- All trees within 1m of underground utility trenches are to be excavated by hand.
- Remove all protective wrapping from tree trunks after installation.
- Staking of trees shall only be performed if necessary.
- Ensure that mulch is pulled back a min. distance of 75mm from base of tree trunk.

CLIENT
JLG DEVELOPMENTS INC.
9 CALAIS COURT
OTTAWA, ON
K2E 7E1
TEL: (613) 291-4119

CONSULTANTS

ARCHITECTS:
Rosaline J. Hill Architect Inc.
414 CHURCHILL AVENUE NORTH
OTTAWA, ON
K1Z 5C2
TEL: (613) 852-2822

SURVEYORS:
FARLEY, SMITH AND DENIS SURVEYING LTD.
180 COLONADE ROAD,
OTTAWA, ON
K1Z 5C2
TEL: (613) 727-8226

CIVIL ENGINEERS:
TL MAK ENGINEERING CONSULTANTS INC.
1465 YONGEVILLE DRIVE,
OTTAWA, ON
K1C 5C2
TEL: (613) 857-9516

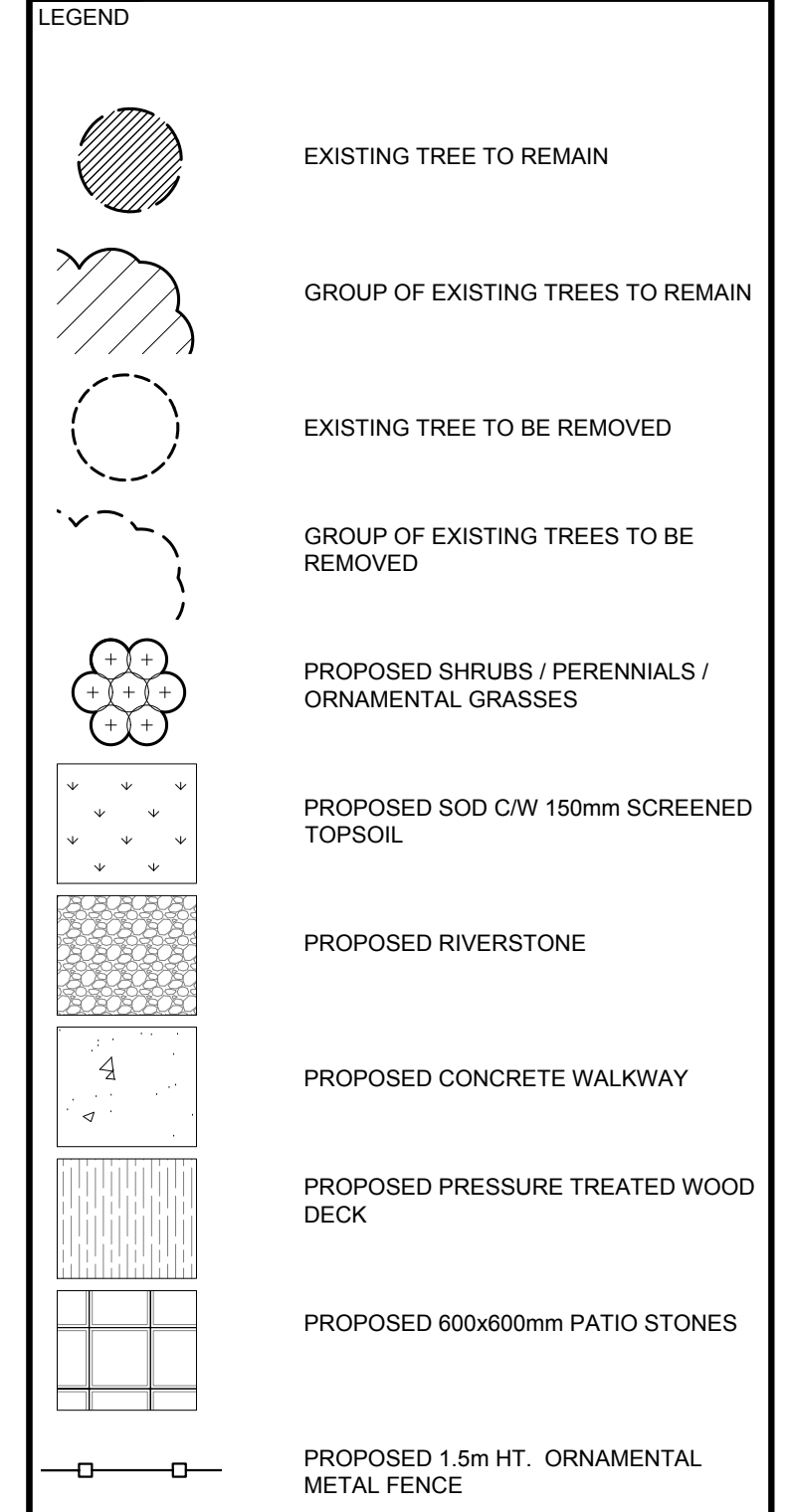

No.	Issue	Date	DR	CK
3	REVISED AS PER COMMENTS	10/10/2018	SS	JL
2	ISSUED FOR COMMENTS AND REVIEW	09/04/2018	ML	JL
1	ISSUED FOR COMMENTS AND REVIEW	08/30/2018	SS	JL

JAMES B. LENNOX & ASSOCIATES INC.
LANDSCAPE ARCHITECTS
3332 CARLING AVE. OTTAWA, ONTARIO K2H 5A5
Tel: (613) 722-5168 Fax: (613) 343-3942

PROJECT
CHAMPAGNE APARTMENTS
16 & 20 CHAMPAGNE AVE. S., OTTAWA ON

DRAWING
TREE CONSERVATION REPORT & LANDSCAPE PLAN

STAMP

SCALE
AS SHOWN

START DATE
AUGUST 2018

PROJECT NO.
18-MIS-1866

PROJECT NORTH

DRAWING NO.
L.1

PLOT SIZE ARCH-D

1 TREE CONSERVATION REPORT & LANDSCAPE PLAN
SCALE 1:75

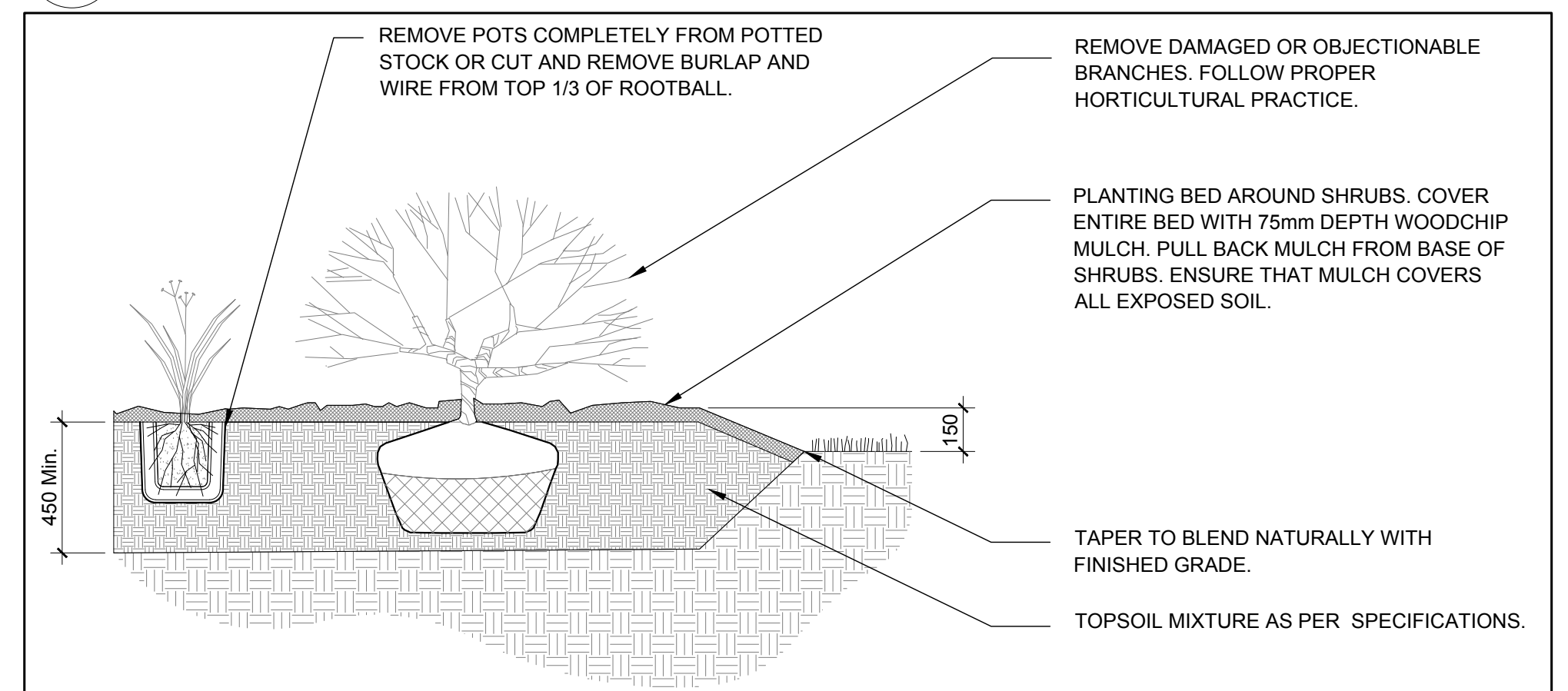

2 SHRUB / PERENNIAL / ORNAMENTAL GRASS PLANTING
SCALE 1:20

EXISTING TREE LIST

KEY	QTY.	BOTANICAL NAME	COMMON NAME	SIZE	CONDITION	REMARKS
AP	1	Acer platanoides	Norway Maple	100mm DBH.	Good	
AN	11	Acer negundo	Manitoba Maple	100-200mm DBH.	Fair-Good	
AR	1	Acer rubrum	Red Maple	100mm DBH.	Good	
GT	2	Gleditsia triacanthos	Honey Locust	200mm DBH.	Good	
PC	2	Thuja occidentalis 'Fastigiata'	Pyramid Cedar	100mm DBH.	Good	
PV	1	Prunus virginiana	Chokecherry	150mm DBH.	Good	
TC	2	Taxus cuspidata 'Capitata'	Upright Japanese Yew	100mm DBH.	Good	
TO	*	Thuja occidentalis	Eastern White Cedar	100-250mm DBH.	Fair-Good	
UA	*	Ulmus americana	White Elm	100-300mm DBH.	Fair	

*DENOTES NUMEROUS

PROPOSED PLANT LIST

KEY	QTY.	BOTANICAL NAME	COMMON NAME	SIZE	CONDITION	REMARKS
SHRUBS						
AH	3	Hydrangea arborescens 'Annabelle'	Annabelle Hydrangea	1 gallon pot	Potted	1000mm o.c.
PM	6	Pinus mugo 'Pumilio'	Dwarf Mugo Pine	600mm spr.	Potted	1000mm o.c.
ORNAMENTAL GRASSES						
KF	6	Calamagrostis acutiflora 'Karl Foerster'	Karl Foerster Grass	250mm pot	Potted	800mm o.c.
PERENNIALS						
EP	28	Echinacea purpurea 'Magnus'	Magnus' Purple Coneflower	100mm pot	Potted	400mm o.c.
HS	15	Hemerocallis 'Stella D'Oro'	Stella D'Oro Daylily	150mm pot	Potted	300mm o.c.
PA	6	Perovskia anglicifolia	Russian Sage	250mm pot	Potted	600mm o.c.
RH	29	Rudbeckia fulgida 'Goldstrum'	Yellow Coneflower	150mm pot	Potted	400mm o.c.