

LEGEND

	PROPERTY LINE		PROPOSED SANITARY MANHOLE
	PROPOSED WATERMAIN		PROPOSED STORM MANHOLE
	PROPOSED SANITARY SEWER		PROPOSED CATCH BASIN
	PROPOSED STORM SEWER		PROPOSED CB 'T'
	PROPOSED PERFORATED SUBDRAIN		PROPOSED SERVICE LATERAL PER CITY STD. S11.3
	PROPOSED VALVE BOX		
	PROPOSED CURB STOP		
	PROPOSED FIRE HYDRANT		
	PROPOSED GROMMET CONNECTION		
	PROPOSED REMOTE WATER METER		
	PROPOSED WATER METER		

FOLIAGE PRIVATE PROFILE

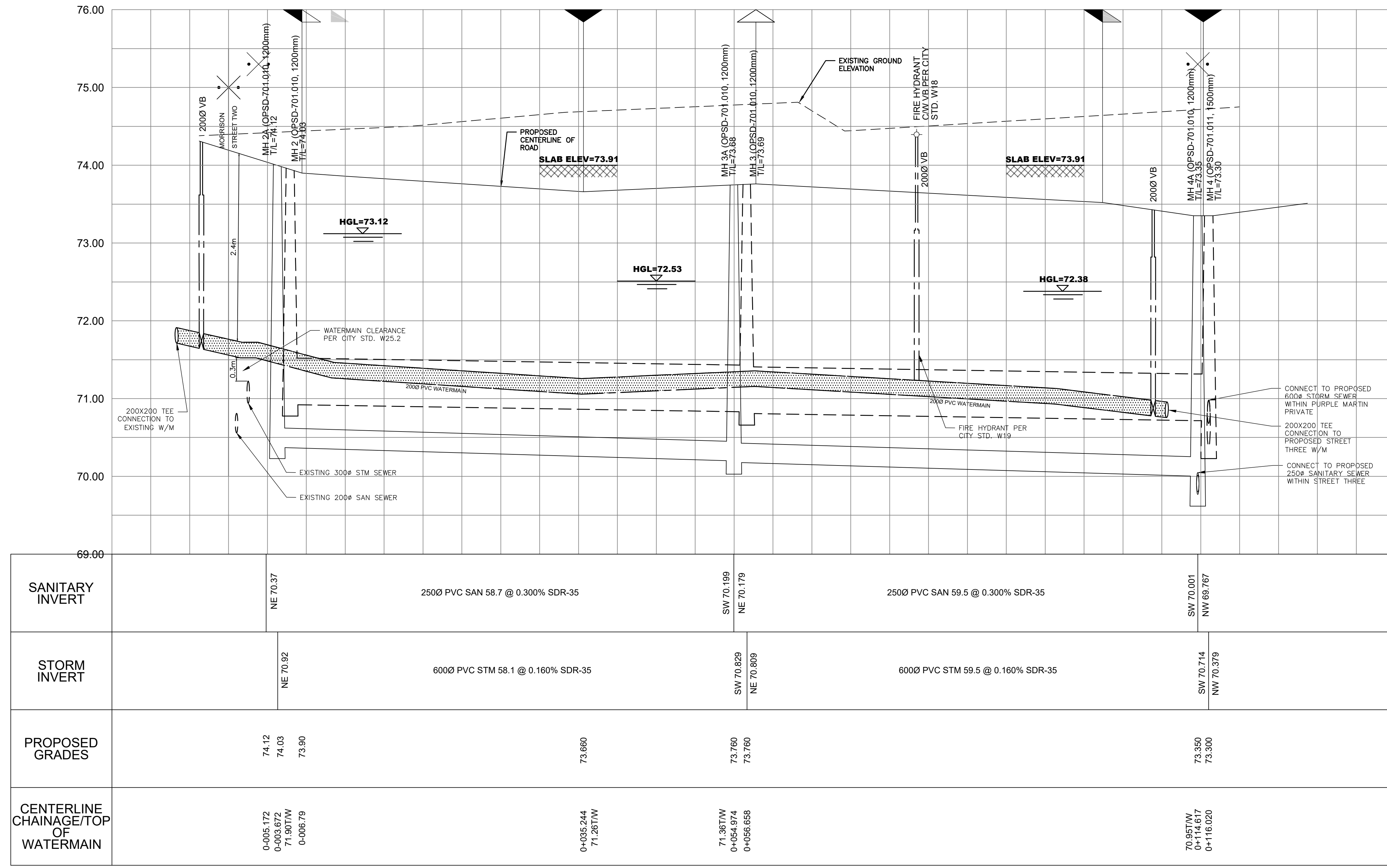

EXISTING UNDERGROUND SERVICES AND UTILITY LOCATIONS DERIVED FROM THE BEST AVAILABLE DATA, AS-CONSTRUCTED DRAWINGS, UTILITY DRAWINGS AND INFRASTRUCTURE MAPPING PROVIDED BY THE CITY OF OTTAWA.

CONTRACTOR TO CONFIRM ELEVATIONS AND LOCATIONS OF EXISTING UNDERGROUND SERVICES AND UTILITIES WITHIN THE RIGHT OF WAY PRIOR TO INSTALLATION OF SITE SERVICING INFRASTRUCTURE.

THE CONTRACTOR SHALL IMPLEMENT BEST MANAGEMENT PRACTICES, TO PROVIDE FOR PROTECTION OF THE AREA DRAINAGE SYSTEM AND THE RECEIVING WATERCOURSE, DURING CONSTRUCTION ACTIVITIES. THE CONTRACTOR ACKNOWLEDGES THAT THE FAILURE TO IMPLEMENT APPROPRIATE EROSION AND SEDIMENT CONTROL MEASURES MAY BE SUBJECT TO PENALTIES IMPOSED BY ANY APPLICABLE REGULATORY AGENCY.

TOPOGRAPHIC INFORMATION
TOPOGRAPHIC INFORMATION PROVIDED BY ANNIS, O'SULLIVAN, VOLLEBEKK LTD.
PROJ. NO. 19336-17
DATED MAY 16, 2017

SITE PLAN INFORMATION
SITE PLAN PROVIDED BY RODERICK LAHEY ARCHITECTS
PROJ. NO. 1020
RECEIVED/ISSUED AUGUST 2, 2018

GEOTECHNICAL STUDY
GEOTECHNICAL RECOMMENDATIONS PROVIDED BY PATERSON GROUP INC.
PROJ. NO. PG1630-3
DATED MAY 28, 2018 REVISION 4

SITE SERVICING AND STORMWATER MANAGEMENT STUDY
SERVICING AND STORMWATER MANAGEMENT RECOMMENDATIONS PROVIDED BY DSEL
PROJ. NO. 17-927
DATED AUGUST 2018

BENCH MARK
TOP OF FIRE SPINDLE LOCATED NORTH EAST OF THE SUBJECT SITE
ELEV=74.01m

No.	BY	YY.MM.DD	DESCRIPTION
11	A.J.G.	18.08.08	ISSUED FOR MUNICIPAL APPROVAL
10	A.J.G.	18.07.11	ISSUED FOR MUNICIPAL APPROVAL
9	A.J.G.	18.07.06	ISSUED FOR MUNICIPAL APPROVAL
8	A.J.G.	18.06.15	ISSUED FOR MUNICIPAL APPROVAL
7	A.J.G.	18.06.11	ISSUED FOR MUNICIPAL APPROVAL
6	A.D.F.	18.05.25	ISSUED FOR MUNICIPAL APPROVAL
5	A.J.G.	18.05.02	ISSUED FOR MUNICIPAL REVIEW
4	A.J.G.	18.03.23	ISSUED FOR MUNICIPAL REVIEW
3	A.J.G.	17.11.28	ISSUED FOR GEOTECHNICAL REVIEW
2	A.J.G.	17.11.17	ISSUED FOR MUNICIPAL REVIEW
1	A.J.G.	17.06.14	ISSUED FOR MUNICIPAL REVIEW

PROJECT No. 17-927

PLAN & PROFILE - FOLIAGE PRIVATE
FRESH TOWNS - 2710 DRAPER AVENUE PHASE 3-1 © DSEL

GREATWISE DEVELOPMENTS 333 Wilson Avenue, Suite 200
Toronto, Ontario, M3H 1T2

DSEL
david schaeffer engineering ltd
SMART SUBDIVISIONS™

120 Iber Road Unit 103
Stittsville, Ontario, K2S 1E9
Tel. (613) 836-0856
Fax. (613) 836-7183
www.DSEL.ca

DRAWN BY: A.J.G. CHECKED BY: R.D.F. DRAWING NO. SHEET NO.
DESIGNED BY: R.D.F. CHECKED BY: A.D.F. PP-2 7 of 8
SCALE: H 1:300 V 1:30 DATE: AUGUST 2018