

REFER TO PLAN 117193-STM1 FOR CONTINUATION OF DRAINAGE SUBCATCHMENT AREAS

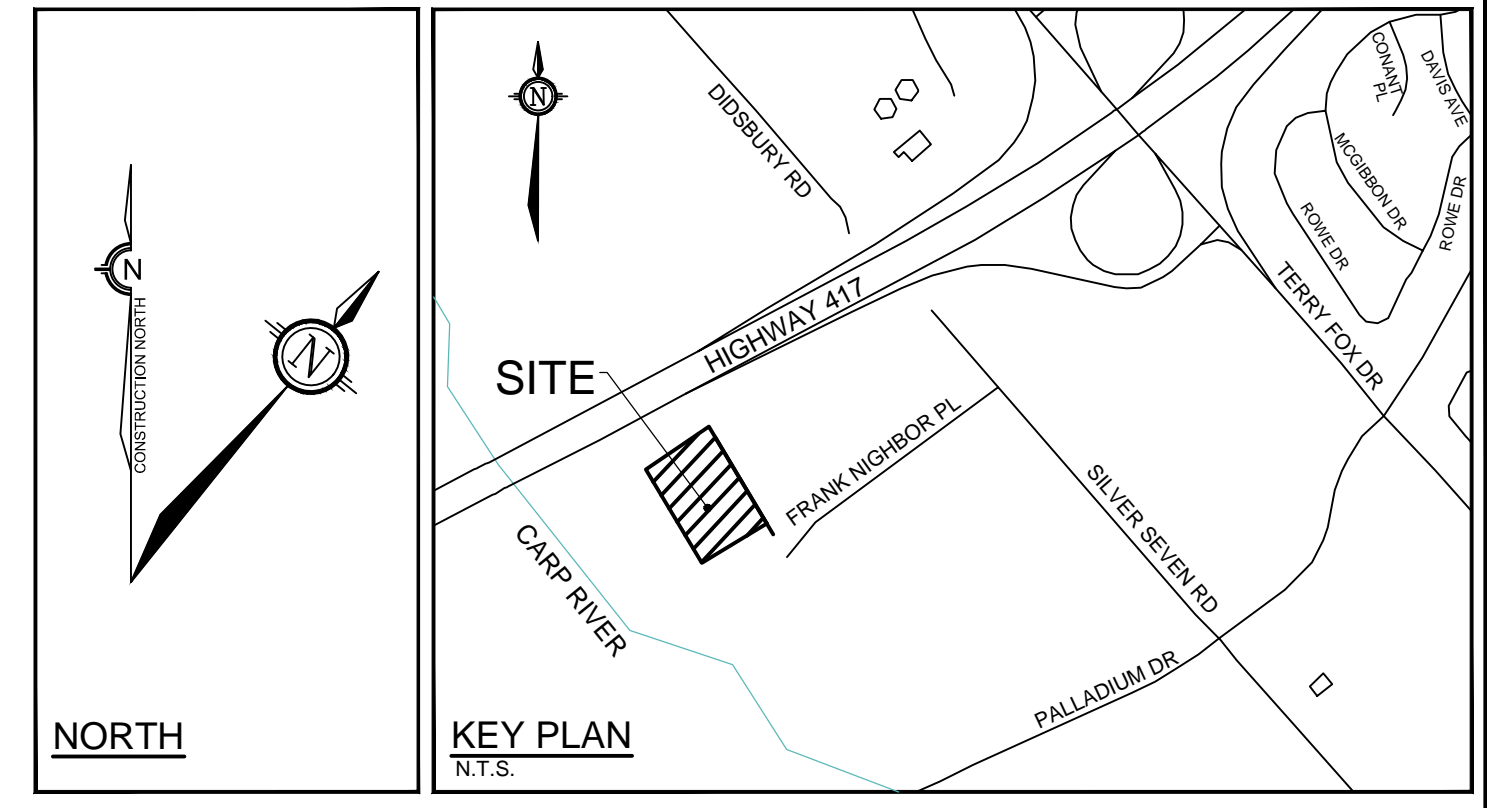

- LEGEND**
- PROPERTY LINE
 - POST-DEVELOPMENT DRAINAGE AREA (ha)
 - STRUCTURE ID (MH to MH)
 - 1.5 YEAR WEIGHTED RUNOFF COEFFICIENT
 - SUBCATCHMENT DRAINAGE AREA LIMITS
 - MAXIMUM 3:1 SIDESLOPE
 - EMERGENCY OVERLAND FLOW ROUTE
 - PROPOSED SANITARY MANHOLE
 - PROPOSED BUILDING ENTRANCE
 - CBMH 3 - PROPOSED CATCHBASIN MANHOLE c/w 3.0m RADIAL SUBDRAINS PER GETOTECH & SEWER
 - STM MH 1 - PROPOSED STORM MANHOLE & SEWER
 - CB - PROPOSED CATCHBASIN c/w 3.0m RADIAL SUBDRAINS PER GETOTECH AND LEAD
 - HYD - PROPOSED HYDRANT AND VALVE
 - DC - PROPOSED DEPRESSED CURB
 - ICD - PROPOSED INLET CONTROL DEVICE
 - RD - PROPOSED ROOF DRAIN
 - FFE=95.50 - PROPOSED FINISHED FLOOR ELEVATION
 - EXISTING CONCRETE CURB
 - EXISTING SANITARY MANHOLE
 - EXISTING CATCHBASIN MANHOLE
 - EXISTING STORM MANHOLE
 - EXISTING CATCHBASIN
 - EXISTING HYDRANT & VALVE
 - EXISTING TREES / VEGETATION
 - EXISTING UTILITY POLE C/W GUY WIRES
 - EXISTING FENCE
 - EXISTING LIGHT STANDARD

NOTE:
THE STORM DRAINAGE AREA PLANS ARE TO BE READ IN CONJUNCTION WITH THE STORM SEWER DESIGN SHEET LOCATED IN APPENDIX 'D' OF THE DEVELOPMENT SERVICING STUDY & STORMWATER MANAGEMENT REPORT (REFERENCE No. R-2018-011)

NOTE:
THE POSITION OF ALL POLE LINES, CONDUITS, WATERMANS, SEWERS AND OTHER UNDERGROUND AND OVERGROUND UTILITIES AND STRUCTURES IS NOT NECESSARILY SHOWN ON THE CONTRACT DRAWINGS, AND WHERE SHOWN, THE ACCURACY OF THE POSITION OF SUCH UTILITIES AND STRUCTURES IS NOT GUARANTEED. BEFORE STARTING WORK, DETERMINE THE EXACT LOCATION OF ALL SUCH UTILITIES AND STRUCTURES AND ASSUME ALL LIABILITY FOR DAMAGE TO THEM.

OWNER INFORMATION
20 FRANK NIGHBOR INC.
11266 FIFTH LINE
HALTON HILLS, ON, L7G 4S6
SUNNY BAINS
PHONE: 1-877-401-3423
sbains35@gmail.com

No.	REVISION	DATE	BY
2	REVISED PER MTO COMMENTS	AUG 19/18	FST
1	ISSUED FOR CITY APPROVAL	JUL 27/18	FST

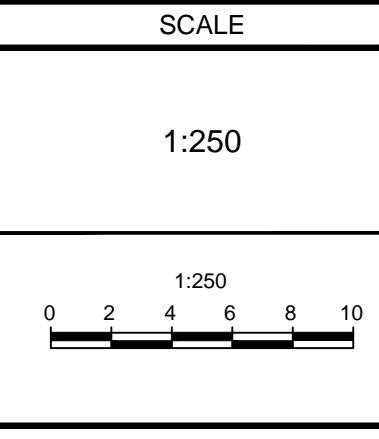

FOR REVIEW ONLY

DESIGN: SM / FST
CHECKED: FST
DRAWN: SM
CHECKED: SM / FST
APPROVED: FST

PROFESSIONAL ENGINEER
F.S. THAUETTE
100841599
Aug 19, 2018
PROVINCE OF ONTARIO

NOVATECH
Engineers, Planners & Landscape Architects
Suite 200, 240 Michael Cowpland Drive
Ottawa, Ontario, Canada K2M 1P6
Telephone: (613) 254-9643
Facsimile: (613) 254-5867
Website: www.novatech-eng.com

LOCATION
CITY OF OTTAWA
20 FRANK NIGHBOR PLACE - CAMP MART SITE

DRAWING NAME
STORM DRAINAGE AREA PLAN

PROJECT No. 117193
REV # 2
DRAWING No. 117193-STM2
#17578

M:\2017\117193-STM2\Drawings\117193-STM2.dwg, STM2, Aug 19, 2018 - 2:41pm, smathews