

PART B
 AREA = 10.10 AC
 TOTAL BUILDING AREA = 111,180 SF/ 10,329 SM
 (EXCLUDES 18,325 SF OUTDOOR)
 PARKING (EXCL. OUTDOOR CENTRE) = 516 (prov'd)

PART A
 AREA = 17.95 AC
 TOTAL BUILDING AREA = 201,855 SF/ 18,852 SM
 PARKING = 939 (prov'd)

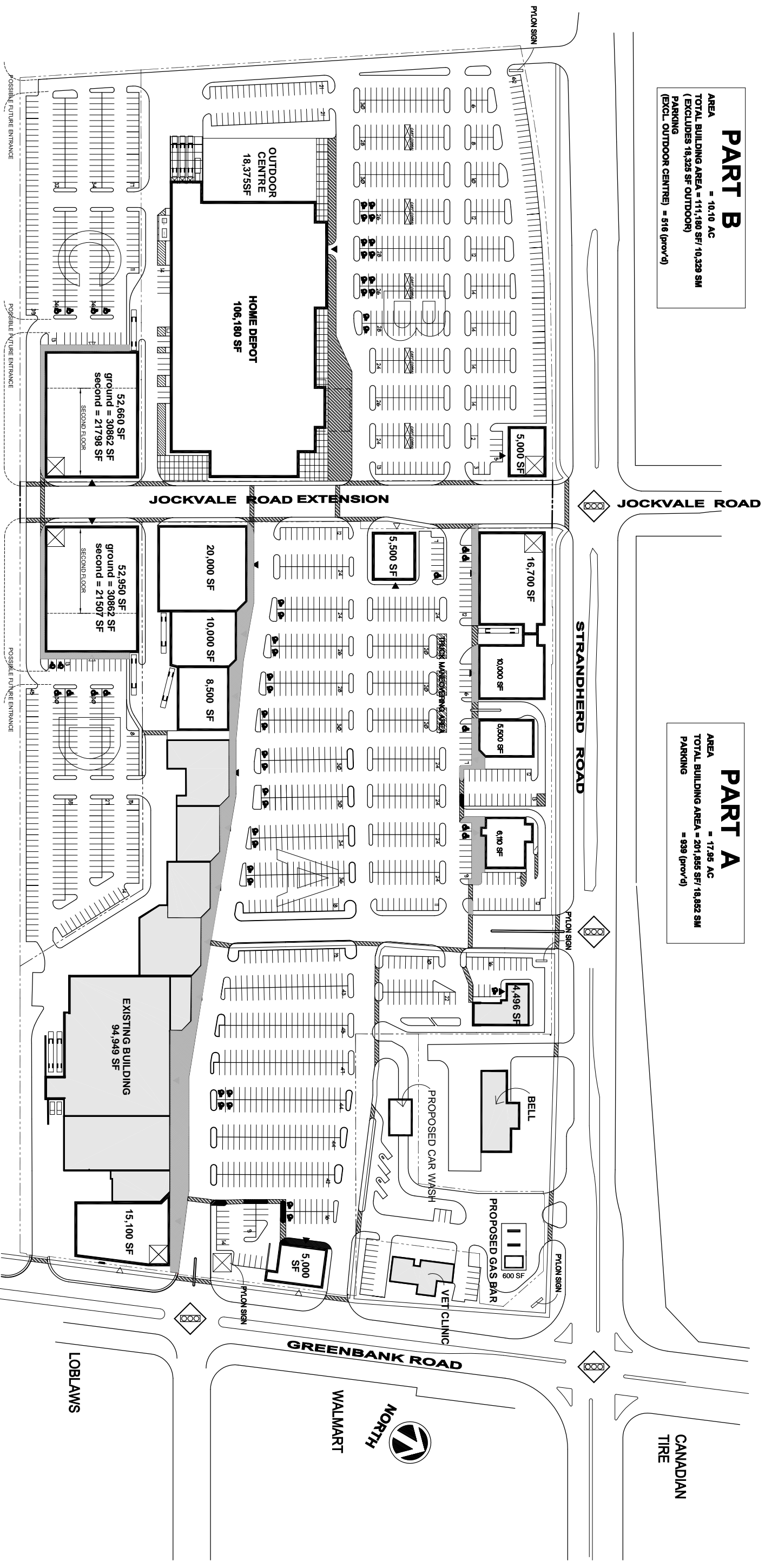

PART C
 AREA = 2.92 AC
 TOTAL BUILDING AREA = 30,862 SF (gnd) / 2867 SM (gnd)
 = 21,798 SF (2nd) / 2025 SM (2nd)
 PARKING = 218 (prov'd)

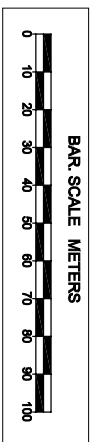

PART D
 AREA = 2.93 AC
 TOTAL BUILDING AREA = 30,862 SF (gnd) / 2867 SM (gnd)
 = 21,507 SF (2nd) / 1998 SM (2nd)
 PARKING = 217 (prov'd)

- LEGEND**
- ▲ MAIN ENTRANCE
 - △ SECONDARY ENTRANCE
 - ⊠ GATEWAY FEATURES
 - ▨ PAINTED NO PARKING LINENWORK
 - ▤ EXISTING BUILDING

TOTAL SITE STATISTICS
 PARTS A,B,C,D AREA = 33.9 AC
 TOTAL BUILDING AREA = 376,749 SF
 = 35,000 SM
 TOTAL PARKING = 1908

SITE INFORMATION PRELIMINARY

BARRHAVEN TOWN CENTRE INC.

BARRHAVEN TOWN CENTRE MASTER SITE PLAN
 NEPEAN ONTARIO



ALL AREAS, LOCATIONS, DIMENSIONS, DATA AND ALL OTHER INFORMATION ON THIS SCHEDULE ARE APPROXIMATE AND SHOULD BE USED AS A GUIDE TO MAKE ANY NECESSARY CHANGES TO THE LEASING PLAN.

9866-BARRHAVEN
53
 5 MAR 03