

M:\2017\117193\CAD\Design\Issued Drawings\20180528-Coord-TrafficComments\117193-BP.dwg, PM, May 28, 2018 - 3:20pm, smatthews

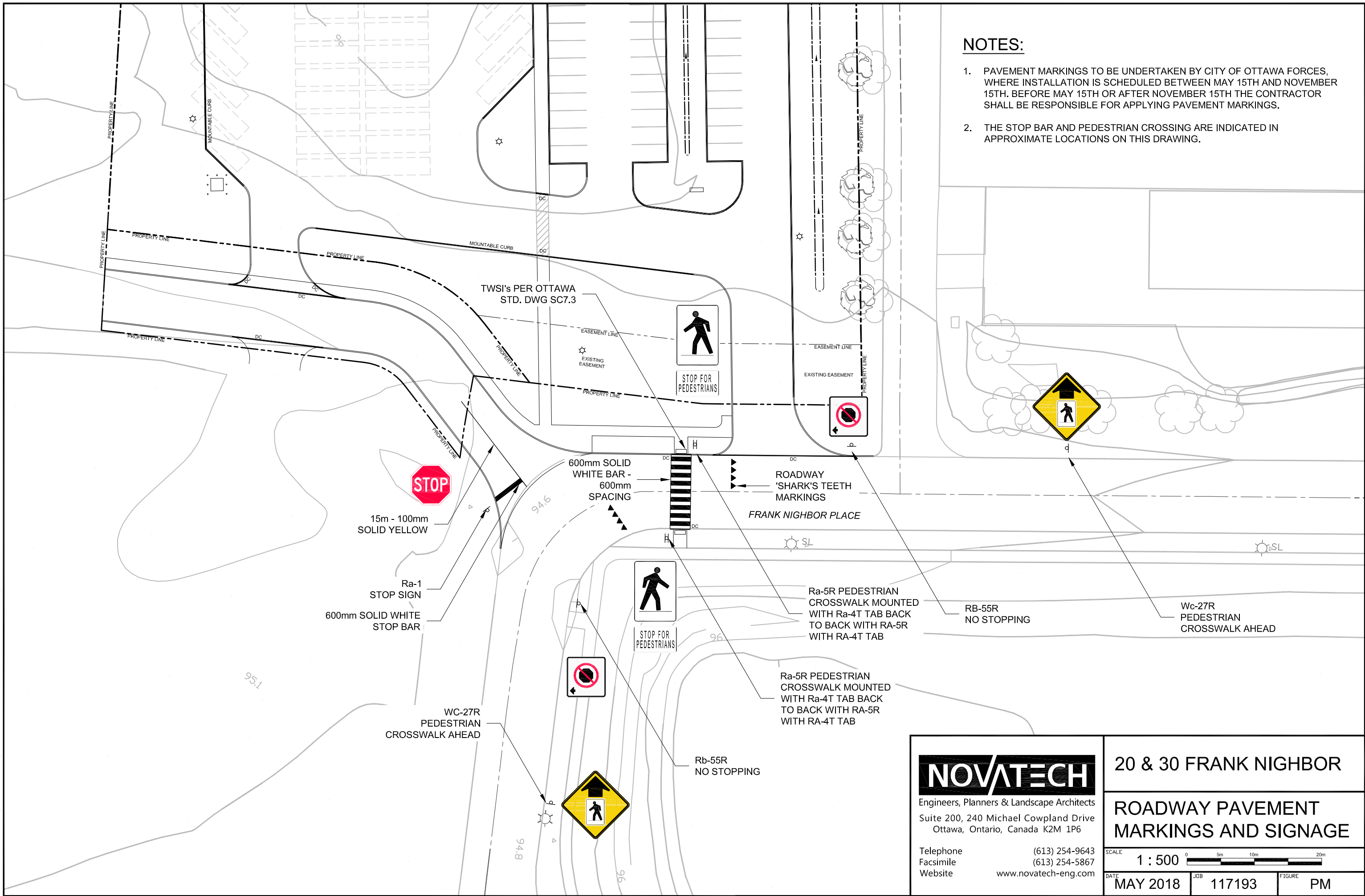

**NOTES:**

1. PAVEMENT MARKINGS TO BE UNDERTAKEN BY CITY OF OTTAWA FORCES, WHERE INSTALLATION IS SCHEDULED BETWEEN MAY 15TH AND NOVEMBER 15TH. BEFORE MAY 15TH OR AFTER NOVEMBER 15TH THE CONTRACTOR SHALL BE RESPONSIBLE FOR APPLYING PAVEMENT MARKINGS.
2. THE STOP BAR AND PEDESTRIAN CROSSING ARE INDICATED IN APPROXIMATE LOCATIONS ON THIS DRAWING.

 Engineers, Planners & Landscape Architects Suite 200, 240 Michael Cowpland Drive Ottawa, Ontario, Canada K2M 1P6  Telephone (613) 254-9643 Facsimile (613) 254-5867 Website www.novatech-eng.com	<b>20 &amp; 30 FRANK NIGHBOR</b>	
	<b>ROADWAY PAVEMENT MARKINGS AND SIGNAGE</b>	
SCALE 1 : 500		
DATE MAY 2018	JOB 117193	FIGURE PM

CUT 11 V17 DWG 270mm x 132mm