

STANDARD DECIDUOUS TREE PLANTING

D1

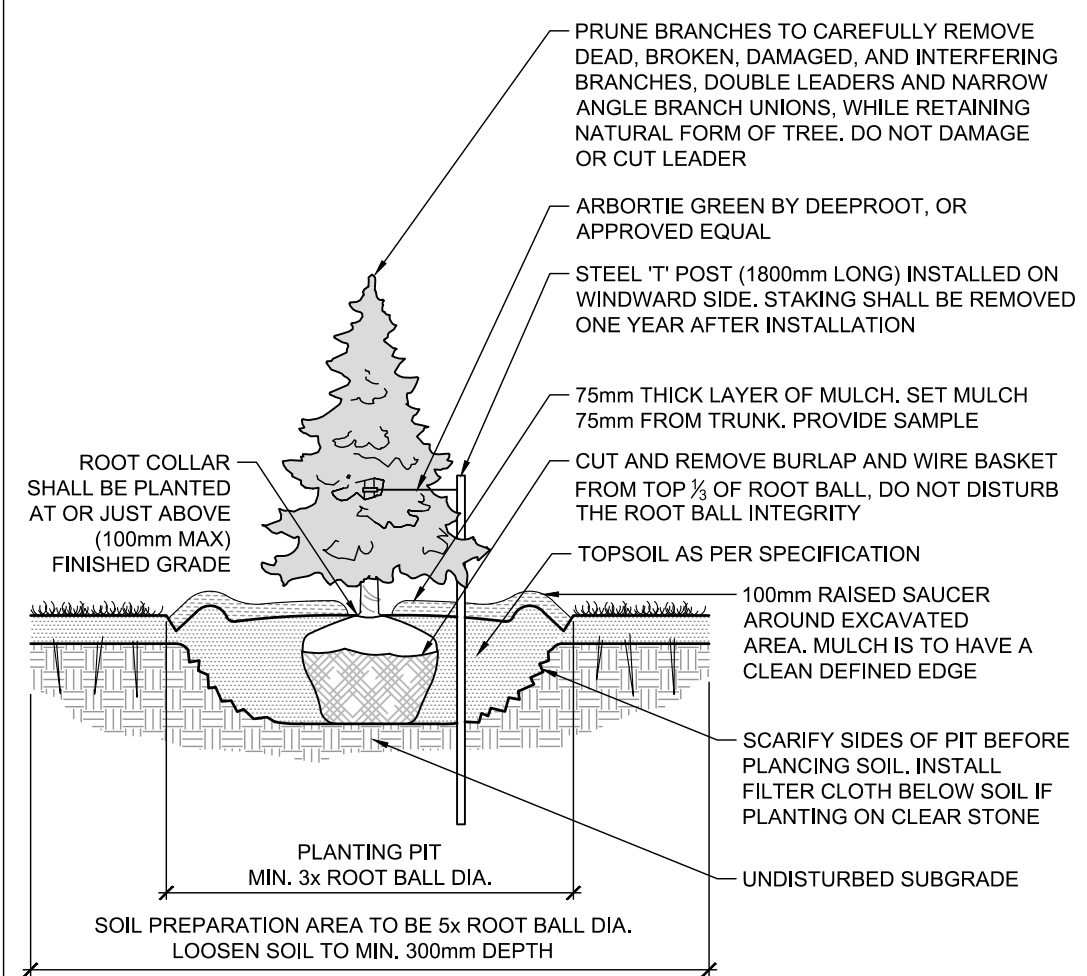

STANDARD CONIFEROUS TREE PLANTING

D2

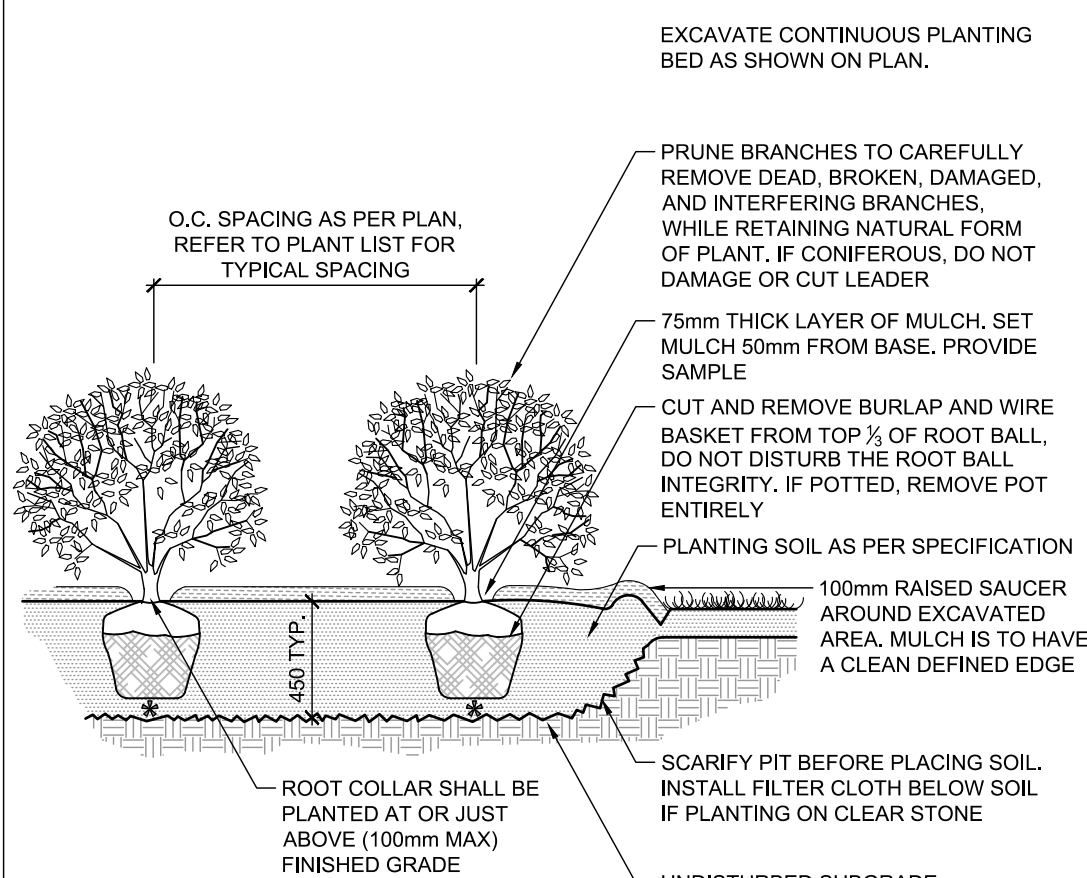

SHRUB AND PERENNIAL PLANTING

D3

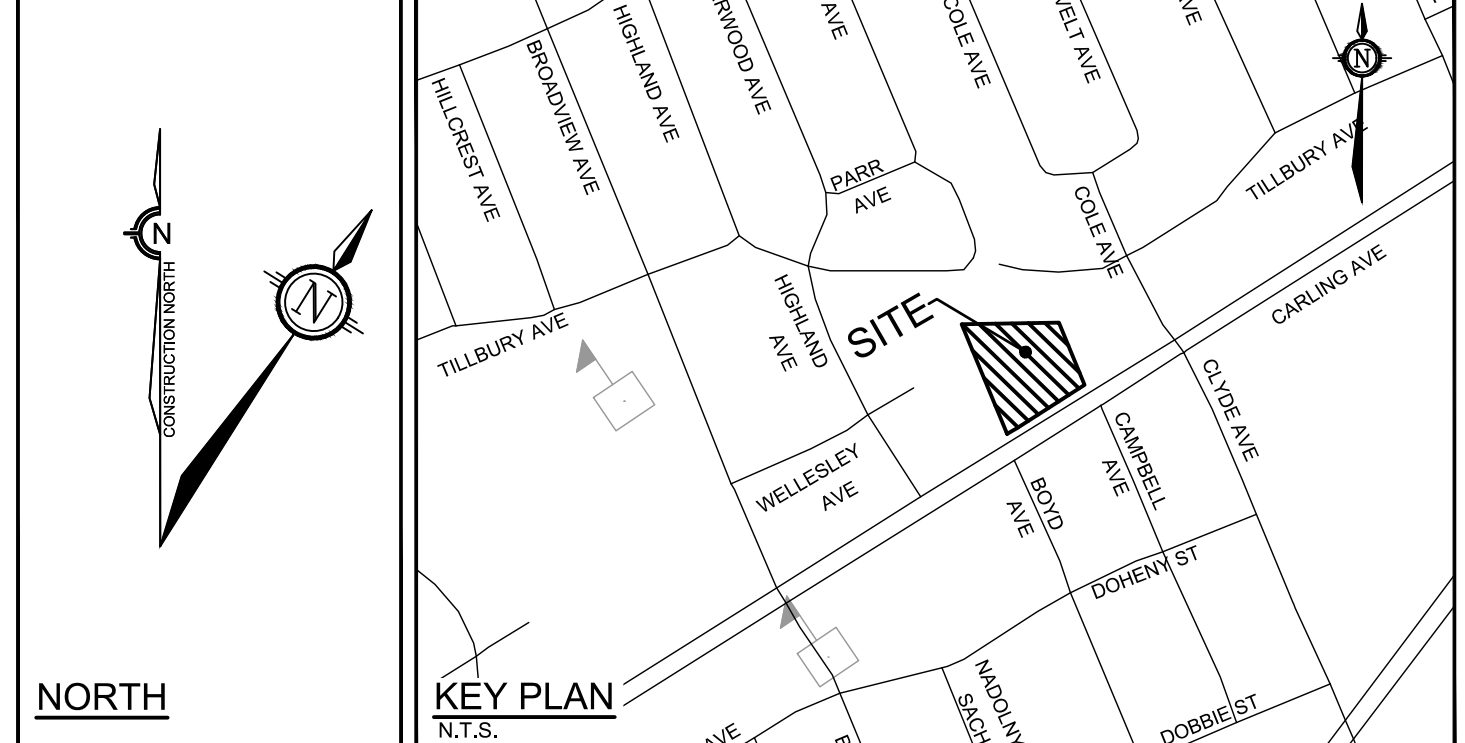
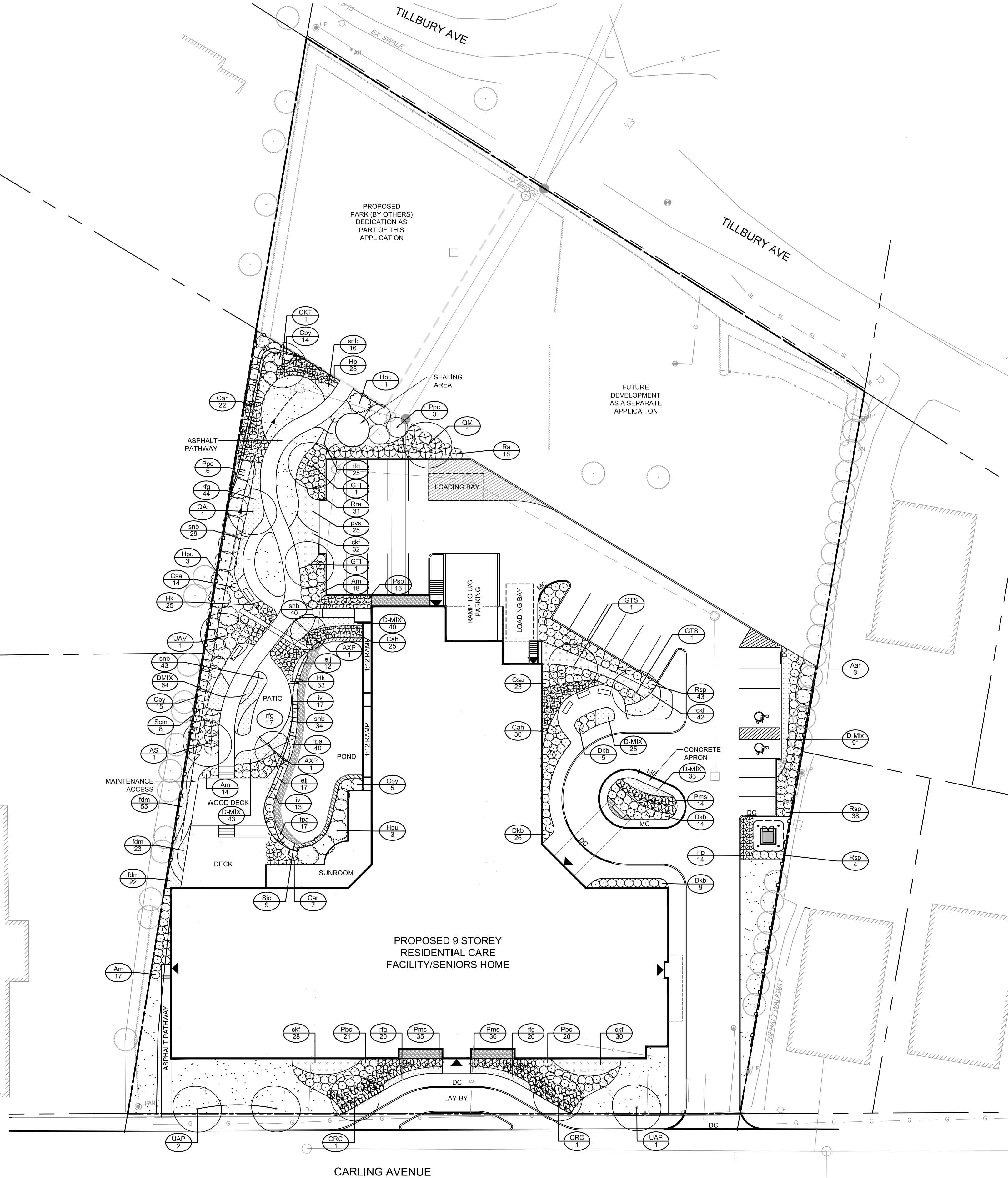

PLANTING NOTES

- This drawing shall be read in conjunction with all relevant Architectural, Engineering, and related drawings and documents.
- Refer to Engineering Drawings for Grading. Provide drainage as indicated in grading plan. Round all tops and toes of slopes, smoothly. Compact all areas to 95% Standard Proctor Density unless otherwise noted.
- Refer to Architectural Drawings for site layout.
- Refer to Engineering Drawings for site servicing.
- Contractor must contact utility companies for locates prior to excavation or planting.
- It is essential to use the plans and details in conjunction with the specifications and notes.
- Existing trees to be retained shall be protected according to the contract detail and specifications.
- Plant material shall be No. 1 Grade and shall comply with Canadian Standards for Nursery Stock (latest edition) published by the Canadian Nursery Landscape Association.
- Use plant material with strong fibrous root system free of disease, defects or injuries, and structurally sound. Use trees with straight trunks, well and characteristically branched for species. Obtain approval from consultant of plant material at source prior to digging. All trees and shrubs shall be container grown, potted, W/B or B/B, as indicated on Plant List. Bare root planting will only be acceptable for certain species and as approved by the Landscape Architect.
- Plant material substitutions shall not be permitted without the written approval from the consultant, with 48 hours notice, prior to shipping plant material.
- Plant locations are schematic / approximate only. Contractor shall stake out locations on site for approval by the Landscape Architect prior to installation. The illustrated number of plants shown in the Planting Plan supersedes the estimated number in the Plant List. Contractor to report any discrepancies to the Landscape Architect prior to installation. Contractor will assume full responsibility if the Landscape Architect is not notified.
- Shrubs, Perennials, Vines, and Groundcovers shall be planted in a continuous planting bed of 450mm depth with approved topsoil covered with 75mm depth shredded bark mulch.
- Ensure trees are thoroughly watered following planting. Monitor material and ensure adequate moisture until acceptance.
- In heavy clay or poorly drained soils, set root ball with root collar 75-100mm higher than finished grade.
- Sod and/or seed areas to receive 150mm depth topsoil as specified. Sod shall be No. 1 Kentucky Bluegrass Sod grown from minimum mixture of 3 Kentucky Bluegrass cultivars. Quality and source shall comply with Canadian Standards for Nursery Stock, Section 17, (latest edition) published by the Canadian Nursery Landscape Nursery Landscape Association. Unless otherwise specified, turf is to be maintained by the contractor until a second cutting is accepted by the Landscape Architect.
- Apply the following mineral fertilizer unless soil tests show other requirements: Sodded areas - (8-32-16) 8% Nitrogen, 32% Phosphorus, 16% Potash at a rate of 350kg/ha. - Planting Beds - (8-32-16) - 8% Nitrogen, 32% Phosphorus, 16% Potash as per manufacturer specifications.
- Reinstate all areas damaged or disturbed beyond the Limit of Work.

1705-1715 Carling Avenue - Plant List

KEY	QTY	BOTANICAL NAME	COMMON NAME	SIZE	COND	SPACING
Deciduous Trees						
AXP	2	Amelanchier x grandiflora 'Princess Diana'	Princess Diana Serviceberry	50mm Cal	WB	As Shown
CKT	1	Cladrastis kentukea	Yellowwood	50mm Cal	WB	As Shown
CRC	2	Crataegus crus-galli	Cockspur Hawthorn	50mm Cal	WB	As Shown
GTL	2	Gleditsia triacanthos var. inermis 'Impole'	Imperial Honeylocust	50mm Cal	WB	As Shown
GTS	2	Gleditsia triacanthos var. inermis 'Shademaster'	Shademaster Honeylocust	50mm Cal	WB	As Shown
QA	1	Quercus alba	White Oak	50mm Cal	WB	As Shown
QM	1	Quercus macrocarpa	Burr Oak	50mm Cal	WB	As Shown
UAP	3	Ulmus americana 'Princeton'	Princeton Elm	50mm Cal	WB	As Shown
UAV	1	Ulmus americana 'Valley Forge'	Valley Forge Elm	50mm Cal	WB	As Shown
Coniferous Shrubs						
Psm	1	Pinus mugo 'Slowmound'	Slowmound Mugo Pine	40cm Spr	PT	100cm O.C.
Deciduous Shrubs						
Aar	3	Amelanchier alnifolia 'Regent'	Regent Saskatoon Berry	100cm Ht	PT	175cm O.C.
Am	49	Aronia melanocarpa	Black Chokeberry	50cm Ht	PT	100cm O.C.
Cah	55	Clethra alnifolia 'Hummingbird'	Hummingbird Summersweet	50cm Ht	PT	80cm O.C.
Car	29	Clethra alnifolia 'Ruby Spice'	Ruby Spice Summersweet	50cm Ht	PT	100cm O.C.
Cby	34	Cornus sericea 'Bridal's Yellow'	Bridal's Yellow Dogwood	50cm Ht	PT	150cm O.C.
Csa	37	Cornus sericea 'Farrow'	Arctic Fire Dogwood	50cm Ht	PT	100cm O.C.
Dkb	54	Diervilla x Kodiak Black	Kodiak Black Honeysuckle	50cm Ht	PT	100cm O.C.
Hpu	7	Hydrangea paniculata 'Unique'	Unique Hydrangea	60cm Ht	PT	250cm O.C.
Hk	58	Hypericum kalmianum	St. John's Wort/Pot Of Gold	40cm Ht	PT	60cm O.C.
Hp	42	Hypericum prolificum	St. John's Wort/Pot Of Gold	50cm Ht	PT	80cm O.C.
Pbc	41	Physocarpus opulifolius 'Burgundy Candy'	Burgundy Candy Ninebark	60cm Ht	PT	100cm O.C.
Ppc	9	Physocarpus opulifolius 'Minka'	Copeland Ninebark	60cm Ht	PT	250cm O.C.
Psp	15	Physocarpus opulifolius 'Seward'	Summer Wine Ninebark	60cm Ht	PT	80cm O.C.
Ra	18	Rhus aromatica	Fragrant Sumac	60cm Ht	PT	150cm O.C.
Rsp	85	Rosa 'Snow Pavement' (Schneekoope)	Snow Pavement Rose	60cm Ht	PT	100cm O.C.
Scm	8	Sambucus canadensis 'Maxima'	Maxima Elderberry	60cm Ht	PT	180cm O.C.
Sic	9	Stephanandra incisa 'Crispa'	Cutleaf Stephanandra	40cm Ht	PT	100cm O.C.
Perennials						
Idm	100	Dryopteris marginalis	Marginal Wood Fern	1g	PT	45cm O.C.
ej	29	Eupatorium dubium 'Little Joe'	Little Joe-Pye Weed	1g	PT	60cm O.C.
D-MX	296	Hemerocallis sp. *	Daylily Mix	1g	PT	45cm O.C.
iv	30	Iris versicolor	Blue Flag Iris	1g	PT	50cm O.C.
ipa	57	Polystichum acrostichoides	Christmas Fern	1g	PT	40cm O.C.
rg	126	Rudbeckia fulgida 'Goldsturm'	Goldsturm Coneflower	1g	PT	60cm O.C.
snb	162	Salvia nemorosa 'Blaukoenigin'	Blue Queen Meadow Sage	1g	PT	45cm O.C.
Ornamental Grasses						
ckf	132	Calamagrostis acutiflora 'Karl Foerster'	Karl Foerster Feather Reed Grass	1g	PT	75cm O.C.
pvs	25	Panicum virgatum 'Shenandoah'	Shenandoah Switch Grass	1g	PT	75cm O.C.

* to be divided equally between Hemerocallis 'Frans Hals' and Hemerocallis 'Sammy Russell'

NOTE:
THE POSITION OF ALL POLE LINES, CONDUITS, WATERMAINS, SEWERS AND OTHER UNDERGROUND AND OVERGROUND UTILITIES AND STRUCTURES IS NOT NECESSARILY SHOWN ON THE CONTRACT DRAWINGS, AND WHERE SHOWN, THE ACCURACY OF THE POSITION OF SUCH UTILITIES AND STRUCTURES IS NOT GUARANTEED. BEFORE STARTING WORK, DETERMINE THE EXACT LOCATION OF ALL SUCH UTILITIES AND STRUCTURES AND ASSUME ALL LIABILITY FOR DAMAGE TO THEM.

NOT FOR CONSTRUCTION

No.	REVISION	DATE	BY
1.	SITE PLAN APPLICATION	APR 20/18	RJ

SCALE

1:300

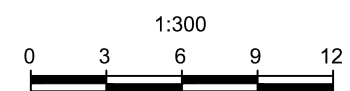

DESIGN

DESIGNED	KW
CHECKED	RJ
DRAWN	KW
CHECKED	RJ
APPROVED	RJ

FOR REVIEW ONLY

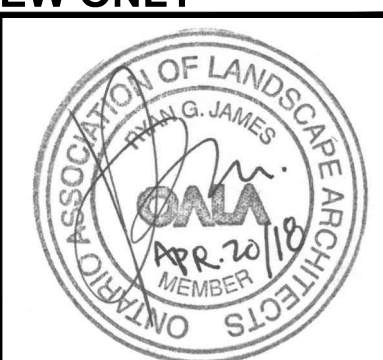

NOVATECH
Engineers, Planners & Landscape Architects
Suite 200, 240 Michael Cowpland Drive
Ottawa, Ontario, Canada K2M 1P6
Telephone (613) 254-9643
Facsimile (613) 254-5867
Website www.novatech-eng.com

LOCATION
CITY OF OTTAWA
THE FOUNDERS RESIDENCES, WESTBORO

DRAWING NAME
LANDSCAPE PLAN

PROJECT No.	117216-00
REV	REV # 1
DRAWING No.	117216-L1