

RECTANGULAR PRECAST PLANTER

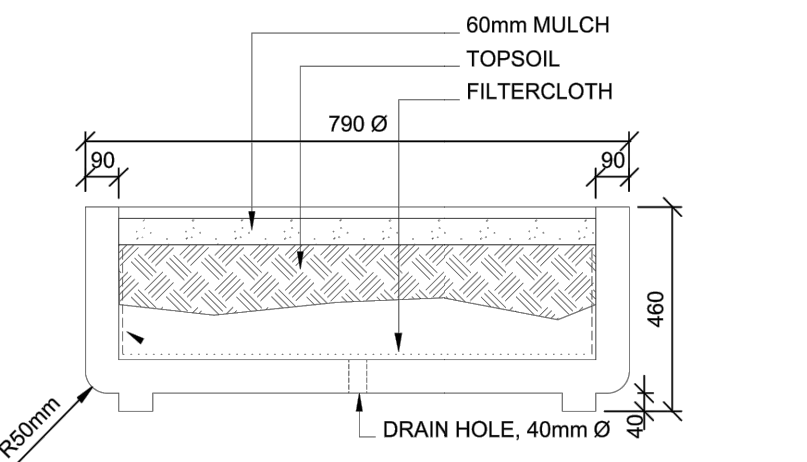

CROSS SECTION
CIRCULAR PRECAST PLANTER

ROCKERY WITH PERENNIALS

CANADIAN NATIONAL AND CANADIAN
PACIFIC RAILWAY RIGHT-OF-WAY

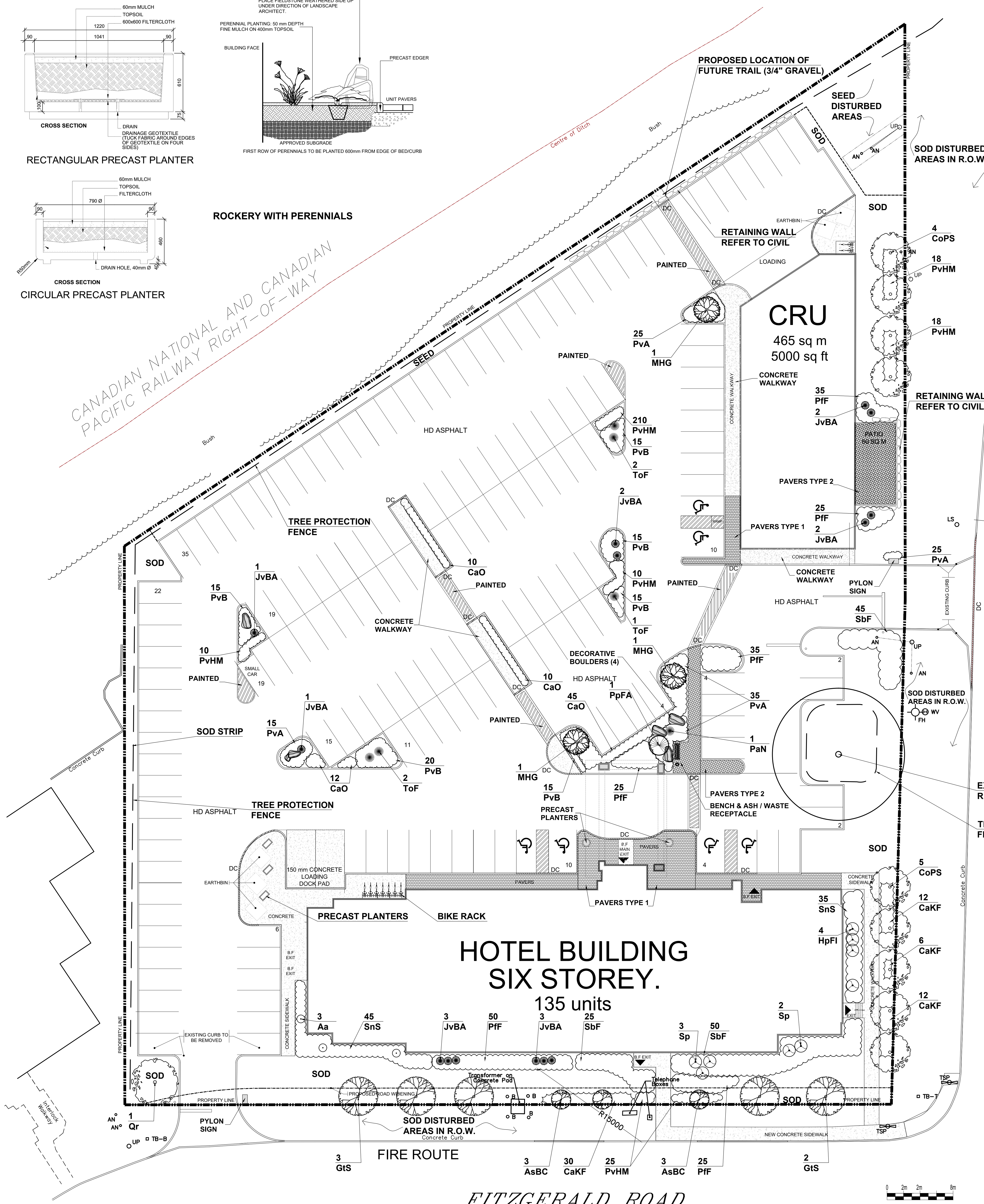

Plant List					
ID	Qty	Botanical Name	Common Name	Scheduled Size	Remarks
Trees					
AsBC	6	Acer saccharum 'Barrett Cole'	Apollo Sugar Maple	50mm cal.	WB, Staked
CoPS	9	Celtis occidentalis 'Prairie Sentinel'	Prairie Sentinel Hackberry	70mm cal.	WB, Staked
GtS	5	Gleditsia triacanthos 'Shademaster'	Shademaster Honeylocust	70mm cal.	WB, Staked
MHG	3	Malus x 'Harvest Gold'	Harvest Gold Crabapple	50mm cal.	WB, Staked
PpFA	1	Picea pungens 'Fat Albert'	Fat Albert Spruce	1750mm ht.	B&B / Potted
Qr	1	Quercus rubra	Red Oak	70mm caliper	B&B, Staked
Large Shrubs					
Aa	3	Amelanchier alnifolia	Saskatoon Berry	125cm ht.	B&B / Potted
JvBA	12	Juniperus scopulorum 'Blue Arrow'	Blue Arrow Juniper	125cm ht.	B&B / Potted
PaN	1	Picea abies 'Nidiformis'	Dwarf Nest Spruce	50cm spd.	B&B / Potted
Sp	5	Syringa prestoniae	Preston Lilac	125cm ht.	Potted
ToF	5	Thuja occidentalis fastigiata	Pyramidal White Cedar	125cm ht.	B&B / Potted
Shrubs					
HpFI	4	Hydrangea Fire and Ice	Hydrangea Fire and Ice	50cm ht.	Potted
PfF	195	Potentilla fruticosa 'Farreni'	Gold Drop Potentilla	50cm ht.	Potted
SbF	120	Spiraea bumalda 'Froebeli'	Froebel's Spirea	50cm ht.	Potted
SnS	80	Spiraea nipponica 'Snowmound'	Snowmound Spirea	50cm ht.	Potted, 0.9m o.c.
Perennials					
CaKF	60	Calamagrostis acutiflora 'Karl Foerster'	Karl Foerster Feather Reed Grass	1 gallon Pot	80cm o.c.
CaO	77	Calamagrostis acutiflora 'Overdam'	Overdam Feather Reed Grass	1 gallon Pot	80cm o.c.
PvA	100	Flowering perennials Type 1		150mm Pot	60cm o.c.
PvB	95	Flowering perennials Type 2		150mm Pot	60cm o.c.
PvHM	91	Panicum virgatum 'Heavy Metal'	Heavy Metal Switch Grass	1 gallon Pot	75cm o.c.

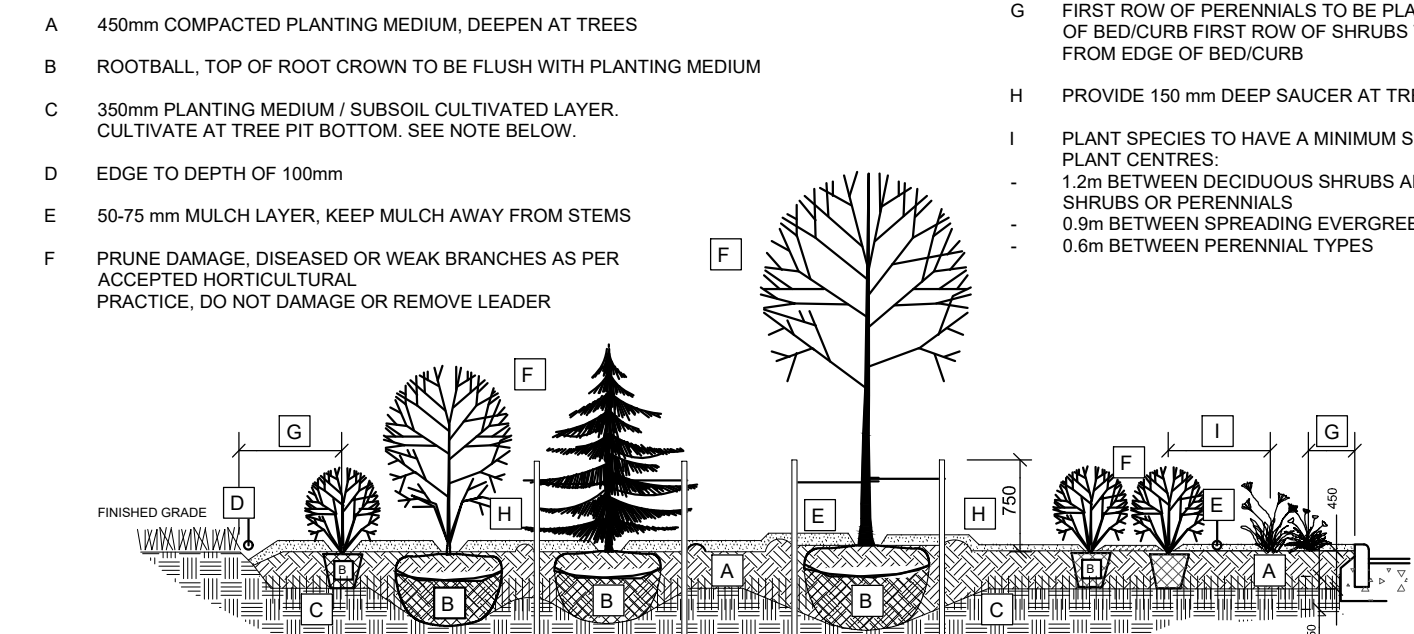

- PLANTING BED DETAIL ON GRADE**
- NOTE: PLANTING BED AREAS: EXCAVATE TO 500mm BELOW FINAL GRADE TO ACHIEVE ROUGH GRADE ELEVATION. WHERE GRAVEL IS ENCOUNTERED ROUGH GRADE LEVEL TO BE 1000mm BELOW FINAL GRADE. PLACE APPROVED SUBSOIL IN THESE LOCATIONS TO OBTAIN PLANTING MEDIUM DEPTH. PLACEMENT OF SUBSOIL TO BE PAID AT UNIT PRICE PER m³ OF SUBSOIL PLACED MEASURED ON SITE.
- A 450mm COMPACTED PLANTING MEDIUM, DEEPEN AT TREES
B ROOTBALL, TOP OF ROOT CROWN TO BE FLUSH WITH PLANTING MEDIUM
C 300mm PLANTING MEDIUM / SUBSOIL CULTIVATED LAYER
D 100mm PLANTING MEDIUM / SUBSOIL CULTIVATED LAYER
E 50-75mm MULCH LAYER, KEEP MULCH AWAY FROM STEMS
F PRUNE DAMAGE, DISEASED OR WEAK BRANCHES AS PER ACCEPTED HORTICULTURAL PRACTICE, DO NOT DAMAGE OR REMOVE LEADER
G FIRST ROW OF PERENNIALS TO BE PLANTED 600mm FROM EDGE OF BED/CURB FIRST ROW OF SHRUBS TO BE PLANTED 900mm FROM EDGE OF BED/CURB
H PROVIDE 150mm DEEP SAUCER AT TREES
I PLANT SPECIES TO HAVE A MINIMUM SEPARATION BETWEEN PLANT CENTRES
J 1.2m BETWEEN DECIDUOUS SHRUBS AND SPREADING EVERGREEN SHRUBS OR PERENNIALS
K 0.9m BETWEEN SPREADING EVERGREEN SHRUBS AND PERENNIALS
L 0.6m BETWEEN PERENNIAL TYPES

- PLANTING IN MEDIAN**
- PLACE FENCE AT EDGE OF TREE PRESERVATION ZONE (CRZ)
- 38x38x2400mm STEEL POST
1200mm PLASTIC SNOW FENCE
- EXISTING TREES
- LIMIT OF CONST. EXCAVATION
ROOT PROTECTION ZONE
EDGE OF TREE PRESERVATION
- PROTECTION FENCE
FENCE FABRIC TO EXTEND DOWN TO BELOW FILTER FABRIC
- EXISTING TREE
38x38x2400mm T RAIL 3000 O.C. MAX
1200mm PLASTIC SNOW FENCE (ORANGE), PLACED 2500mm ABOVE GRADE
- EXISTING TREE
38x38x2400mm T RAIL 3000 O.C. MAX
1200mm PLASTIC SNOW FENCE (ORANGE), PLACED 2500mm ABOVE GRADE
- EXISTING TREE
38x38x2400mm T RAIL 3000 O.C. MAX
1200mm PLASTIC SNOW FENCE (ORANGE), PLACED 2500mm ABOVE GRADE

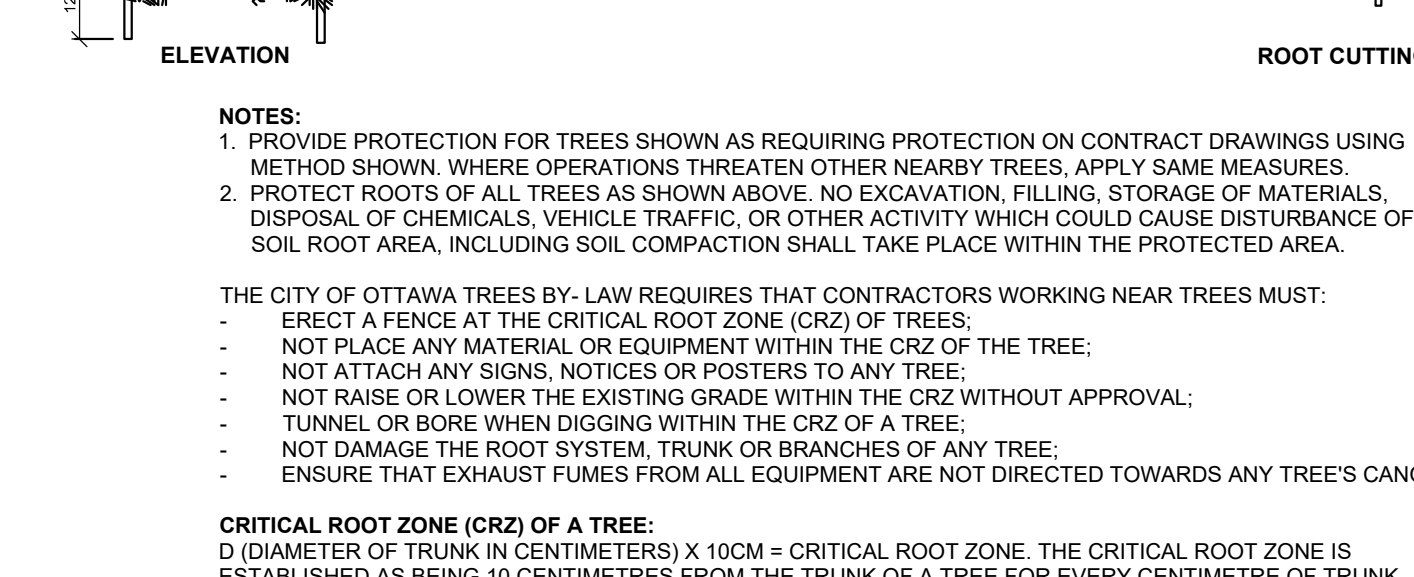
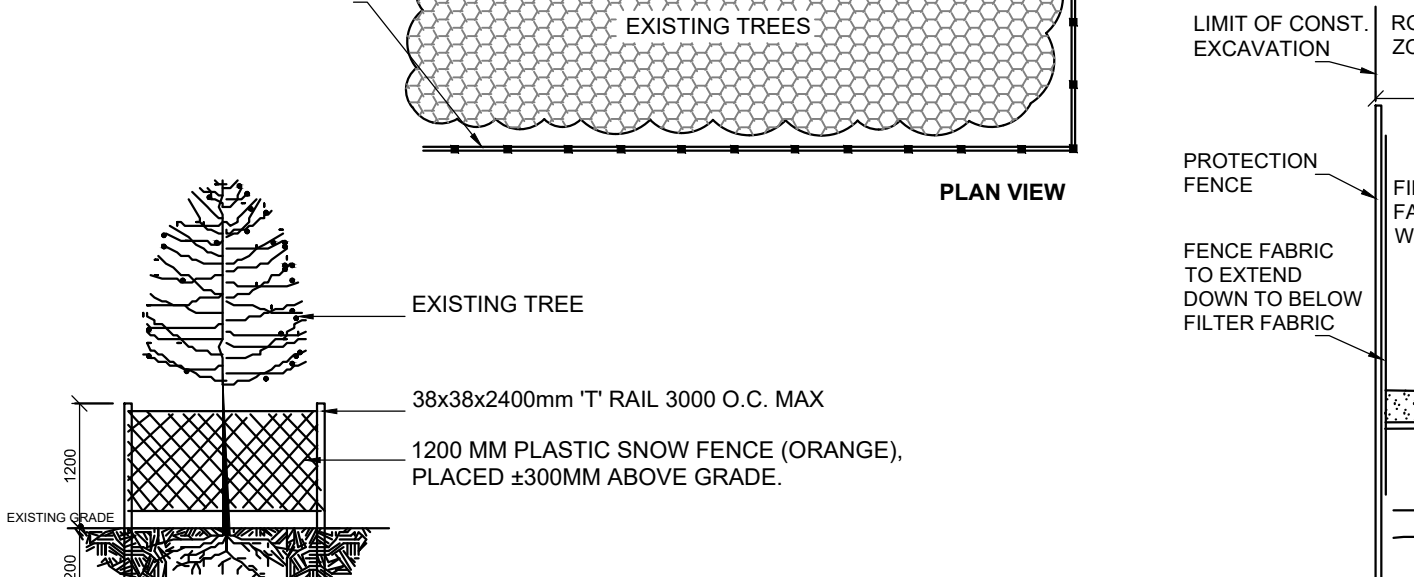
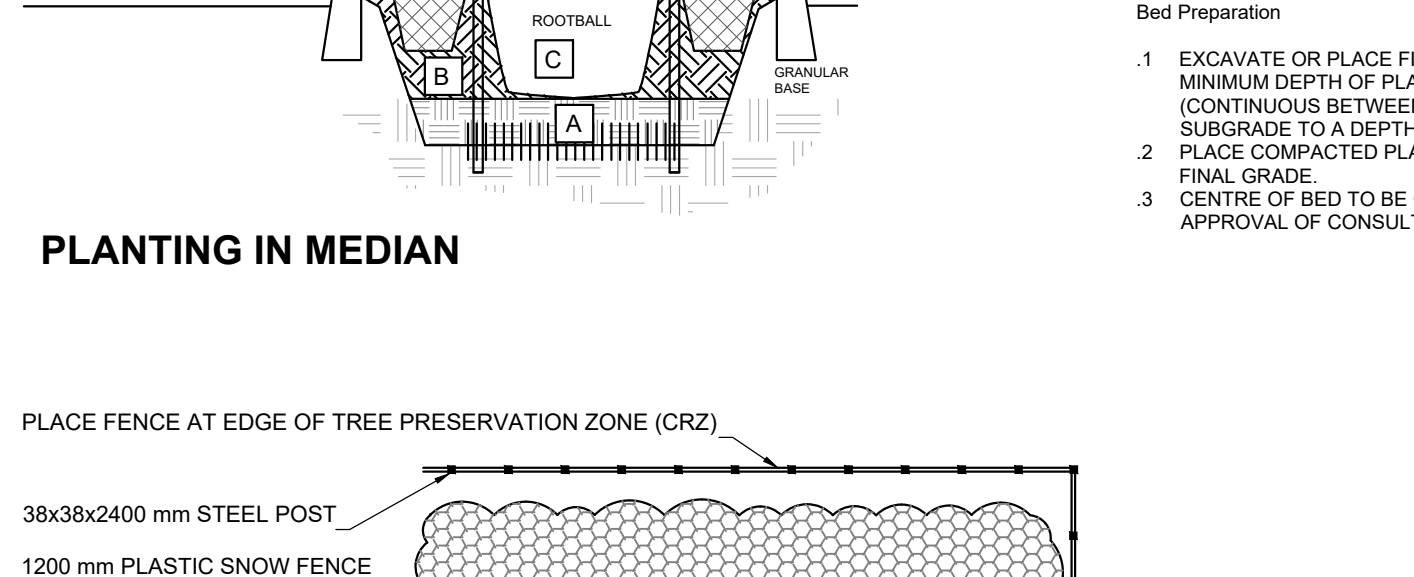
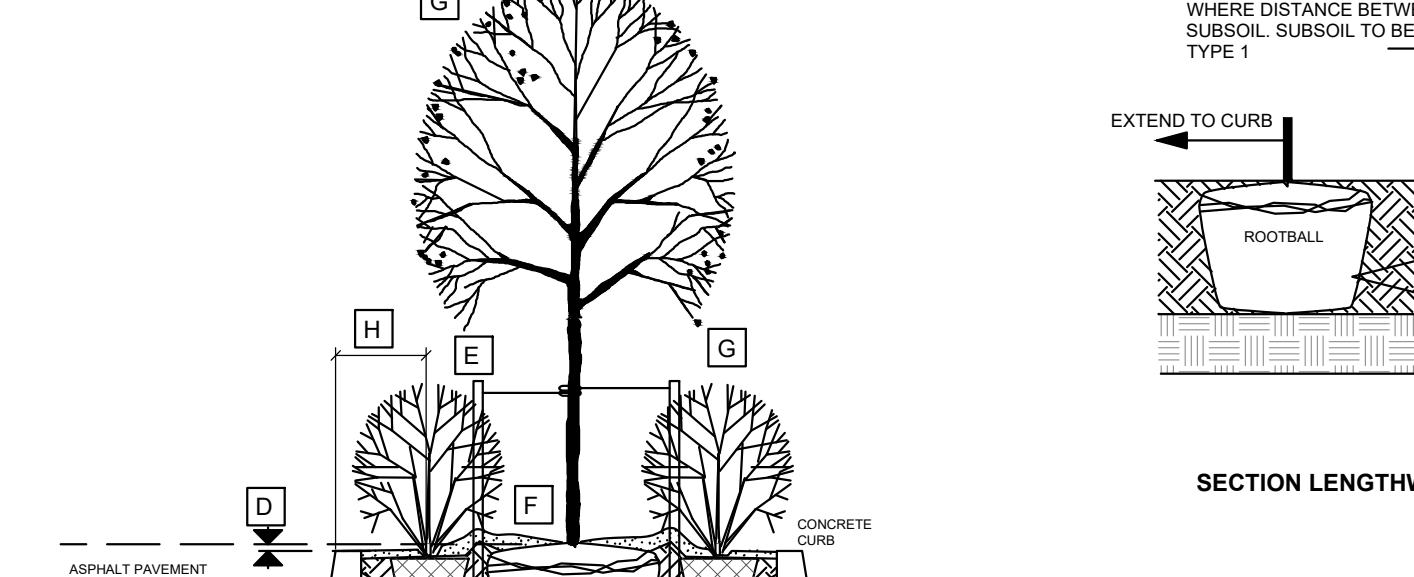
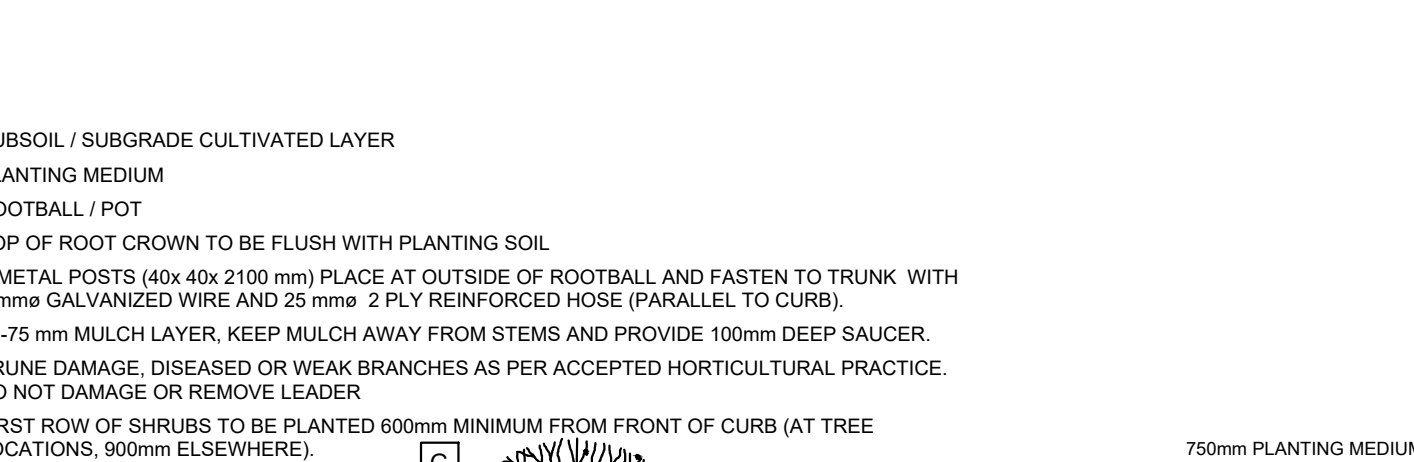

TREE PROTECTION AND ROOT CUTTING DETAIL

NOTES:

- PROVIDE PROTECTION FOR TREES SHOWN AS REQUIRING PROTECTION ON CONTRACT DRAWINGS USING METHOD SHOWN. WHERE OPERATIONS THREATEN OTHER NEARBY TREES, APPLY SAME MEASURES.
- PROTECT ROOTS OF ALL TREES AS SHOWN ABOVE. NO EXCAVATION, FILLING, STORAGE OF MATERIALS, DISPOSAL OF CHEMICALS, VEHICLE TRAFFIC, OR OTHER ACTIVITY WHICH COULD CAUSE DISTURBANCE OF SOIL ROOT AREA, INCLUDING SOIL COMPACTION SHALL TAKE PLACE WITHIN THE PROTECTED AREA.

THE CITY OF OTTAWA TREES BY-LAW REQUIRES THAT CONTRACTORS WORKING NEAR TREES MUST:

- ERECT A FENCE AT THE CRITICAL ROOT ZONE (CRZ) OF TREES.
- NOT PLACE ANY MATERIAL OR EQUIPMENT WITHIN THE CRZ OF THE TREE.
- NOT ATTACH ANY SIGNS, NOTICES OR POSTERS TO ANY TREE.
- NOT RAISE OR LOWER THE EXISTING GRADE WITHIN THE CRZ WITHOUT APPROVAL.
- TUNNEL OR BORE WHEN DIGGING WITHIN THE CRZ OF A TREE.
- NOT DAMAGE THE ROOT SYSTEM, TRUNK OR BRANCHES OF ANY TREE.
- ENSURE THAT EXHAUST FUMES FROM ALL EQUIPMENT ARE NOT DIRECTED TOWARDS ANY TREE'S CANOPY.

CRITICAL ROOT ZONE (CRZ) OF A TREE:
D (DIAMETER OF TRUNK IN CENTIMETERS) X 10CM = CRITICAL ROOT ZONE. THE CRITICAL ROOT ZONE IS ESTABLISHED AS BEING 10 CENTIMETRES FROM THE TRUNK OF A TREE FOR EVERY CENTIMETRE OF TRUNK DIAMETER. THE TRUNK DIAMETER IS MEASURED AT A HEIGHT OF 1.2 METRES FOR TREES OF 15 CENTIMETRES DIAMETER AND GREATER AND AT A HEIGHT OF 0.3 METRES FOR TREES OF LESS THAN 15 CENTIMETRES DIAMETER. THE CONTRACTOR MUST OBTAIN ALL PERMITS AND APPROVALS PRIOR TO THE START OF CONSTRUCTION. THE CONTRACTOR MUST CALL A CITY TREE INSPECTOR WHEN WORK IS REQUIRED NEAR A CITY TREE.

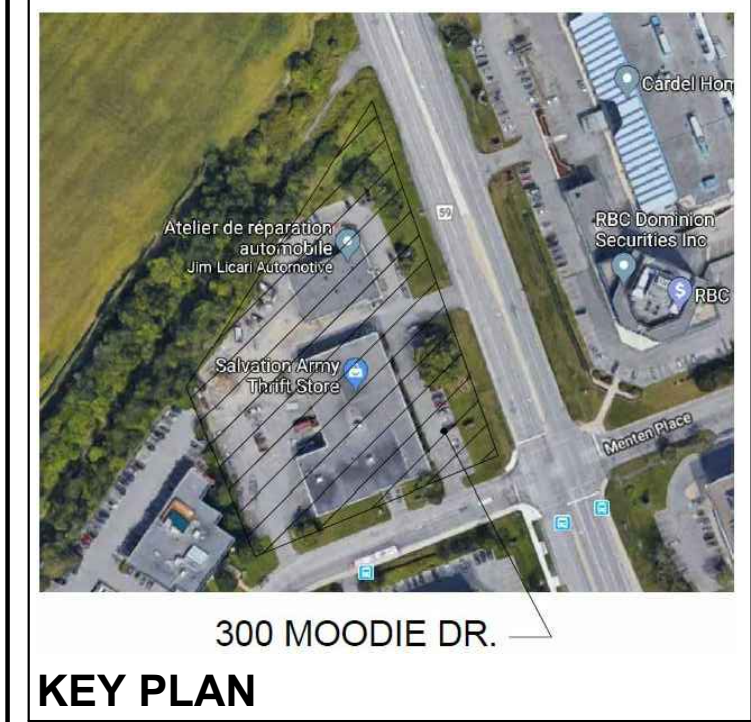

KEY PLAN

3		
2	Issued for Site Plan Control	Apr. 16/18
1	for review	Apr. 09/18
no.	issue / revision	date

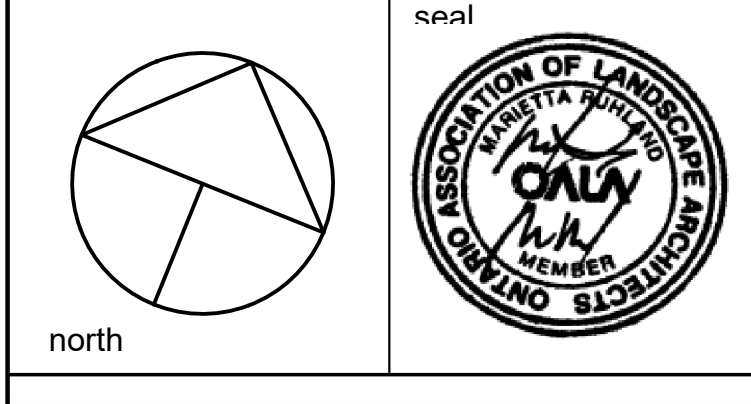

project	HAMPTON INN 300 MOODIE DR.	
drawing title	LANDSCAPE PLAN	
scale	drawn by M. Malkov	designed by R. Ruhland
1:200	checked by R. Ruhland	plot date Mar. 23/18
date October, 2016	project number 18 - 11556	drawing number L - 01
Contractor to check and verify all dimensions on the job		