

TURF AREAS TO BE SOD C/W 150MM DEPTH TOPSOIL ON APPROVED SUBGRADE.
 SOD TO BE NUMBER ONE GRADE TURFGRASS NURSERY SOD per NSGA - Fine Fescue/Kentucky Bluegrass Sod.
 PLANTING MIX TO BE APPROVED BY LANDSCAPE ARCHITECT.
 ALL PLANT MATERIAL TO MEET CNLA STANDARDS, AND BE APPROVED BY LANDSCAPE ARCHITECT PRIOR TO PLANTING.
 REFER TO CIVIL ENGINEER'S DRAWING FOR ELEVATIONS / GRADING.
 ALL WORK TO INCLUDE 1 YEAR WARRANTY FROM DATE OF FINAL ACCEPTANCE.

MAINTAIN ALL AREAS UNTIL FINAL ACCEPTANCE, INCLUDING MOWING OF TURF, WEEDING OF BEDS, WATERING, SWEEPING HARD SURFACES.
 PROVIDE WATERING OF ALL TURF AND PLANT MATERIAL AS REQUIRED FOR PROPER ESTABLISHMENT, UNTIL END OF WARRANTY PERIOD.

The Landscape Plan is to be read in conjunction with the grading and survey plan, underground services engineering drawings, construction details and contract documents and cannot be used for construction until signed by the landscape architect. Bare root material to be planted in season only. All plant material locations to be staked on site by the landscape contractor and checked by the landscape architect prior to planting. All trees to be preserved on or directly adjacent to the site will be protected. Plant material are to be installed a minimum of: 3.0m away from any part of any hydro transformer, 3.0m corridor between a fire hydrant and the curb, a 2.5m radius beside or behind a fire hydrant, 2.0m from any servicing/utility line or structure.

Plant List - Trees - A & W Loblaws Plaza Merivale Road				
Code	Qty.	Botanical Name	Common Name	Condition
AC	8	Amelanchier canadensis	Tree Serviceberry	60mm cal B + B specimen
AR	1	Acer rubrum	Red Maple	60mm cal B + B specimen
AS	1	Acer saccharum	Sugar Maple	60mm cal B + B specimen
CO	1	Celtis occidentalis	Common Hackberry	60mm cal B + B specimen
PC	2	Pinus cembra	Swiss Stone Pine	1.5m Ht. B + B specimen
PF	2	Pinus flexilis	Lumber Pine	1.5m Ht. B + B specimen

Plant List - Shrubs - A & W Loblaws Plaza Merivale Road				
Code	Qty.	Botanical Name	Common Name	Condition
HK	130	Hypericum kalmianum	St. John's Wort	40cm Ht. Pot
SB	180	Spiraea bumalda 'Dart's Reef'	Dart's Red Spiraea	60cm Ht. Pot

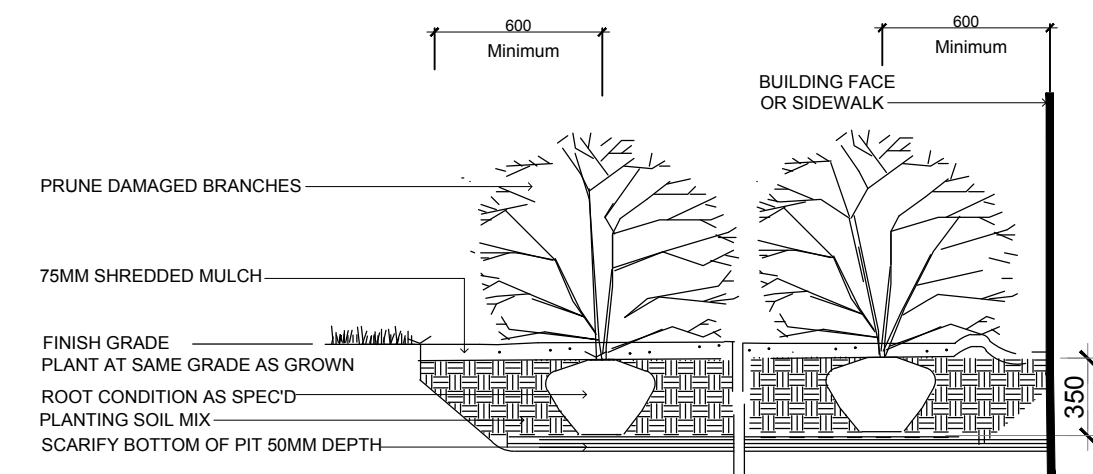

SHRUB PLANTING NTS

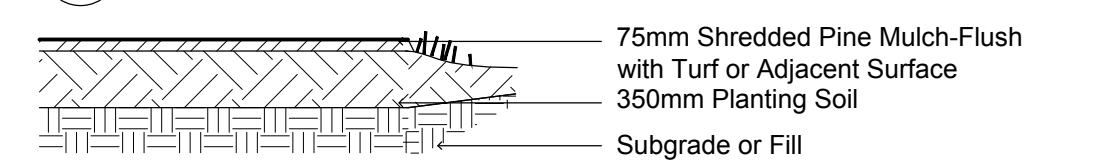

TYPICAL PLANTING BED NTS

During Excavation/Bed Preparation if Extreme Conditions are Encountered (Water, Rock, Gravel...) that Could Effect the Planting, Notify GJALA Immediately.

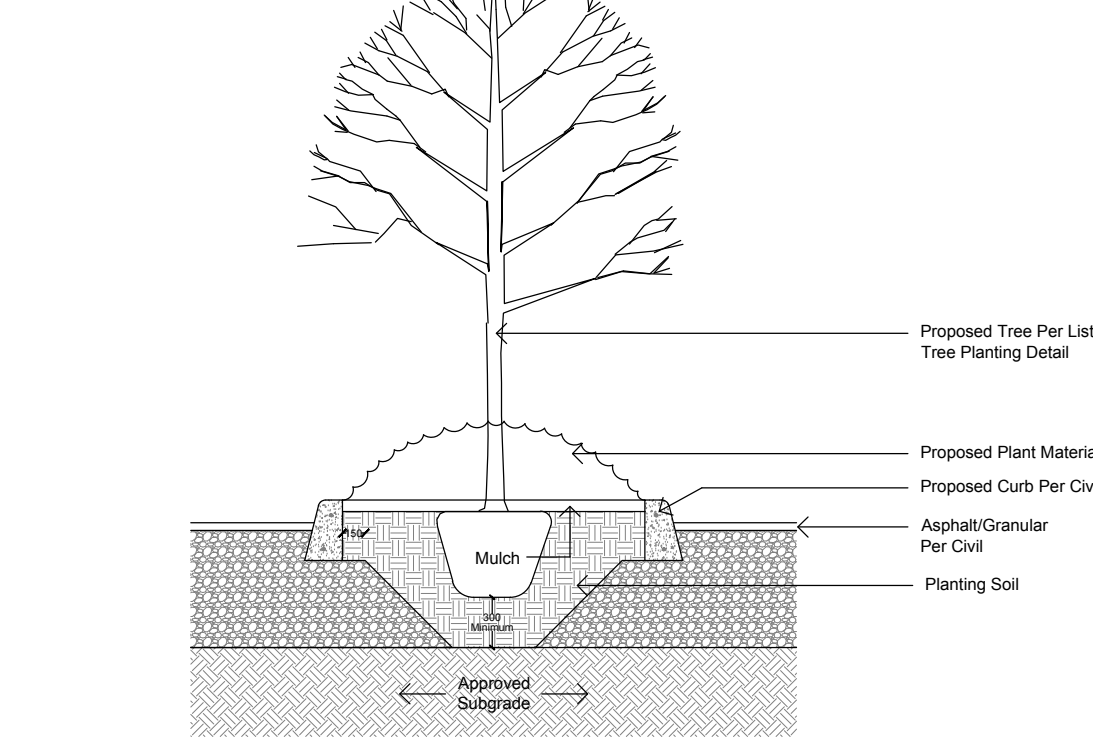

TYPICAL LANDSCAPE ISLAND NTS

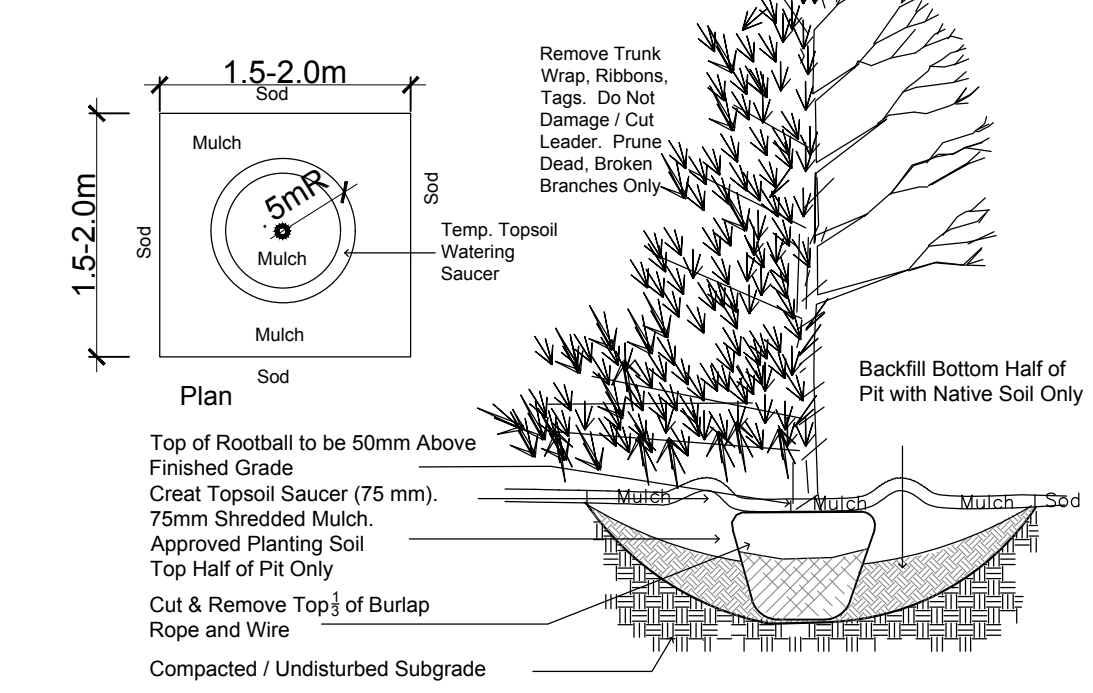

TREE PLANTING Section NTS

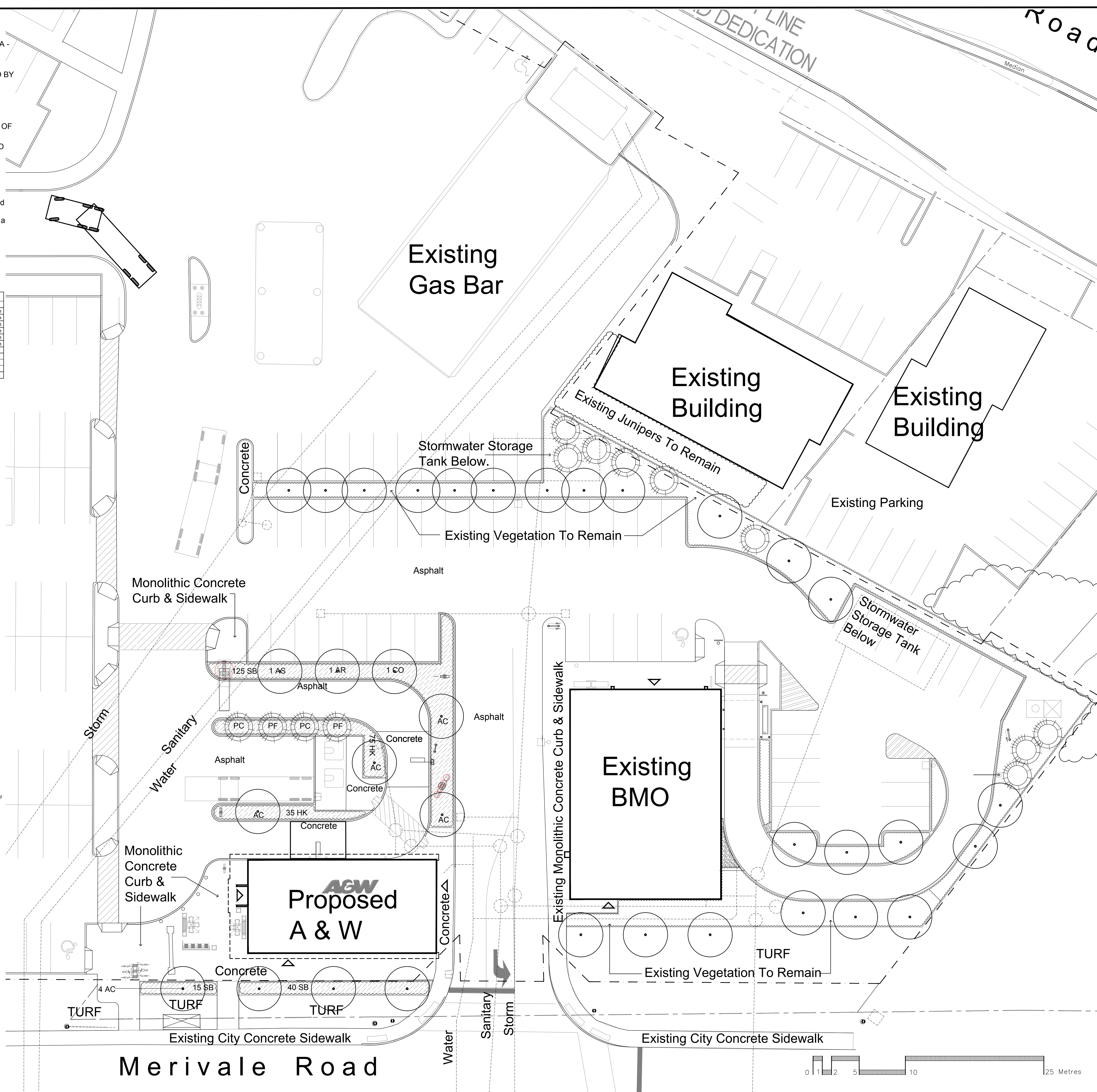

APPROVED REFUSED
 THIS ___ DAY OF ___, 20__
 DERRICK MOODIE
 MANAGER, DEVELOPMENT REVIEW - WEST
 PLANNING, INFRASTRUCTURE & ECONOMIC
 DEVELOPMENT DEPARTMENT, CITY OF OTTAWA

Drawing Remains the Property of Gino J. Aiello Landscape Architect. Copyright Reserved by Gino J. Aiello Landscape Architect. Do Not Use or Reproduce Without Approval of Gino J. Aiello. Do Not Use For Construction Unless Signed By Landscape Architect. Contractor is Responsible for Verification of Site Locations of all Utilities. Report any Discrepancies Between Site and Drawing Immediately to Gino J. Aiello.

- Proposed Coniferous Tree
- Proposed Deciduous Tree
- Proposed Planting Bed

No.	Revision	Date
5	per Revised Site and Civil	February 16 2018
4	per City Comments	November 30 2017
3	per City Comments	August 23 2017
2	For Site Plan Control	April 18 2017
1	For Review/Coordination	April 2017

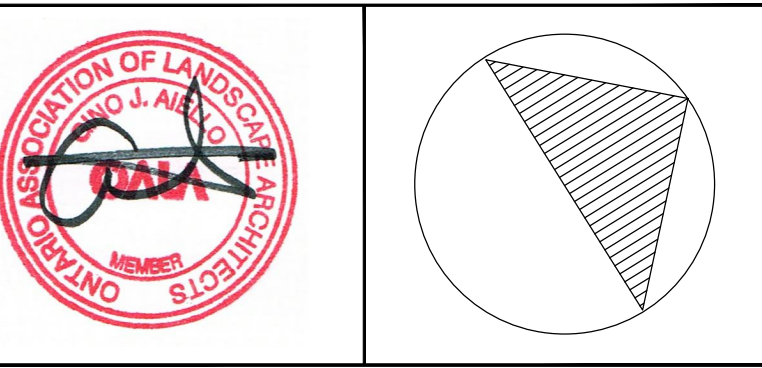

Property Owner **First Capital Realty**
 7600 boulevard Viau
 Montréal, Québec, H1S 2P3

Consultant
Gino J. Aiello landscape architect www.gjala.com
 gino@gjala.com (613) 852 1343
 50 Camelot Drive, Nepean, Ontario K2G 5X8

Project **A & W Loblaws Plaza**
 1454 & 1460 Merivale Road Ottawa

Drawing **Landscape Plan**

Drawn By: GJA Sheet Number
 Design By: GJA **L1**
 Date: March 2017
 Scale: 1:200

D07-12-17-0053