

SERVICING SECTION

NOT TO SCALE

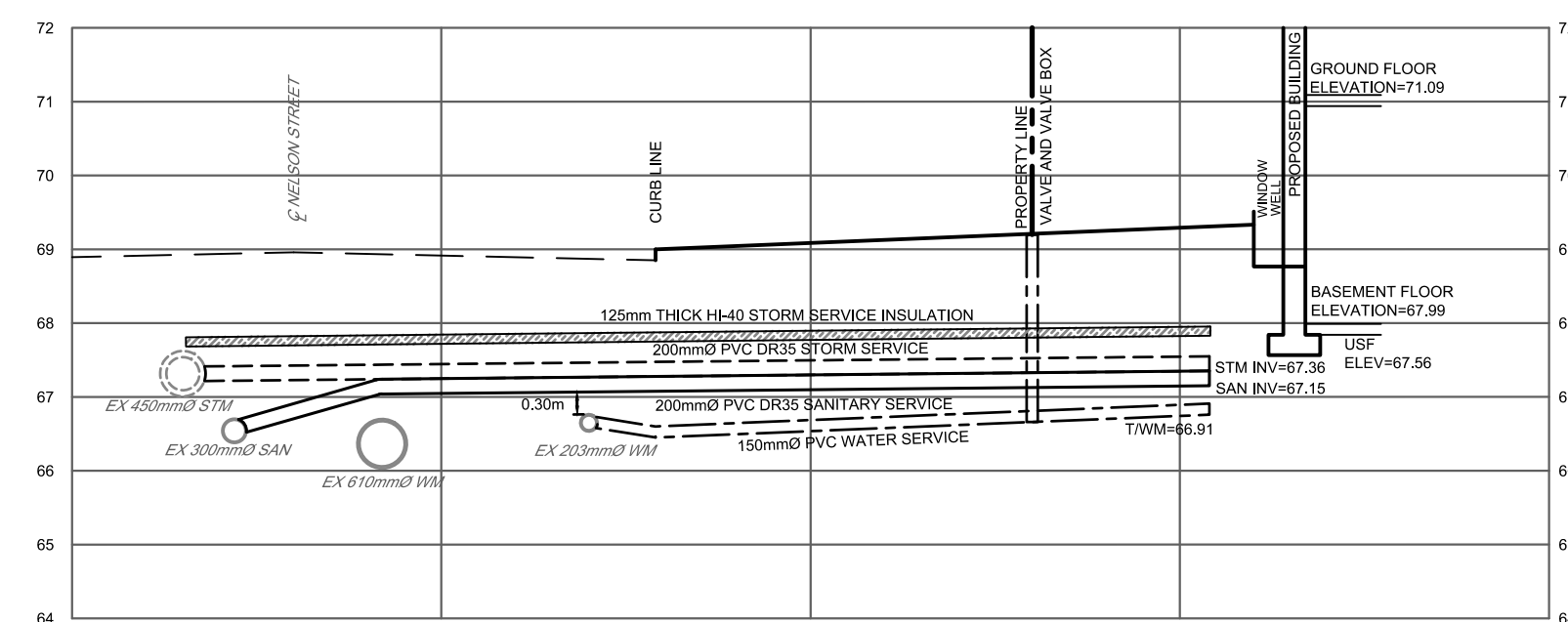

LEGEND

- PROPERTY LINE
PROPOSED SANITARY SERVICE
PROPOSED STORM SERVICE
CONTROLLED FLOW ROOF DRAIN
THERMAL INSULATION FOR SHALLOW SEWERS
PROPOSED BARRIER CURB
PROPOSED DEPRESSED CURB
PROPOSED WATER SERVICE AND DIAMETER
PROPOSED VALVE & VALVE BOX
PROPOSED CAP
PROPOSED SIAMESE CONNECTION
PROPOSED WATER METER & REMOTE METER
PROPOSED BUILDING ENTRANCE
PROPOSED RETAINING WALL
PROPOSED WINDOW WELL
PROPOSED MAIN FLOOR ELEVATION
PROPOSED FRONT ENTRANCE ELEVATION
PROPOSED BASEMENT FLOOR ELEVATION
PROPOSED UNDERSIDE OF FOOTING ELEVATION
- OH
EXISTING OVERHEAD WIRES
EXISTING CONCRETE CURB
EXISTING SANITARY MANHOLE & SEWER
EXISTING CATCHBASIN MANHOLE
EXISTING STORM MANHOLE & SEWER
EXISTING CATCHBASIN CW
EXISTING CATCHBASIN LEAD
EXISTING HYDRANT & VALVE
EXISTING TREES / VEGETATION
EXISTING UTILITY POLE C/W GUY WIRES
EXISTING FENCE
EXISTING WATERMAIN
EXISTING HYDRANT C/W VALVE & LEAD
REMOVALS / ABANDONMENT
PROPOSED HYDRO TRANSFORMER
PROPOSED BOLLARD FOR TRANSFORMER

GENERAL NOTES:

- COORDINATE AND SCHEDULE ALL WORK WITH OTHER TRADES AND CONTRACTORS.
- DETERMINE THE EXACT LOCATION, SIZE, MATERIAL AND ELEVATION OF ALL EXISTING UTILITIES PRIOR TO COMMENCING CONSTRUCTION. PROTECT AND ASSUME RESPONSIBILITY FOR ALL EXISTING UTILITIES WHETHER OR NOT SHOWN ON THIS DRAWING.
- OBTAIN ALL NECESSARY PERMITS AND APPROVALS FROM THE CITY OF OTTAWA BEFORE COMMENCING CONSTRUCTION.
- BEFORE COMMENCING CONSTRUCTION OBTAIN AND PROVIDE PROOF OF COMPREHENSIVE, ALL RISK AND OPERATIONAL LIABILITY INSURANCE FOR \$2,000,000.00. INSURANCE POLICY TO NAME OWNERS, ENGINEERS AND ARCHITECTS AS CO-INSURED.
- RESTORE ALL DISTURBED AREAS ON-SITE AND OFF-SITE, INCLUDING TRENCHES AND SURFACES ON PUBLIC ROAD ALLOWANCES TO EXISTING CONDITIONS OR BETTER TO THE SATISFACTION OF MUNICIPAL AUTHORITIES.
- REMOVE FROM SITE ALL EXCESS EXCAVATED MATERIAL, ORGANIC MATERIAL AND DEBRIS UNLESS OTHERWISE INSTRUCTED BY ENGINEER. EXCAVATE AND REMOVE FROM SITE ANY CONTAMINATED MATERIAL. ALL CONTAMINATED MATERIAL SHALL BE DISPOSED OF AT A LICENSED LANDFILL FACILITY.
- ALL ELEVATIONS ARE GEODETIC.
- REFER TO GEOTECHNICAL INVESTIGATION (PG4059-LET.01), DATED APRIL 6, 2017, PREPARED BY PATERSON GROUP FOR SUBSURFACE CONDITIONS, CONSTRUCTION AND GEOTECHNICAL INSPECTION REQUIREMENTS. THE GEOTECHNICAL CONSULTANT IS TO REVIEW ON-SITE CONDITIONS AFTER EXCAVATION PRIOR TO PLACEMENT OF THE GRANULAR MATERIAL.
- REFER TO ARCHITECT'S AND LANDSCAPE ARCHITECT'S DRAWINGS FOR BUILDING AND HARD SURFACED AREAS AND DIMENSIONS.
- REFER TO THE 'DEVELOPMENT SERVICING STUDY AND STORMWATER MANAGEMENT REPORT' (R-2017-139) PREPARED BY NOVATECH.
- SAW CUT AND KEY/GRIND ASPHALT AT ALL ROAD CUTS AND ASPHALT TIE-IN POINTS AS PER CITY OF OTTAWA STANDARDS (R10).

SEWER NOTES:

- SUPPLY AND CONSTRUCT ALL SEWERS AND APPURTENANCES IN ACCORDANCE WITH THE MOST CURRENT CITY OF OTTAWA STANDARDS AND SPECIFICATIONS.
- SPECIFICATIONS:
ITEM: STORM SERVICE, SANITARY SERVICE, SEWER TRENCH
SPEC. No.: PVC DR 35, PVC DR 35
COVER (GRANULAR 'A' OR GRANULAR 'B' TYPE I WITH MAXIMUM PARTICLE SIZE=25mm)
- ALL STORM AND SANITARY SERVICE LATERALS SHALL BE EQUIPPED WITH BACKFLOW PREVENTERS WITHIN THE BUILDING FOOTPRINT AS PER CITY OF OTTAWA STANDARD DETAILS S14 AND S14.1 OR S14.2. REFER TO MECHANICAL PLANS FOR DETAILS.
- PIPE BEDDING, COVER AND BACKFILL ARE TO BE COMPACTED TO AT LEAST 95% OF THE STANDARD PROCTOR MAXIMUM DRY DENSITY. THE USE OF CLEAR CRUSHED STONE AS A BEDDING LAYER SHALL NOT BE PERMITTED.
- INSULATE ALL SEWER PIPES THAT HAVE LESS THAN 1.5m COVER WITH 125mm THICK HI-40 RIGID INSULATION.
- CONTRACTOR TO PROVIDE THE CONSULTANT WITH A GENERAL PLAN OF SERVICES INDICATING ALL APPLICABLE SERVICING AS-BUILT INFORMATION SHOWN ON THIS PLAN. AS-BUILT INFORMATION MUST INCLUDE: PIPE MATERIAL, SIZES, LENGTHS, SLOPES, INVERT AND T/I ELEVATIONS, STRUCTURE LOCATIONS AND ANY ALIGNMENT CHANGES, ETC.
- THE OWNER SHALL REQUIRE THAT THE SITE SERVICING CONTRACTOR PERFORM FIELD TESTS FOR QUALITY CONTROL OF ALL SANITARY SEWERS. LEAKAGE TESTING SHALL BE COMPLETED IN ACCORDANCE WITH OPSB 410.07.16, 410.07.16.04 AND 407.07.24. DYE TESTING IS TO BE COMPLETED ON ALL SANITARY SERVICES TO CONFIRM PROPER CONNECTION TO THE SANITARY SEWER MAIN. THE FIELD TESTS SHALL BE PERFORMED IN THE PRESENCE OF A CERTIFIED PROFESSIONAL ENGINEER WHO SHALL SUBMIT A CERTIFIED COPY OF THE TEST RESULTS.

WATERMAIN NOTES:

- SUPPLY AND CONSTRUCT ALL WATERMAIN AND APPURTENANCES IN ACCORDANCE WITH THE MOST CURRENT CITY OF OTTAWA STANDARDS AND SPECIFICATIONS.
- SPECIFICATIONS:
ITEM: WATERMAIN TRENCHING, THERMAL INSULATION IN SHALLOW TRENCHES, THERMAL INSULATION BY OPEN STRUCTURES, WATERMAIN CROSSING BELOW SEWERS, WATERMAIN MATERIAL
SPEC. No.: W22, W23, W25
REFERENCE: CITY OF OTTAWA, CITY OF OTTAWA, CITY OF OTTAWA, CITY OF OTTAWA
PVC DR 18 (100mm AND LARGER)
- EXCAVATION, INSTALLATION, BACKFILL AND RESTORATION OF ALL WATERMANS BY THE CONTRACTOR. CONNECTIONS AND SHUT-OFFS AT THE MAIN AND CHLORINATION OF THE WATER SYSTEM SHALL BE PERFORMED BY CITY OFFICIALS. EXCAVATION, INSTALLATION OF SERVICE, BACKFILL AND RESTORATION BY THE CONTRACTOR.
- WATERMAIN SHALL BE MINIMUM 2.4m DEPTH BELOW GRADE UNLESS OTHERWISE INDICATED.
- PROVIDE MINIMUM 0.5m CLEARANCE BETWEEN OUTSIDE OF PIPES AT ALL CROSSINGS, UNLESS OTHERWISE INDICATED.
- WATER SERVICE IS TO BE CONSTRUCTED TO WITHIN 1.0m OF FOUNDATION WALL AND CAPPED, UNLESS OTHERWISE INDICATED.

NOTE:
THE POSITION OF ALL POLE LINES, CONDUITS, WATERMANS, SEWERS AND OTHER UNDERGROUND AND OVERGROUND UTILITIES AND STRUCTURES IS NOT NECESSARILY SHOWN ON THE CONTRACT DRAWINGS, AND WHERE SHOWN, THE ACCURACY OF THE POSITION OF SUCH UTILITIES AND STRUCTURES IS NOT GUARANTEED. BEFORE STARTING WORK, DETERMINE THE EXACT LOCATION OF ALL SUCH UTILITIES AND STRUCTURES AND ASSUME ALL LIABILITY FOR DAMAGE TO THEM.

OWNER INFORMATION
A.F. MARTINS CONSTRUCTION
35 LINDEN TERRACE
OTTAWA, ONTARIO, K1S 1Z1
MS. TINA CAMPAGNA
PHONE: (613) 232-9820
TINACAMPAGNA@SYMPATICO.CA

No.	REVISION	DATE	BY
1	ISSUED FOR SITE PLAN APPLICATION	OCT 27/17	FST

SCALE

1:100

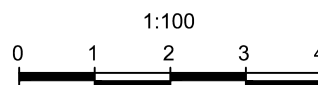

DESIGN	LSC / FST
CHECKED	FST
DRAWN	LSC
CHECKED	FST
APPROVED	FST



NOVATECH
Engineers, Planners & Landscape Architects
Suite 200, 240 Michael Cowpland Drive
Ottawa, Ontario, Canada K2M 1P6
Telephone (613) 254-9643
Facsimile (613) 254-5867
Website www.novatech-eng.com

LOCATION
CITY of OTTAWA
355 NELSON STREET

DRAWING NAME

GENERAL PLAN OF SERVICES

PROJECT No.	116018-00
REV	REV # 1
DRAWING No.	116018-GP