

1 PROPOSED BASEMENT FLOOR PLAN - PHASE (2)  
A2.1 SCALE 1:100

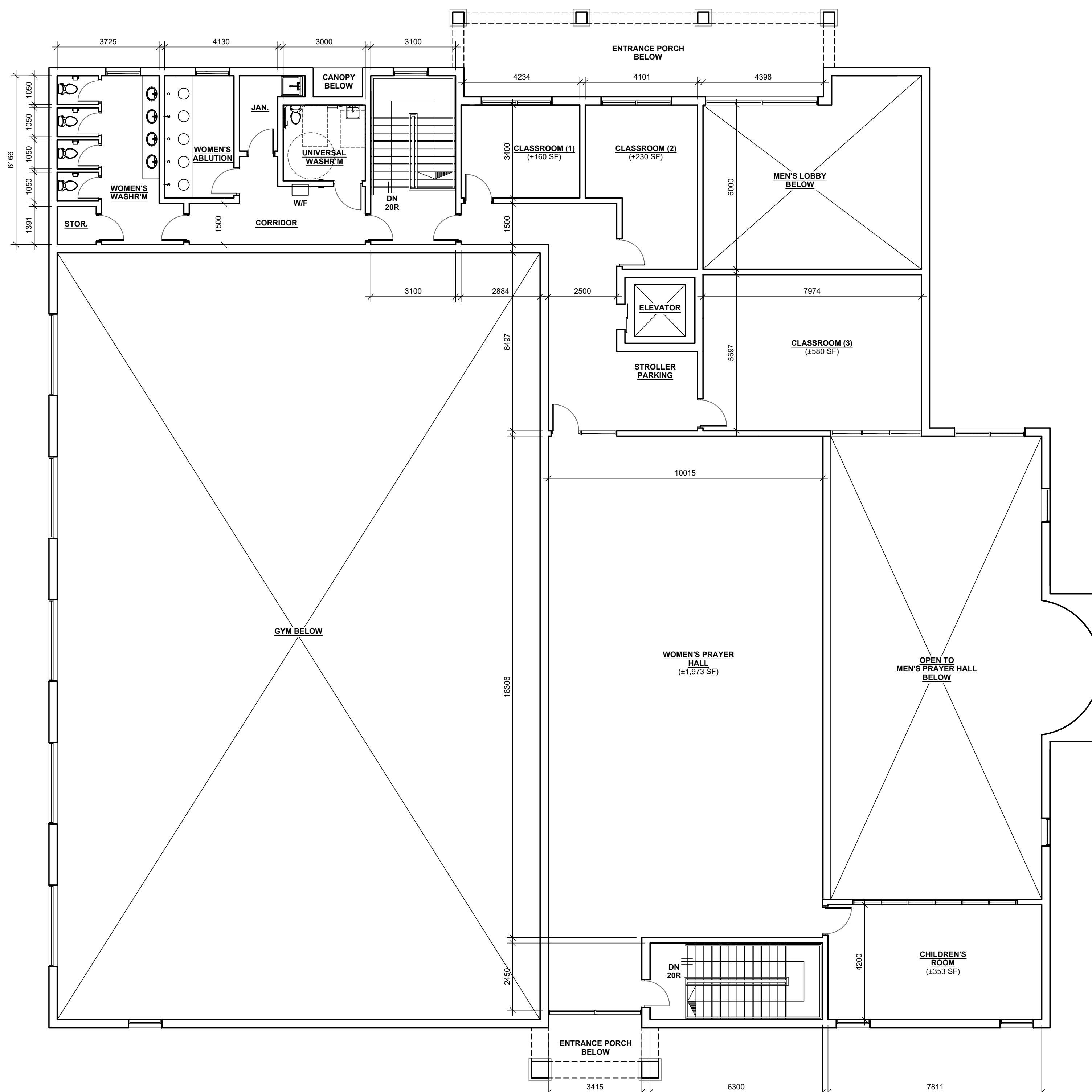

2 PROPOSED SECOND FLOOR PLAN - PHASE (2)  
A2.1 SCALE 1:100

**GENERAL NOTES**

- CONTRACTOR SHALL VERIFY ALL DIMENSIONS ON SITE AND SHALL REPORT ANY DISCREPANCIES TO THE ARCHITECT PRIOR TO COMMENCEMENT OF WORK.
- CONTRACTOR MUST COMPLY WITH ALL CODES AND BYLAWS AND OTHER REGULATIONS BY AUTHORITIES HAVING JURISDICTION OVER THE WORK.
- DO NOT SCALE THIS DRAWING.
- THIS DRAWING MAY NOT BE USED FOR CONSTRUCTION UNLESS SEALED/SIGNED BY THE ARCHITECT.
- COPYRIGHT OF THIS DRAWING IS RESERVED.

00	ISSUED FOR RE-ZONING/SITE PLAN CONTROL APPLICATION	2017/08/30
NO.	ISSUE	DATE (YYYYMMDD)

REVISIONS

ORIENTATION  PROJECT NORTH	SEAL  AHMED ARIEF ARCHITECT LICENSE 7766
----------------------------------	--

	<b>A+ Architecture Inc.</b> 555 LEGGET DRIVE TOWER A, SUITE 304 KANATA, ON K2K 2X3 +1 613 699 6860 info@aplus-arch.com www.aplus-arch.com
--	---

CLIENT  
**KANATA MUSLIM ASSOCIATION**

PROJECT  
**KMA MOSQUE AND COMMUNITY CENTER**  
351 SANDHILL ROAD  
KANATA, ON K2K 1X7

DRAWING TITLE  
**PROPOSED BASEMENT & SECOND FLOOR PLANS - PHASE (2)**

DRAWN BY C.G.M	DRAWING NO.
REVIEWED BY A.A.	<b>A2.1</b>
START DATE 2016/11/23	PROJECT NO. 16010
PROJECT NO. 16010	REVISION NO. 00