

- LEGEND**
- PROPERTY LINE
  - PROPOSED WATERMAIN
  - PROPOSED SANITARY SEWER
  - PROPOSED STORM SEWER
  - PROPOSED PERFORATED SUBDRAIN
  - VB PROPOSED VALVE BOX
  - CS PROPOSED CURB STOP
  - ◇ PROPOSED FIRE HYDRANT
  - ◊ PROPOSED SIAMESE CONNECTION
  - RM PROPOSED REMOTE WATER METER
  - ⊙ PROPOSED WATER METER
  - PROPOSED STORM MANHOLE
  - PROPOSED FOUNDATION MANHOLE (WATERTIGHT COVER PER OPSD 401.030)
  - PROPOSED SANITARY MANHOLE (WATERTIGHT COVER PER OPSD 401.030)
  - PROPOSED CATCH BASIN
  - PROPOSED CB 'T'

EXISTING UNDERGROUND SERVICES AND UTILITY LOCATIONS DERIVED FROM THE BEST AVAILABLE DATA, AS-CONSTRUCTED DRAWINGS, UTILITY DRAWINGS AND INFRASTRUCTURE MAPPING PROVIDED BY THE CITY OF OTTAWA.

CONTRACTOR TO CONFIRM ELEVATIONS AND LOCATIONS OF EXISTING UNDERGROUND SERVICES AND UTILITIES WITHIN THE RIGHT OF WAY PRIOR TO INSTALLATION OF SITE SERVICING INFRASTRUCTURE.

THE CONTRACTOR SHALL IMPLEMENT BEST MANAGEMENT PRACTICES, TO PROVIDE FOR PROTECTION OF THE AREA DRAINAGE SYSTEM AND THE RECEIVING WATERCOURSE, DURING CONSTRUCTION ACTIVITIES. THE CONTRACTOR ACKNOWLEDGES THAT THE FAILURE TO IMPLEMENT APPROPRIATE EROSION AND SEDIMENT CONTROL MEASURES MAY BE SUBJECT TO PENALTIES IMPOSED BY ANY APPLICABLE REGULATORY AGENCY.

**NOT FOR CONSTRUCTION**

**TOPOGRAPHIC INFORMATION**  
 TOPOGRAPHIC INFORMATION PROVIDED BY ANNIS, O'SULLIVAN, VOLLEBEK LTD.  
 PROJ. NO. 4615-03  
 DATED AUGUST 13, 2003

**SITE PLAN INFORMATION**  
 SITE PLAN PROVIDED BY M. DAVID BLAKELY ARCHITECT INC.  
 RECEIVED SEPTEMBER 20, 2017

**GEOTECHNICAL STUDY**  
 GEOTECHNICAL RECOMMENDATIONS PROVIDED BY PATERSON GROUP INC.  
 PROJ. NO. PG0287-1  
 DATED JULY 5, 2004

**SITE SERVICING AND STORMWATER MANAGEMENT STUDY**  
 SERVICING AND STORMWATER MANAGEMENT RECOMMENDATIONS PROVIDED BY DSEL  
 PROJ. NO. 17-919  
 DATED SEPTEMBER 2017

**BENCHMARK**  
 BENCHMARK AT THE TOP OF SPINDLE LOCATED NORTH OF THE SUBJECT SITE  
 ELEV=92.90m

No.	BY	YY.MM.DD	DESCRIPTION
3	A.J.G.	17.09.20	ISSUED FOR MUNICIPAL APPROVAL
2	A.J.G.	17.08.01	ISSUED FOR MUNICIPAL REVIEW
1	B.N.C.	17.04.19	ISSUED FOR MUNICIPAL REVIEW

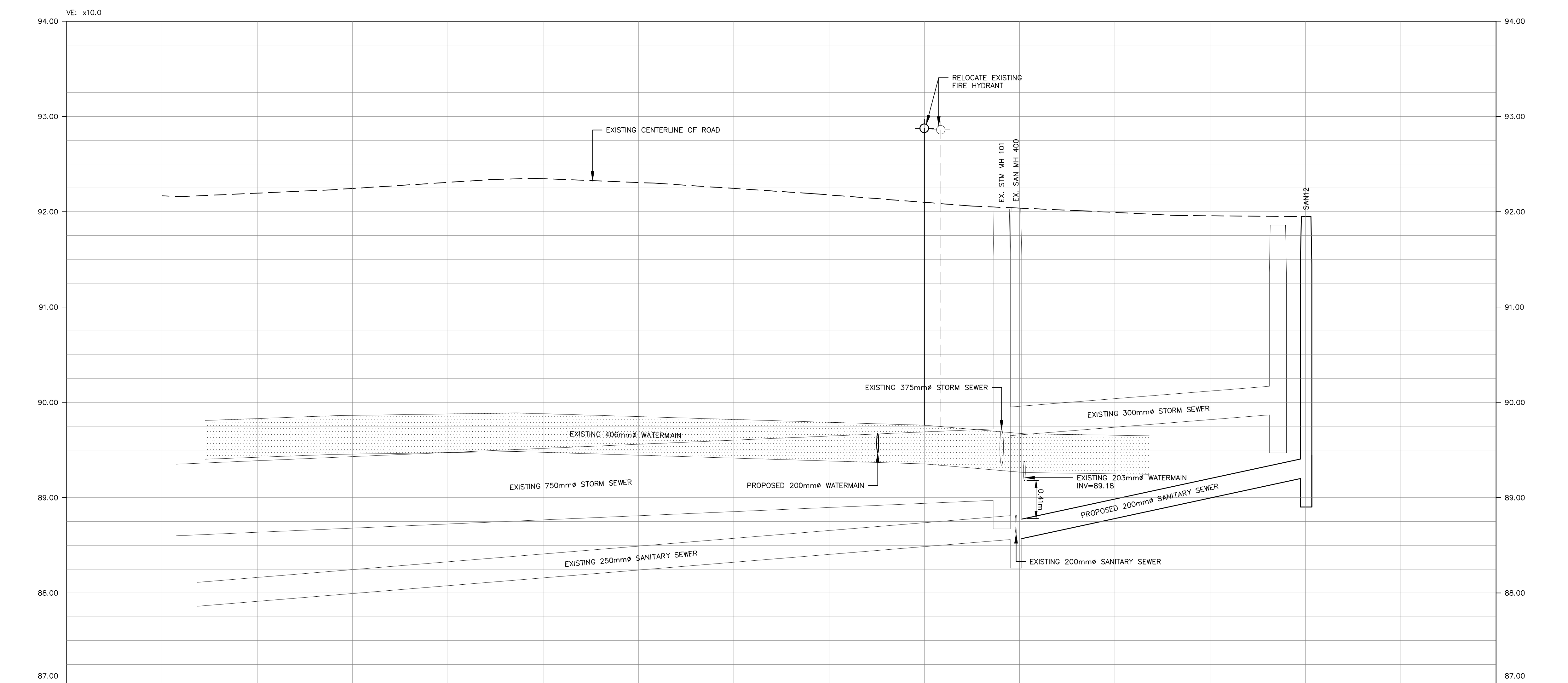

EXISTING CL OF ROAD GRADES	92.16	92.23	92.34	92.35	92.30	92.19	92.09	92.06	92.04	92.01	91.96	91.95	EXISTING CL OF ROAD GRADES
TOP OF EXISTING WATERMAIN	89.81	89.86	89.89				89.75		89.67		89.65		TOP OF EXISTING WATERMAIN
PROPOSED SANITARY INVERT									E 88.57			W 89.20	PROPOSED SANITARY INVERT
PROPOSED STORM INVERT													PROPOSED STORM INVERT
CENTERLINE CHAINAGE	0+080.00	0+090.00	0+040.00		0+020.00		0+000.00	0+005.60	0+020.00		0+040.00		CENTERLINE CHAINAGE

PROJECT No. 17-919

**PLAN & PROFILE**  
**146 MOUNTSHANNON DRIVE** © DSEL

**RICHCRAFT™**  
 Group of Companies

2280 St. Laurent Blvd., Suite 201  
 Ottawa, Ontario, K1G 4K1  
 Tel. (613) 739-7111

**DSEL**  
 david schaeffer engineering ltd  
 SMART SUBDIVISIONS™

120 Iber Road Unit 103  
 Stittsville, Ontario, K2S 1E9  
 Tel. (613) 836-0856  
 Fax. (613) 836-7183  
 www.DSEL.ca

DRAWN BY: B.N.C.	CHECKED BY: R.D.F.	DRAWING NO.:	SHEET NO.:
DESIGNED BY: B.N.C.	CHECKED BY: A.D.F.	PP-1	6 of 6
SCALE: H 1:250 V 1:25	DATE: SEPTEMBER 2017		