

EXISTING UNDERGROUND AND ABOVE GROUND INFORMATION FROM WATERIDGE VILLAGE AT ROCKCLIFFE SUBDIVISION DESIGN DRAWINGS PREPARED BY IBI GROUP (CONTRACT NO. 38298) DATED FEBRUARY 2, 2017

WATER SERVICES TO BE 25mm DIA. STUBBED 2.4m BELOW GRADE 1.2m FROM BUILDING FOUNDATION

SANITARY SERVICES TO BE 135mm DIA. @ 1.0% (MIN) 2.5m BELOW GRADE

STORM SERVICES TO BE 150mm DIA. @ 1.0% (MIN) 2.0m BELOW GRADE

REFER TO DS-1 FOR AREA DRAIN TABLE

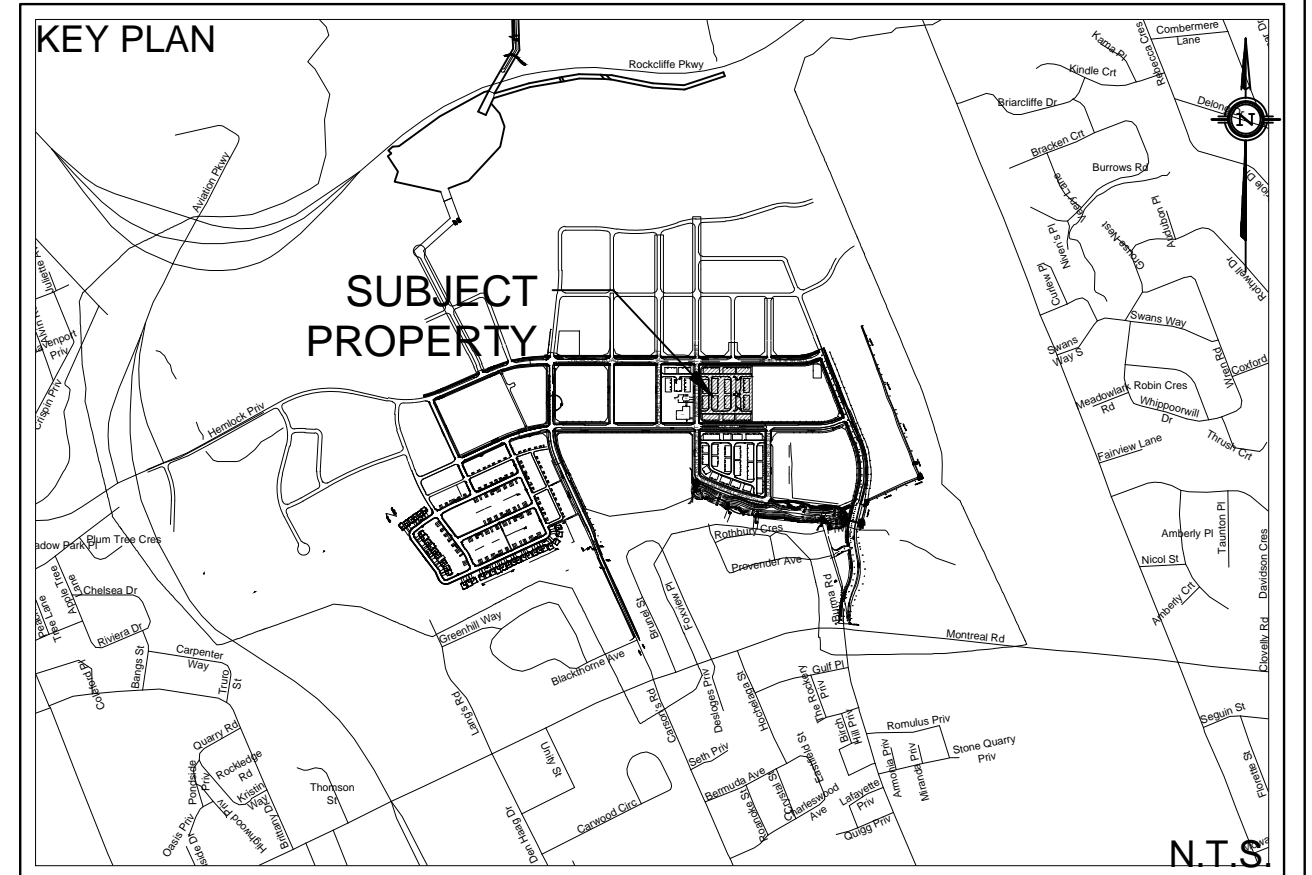

- LEGEND**
- PROPERTY LINE
 - PROPOSED WATERMAIN
 - PROPOSED SANITARY SEWER
 - PROPOSED STORM SEWER
 - PROPOSED PERFORATED SUBDRAIN
 - VB PROPOSED VALVE BOX
 - CS PROPOSED CURB STOP
 - FH PROPOSED FIRE HYDRANT
 - SC PROPOSED SIAMSE CONNECTION
 - RM PROPOSED REMOTE WATER METER
 - WM PROPOSED WATER METER
 - PROPOSED STORM MANHOLE
 - PROPOSED SANITARY MANHOLE
 - PROPOSED CATCH BASIN
 - PROPOSED CB 'T'

CONTRACTOR TO CONFIRM ELEVATIONS AND LOCATIONS OF EXISTING UNDERGROUND SERVICES AND UTILITIES WITHIN THE RIGHT OF WAY PRIOR TO INSTALLATION OF SITE SERVICING INFRASTRUCTURE.

THE CONTRACTOR SHALL IMPLEMENT BEST MANAGEMENT PRACTICES, TO PROVIDE FOR PROTECTION OF THE AREA DRAINAGE SYSTEM AND THE RECEIVING WATERCOURSE, DURING CONSTRUCTION ACTIVITIES. THE CONTRACTOR ACKNOWLEDGES THAT THE FAILURE TO IMPLEMENT APPROPRIATE EROSION AND SEDIMENT CONTROL MEASURES MAY BE SUBJECT TO PENALTIES IMPOSED BY ANY APPLICABLE REGULATORY AGENCY.

NOT FOR CONSTRUCTION

SITE PLAN INFORMATION
SITE PLAN PROVIDED BY KORSIAK URBAN PLANNING
DATED AUGUST 4, 2017

GEOTECHNICAL STUDY
GEOTECHNICAL RECOMMENDATIONS PROVIDED BY PATERSON GROUP INC.
PROJ. NO. PG4064-1
DATED AUGUST 8 2017

SITE SERVICING AND STORMWATER MANAGEMENT STUDY
SERVICING AND STORMWATER MANAGEMENT RECOMMENDATIONS PROVIDED BY DSEL
PROJ. NO. 17-949
DATED AUGUST 2017

BENCH MARK
ELEVATIONS ARE GEODETIC, REFERRED TO CITY OF OTTAWA VERTICAL BENCHMARK NO. 396
ELEV = 95.06 METERS

NO.	BY	DATE	DESCRIPTION
2	A.D.F.	17.08.11	ISSUED FOR MUNICIPAL REVIEW
1	S.L.M.	17.08.02	ISSUED FOR CANADA LANDS COMPANY REVIEW

PROJECT No. 17-949

PROFESSIONAL ENGINEER
A.D. FOBERT
100390625
PROVINCE OF ONTARIO

REVIEWED BY

SITE SERVICING PLAN
WATERIDGE - BLOCK 24

© DSEL

MATTAMY HOMES

50 Hines Road, Suite 100
Ottawa, Ontario, K2K 2M5
Tel. (613) 831-5144

DSEL
david schaeffer engineering ltd
SWAY SUBDIVISIONS™

120 Iler Road Unit 103
Stittsville, Ontario, K2S 1E9
Tel. (613) 836-0856
Fax. (613) 836-7183
www.DSEL.ca

DRAWN BY: S.L.M./A.W.T. CHECKED BY: S.L.M.	DRAWING NO.	SHEET NO.
DESIGNED BY: B.N.C. CHECKED BY: A.D.F.	SSP-1	3 of 5
SCALE: 1:300	DATE: AUGUST 2017	