

EXISTING UNDERGROUND AND ABOVE GROUND INFORMATION FROM WATERIDGE VILLAGE AT ROCKCLIFFE SUBDIVISION DESIGN DRAWINGS PREPARED BY IBI GROUP (CONTRACT NO. 38298) DATED FEBRUARY 2, 2017

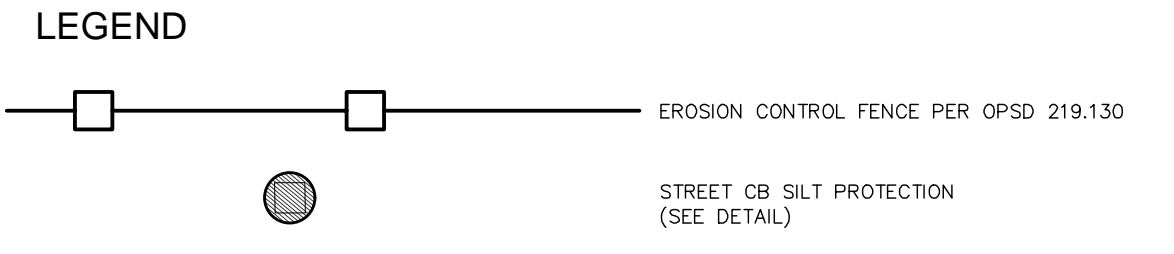
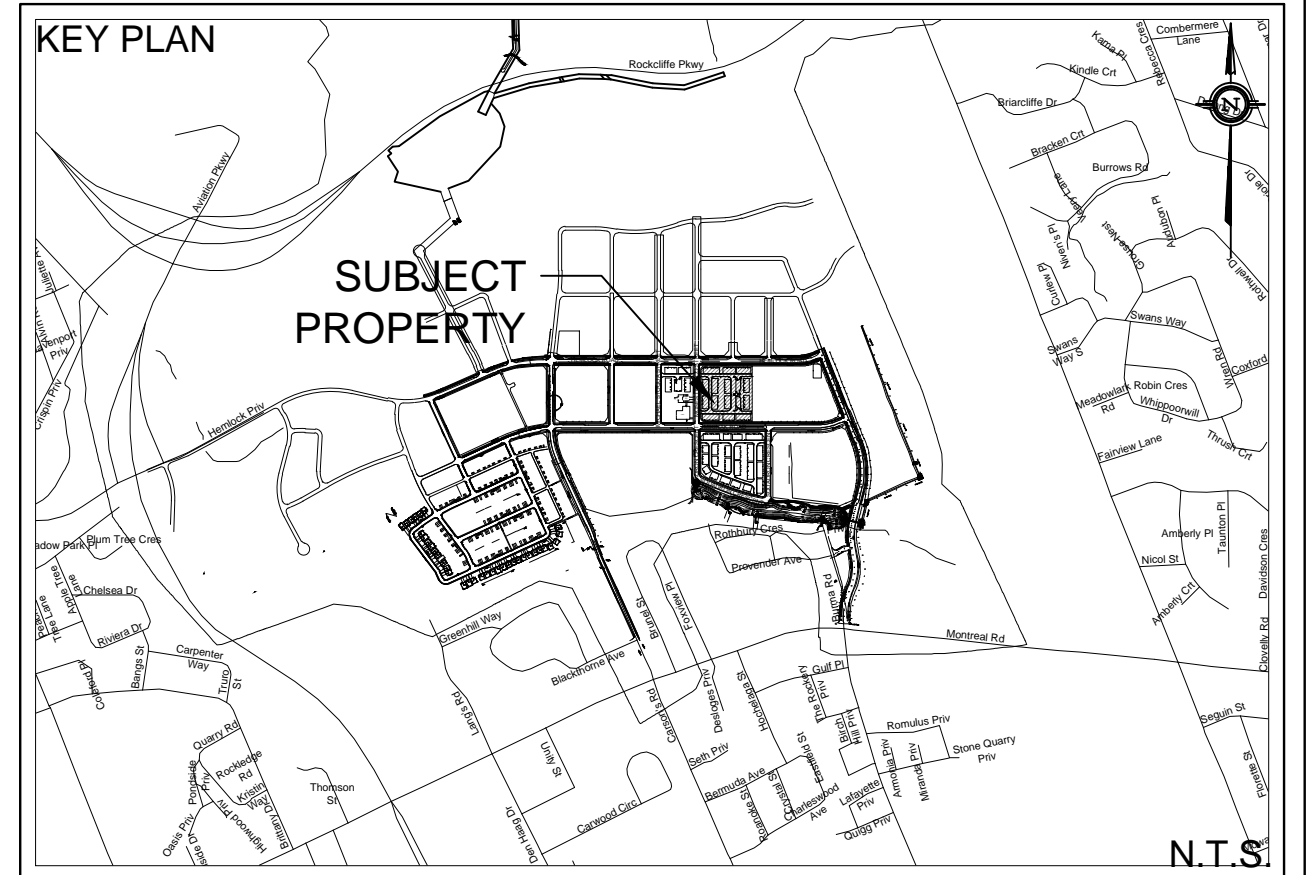

NOT FOR CONSTRUCTION

SITE PLAN INFORMATION
SITE PLAN PROVIDED BY KORSIAK URBAN PLANNING
DATED AUGUST 4, 2017

GEOTECHNICAL STUDY
GEOTECHNICAL RECOMMENDATIONS PROVIDED BY PATERSON GROUP INC.
PROJ. NO. PG4064-1
DATED AUGUST 8 2017

SITE SERVICING AND STORMWATER MANAGEMENT STUDY
SERVICING AND STORMWATER MANAGEMENT RECOMMENDATIONS PROVIDED BY DSEL
PROJ. NO. 17-949
DATED AUGUST 2017

BENCH MARK
ELEVATIONS ARE GEODETIC, REFERRED TO CITY OF OTTAWA VERTICAL BENCHMARK NO. 396
ELEV= 95.06 METERS

2	A.D.F.	17.08.11	ISSUED FOR MUNICIPAL REVIEW
1	S.L.M.	17.08.02	ISSUED FOR CANADA LANDS COMPANY REVIEW
NO.	BY	YY.MM.DD	DESCRIPTION

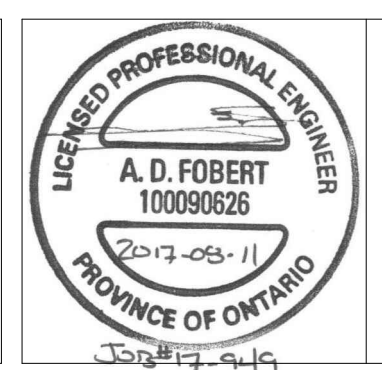

PROJECT No. 17-949

REVIEWED BY

EROSION CONTROL PLAN
WATERIDGE - BLOCK 24 © DSEL

MATTAMY HOMES
50 Hines Road, Suite 100
Ottawa, Ontario, K2K 2M5
Tel. (613) 831-5144

DSEL
david schaeffer engineering ltd
SWAY SUBSIDIARIES

120 Iber Road Unit 103
Stittsville, Ontario, K2S 1E9
Tel. (613) 836-0856
Fax. (613) 836-7183
www.DSEL.ca

DRAWN BY: S.L.M.	CHECKED BY: S.L.M.	DRAWING NO. EC-1	SHEET NO. 4 of 5
DESIGNED BY: B.N.C.	CHECKED BY: A.D.F.		
SCALE: 1:300	DATE: AUGUST 2017		