

EXISTING UNDERGROUND AND ABOVE GROUND INFORMATION FROM WATERIDGE VILLAGE AT ROCKCLIFFE SUBDIVISION DESIGN DRAWINGS PREPARED BY IBI GROUP (CONTRACT NO. 38298) DATED FEBRUARY 2, 2017

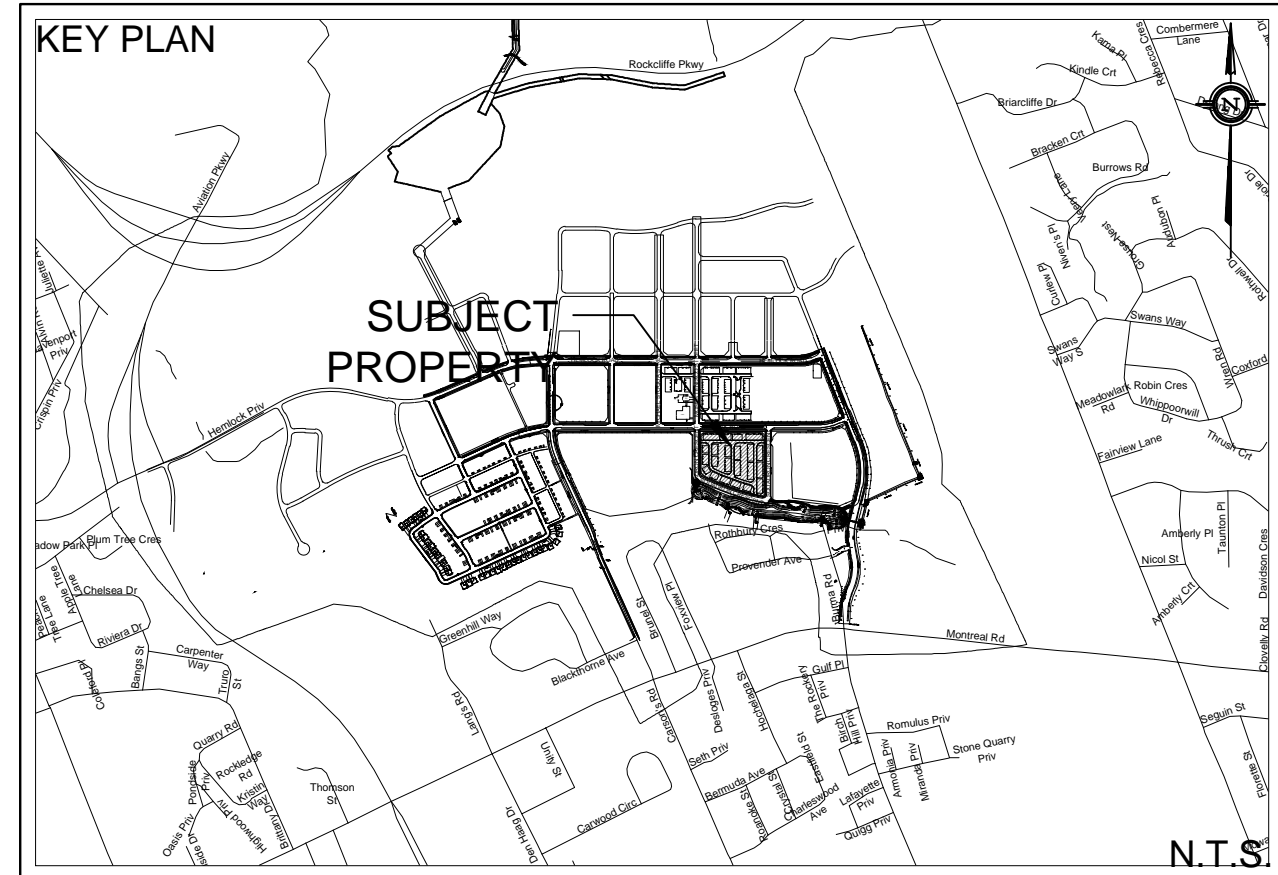

LEGEND

- PROPERTY LINE
- PROPOSED SANITARY SEWER
- PROPOSED SANITARY MANHOLE
- DRAINAGE DIVIDE

SAN-1	DRAINAGE AREA ID
0.260	AREA IN Ha
10 / 36	POPULATION # OF UNITS

NOT FOR CONSTRUCTION

SITE PLAN INFORMATION
SITE PLAN PROVIDED BY KORSIC URBAN PLANNING
DATED AUGUST 4, 2017

GEOTECHNICAL STUDY
GEOTECHNICAL RECOMMENDATIONS PROVIDED BY PATERSON GROUP INC.
PROJ. NO. PG4064-1
DATED AUGUST 8, 2017

SITE SERVICING AND STORMWATER MANAGEMENT STUDY
SERVICING AND STORMWATER MANAGEMENT RECOMMENDATIONS PROVIDED BY DSEL
PROJ. NO. 17-946
DATED AUGUST 2017

BENCH MARK
ELEVATIONS ARE GEODETIC, REFERRED TO CITY OF OTTAWA VERTICAL BENCHMARK NO. 396
ELEV= 95.06 METERS

No.	BY	DATE	DESCRIPTION
2	A.D.F.	17.08.11	ISSUED FOR MUNICIPAL REVIEW
1	S.L.M.	17.08.02	ISSUED FOR CANADA LANDS COMPANY REVIEW

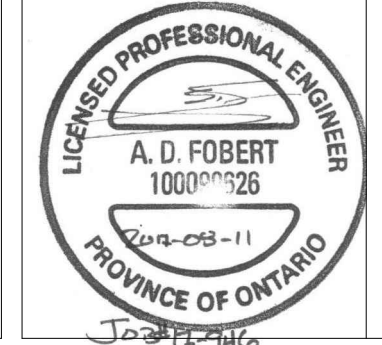

PROJECT No. 17-946

**SANITARY DRAINAGE PLAN
WATERIDGE - BLOCK 15**

<p>MATTAMY HOMES</p> <p>DSEL david schaeffer engineering ltd SANITARY SUBDIVISIONS™</p> <p>DESIGNED BY: B.N.C. CHECKED BY: S.L.M. DRAWING NO. SAN-1</p> <p>SCALE: 1:400 DATE: AUGUST 2017</p>	<p>50 Hines Road, Suite 100 Ottawa, Ontario, K2K 2M5 Tel. (613) 831-5144</p> <p>120 Iber Road Unit 103 Stittsville, Ontario, K2S 1E9 Tel. (613) 836-0856 Fax. (613) 836-7183 www.DSEL.ca</p> <p>REVIEWED BY:</p> <p style="text-align: right;">© DSEL</p> <p style="text-align: right;">2 of 2</p>
--	--