

LEGEND

	EXISTING TREE TO REMAIN
	TREE PROTECTION FENCE
	PROPOSED SOD
	PROPOSED DECIDUOUS TREE
	PROPOSED ORNAMENTAL GRASSES/ PERENNIALS
	PROPOSED PEASTONE

1	ISSUED FOR SITE PLAN APPLICATION	07/19/2017	ML	JL
No.	Issue	Date	Drawn	Checked

PROJECT  
 PROPOSED 3 STOREY 8 UNIT DWELLING  
 351 CROYDON AVENUE OTTAWA, ONTARIO

DRAWING  
 TREE CONSERVATION REPORT &  
 LANDSCAPE PLAN

STAMP

SCALE  
 AS SHOWN  
 START DATE  
 MAY 2017  
 PROJECT NO.

PROJECT NORTH

DRAWING NO.  
**L.1**  
 PLOT SIZE ARCH-D

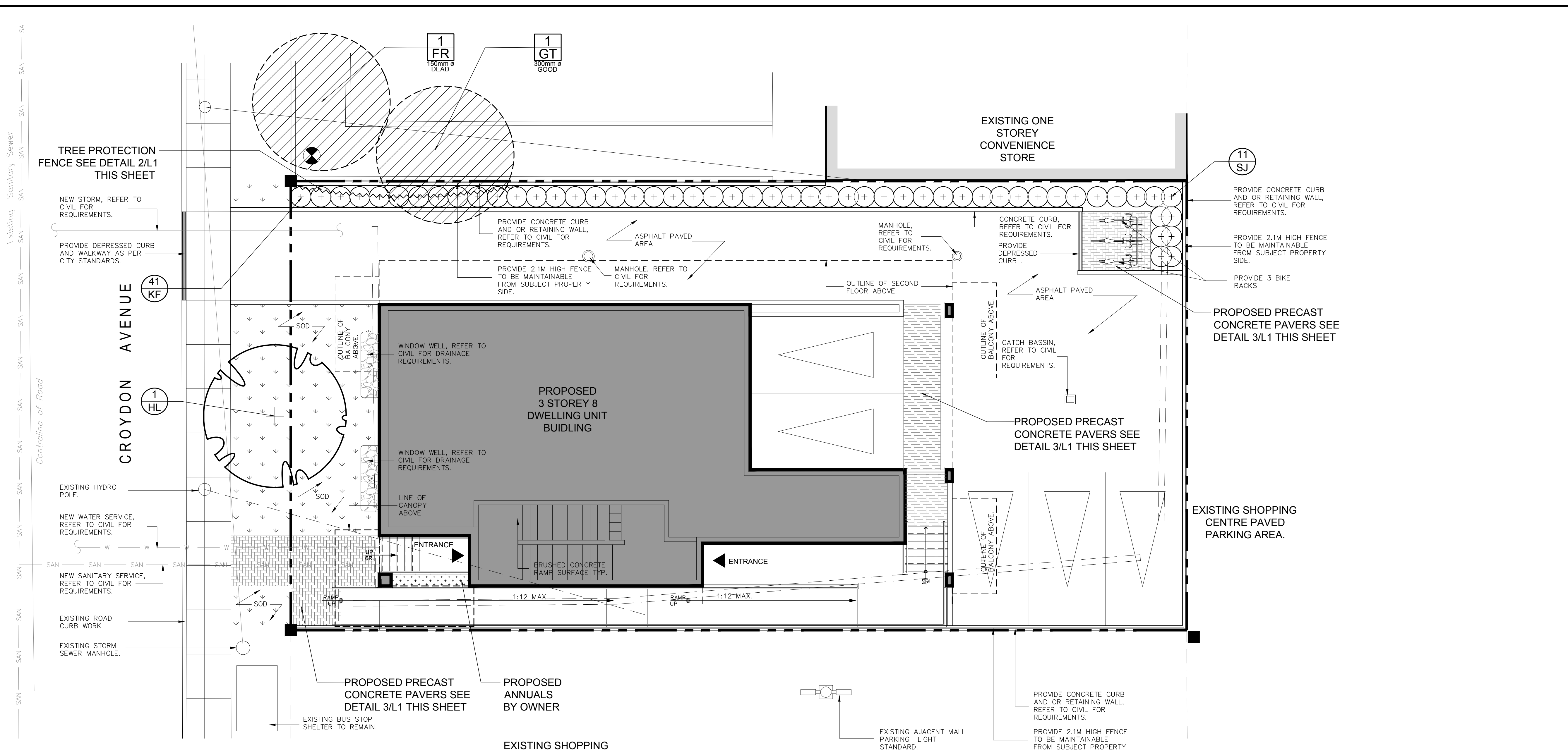

**1 L.1 TREE CONSERVATION REPORT & LANDSCAPE PLAN**  
 SCALE: 1:75

KEY	QTY.	BOTANICAL NAME	COMMON NAME	SIZE	CONDITION	REMARKS
<b>EXISTING TREE LIST</b>						
TREES						
FR	1	Fraxinus sp.	Ash	150mm ø	DEAD	To Remain
GT	1	Gleditsia triacanthos	Honeylocust	300mm ø	GOOD	To Remain

KEY	QTY.	BOTANICAL NAME	COMMON NAME	SIZE	CONDITION	REMARKS
<b>PROPOSED PLANT LIST</b>						
TREES						
HL	1	Gleditsia triacanthos 'Draves'	Streetkeeper Honeylocust	70mm ø	B&B	See Plan
SHRUBS						
SJ	11	Hypericum kalmianum	St. John's Wort	600mm Ht.	Potted	Space 800mm O.C.
ORNAMENTAL GRASSES						
KF	41	Calamagrostis x acutiflora Karl Foerster	Feather Reed Grass	250 mm Pot.	Potted	Space 800mm O.C.

- GENERAL NOTES:**
- It is the responsibility of the appropriate contractor or official to report any errors, omissions or discrepancies on this plan with actual site conditions to the Landscape Architect before proceeding with construction.
  - The contractor is to notify all utility companies and authorities prior to any excavation and ascertain locations of underground services.
  - The contractor is to reinstate all areas and items damaged as a result of construction activity.
  - The contractor is to comply with all pertinent codes and by-laws.
  - The contractor is to maintain a positive surface run-off throughout the entire construction period.
  - The Landscape Architect is not responsible for subsurface conditions.
  - The contractor is to identify all existing trees to remain on site with the Landscape Architect prior to construction.
  - The contractor is to stake the proposed location of all plant material in conjunction with the Landscape Architect prior to excavation.
  - Minimum distances for selected deciduous trees are as follows:
    - Building Foundations 7.5m
    - Sidewalks 1.5m
    - Public Streets 2.5m
    - Underground Infrastructure 2.0m
  - All trees within 1m of underground utility trenches are to be excavated by hand.
  - Remove all protective wrapping from tree trunks after installation.
  - Staking of trees shall only be performed if necessary.
  - Ensure that mulch is pulled back a min. distance of 75mm from base of tree trunk.

