

150mmØ WATERMAIN A			
STATION	FINISHED GRADE	TOP OF W/M	ITEM
D+000	57.18	55.02	CONNECT TO EXISTING 150mmØ WATERMAIN STUB
D+011.2	57.07	54.50	150mmØ HYDRANT TEE
D+015	57.05	54.60	45° HORIZONTAL BEND
D+018	57.12	54.70	45° HORIZONTAL BEND
D+040	57.06	54.60	TOP OF PIPE
D+053.7	57.08	54.60	45° HORIZONTAL BEND
D+058.8	57.10	54.700	45° HORIZONTAL BEND
D+070	57.25	54.80	TOP OF PIPE
D+083.9	57.21	54.810	150mmØ VALVE AND VALVE BOX
D+086.9	57.21	54.810	45° HORIZONTAL BEND
D+089	57.27	54.870	45° HORIZONTAL BEND
D+090.3	57.30	54.900	150mmØ CAP AND THRUST BLOCK

150mmØ WATERMAIN B			
STATION	FINISHED GRADE	TOP OF W/M	ITEM
D+000	56.47	54.33	CONNECT TO EXISTING 150mmØ WATERMAIN WITH 45° HORIZONTAL BEND
D+003	56.48	54.00	22 1/2" HORIZONTAL BEND
D+006	56.53	54.130	11 1/4" HORIZONTAL BEND
D+020	56.40	54.000	TOP OF PIPE
D+040	56.47	54.070	TOP OF PIPE
D+061.3	56.50	54.100	45° HORIZONTAL BEND
D+065.2	56.50	54.100	45° HORIZONTAL BEND
D+068.6	56.50	54.100	150mmØ CAP AND THRUST BLOCK

SEWER AND WATERMAIN CROSSING TABLE						
CROSSING	STM INV	STM OBV	SAN INV	SAN OBV	WTR TOP	WTR STM
▲	54.92	55.02	52.77	52.97		
▲	54.56	55.06	51.92	52.12	54.36	54.21
▲			51.94	52.14	54.10	53.95
▲	52.73	53.11				
▲	52.64	53.02			54.13	53.98

* BRACKETS DENOTE ADJUSTED VALUE WITH CONCRETE PIPE THICKNESS

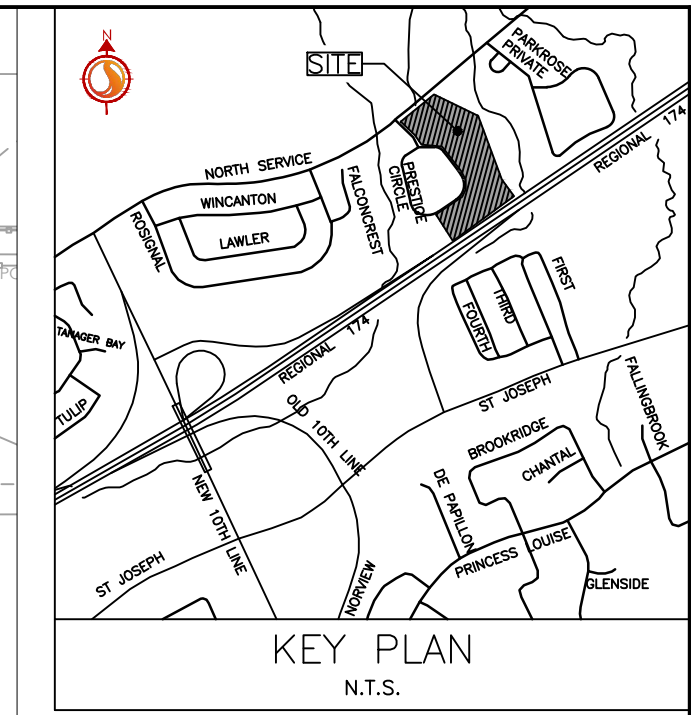

Stantec Consulting Ltd.
400 - 1331 Clyde Avenue
Ottawa ON
Tel. 613.722.4420
www.stantec.com

Copyright Reserved
The Contractor shall verify and be responsible for all dimensions. DO NOT scale the drawing - any errors or omissions shall be reported to Stantec without delay.
The Copyrights to all designs and drawings are the property of Stantec. Reproduction or use for any purpose other than that authorized by Stantec is forbidden.

Legend

- PROPOSED WATERMAIN
- PROPOSED VALVE AND VALVE BOX
- PROPOSED SERVICE CHAMBER
- PROPOSED REDUCER
- PROPOSED FIRE HYDRANT
- PROPOSED WATER METER
- PROPOSED REMOTE WATER METER
- PROPOSED PRESSURE REDUCING VALVE
- PROPOSED THRUST BLOCK LOCATIONS
- PROPOSED SANITARY SEWER
- PROPOSED STORM SEWER
- PROPOSED CATCHBASIN MANHOLE
- PROPOSED CATCHBASIN
- PROPOSED SUBDRAIN CATCHBASIN
- EXISTING WATERMAIN
- EXISTING VALVE AND VALVE BOX
- EXISTING REDUCER
- EXISTING FIRE HYDRANT
- EXISTING SANITARY SEWER
- EXISTING STORM SEWER
- EXISTING CATCHBASIN MANHOLE
- EXISTING CATCHBASIN
- EXISTING SUBDRAIN CATCHBASIN
- THERMAL INSULATION ON STORM SEWER WHERE COVER IS LESS THAN 1.5m. THERMAL INSULATION ON WATERMAIN WHERE COVER IS LESS THAN 2.4m AS PER W22.

SCHEDULE OF ROOF RELEASE RATES				
BUILDING	DRAIN TYPE	# DRAINS	100YR Head (m)	100YR RELEASE RATE (L/s)
BLOCK 6	WATTS ACCUFLOW (100% OPEN)	6	0.140	10.63
BLOCK 7	WATTS ACCUFLOW (100% OPEN)	7	0.142	12.58
BLOCK 8	WATTS ACCUFLOW (100% OPEN)	8	0.145	14.63

SCHEDULE FOR PARKING RAMP TRENCH DRAINS		
BLOCK ID	DRAINAGE AREA ID	100YR RELEASE RATE (L/s)
BLOCK 6	F203A	12.9
BLOCK 7	F202A	12.4
BLOCK 8	F300B	9.4

SCHEDULE OF INLET CONTROL DEVICES				
STRUCTURE ID	DRAINAGE AREA ID	TYPE	100YR HEAD (m)	100YR RELEASE RATE (L/s)
CB100A	F100B	IPX TEMPEST LMF 45	2.1	2.6
CB100B	F100C	110mm ORIFICE PLATE	2.1	37.2
CB200A	F201A	IPX TEMPEST LMF 55	2.1	3.9
CB200B	F200B	100mm ORIFICE PLATE	2.1	30.8
CB300A	F300A	95mm ORIFICE PLATE	2.1	27.8

- NOTES:
- PROPOSED BUILDINGS TO BE EQUIPPED WITH BACKWATER VALVES
 - PROPOSED TRENCH DRAINS TO BE DESIGNED TO CAPTURE 100 YEAR PEAK FLOWS.

Revision		By	Appd.	YY.MM.DD
1	ISSUED FOR SPA	MJS	AMP	17.06.13

Permit-Seal		Dwn.	Chkd.	Dsgn.	YY.MM.DD
File Name:	160401331 D8.dwg	MJS	AMP	MJS	17.06.12

Client/Project
**BRIGIL
PETRIE'S LANDING II**

**BLOCK 6, 7, AND 8
8466 JEANNE D'ARC BOULEVARD
OTTAWA, ON, CANADA**

Title
SITE SERVICING PLAN

Project No. 160401331	Scale 1:500	Sheet 1	Revision 1
--------------------------	----------------	------------	---------------