

**LEGEND**

---	PROPERTY LINE	○	PROPOSED STORM MANHOLE
---	PROPOSED WATERMAIN	●	PROPOSED FOUNDATION MANHOLE (WATERTIGHT COVER PER OPSD 401.030)
---	PROPOSED SANITARY SEWER	●	PROPOSED SANITARY MANHOLE (WATERTIGHT COVER PER OPSD 401.030)
---	PROPOSED STORM SEWER	■	PROPOSED CATCH BASIN
---	PROPOSED PERFORATED SUBDRAIN	○	PROPOSED CB 'T'
VB	PROPOSED VALVE BOX		
CS	PROPOSED CURB STOP		
⊕	PROPOSED FIRE HYDRANT		
⊕	PROPOSED SIAMSESE CONNECTION		
⊕	PROPOSED REMOTE WATER METER		
⊕	PROPOSED WATER METER		

EXISTING UNDERGROUND SERVICES AND UTILITY LOCATIONS DERIVED FROM THE BEST AVAILABLE DATA, AS-CONSTRUCTED DRAWINGS, UTILITY DRAWINGS AND INFRASTRUCTURE MAPPING PROVIDED BY THE CITY OF OTTAWA.

CONTRACTOR TO CONFIRM ELEVATIONS AND LOCATIONS OF EXISTING UNDERGROUND SERVICES AND UTILITIES WITHIN THE RIGHT OF WAY PRIOR TO INSTALLATION OF SITE SERVICING INFRASTRUCTURE.

THE CONTRACTOR SHALL IMPLEMENT BEST MANAGEMENT PRACTICES, TO PROVIDE FOR PROTECTION OF THE AREA DRAINAGE SYSTEM AND THE RECEIVING WATERCOURSE, DURING CONSTRUCTION ACTIVITIES. THE CONTRACTOR ACKNOWLEDGES THAT THE FAILURE TO IMPLEMENT APPROPRIATE EROSION AND SEDIMENT CONTROL MEASURES MAY BE SUBJECT TO PENALTIES IMPOSED BY ANY APPLICABLE REGULATORY AGENCY.

**NOT FOR CONSTRUCTION**

**TOPOGRAPHIC INFORMATION**  
 TOPOGRAPHIC INFORMATION PROVIDED BY ANNIS, O'SULLIVAN, VOLLEBEKK LTD.  
 PROJ. NO. 4615-03  
 DATED AUGUST 13, 2003

**SITE PLAN INFORMATION**  
 SITE PLAN PROVIDED BY M. DAVID BLAKELY ARCHITECT INC.  
 DATED DECEMBER 22, 2016

**GEOTECHNICAL STUDY**  
 GEOTECHNICAL RECOMMENDATIONS PROVIDED BY PATERSON GROUP INC.  
 PROJ. NO. PG0267-1  
 DATED JULY 5, 2004

**SITE SERVICING AND STORMWATER MANAGEMENT STUDY**  
 SERVICING AND STORMWATER MANAGEMENT RECOMMENDATIONS PROVIDED BY DSEL  
 PROJ. NO. 17-919  
 DATED APRIL 2017

**BENCH MARK**  
 EXISTING ELEVATIONS ESTABLISHED BY ADV ARE REFERRED TO GEODETIC DATUM

1	B.N.C.	17.04.19	ISSUED FOR MUNICIPAL REVIEW
No.	BY	YY.MM.DD	DESCRIPTION

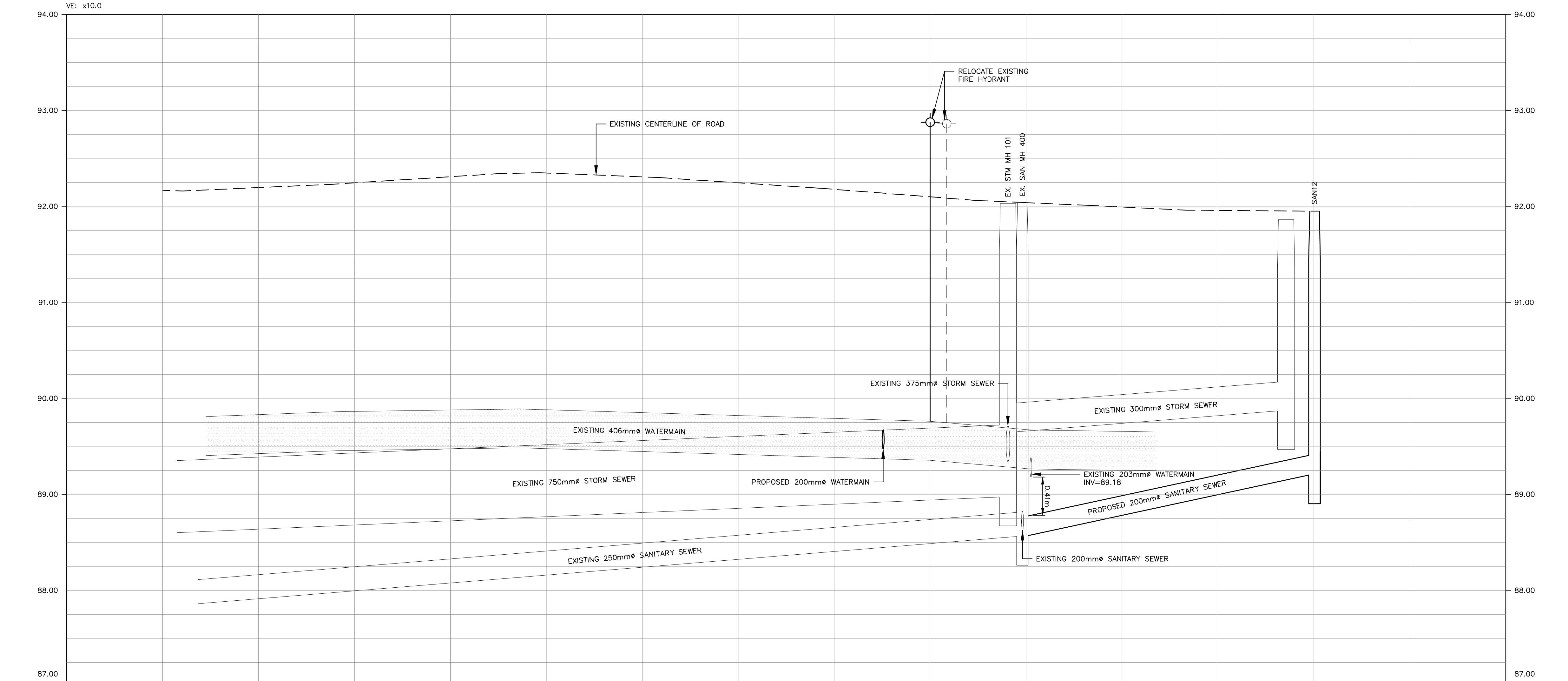

EXISTING CL OF ROAD GRADES	92.16	92.23	92.34	92.35	92.30	92.19	92.09	92.06	92.04	92.01	91.96	91.95	EXISTING CL OF ROAD GRADES
TOP OF EXISTING WATERMAIN	88.81	88.86	88.89				88.75 HYDRANT	88.67		88.65			TOP OF EXISTING WATERMAIN
PROPOSED SANITARY INVERT									E 88.57	34.7m-200mm SAN @ 2.2%		W 89.20	PROPOSED SANITARY INVERT
PROPOSED STORM INVERT													PROPOSED STORM INVERT
CENTERLINE CHAINAGE	0+080.00	0+060.00	0+040.00	0+020.00	0+000.00	0+000.00	0+000.00	0+020.00	0+040.00	0+020.00	0+040.00	0+040.00	CENTERLINE CHAINAGE

PROJECT No. 17-919

R. D. FREEL  
100163197  
2019-04-19

A. D. FOBERT  
100087726  
2017-04-19

**PLAN & PROFILE**  
**146 MOUNTSHANNON DRIVE** © DSEL

**RICHCRAFT™**  
Group of Companies

2280 St. Laurent Blvd., Suite 201  
Ottawa, Ontario, K1G 4K1  
Tel. (613) 739-7111

**DSEL**  
david schaeffer engineering ltd  
SMART SUBDIVISIONS™

120 Iher Road Unit 103  
Stittsville, Ontario, K2S 1E9  
Tel. (613) 836-0856  
Fax. (613) 836-7183  
www.DSEL.ca

DRAWN BY:	B.N.C.	CHECKED BY:	R.D.F.	DRAWING NO.	SSP-1	SHEET NO.	5 of 5
DESIGNED BY:	B.N.C.	CHECKED BY:	A.D.F.	DATE:	APRIL 2017		
SCALE:	H 1:250	V 1:25	DATE:	APRIL 2017			