

- GENERAL NOTES:**
- It is the responsibility of the appropriate contractor or official to report any errors, omissions or discrepancies on this plan with actual site conditions to the Landscape Architect before proceeding with construction.
 - The contractor is to notify all utility companies and authorities prior to any excavation and ascertain locations of underground services.
 - The contractor is to reinstate all areas and items damaged as a result of construction activity.
 - The contractor is to comply with all pertinent codes and by-laws.
 - The contractor is to maintain a positive surface run-off throughout the entire construction period.
 - The Landscape Architect is not responsible for subsurface conditions.
 - The contractor is to identify all existing trees to remain on site with the Landscape Architect prior to construction.
 - The contractor is to stake the proposed location of all plant material in conjunction with the Landscape Architect prior to excavation.
 - Minimum distances for selected deciduous trees are as follows:
 - Building Foundations 7.5m
 - Sidewalks 1.5m
 - Public Streets 2.5m
 - Underground Infrastructure 2.0m
 - All trees within 1m of underground utility trenches are to be excavated by hand.
 - Remove all protective wrapping from tree trunks after installation.
 - Staking of trees shall only be performed if necessary.
 - Ensure that mulch is pulled back a min. distance of 75mm from base of tree trunk.
 - See report titled "Geotechnical Investigation Residential Development Spring Valley Trails Zen Blocks" prepared by Golder & Associates Ltd. August 2018 for information regarding planting restrictions.

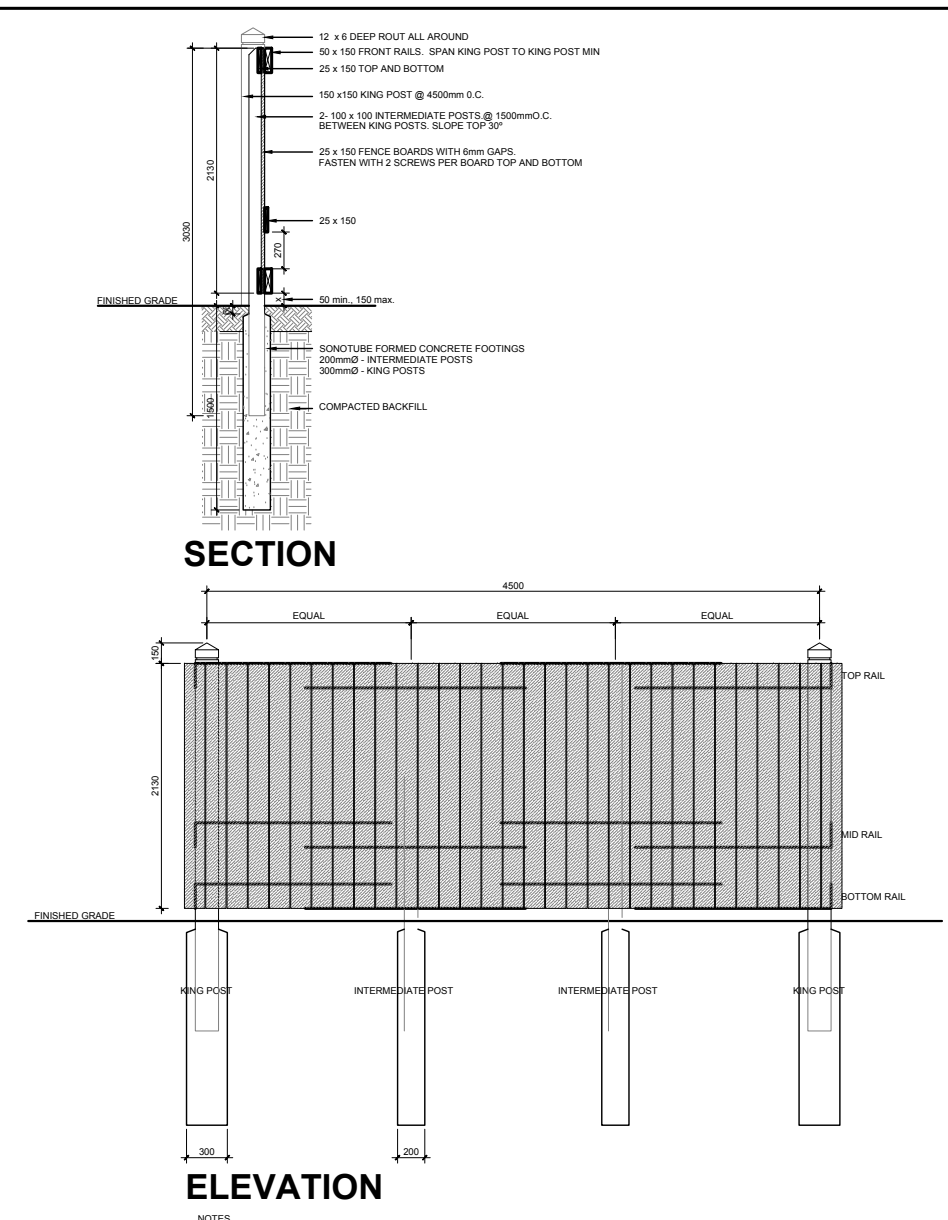

4 2130mm Ht. WOOD BOARD FENCE
SCALE: NTS

CLIENT:

CLARIDGE HOMES

210 Gladstone Avenue, Suite 2001
Ottawa, Ontario K2P 0Y6
Tel: (613) 233-8200
Fax: (613) 233-8200

CONSULTANTS

ARCHITECTS:

Roderick Lahey Architect Inc.
98 Booth St., Ottawa, ON K1S 3J6
Tel: (613) 724-9932

SURVEYORS:

Annis O'Sullivan Vollebæk Ltd.
14 Concorde Gate Suite 500, Niagara, ON, K2E 7S6
Tel: (613) 727-0850

CIVIL ENGINEERS:

Navatech Engineering Consultants Ltd.
Suite 200A, 3401 Midland-Cleveland Drive Ottawa, ON, K2M 1Y6
Tel: (613) 724-8643

LEGEND

- EXISTING TREE TO REMAIN
- GROUP OF EXISTING TREES TO REMAIN
- EXISTING TREE TO BE REMOVED
- GROUP OF EXISTING TREES TO BE REMOVED
- PROPOSED DECIDUOUS TREE
- PROPOSED CONIFEROUS TREE
- PROPOSED SHRUBS / PERENNIALS
- PROPOSED SOD
- PROPOSED TREE PROTECTION FENCE
- PROPOSED 2130mm Ht. WOOD BOARD FENCE

3	REVISED PER CITY COMMENTS	04/10/2019	ML	JL
2	WOOD BOARD FENCE ADDED TO NORTH PROPERTY LINE	03/15/2019	ML	JL
1	ISSUED FOR SITE PLAN CONTROL	10/23/2018	ML	JL

No. Issue Date MUEG/vv DR CK

JAMES B. LENNOX & ASSOCIATES INC.
ARCHITECTS

3332 CARLING AVE. OTTAWA, ONTARIO K2H 5A8
Tel: (613) 722-5168 Fax: 1(866) 343-3942

PROJECT

SPRING VALLEY TRAILS ZENS

ROLLING MEADOW CRESCENT, OTTAWA ON

DRAWING

TREE CONSERVATION REPORT & LANDSCAPE PLAN

STAMP

ASSOCIATION OF LANDSCAPE ARCHITECTS
MEMBER

SCALE

1:250

PROJECT NUMBER

18-CLG-1862

DATE

OCTOBER 2018

PROJECT NORTH

L.1

PLOT SIZE A.1

PROPOSED PLANT LIST						
KEY	QTY.	BOTANICAL NAME	COMMON NAME	SIZE	CONDITION	REMARKS
TREES						
CE	4	Thuja occidentalis 'Multi-Stem'	Multi-Stem White Cedar	1.8m Ht.	B&B	
HL	2	Gleditsia triacanthos	Honey Locust	60mm ø	B&B	
SB	25	Amelanchier canadensis	Serviceberry	60mm ø	B&B	
SHRUBS						
RA	12	Rhus aromatica 'Gro-Low'	Gro-Low Fragrant Sumac	600 mm ht.	Potted	800 mm o.c.
RT	34	Rhus typhina	Staghorn Sumac	600 mm ht.	Potted	1200 mm o.c.
WC	71	Thuja occidentalis 'Clumps'	White Cedar Clumps	1200 mm ht.	Bare Root	500 mm o.c.

EXISTING TREE LIST						
KEY	QTY.	BOTANICAL NAME	COMMON NAME	SIZE	CONDITION	REMARKS
AN	2	Acer negundo	Manitoba Maple	400-450mm DBH.	Good	
AR	4	Acer rubrum	Red Maple	150-300mm DBH.	Good	
BC	9	Prunus serotina	Black Cherry	100-400mm DBH.	Fair-Good	
FR	1	Fraxinus sp.	Ash	1400mm DBH.	Dead	
JN	1	Juglans nigra	Black Walnut	300mm DBH.	Good	
LL	1	Larix laricina	Tamarack	300mm DBH.	Good	
PB	6	Pinus banksiana	Jack Pine	150-200mm DBH.	Good	
PD	*	Populus deltoides	Eastern Cottonwood	100-350mm DBH.	Good	
PG	2	Picea glauca	White Spruce	100-200mm DBH.	Good	
PS	1	Pinus strobus	White Pine	500mm DBH.	Good	
SA	10	Salix sp.	Willow	100-1000mm DBH.	Fair-Good	
TO	*	Thuja occidentalis	Eastern White Cedar	100-200mm DBH.	Good	
UA	3	Ulmus americana	White Elm	250-400mm DBH.	Dead-Poor	
UP	1	Ulmus pumila	Siberian Elm	350mm DBH.	Good	

* DENOTES NUMEROUS

JEFF MCEWEN P.ENG.
MANAGER, DEVELOPMENT REVIEW EAST BRANCH
PLANNING, INFRASTRUCTURE & ECONOMIC
DEVELOPMENT DEPARTMENT, CITY OF OTTAWA

APPROVED
By Jeff McEwen at 2:50 pm, May 15, 2020

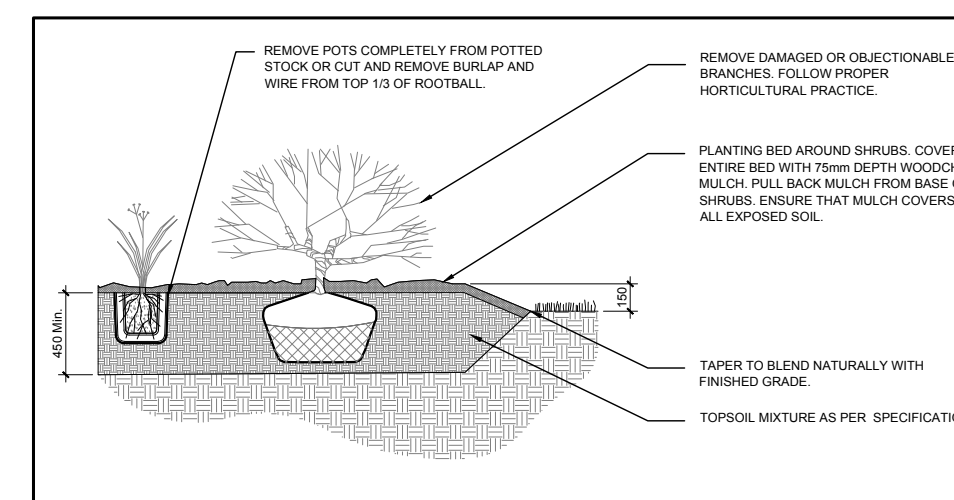

2 SHRUB / PERENNIAL PLANTING
SCALE: NTS

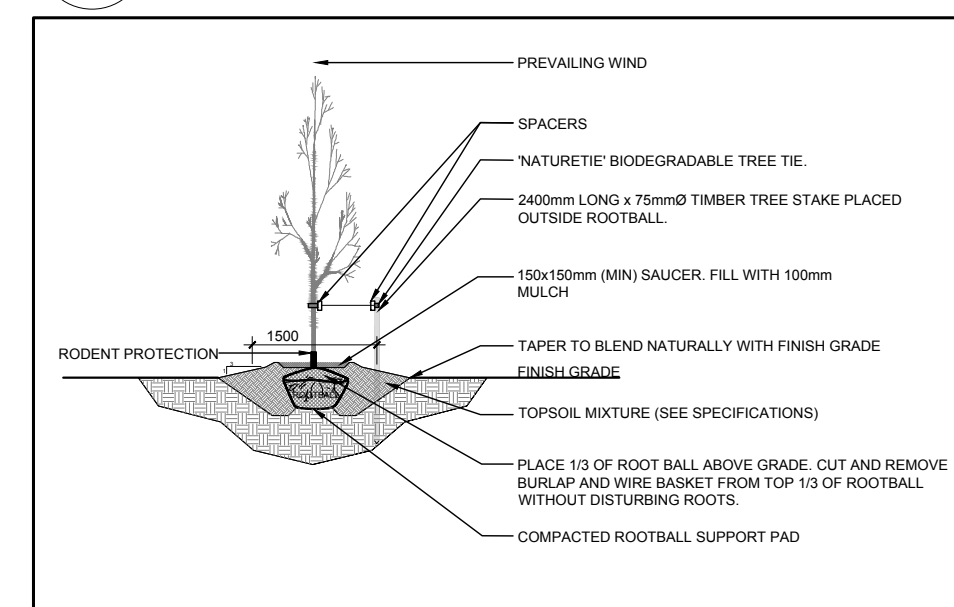

3 DECIDUOUS TREE PLANTING
SCALE: NTS

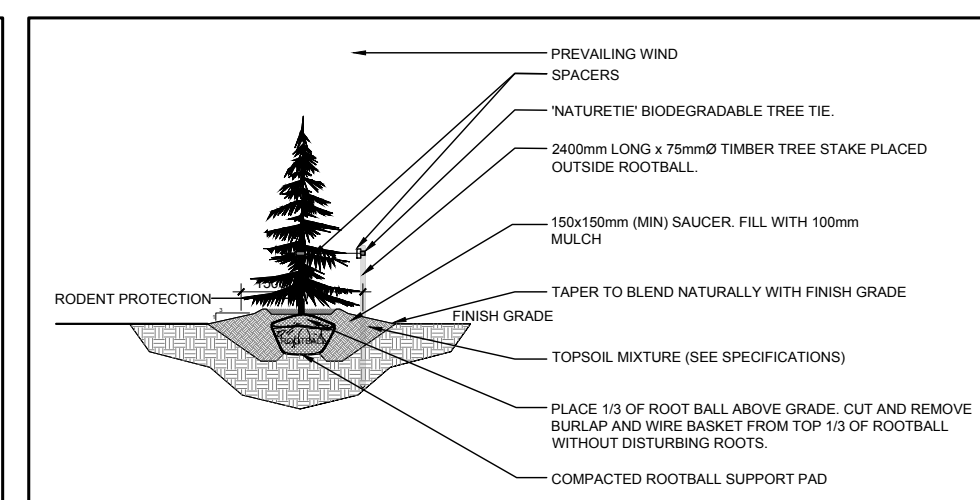

5 CONIFEROUS TREE PLANTING
SCALE: NTS

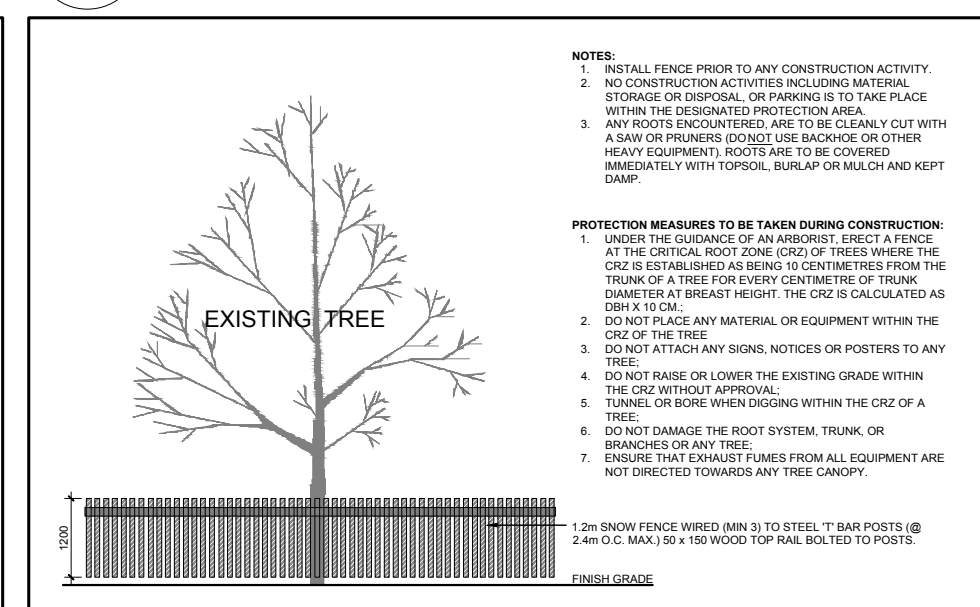

6 TREE PROTECTION FENCE
SCALE: NTS