

CLIENT:
MCROBIE
 ARCHITECTS + INTERIOR DESIGNERS
 DAVID S. MCROBIE ARCHITECTS INC.
 66 Queen St.
 Ottawa, ON
 Tel: (613) 238-2072

CONSULTANTS
 ARCHITECTS:
MCROBIE
 ARCHITECTS + INTERIOR DESIGNERS
 DAVID S. MCROBIE ARCHITECTS INC.
 66 Queen St.
 Ottawa, ON
 Tel: (613) 238-2072

SURVEYORS:
 Annis O'Sullivan Vollebek Inc.
 114 Concourse Gate, Suite 500
 Niagara, ON
 Tel: (913) 727-0860

CIVIL ENGINEERS:
IBI Group
 400-333 Preston Street
 Ottawa, ON
 Tel: (613) 225-1311

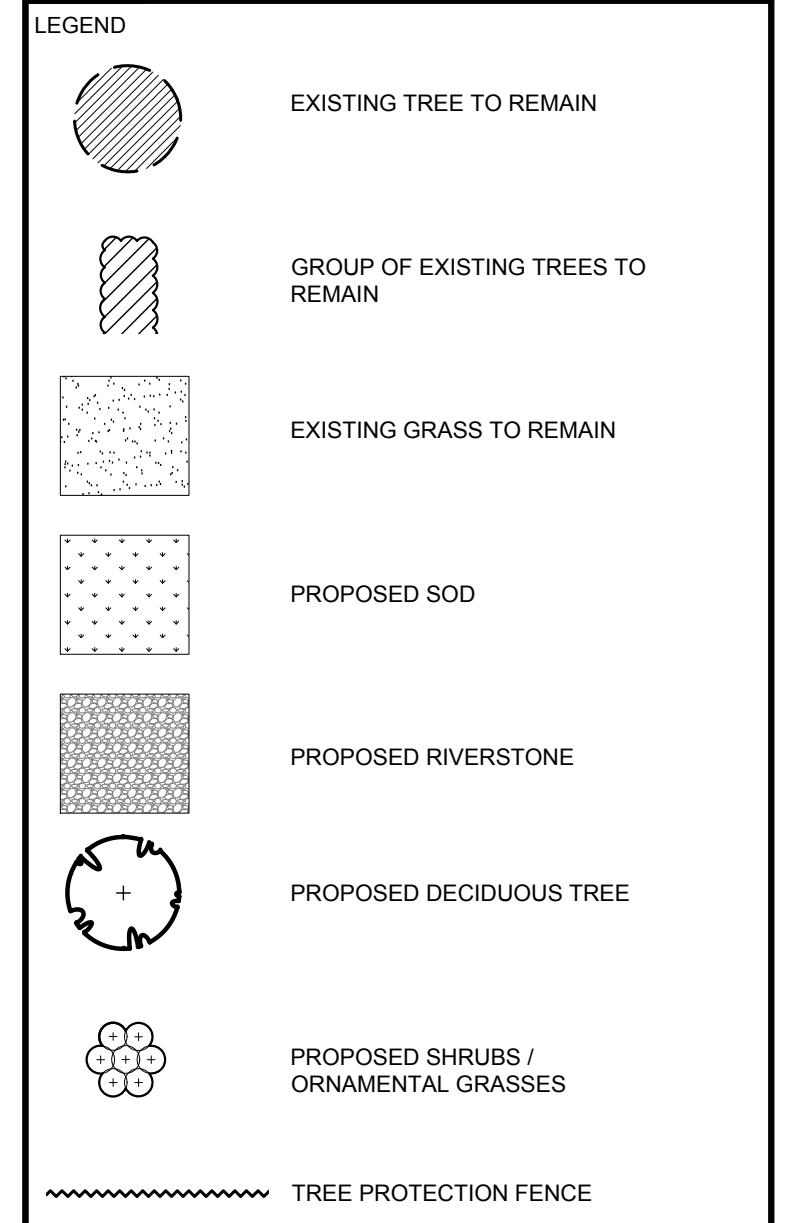

1 TREE CONSERVATION REPORT & LANDSCAPE PLAN
 L.1 SCALE 1:500

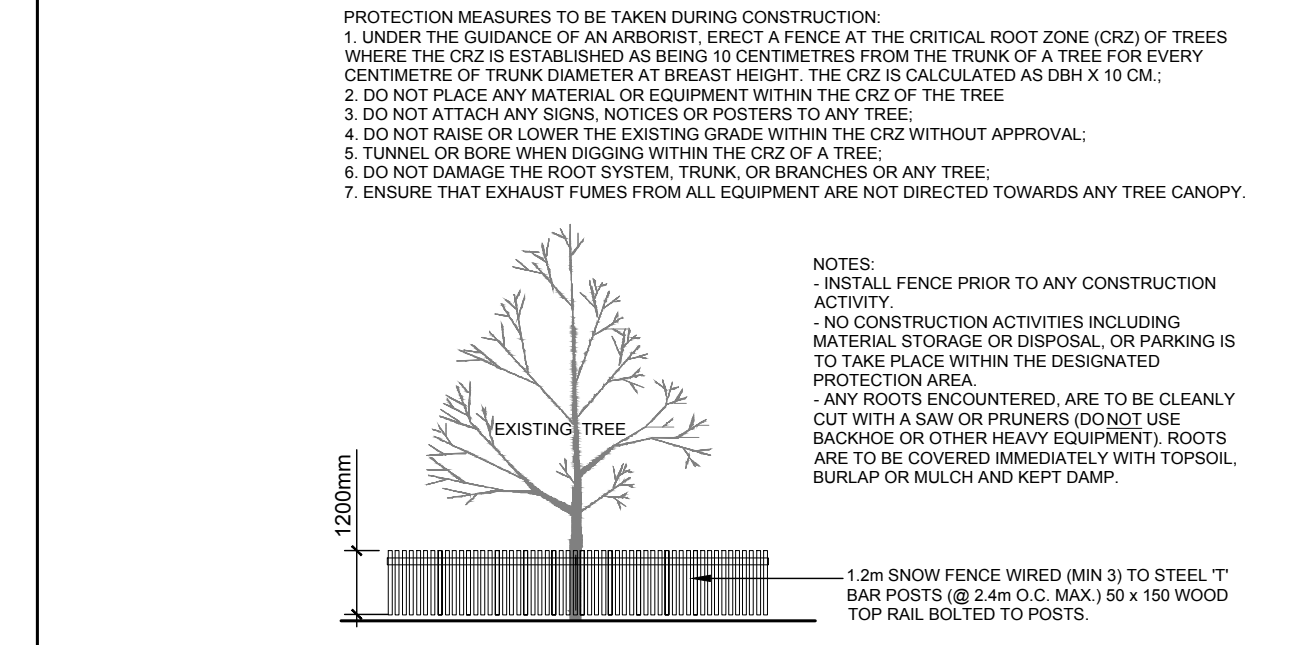
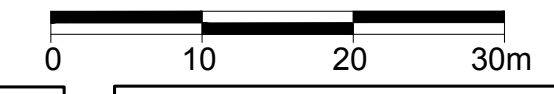

2 TREE PROTECTION FENCE
 L.1 SCALE: NTS

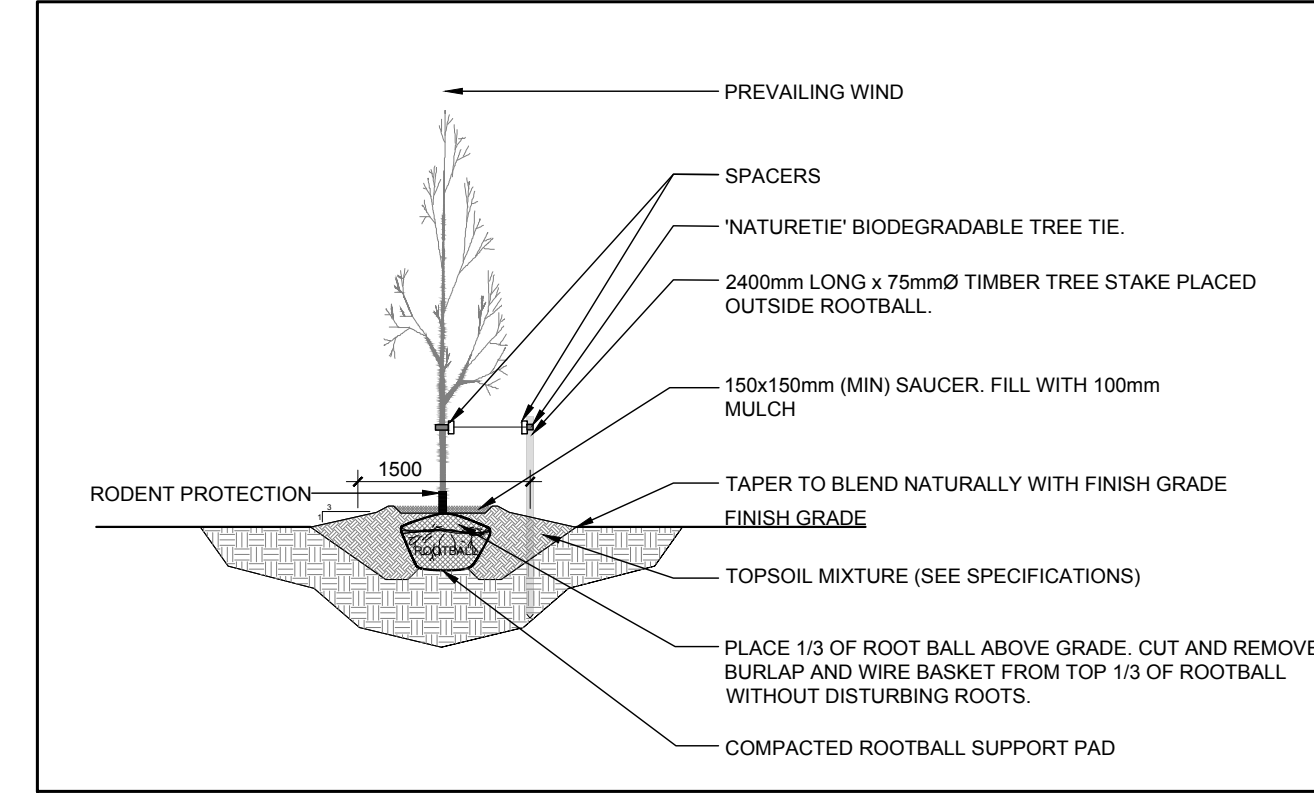

3 DECIDUOUS TREE PLANTING
 L.1 SCALE: NTS

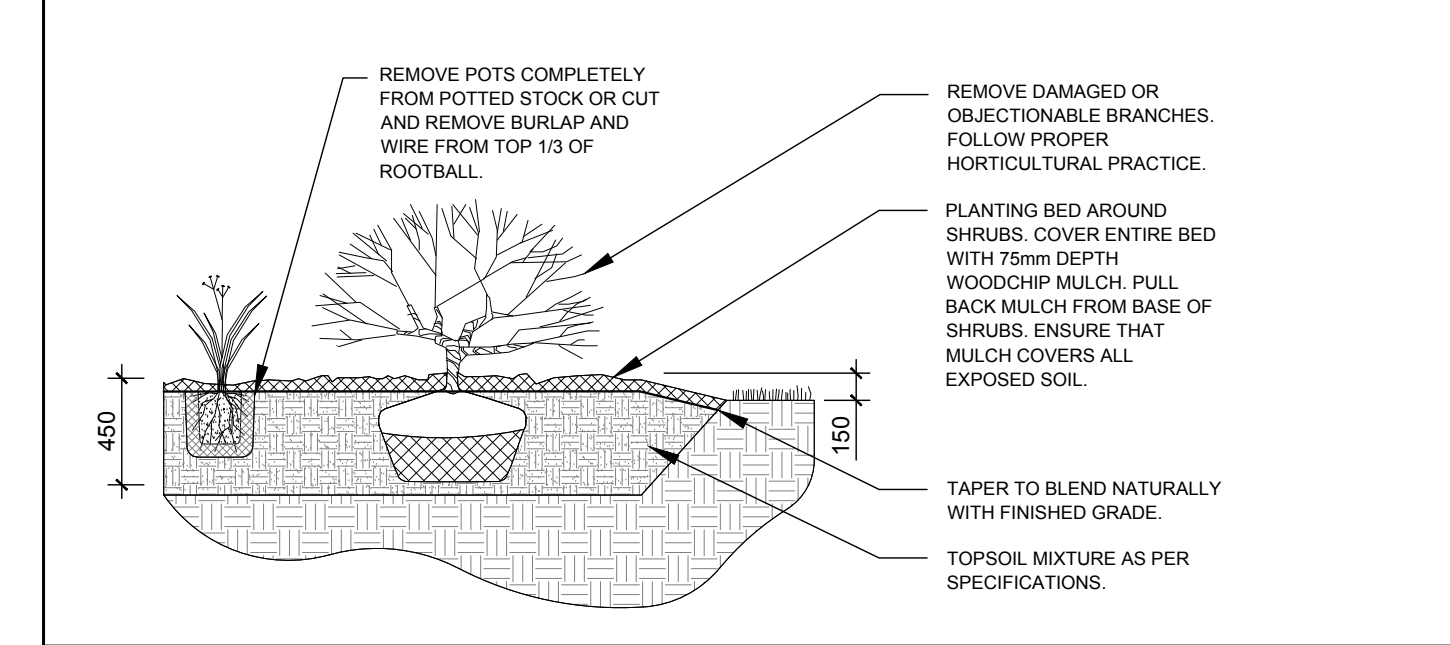

4 SHRUB / ORNAMENTAL GRASS PLANTING
 L.1 SCALE: NTS

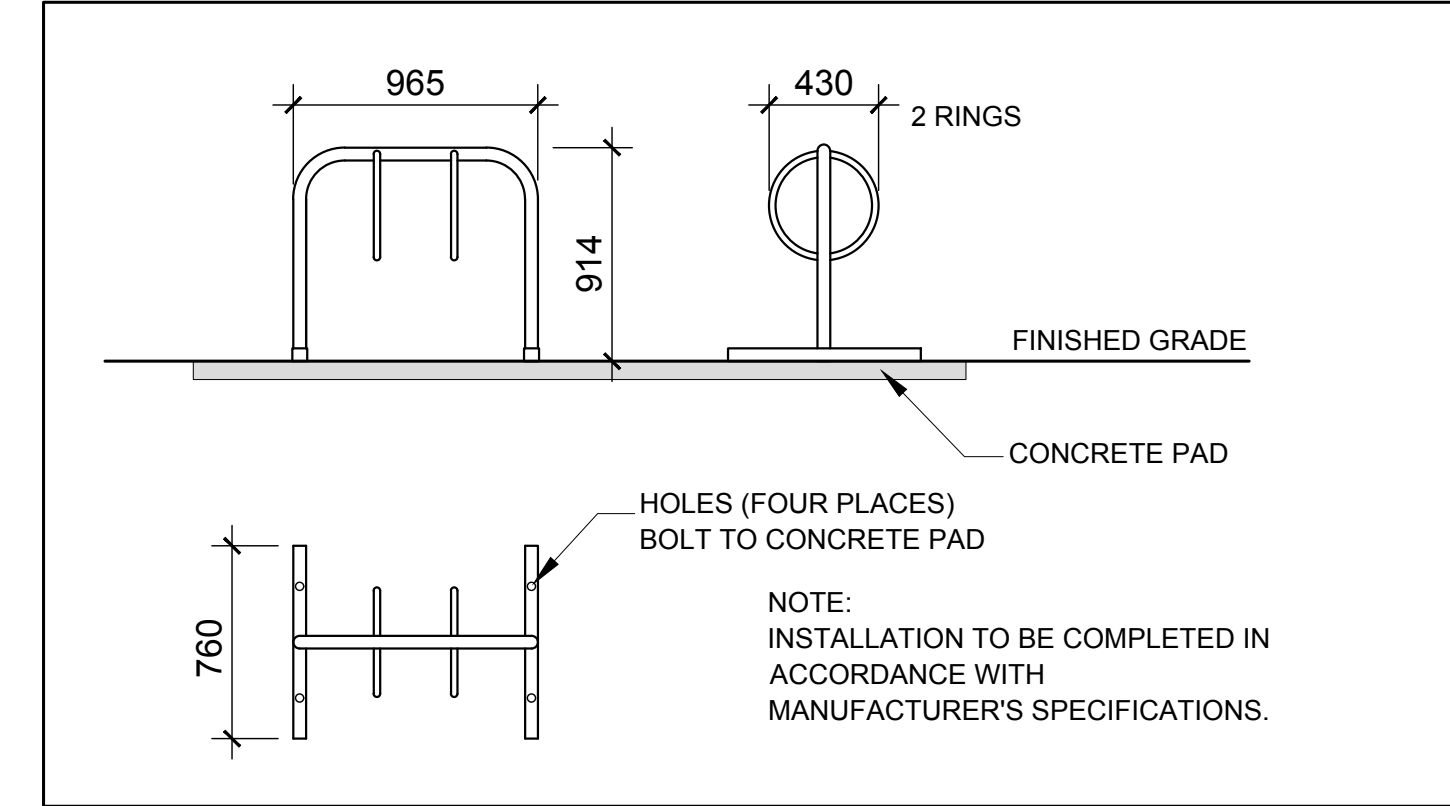

5 PROPOSED TWO (2) RING BIKE RACK
 L.1 SCALE: NTS

EXISTING TREE LIST

KEY	QTY	BOTANICAL NAME	COMMON NAME	SIZE	CONDITION	REMARKS
TREES						
GT	13	Gleditsia triacanthos	Honey Locust	100mm DBH	Fair-Good	See Plan
QR	4	Quercus rubra	Red Oak	100-400mm DBH	Fair-Good	See Plan
TO	7	Thuja occidentalis 'Fastigiata'	Pyramidal White Cedar	100mm DBH	Good	See Plan

PROPOSED PLANT LIST

KEY	QTY	BOTANICAL NAME	COMMON NAME	SIZE	CONDITION	REMARKS
TREES						
FM	4	Acer x freemanii	Freeman's Maple	60mmø	B&B	Space 8000mm O.C.
HB	3	Celtis occidentalis	Hackberry	60mmø	B&B	Space 8000mm O.C.
HL	5	Gleditsia triacanthos	Honey Locust	60mmø	B&B	Space 8000mm O.C.
SHRUBS						
FS	10	Sorbaria sorbifolia 'Sem'	Sem False Spirea	600mm Ht.	Potted	Space 800mm O.C.
RA	55	Rhus aromatica	Fragrant Sumac	600mm Ht.	Potted	Space 800mm O.C.
ORNAMENTAL GRASSES						
KF	89	Calamagrostis acutiflora 'Karl Foerster'	Feather Reed Grass	250mm Pot.	Potted	Space 800mm O.C.
SG	19	Panicum virgatum 'Prairie Fire'	Prairie Fire Switchgrass	250mm Pot.	Potted	Space 800mm O.C.

GENERAL NOTES:

- It is the responsibility of the appropriate contractor or official to report any errors, omissions or discrepancies on this plan with actual site conditions to the Landscape Architect before proceeding with construction.
- The contractor is to notify all utility companies and authorities prior to any excavation and ascertain locations of underground services.
- The contractor is to reinstate all areas and items damaged as a result of construction activity.
- The contractor is to comply with all pertinent codes and by-laws.
- The contractor is to maintain a positive surface run-off throughout the entire construction period.
- The Landscape Architect is not responsible for subsurface conditions.
- The contractor is to identify all existing trees to remain on site with the Landscape Architect prior to construction.
- The contractor is to stake the proposed location of all plant material in conjunction with the Landscape Architect prior to excavation.
- Minimum distances for selected deciduous trees are as follows:
 - Building Foundations 7.5m
 - Sidewalks 1.5m
 - Public Streets 2.5m
 - Underground Infrastructure 2.0m
- All trees within 1m of underground utility trenches are to be excavated by hand.
- Remove all protective wrapping from tree trunks after installation.
- Staking of trees shall only be performed if necessary.
- Ensure that mulch is pulled back a min. distance of 75mm from base of tree trunk.

No.	Issue	Date	ML	JL
1	ISSUED FOR SITE PLAN CONTROL	08/20/2018		

JAMES B. LENNOX & ASSOCIATES INC.
 LANDSCAPE ARCHITECTS
 3333 CARLING AVE. OTTAWA, ONTARIO K2H 5A8
 Tel: (613) 722-5168 Fax: (866) 343-3942

PROJECT
 NEW DEVELOPMENT PAD
 HAZELDEAN ROAD AND CARBROOKE STREET, OTTAWA ON

DRAWING
 TREE CONSERVATION REPORT & LANDSCAPE PLAN

SCALE
 AS SHOWN

START DATE
 JUNE 2018

PROJECT NO.
 18-MIS-1848

PROJECT NORTH

DRAWING NO.
L.1

PLOT SIZE ARCH-D