

Stantec Consulting Ltd.
400 - 1331 Clyde Avenue
Ottawa ON
Tel. 613.722.4420
www.stantec.com

Copyright Reserved

The Contractor shall verify and be responsible for all dimensions. DO NOT scale the drawing - any errors or omissions shall be reported to Stantec without delay.
The Copyrights to all designs and drawings are the property of Stantec. Reproduction or use for any purpose other than that authorized by Stantec is forbidden.

Legend

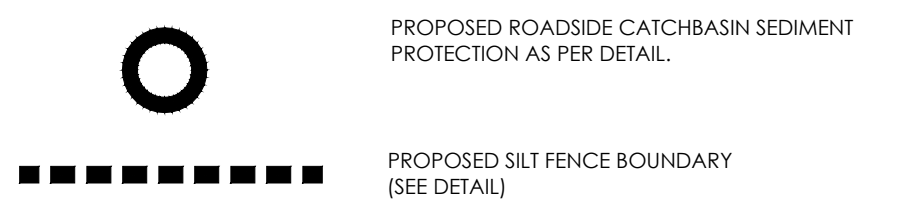

GENERAL NOTES

1. ALL WORK SHALL BE CARRIED OUT IN COMPLIANCE WITH THE ONTARIO OCCUPATIONAL HEALTH AND SAFETY ACT AND REGULATIONS FOR CONSTRUCTION PROJECTS.
2. ALL WORK AND MATERIALS TO CONFORM WITH CURRENT MINISTRY OF THE ENVIRONMENT & ENERGY OF ONTARIO, CITY OF OTTAWA AND ONTARIO PROVINCIAL STANDARDS AND SPECIFICATIONS. LOCAL UTILITY STANDARDS AND MINISTRY OF TRANSPORTATION STANDARDS WILL APPLY WHERE REQUIRED.
3. **SITE PLAN**
PREPARED BY: ROSALINE J. HILL
DATED: FEBRUARY 3, 2021
DRAWING: A1.1 - SITE PLAN
SITE BENCHMARK
PROVIDED BY: ANNIS, O'SULLIVAN, AND VOLLEBEKK LTD.
LOCATION / DESCRIPTION: TOP OF SPINDLE OF EX. SOUTHWEST FIRE HYDRANT ON BEDALE DRIVE ELEV=65.20
TOPO SURVEY
PREPARED BY: ANNIS, O'SULLIVAN, AND VOLLEBEKK LTD.
DATED: AUGUST 14, 2015
4. THE CONTRACTOR IS ADVISED THAT WORKS BY OTHERS MAY BE ONGOING DURING THE PERIOD OF THIS CONTRACT. THE CONTRACTOR SHALL COORDINATE CONSTRUCTION ACTIVITIES AND COORDINATION WITH ALL OTHER CONTRACTORS AND PREVENT CONSTRUCTION CONFLICTS.
5. THE INFORMATION SHOWN FOR EXISTING UTILITIES WAS PROVIDED BY OTHERS. THE CONTRACTOR IS RESPONSIBLE FOR LOCATING AND VERIFYING ALL UTILITIES DURING CONSTRUCTION. ALL EXISTING UTILITIES MUST BE LOCATED AND VERIFIED BY EACH UTILITY PRIOR TO COMMENCEMENT OF WORK. ANY VARIANCE IS TO BE IMMEDIATELY REPORTED TO THE ENGINEER. LOST TIME DUE TO FAILURE OF THE CONTRACTOR TO CONFIRM UTILITY LOCATIONS AND NOTIFY THE ENGINEER OF POSSIBLE CONFLICTS PRIOR TO CONSTRUCTION WILL BE AT THE CONTRACTOR'S EXPENSE.
6. ALL CONSTRUCTION SHALL BE CARRIED OUT IN ACCORDANCE WITH THE RECOMMENDATIONS MADE IN THE GEOTECHNICAL REPORT PG3682-1 PREPARED BY PATERSON GROUP INC. DATED JANUARY 6, 2016.
7. THE CONTRACTOR IS RESPONSIBLE FOR OBTAINING ALL PERMITS REQUIRED AND TO BEAR THE COST OF SAME INCLUDING WATER PERMIT AND ASSOCIATED COSTS.
8. ALL DISTURBED AREAS SHALL BE RESTORED TO EQUAL OR BETTER CONDITION TO THE SATISFACTION OF THE ENGINEER AND THE CITY. PAVEMENT RESTORATION FOR SERVICE AND UTILITY CUTS SHALL BE IN ACCORDANCE WITH DETAIL R10 ON DWG GP-1.
9. FOR DETAILS RELATING TO STORMWATER MANAGEMENT AND ROOF DRAINAGE, SEE THE STORMWATER MANAGEMENT REPORT PREPARED BY STANTEC CONSULTING LTD. ROOF DRAINAGE TO BE PROVIDED VIA RESTRICTED FLOW ROOF DRAINS.
10. BENCHMARKS: IT IS THE RESPONSIBILITY OF THE CONTRACTOR TO VERIFY THAT THE SITE BENCHMARK(S) HAS NOT BEEN ALTERED OR DISTURBED AND THAT ITS RELATIVE ELEVATION AND DESCRIPTION AGREES WITH THE INFORMATION SHOWN ON DRAWING GP-1.
11. THE CONTRACTOR SHALL PROVIDE TO THE ENGINEER 1 (ONE) SET OF AS CONSTRUCTED SITE SERVING, DRAINING, AND SITE ELECTRICAL DWGS.
12. SANITARY AND WATER SERVICE SIZED TO BE CONFIRMED BY MECHANICAL CONSULTANT AT DETAILED DESIGN.

5	REVISED AS PER CITY COMMENTS	WAJ	SGG	21.04.01
4	REVISED AS PER CITY COMMENTS	WAJ	SGG	21.02.11
3	REVISED SITE PLAN AND SURVEY	WAJ	SGG	20.10.01
2	2nd SUBMISSION: SITE PLAN APPROVAL	WAJ	SGG	16.12.01
1	1st SUBMISSION: SITE PLAN APPROVAL	WAJ	SGG	16.01.22
Revision		By	Appd.	YY.MM.DD
File Name: 160401218-EC		WAJ	SGG	WAJ
		Dwn.	Chkd.	Dsgn.
				16.01.08
				YY.MM.DD

Permit/Seal

Client/Project
CARDEL DEVELOPMENTS LTD

3368 CARLING AVE

OTTAWA, ON

Title

SEDIMENT & EROSION CONTROL PLAN AND DETAIL SHEET

Project No.	Scale	0	1.5	4.5	7.5m
160401218	1:150				
Drawing No.	Sheet	Revision			
EC/DS-1	3 of 4	5			

Best Management Practices

- CONTRACTOR TO PROVIDE EROSION AND SEDIMENT CONTROLS (BEST MANAGEMENT PRACTICES) DURING CONSTRUCTION OF THIS PROJECT.
- EROSION MUST BE MINIMIZED AND SEDIMENTS MUST BE REMOVED FROM CONSTRUCTION SITE RUN-OFF IN ORDER TO PROTECT DOWNSTREAM AREAS. DURING ALL CONSTRUCTION, EROSION AND SEDIMENTATION SHOULD BE CONTROLLED BY THE FOLLOWING TECHNIQUES:
1. LIMIT THE EXTENT OF EXPOSED SOILS AT ANY GIVEN TIME.
 2. REVEGETATE EXPOSED AREAS AND SLOPES AS SOON AS POSSIBLE.
 3. MINIMIZE AREA TO BE CLEARED AND GRUBBED.
 4. PROTECT EXPOSED SLOPES WITH PLASTIC OR SYNTHETIC MULCHES.
 5. INSTALL FILTER CLOTH BETWEEN FRAME AND COVER ON ALL PROPOSED CATCH BASINS AND CATCH BASIN MANHOLES AND ON ALL EXISTING CATCH BASINS THAT WILL RECEIVE RUN-OFF FROM THE SITE.
 6. A SILT FENCE SHALL BE INSTALLED AROUND THE PERIMETER OF ALL AND ANY STOCKPILES OF MATERIAL TO BE USED OR REMOVED FROM SITE.
 7. A VISUAL INSPECTION SHALL BE DONE DAILY ON SEDIMENT CONTROL MEASURES AND CLEANED OF ANY ACCUMULATED SILT AS REQUIRED. THE DEPOSITS WILL BE DISPOSED OFF SITE AS PER THE REQUIREMENTS OF THE CONTRACT.
 8. SEDIMENT CONTROL BARRIERS MAY ONLY BE REMOVED TEMPORARILY WITH APPROVAL OF CONTRACT ADMINISTRATOR TO ACCOMMODATE CONSTRUCTION OPERATIONS. ALL AFFECTED BARRIERS MUST BE REINSTITATED AT NIGHT WHEN CONSTRUCTION IS COMPLETED. NO REMOVAL WILL OCCUR IF THERE IS A SIGNIFICANT RAINFALL EVENT ANTICIPATED (>10mm) UNLESS A NEW DEVICE HAS BEEN INSTALLED TO PROTECT THE EXISTING STORM AND SANITARY SEWER SYSTEMS.
 9. NO REFUELING OR CLEANING OF EQUIPMENT IS PERMITTED NEAR ANY EXISTING WATERWAY.
 10. CONTRACTOR SHALL REMOVE SEDIMENT CONTROL MEASURES WHEN, IN THE OPINION OF THE CONTRACT ADMINISTRATOR, THE MEASURE(S) IS NO LONGER REQUIRED. NO CONTROL MEASURES SHALL BE PERMANENTLY REMOVED WITHOUT PRIOR WRITTEN AUTHORIZATION FROM THE CONTRACT ADMINISTRATOR.
 11. THE CONTRACTOR SHALL PERIODICALLY, OR WHEN REQUESTED BY THE CONTRACT ADMINISTRATOR, CLEAN OUT ACCUMULATED SEDIMENTS AS REQUIRED.
 12. THE CONTRACTOR SHALL IMMEDIATELY REPORT TO THE ENGINEER ANY ACCIDENTAL DISCHARGES OF SEDIMENT MATERIAL INTO THE WATERCOURSE. APPROPRIATE RESPONSE MEASURES, INCLUDING ANY REPAIRS TO EXISTING CONTROL MEASURES OR THE IMPLEMENTATION OF ADDITIONAL CONTROL MEASURES, SHALL BE CARRIED OUT BY THE CONTRACTOR WITHOUT DELAY.

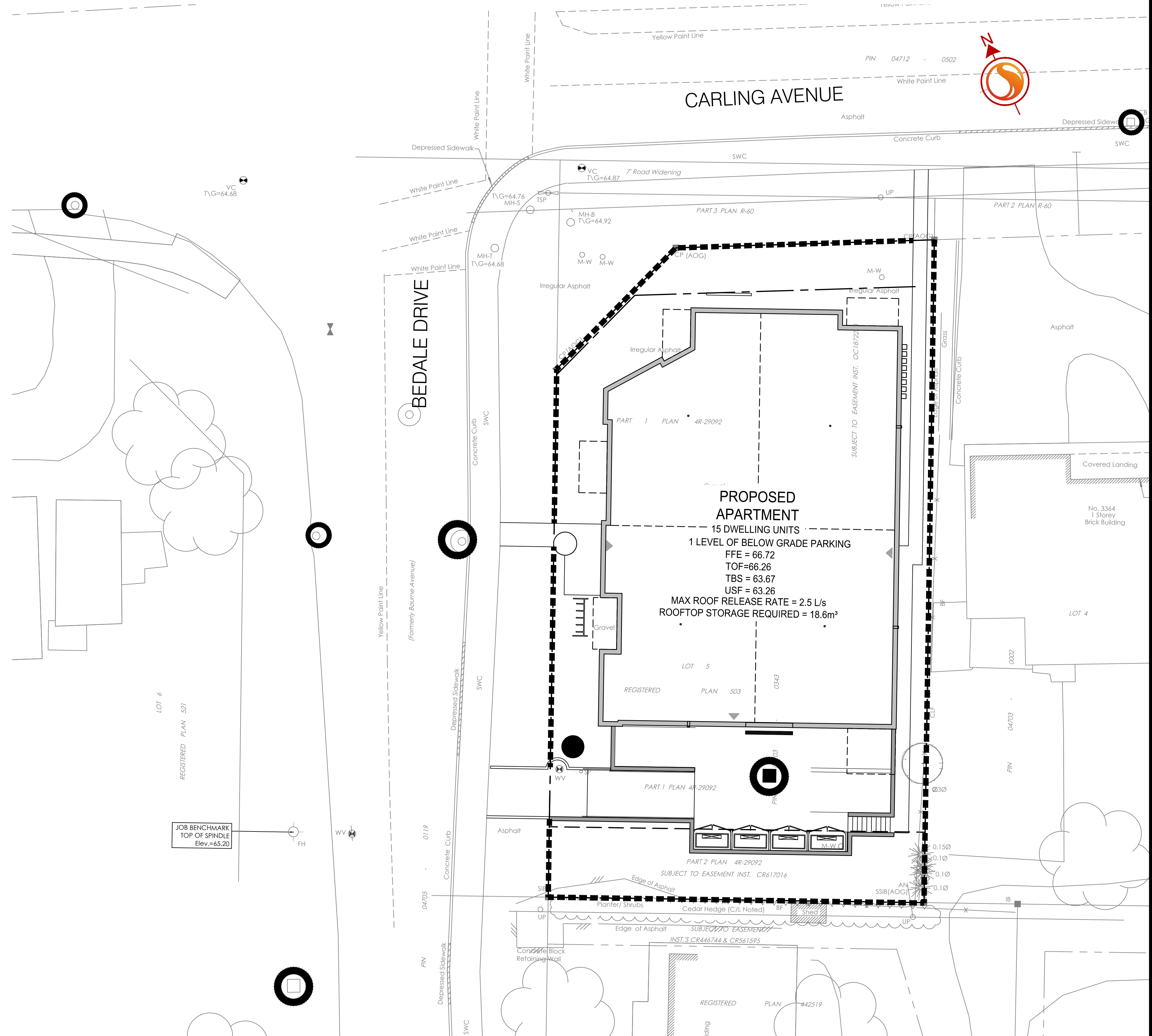
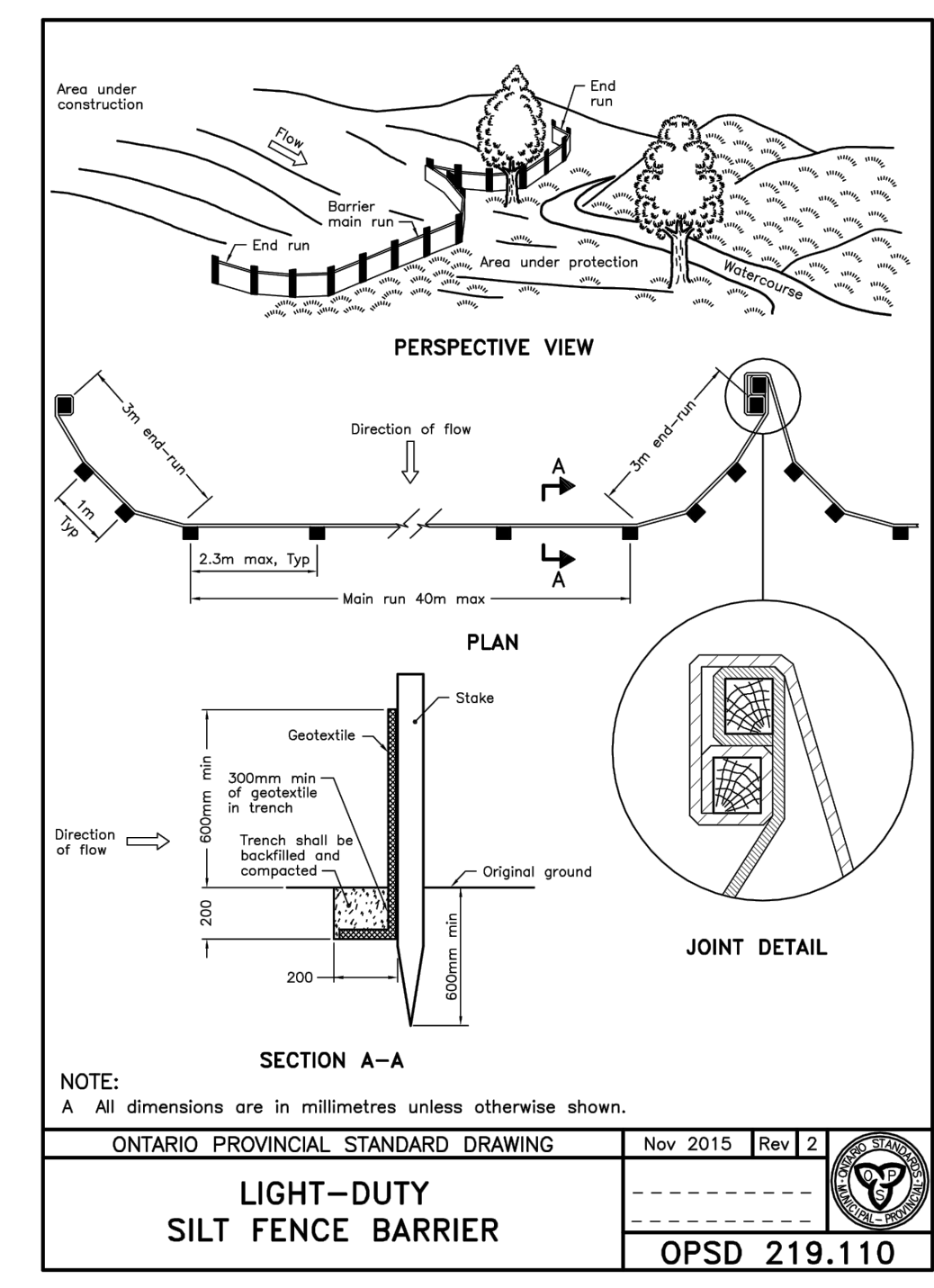
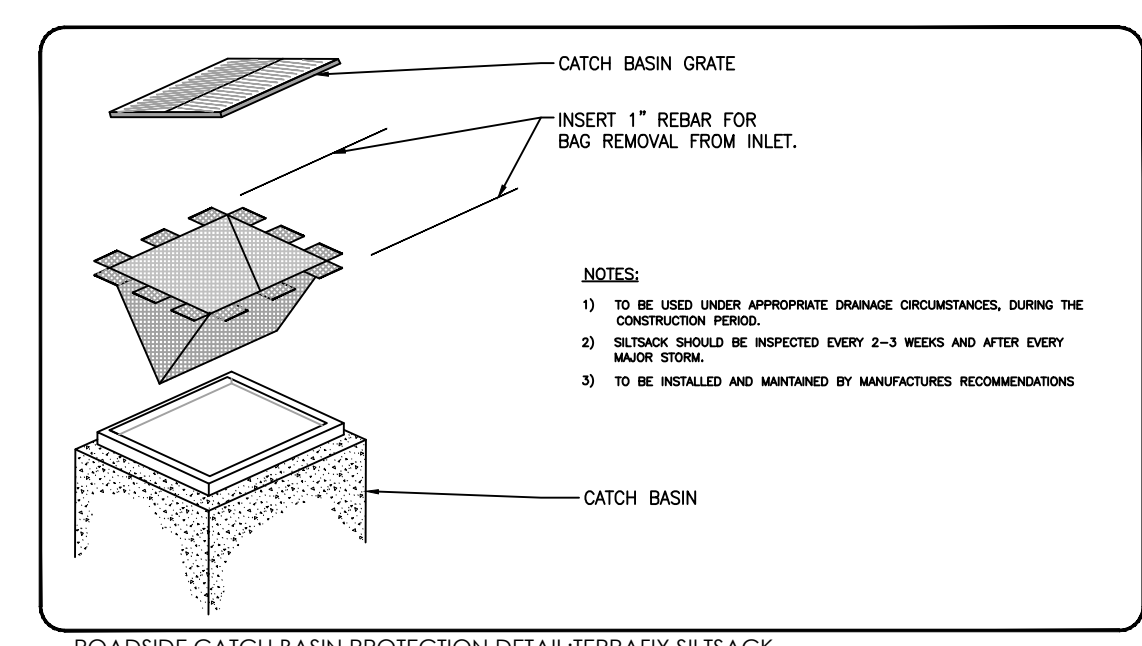

V:\016040\active\160401218_3368 Carling Ave (res. 2023)\design\drawing\160401218-EC.dwg
2023/03/01 12:14 PM by: jblinson, wozner