

\\c:\p\m\Drawings\B+CAD\2014\1411089 - 900 Albert Street\Technical\Drawings - Land Area\BIM\CENTRAL FILES\1411089\_BHL\_LANDSCAPE\_900 Albert\_BLDG\_82018\_CURRENT.rvt  
LANDSCAPE PLAN

3/19/2018 9:20:19 AM  
L0-01

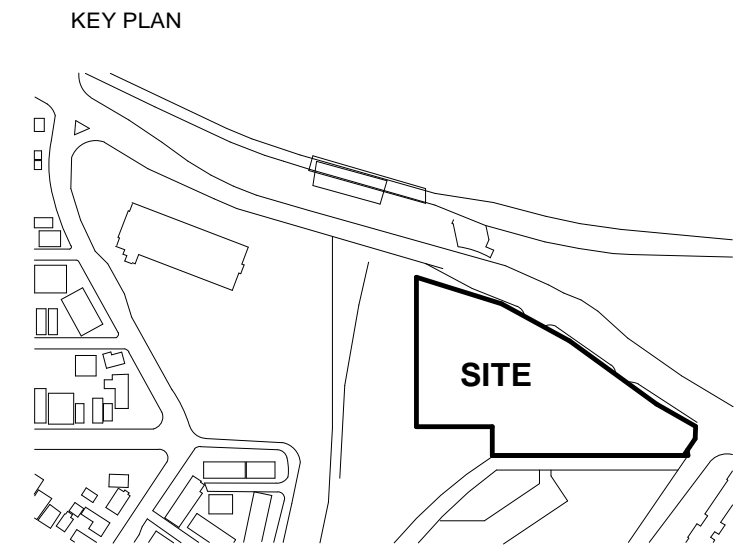
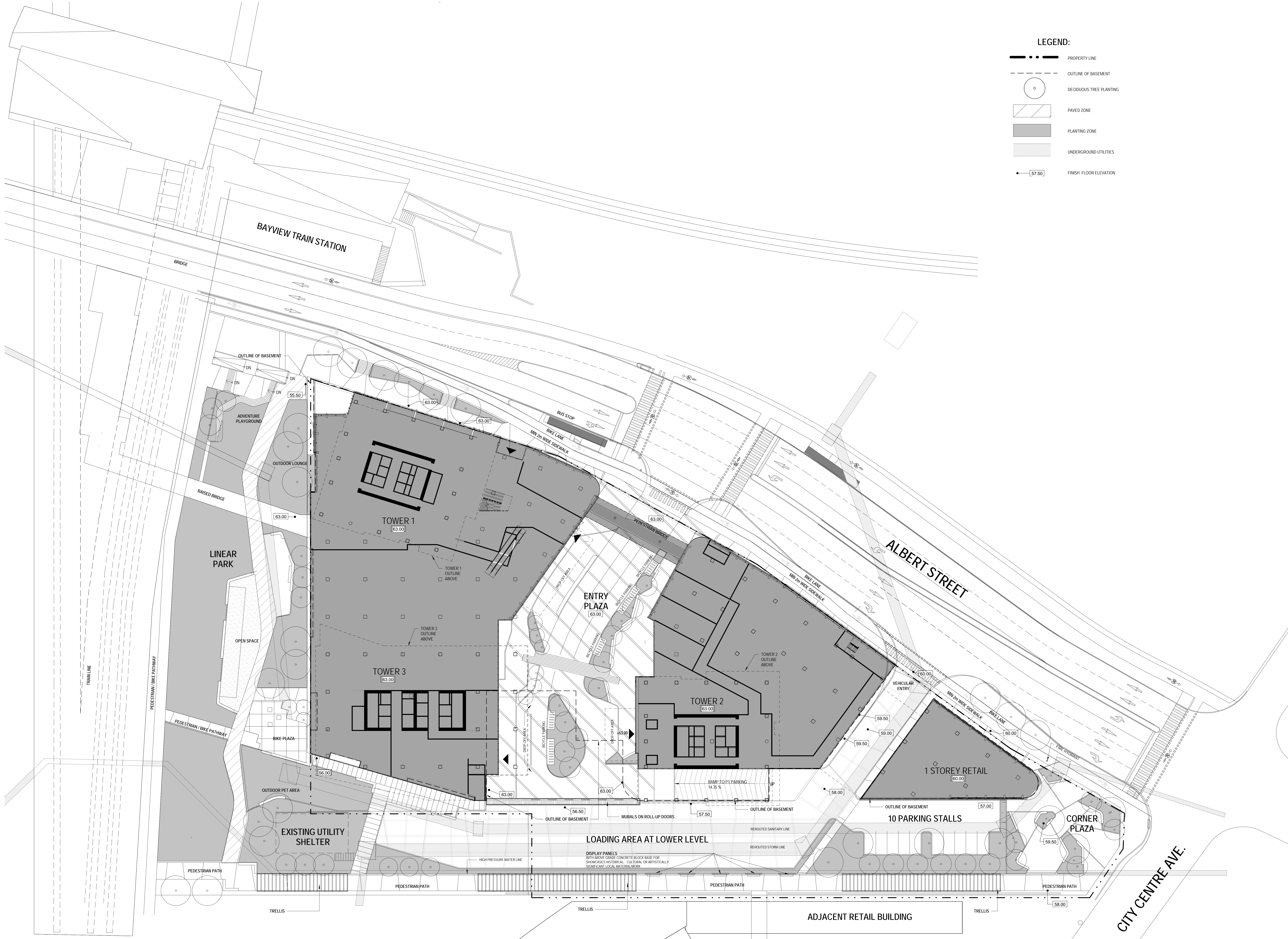

NOT FOR CONSTRUCTION

PRELIMINARY CONCEPT DESIGN

REVISION		
NO.	DATE	DESCRIPTION
1	02/26/2016	ISSUED FOR ZBA/OPA
2	09/11/2016	ISSUED FOR SPA
3	19/03/2018	ISSUED FOR ZBA/OPA

\*All areas are preliminary and do not allow for all shafts, vertical penetrations, final life safety/exit stairs and corridors, and Structural, Mechanical and Electrical spaces not yet designed. It is recommended that for any preliminary pro forma calculations, appropriate deduction allowances should be made for retail rentable areas, residential unit counts and areas, and office areas. All parking and loading floor areas and space counts are preliminary and subject to change due to as yet unconfirmed SMEP and parking ratio requirements. Ratio requirements are still under discussion between Trinity, the City of Ottawa and the design team.



PROJECT ADDRESS:  
900 ALBERT ST  
OTTAWA ON

**B+H** B+H Architects  
481 University Avenue, Suite 300  
Toronto, ON M5G 2H4  
T:416.596.2299 F:416.586.0599

CLIENT:  
**TIP Albert GP Inc.**  
485 Bank St., Suite 200  
Ottawa, ON K2P 1Z2  
1 416.414.2761

ARCHITECT OF RECORD & LANDSCAPE ARCHITECT:  
**B+H**

481 University Avenue, Suite 300  
Toronto, ON M5G 2H4  
1 416.596.2299 F 416.586.0599

ARCHITECT:  
**GGLO**  
1301 First Avenue, Suite 301  
Seattle, Washington 98101  
1 206.467.5828 F 206.467.0627

TRANSPORTATION:  
**PARSONS**  
1223 Michael Street Suite 100  
Ottawa, Ontario K1J 1T2  
1 613-738-4160 F 613-739-7105

URBAN DESIGN:  
**FoTenn**  
223 McLeod Street  
Ottawa, Ontario K2P 029  
1 613-730-5709 F 613-730-1136

STRUCTURAL ENGINEER  
**ENTUFTIVE**  
303 University Ave, Suite 700  
Toronto, Ontario M5H 3C6  
1 416-477-6530

SITE SERVICES/CIVIL ENGINEER:  
**David Schaeffer Engineering**  
120 Iser Road, Suite 103  
Ottawa, Ontario K2B 1E9  
1 613.836.0856 F 613.836.7183

MECHANICAL ENGINEER:  
**TMP Consulting Engineers**  
285 Yorkville Blvd.  
Toronto, Ontario, M2J 1S5  
1 416-499-8000 F 416-499-7446

ELECTRICAL ENGINEER:  
**Mulvey & Banani International**  
44 Mobile Dr.  
Toronto, Ontario, M2J 1S5  
1 416.751.2520

CODE CONSULTANT:  
**LMDG**  
Suite 206, 300 North Queen Street  
Toronto, Ontario M5C 5K4  
1 416.646.0162 F 416.646.0165

PROJECT:  
**900 ALBERT  
OTTAWA**

SHEET CONTENTS:  
**LANDSCAPE PLAN**

PROJECT NUMBER:  
**1411089**

DRAWING SCALE:  
**As indicated**

SHEET NO.:  
**L0-01**

3/19/2018 9:20:19 AM

1 LANDSCAPE PLAN  
1:300