

ST. LAURENT BOULEVARD

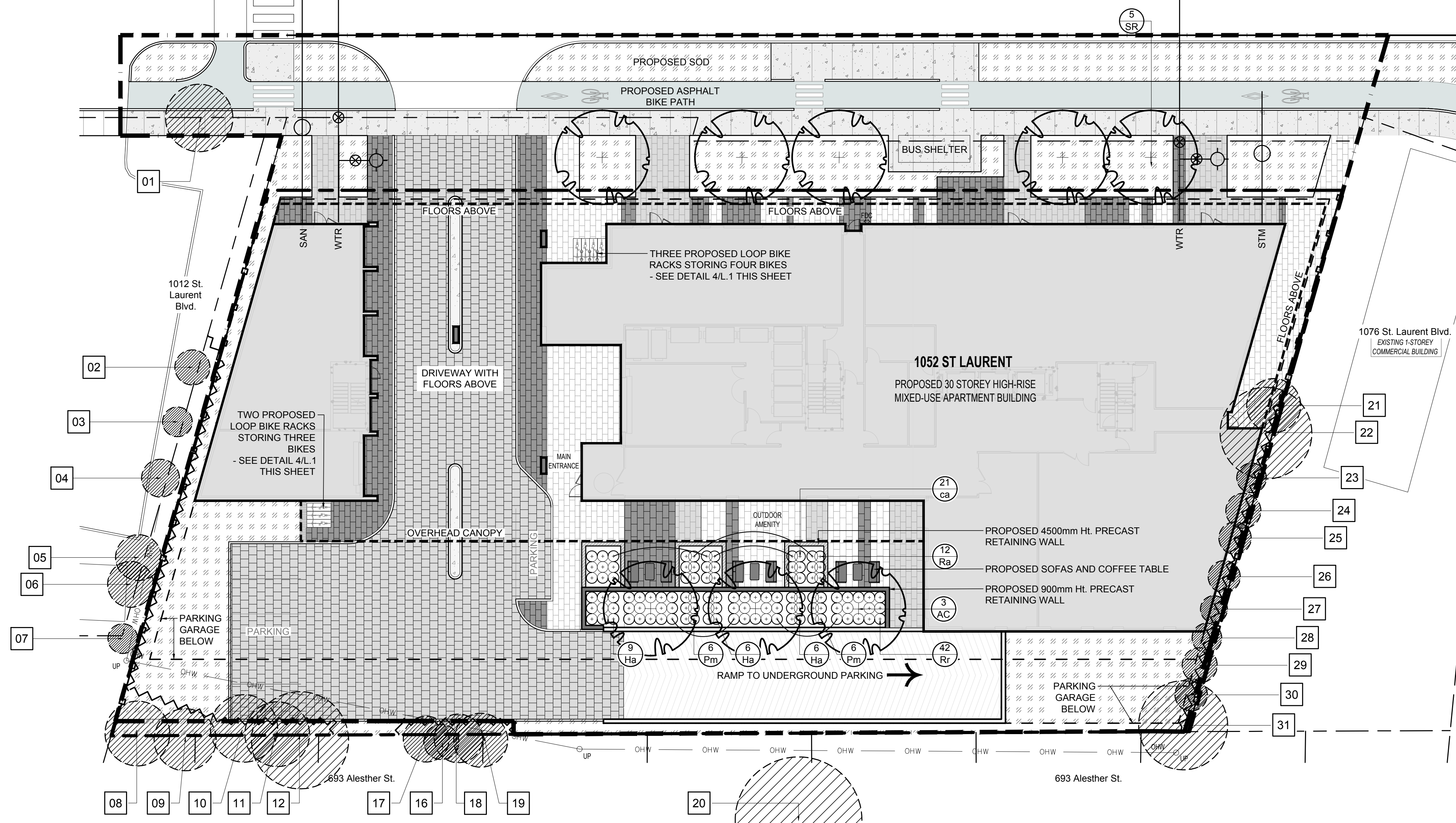

1 LANDSCAPE PLAN
L.1 SCALE 1:200

PROPOSED PLANT LIST

KEY	QTY.	BOTANICAL NAME	COMMON NAME	SIZE	CONDITION	REMARKS
DECIDUOUS TREES						
AC	3	<i>Amelanchier canadensis</i>	Shadblow Serviceberry	50mm cal	B&B	
SR	5	<i>Syringa reticulata</i>	Japanese Tree Lilac	50mm cal	B&B	
SHRUBS						
Ha	21	<i>Hydrangea arborescens</i> 'Annabelle'	Annabelle Hydrangea	3 gal. pot	Potted	Space 800mm o.c.
Pm	12	<i>Pinus mugo</i> 'Pumilio'	Dwarf Mugo Pine	600mm spr.	Potted	Space 800mm o.c.
Ra	12	<i>Rhus aromatica</i> 'Gro-Low'	Grow-Low Fragrant Sumac	500mm ht.	Potted	Space 800mm o.c.
Rr	42	<i>Rosa rugosa</i>	Rugosa Rose	800mm ht.	Potted	Space 800mm o.c.
PERENNIALS/ ORNAMENTAL GRASSES						
ca	21	<i>Calamagrostis x acutiflora</i> 'Karl Foerster'	Karl Foerster Grass	250mm pot	Potted	Space 800mm o.c.

- GENERAL NOTES**
- IT IS THE RESPONSIBILITY OF THE APPROPRIATE CONTRACTOR OR OFFICIAL TO REPORT ANY ERRORS, OMISSIONS OR DISCREPANCIES ON THIS PLAN WITH ACTUAL SITE CONDITIONS TO THE LANDSCAPE ARCHITECT BEFORE PROCEEDING WITH CONSTRUCTION.
 - THE CONTRACTOR IS TO NOTIFY ALL UTILITY COMPANIES AND AUTHORITIES PRIOR TO ANY EXCAVATION AND ASCERTAIN LOCATIONS OF UNDERGROUND SERVICES.
 - THE CONTRACTOR IS TO REINSTATE ALL AREAS AND ITEMS DAMAGED AS A RESULT OF CONSTRUCTION ACTIVITY.
 - THE CONTRACTOR IS TO COMPLY WITH ALL PERTINENT CODES AND BY-LAWS.
 - THE CONTRACTOR IS TO MAINTAIN A POSITIVE SURFACE RUN-OFF THROUGHOUT THE ENTIRE CONSTRUCTION PERIOD.
 - THE LANDSCAPE ARCHITECT IS NOT RESPONSIBLE FOR SUBSURFACE CONDITIONS.
 - THE CONTRACTOR IS TO IDENTIFY ALL EXISTING TREES TO REMAIN ON SITE WITH THE LANDSCAPE ARCHITECT PRIOR TO CONSTRUCTION.
 - THE CONTRACTOR IS TO STAKE THE PROPOSED LOCATION OF ALL PLANT MATERIAL IN CONJUNCTION WITH THE LANDSCAPE ARCHITECT PRIOR TO CONSTRUCTION.
 - MINIMUM DISTANCES FOR SELECTED DECIDUOUS TREES ARE AS FOLLOWS:
 - BUILDING FOUNDATIONS - 7.5M
 - SIDEWALKS - 1.5M
 - PUBLIC STREETS - 2.5M
 - UNDERGROUND INFRASTRUCTURE - 2.0M
 - ALL TREES WITHIN 1M OF UNDERGROUND UTILITY TRENCHES ARE TO BE EXCAVATED BY HAND.
 - REMOVE ALL PROTECTIVE WRAPPING FROM TREE TRUNKS AFTER INSTALLATION.
 - STAKING OF TREES SHALL ONLY BE PERFORMED IF NECESSARY.
 - ENSURE THAT MULCH IS PULLED BACK A MINIMUM DISTANCE OF 75MM FROM BASE OF TREE TRUNK.

40-YEAR CANOPY COVER CALCULATION

3,218 m ² site area
(8) Proposed Small Deciduous Trees (7m ² ea.)
Existing canopy cover: 115m ²
=171m ² canopy cover =5.3% canopy cover
* Small Deciduous Trees calculated at 3m spread.

EXISTING TREES: #

FOR FURTHER INFORMATION REGARDING THE EXISTING TREES, PLEASE REFER TO THE TREE INFORMATION PLAN PREPARED BY THE IFS GROUP, SEPTEMBER 28th, 2025.

LEGAL DESCRIPTION

PART OF LOTS 1, 2, 3 & 4
REGISTERED PLAN 79
CITY OF OTTAWA

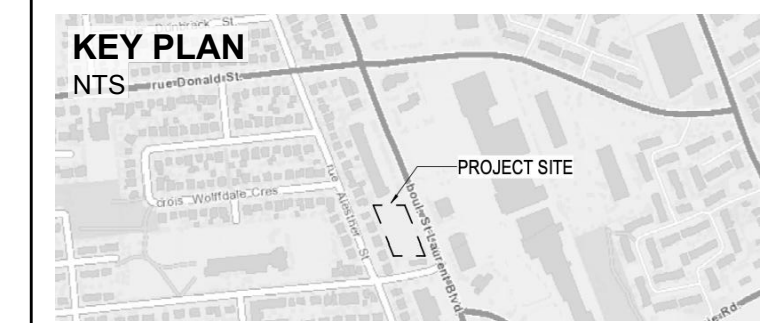

CLIENT
1001182489 Ontario Inc.

CONSULTANTS
ARCHITECTS
project1 studio
Project 1 Studio Incorporated
(613) 884-9339 | info@project1studio.ca

CIVIL ENGINEERS
NOVATECH
Suite 200, 240 Michael Cowpland Drive
Ottawa, Ontario, Canada K2M 1P6

LEGEND

- EXISTING TREE TO REMAIN
- PROPOSED DECIDUOUS TREE
- PROPOSED CONIFEROUS TREE
- PROPOSED SHRUBS/ PERENNIALS
- PROPOSED TREE PROTECTION FENCE
- PROPOSED 1.8m HL. PRIVACY SCREEN
- PROPERTY LINE
- LIMIT OF CONSTRUCTION
- PROPOSED SOD
- PROPOSED PRECAST PAVER TYPE 1
- PROPOSED PRECAST PAVER TYPE 2
- PROPOSED PRECAST PAVER TYPE 3
- PROPOSED HEAVY DUTY PRECAST PAVERS
- PROPOSED CONCRETE PAVING (SEE ARCH)
- PROPOSED ASPHALT BIKE LANE (SEE ARCH)
- PROPOSED LOOP BIKE RACK

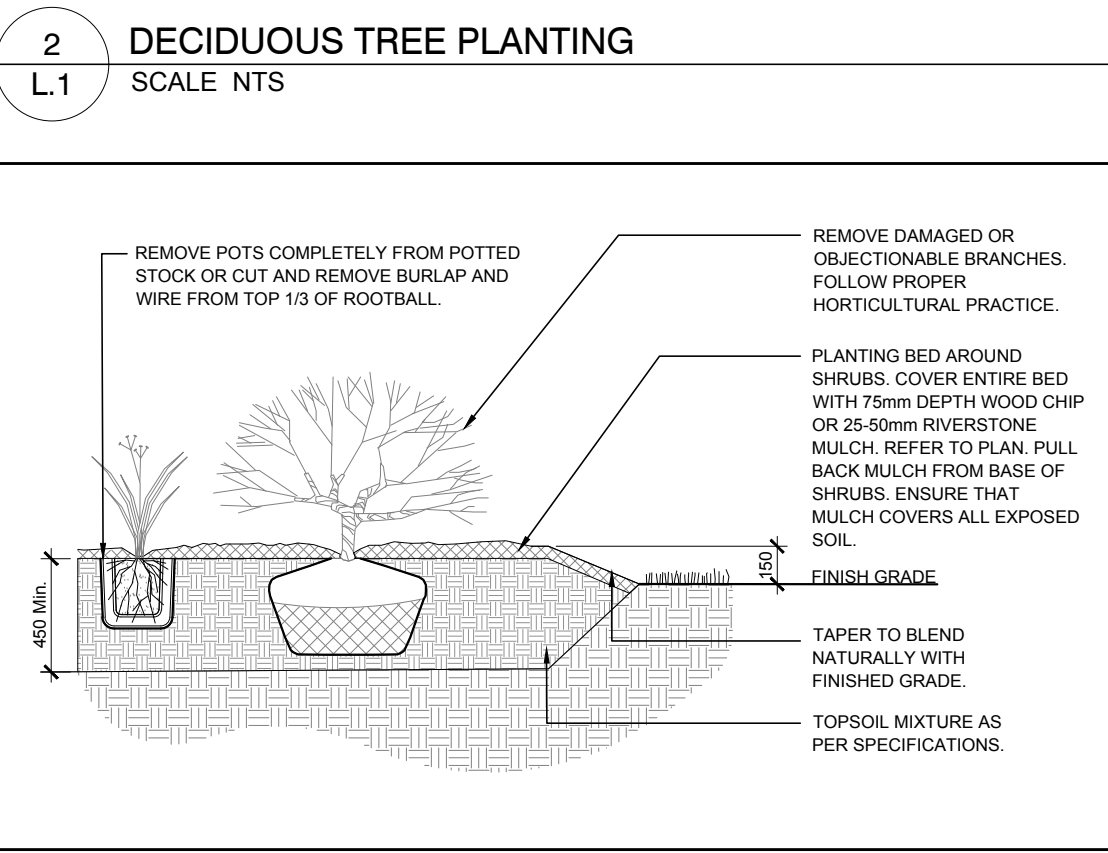
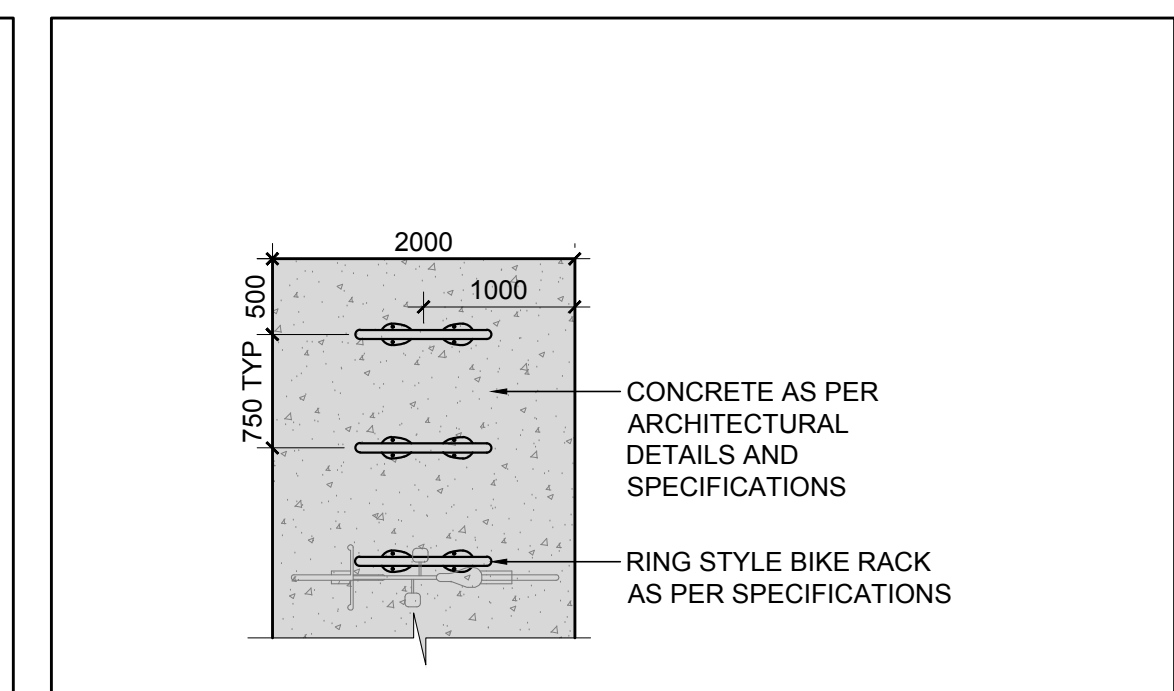
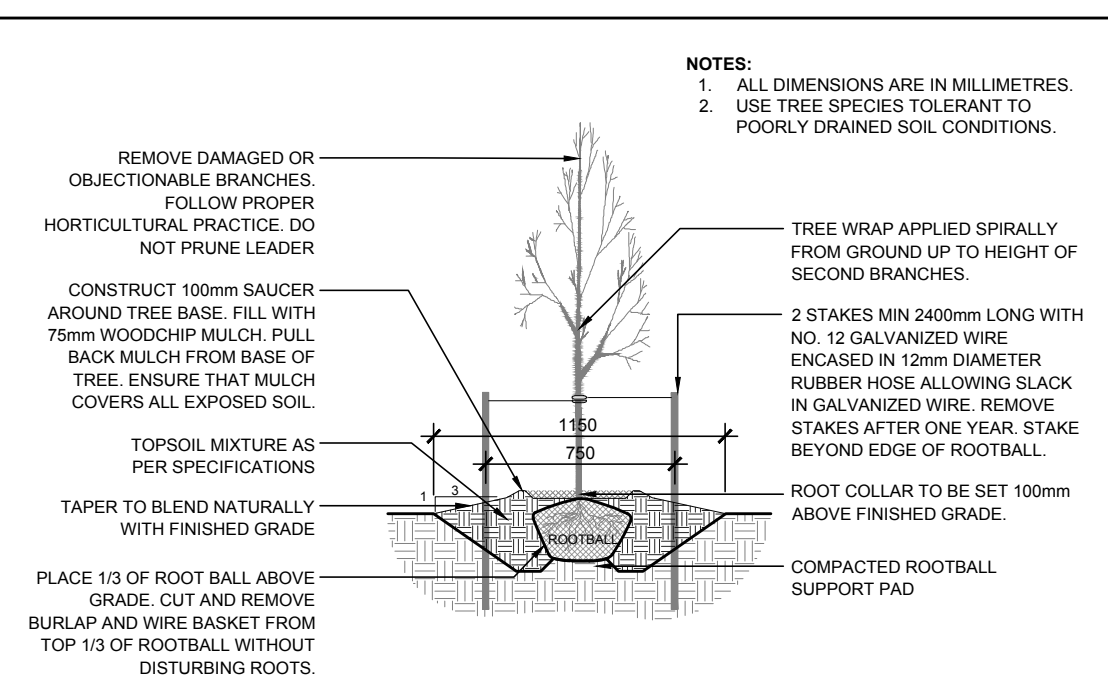

4	ISSUED FOR SPA RESUBMISSION	09/06/2026	WF	JL
3	ISSUED FOR RE-ZONING	10/21/2025	WF	JL
2	TCR UPDATE ACCORDING TO THE IFS GROUP	16/09/2025	CAT	JL
1	ISSUED FOR DISCUSSION AND REVIEW	04/09/2025	ML	JL

No. Issue Date DR CK

JAMES B. LENNOX & ASSOCIATES INC.
LANDSCAPE ARCHITECTS
3332 CARLING AVE. OTTAWA, ONTARIO K2H 5A8
Tel: (613) 722-5168 Fax: (613) 343-3942

PROJECT
PROPOSED MIXED USE HIGH RISE BUILDING
1052 ST. LAURENT BOULEVARD, OTTAWA ON

DRAWING
LANDSCAPE PLAN

STAMP
ASSOCIATION OF LANDSCAPE ARCHITECTS
MEMBER
JBL

SCALE
AS SHOWN

START DATE
JULY 2025

PROJECT NO.
25MIS2535

PROJECT NORTH

DRAWING NO.
L.1

PLOT SIZE ARCH-D