

Contractor shall check all dimensions on the work and report any discrepancy to the Landscape Architect before proceeding. All drawings and specifications are the property of the Landscape Architect and must be returned at the completion of the work. This drawing is not to be used for construction until signed by the Landscape Architect.

- GENERAL NOTES:
1. ALL DIMENSIONS IN MILLIMETERS UNLESS SPECIFIED OTHERWISE. DO NOT SCALE DRAWING. ALL DRAWINGS TO BE READ IN CONJUNCTION WITH WRITTEN SPECIFICATIONS.
  2. THIS DRAWING MAY NOT BE USED FOR CONSTRUCTION UNTIL SIGNED BY THE LANDSCAPE ARCHITECT. IT IS THE RESPONSIBILITY OF THE CONTRACTOR TO:
    - CHECK AND VERIFY ALL DIMENSIONS ON SITE
    - REPORT ALL ERRORS AND/OR OMISSIONS TO THE CONTRACT ADMINISTRATOR
    - COMPLY WITH ALL PERTINENT CODES AND BY-LAWS
    - CHECK AND VERIFY LOCATIONS OF ALL UNDERGROUND SERVICES WITH ALL LOCAL UTILITIES PRIOR TO ANY DIGGING
  3. ANY AREAS BEYOND THE LIMIT OF THE SITE DISTURBED DURING CONSTRUCTION SHALL BE RESTORED TO ORIGINAL CONDITION OR BETTER TO THE SATISFACTION OF THE AUTHORITY HAVING JURISDICTION AT THE CONTRACTOR'S EXPENSE.
  4. ALL WORK SHALL BE COMPLETED IN ACCORDANCE WITH THE 'OCCUPATIONAL HEALTH AND SAFETY ACT AND REGULATIONS FOR CONSTRUCTION PROJECTS'. THE GENERAL CONTRACTOR SHALL BE DEEMED TO BE THE 'CONTRACTOR' AS DEFINED IN THE ACT.
  5. THERE WILL BE NO SUBSTITUTION OF MATERIALS UNLESS PRIOR WRITTEN APPROVAL IS RECEIVED FROM THE CONTRACT ADMINISTRATOR.
  6. THE CONTRACTOR IS RESPONSIBLE FOR OBTAINING ALL PERMITS REQUIRED AND TO BEAR THE COST OF THE SAME.
  7. BENCHMARKS: IT IS THE RESPONSIBILITY OF THE CONTRACTOR TO VERIFY THAT THE SITE BENCHMARK(S) HAS NOT BEEN ALTERED OR DISTURBED AND THAT ITS RELATIVE ELEVATION AND DESCRIPTION AGREES WITH THE INFORMATION DEPICTED ON THIS PLAN.

No.	Description	Date
1	Issued for Site Plan Approval	23-05-15
Revision		
City Approval Stamp		

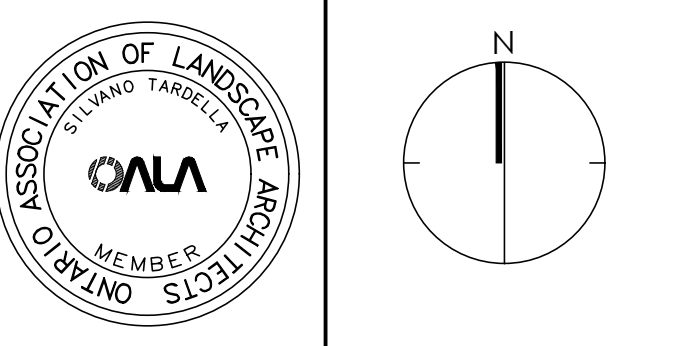

**NAK**  
design strategies

1285 WELLINGTON STREET, OTTAWA, ON K1Y 3A8 CANADA  
T 613.237.2345 NAKDESIGNSTRATEGIES.COM  
Project

265 CATHERINE STREET  
OTTAWA ONTARIO

Title	LANDSCAPE PLAN GROUND FLOOR	
Date	2023-02-03	Sheet
Scale	1:250	L1.0
Drawn	JC/SC	
Checked	SC	
Job No.	23-015	



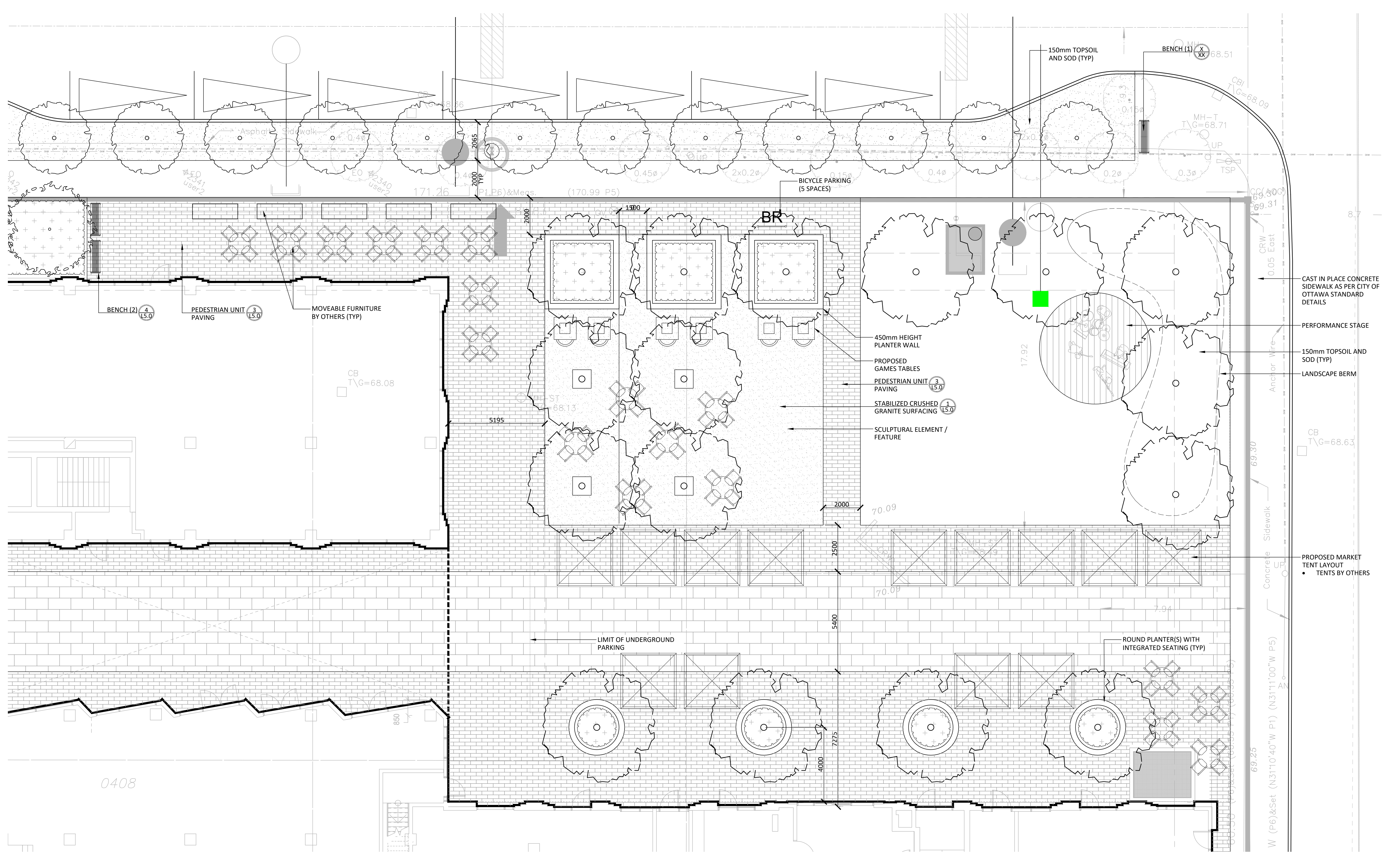

Contractor shall check all dimensions on the work and report any discrepancy to the Landscape Architect before proceeding. All drawings and specifications are the property of the Landscape Architect and must be returned at the completion of the work. This drawing is not to be used for construction until signed by the Landscape Architect.

- GENERAL NOTES:
- ALL DIMENSIONS IN MILLIMETERS UNLESS SPECIFIED OTHERWISE. DO NOT SCALE DRAWING. ALL DRAWINGS TO BE READ IN CONJUNCTION WITH WRITTEN SPECIFICATIONS.
  - THIS DRAWING MAY NOT BE USED FOR CONSTRUCTION UNTIL SIGNED BY THE LANDSCAPE ARCHITECT. IT IS THE RESPONSIBILITY OF THE CONTRACTOR TO:
    - CHECK AND VERIFY ALL DIMENSIONS ON SITE
    - REPORT ALL ERRORS AND/OR OMISSIONS TO THE CONTRACT ADMINISTRATOR
    - COMPLY WITH ALL PERTINENT CODES AND BY-LAWS
    - CHECK AND VERIFY LOCATIONS OF ALL UNDERGROUND SERVICES WITH ALL LOCAL UTILITIES PRIOR TO ANY DIGGING
  - ANY AREAS BEYOND THE LIMIT OF THE SITE DISTURBED DURING CONSTRUCTION SHALL BE RESTORED TO ORIGINAL CONDITION OR BETTER TO THE SATISFACTION OF THE AUTHORITY HAVING JURISDICTION AT THE CONTRACTOR'S EXPENSE.
  - ALL WORK SHALL BE COMPLETED IN ACCORDANCE WITH THE 'OCCUPATIONAL HEALTH AND SAFETY ACT AND REGULATIONS FOR CONSTRUCTION PROJECTS'. THE GENERAL CONTRACTOR SHALL BE DEEMED TO BE THE 'CONTRACTOR' AS DEFINED IN THE ACT.
  - THERE WILL BE NO SUBSTITUTION OF MATERIALS UNLESS PRIOR WRITTEN APPROVAL IS RECEIVED FROM THE CONTRACT ADMINISTRATOR.
  - THE CONTRACTOR IS RESPONSIBLE FOR OBTAINING ALL PERMITS REQUIRED AND TO BEAR THE COST OF THE SAME.
  - BENCHMARKS: IT IS THE RESPONSIBILITY OF THE CONTRACTOR TO VERIFY THAT THE SITE BENCHMARK(S) HAS NOT BEEN ALTERED OR DISTURBED AND THAT ITS RELATIVE ELEVATION AND DESCRIPTION AGREES WITH THE INFORMATION DEPICTED ON THIS PLAN.

No.	Description	Date
1	Issued for Site Plan Approval	23-05-15

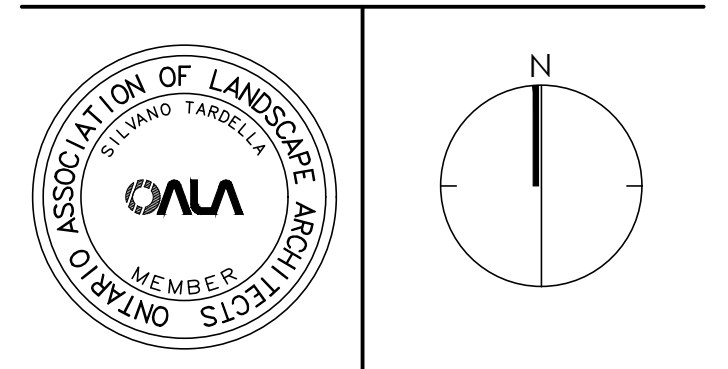

**NAK**  
design strategies

1285 WELLINGTON STREET, OTTAWA, ON K1Y 3A8 CANADA  
T 613.237.2345 NAKDESIGNSTRATEGIES.COM  
Project

265 CATHERINE STREET  
OTTAWA ONTARIO

Title	
LANDSCAPE PLAN GROUND FLOOR	
Date	2023-02-03
Scale	1:250
Drawn	JC/SC
Checked	SC
Job No.	23-015
Sheet	L1.0







Contractor shall check all dimensions on the work and report any discrepancy to the Landscape Architect before proceeding. All drawings and specifications are the property of the Landscape Architect and must be returned at the completion of the work. This drawing is not to be used for construction until signed by the Landscape Architect.

- GENERAL NOTES:
1. ALL DIMENSIONS IN MILLIMETERS UNLESS SPECIFIED OTHERWISE. DO NOT SCALE DRAWING. ALL DRAWINGS TO BE READ IN CONJUNCTION WITH WRITTEN SPECIFICATIONS.
  2. THIS DRAWING MAY NOT BE USED FOR CONSTRUCTION UNTIL SIGNED BY THE LANDSCAPE ARCHITECT. IT IS THE RESPONSIBILITY OF THE CONTRACTOR TO:
    - CHECK AND VERIFY ALL DIMENSIONS ON SITE
    - REPORT ALL ERRORS AND/OR OMISSIONS TO THE CONTRACT ADMINISTRATOR
    - COMPLY WITH ALL PERTINENT CODES AND BY-LAWS
    - CHECK AND VERIFY LOCATIONS OF ALL UNDERGROUND SERVICES WITH ALL LOCAL UTILITIES PRIOR TO ANY DIGGING
  3. ANY AREAS BEYOND THE LIMIT OF THE SITE DISTURBED DURING CONSTRUCTION SHALL BE RESTORED TO ORIGINAL CONDITION OR BETTER TO THE SATISFACTION OF THE AUTHORITY HAVING JURISDICTION AT THE CONTRACTOR'S EXPENSE.
  4. ALL WORK SHALL BE COMPLETED IN ACCORDANCE WITH THE 'OCCUPATIONAL HEALTH AND SAFETY ACT AND REGULATIONS FOR CONSTRUCTION PROJECTS.' THE GENERAL CONTRACTOR SHALL BE DEEMED TO BE THE 'CONSTRUCTOR' AS DEFINED IN THE ACT.
  5. THERE WILL BE NO SUBSTITUTION OF MATERIALS UNLESS PRIOR WRITTEN APPROVAL IS RECEIVED FROM THE CONTRACT ADMINISTRATOR.
  6. THE CONTRACTOR IS RESPONSIBLE FOR OBTAINING ALL PERMITS REQUIRED AND TO BEAR THE COST OF THE SAME.
  7. BENCHMARKS: IT IS THE RESPONSIBILITY OF THE CONTRACTOR TO VERIFY THAT THE SITE BENCHMARK(S) HAS NOT BEEN ALTERED OR DISTURBED AND THAT ITS RELATIVE ELEVATION AND DESCRIPTION AGREES WITH THE INFORMATION DEPICTED ON THIS PLAN.

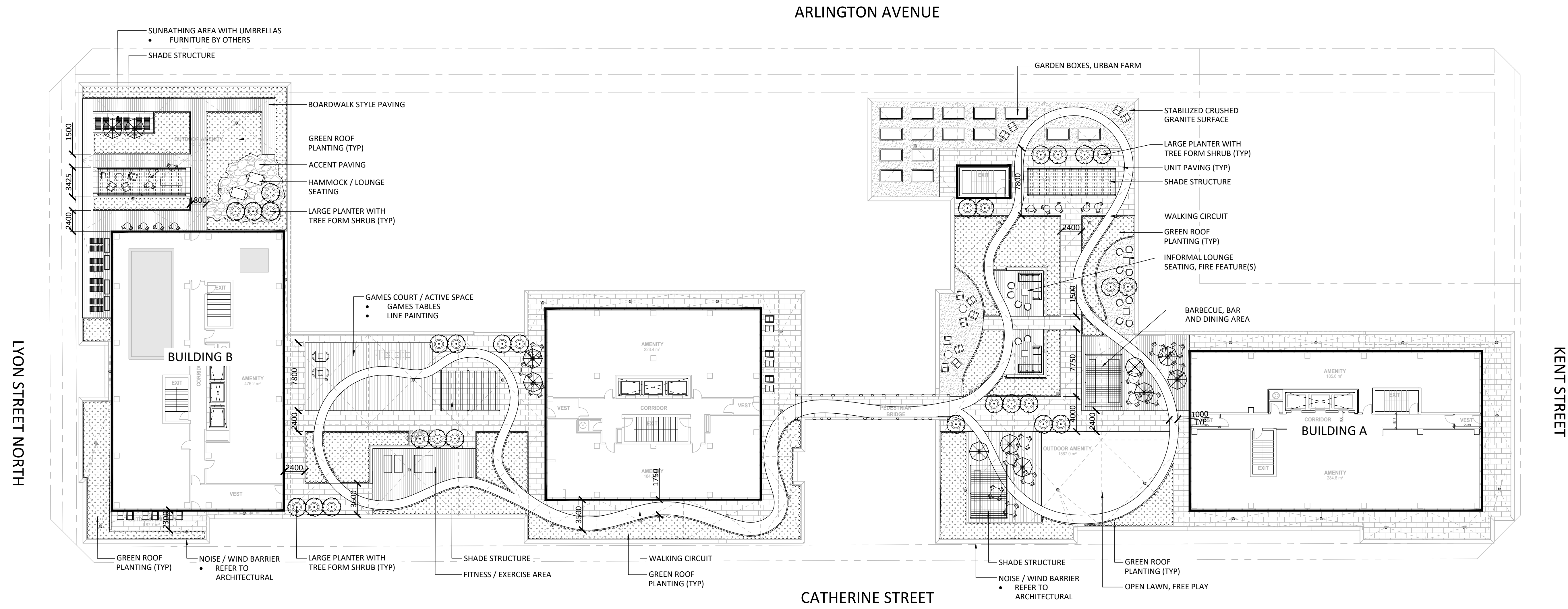

2	Issued for Site Plan Approval	23-05-15
1	Issued for Coordination	23-05-08
No.	Description	Date

Revision City Approval Stamp

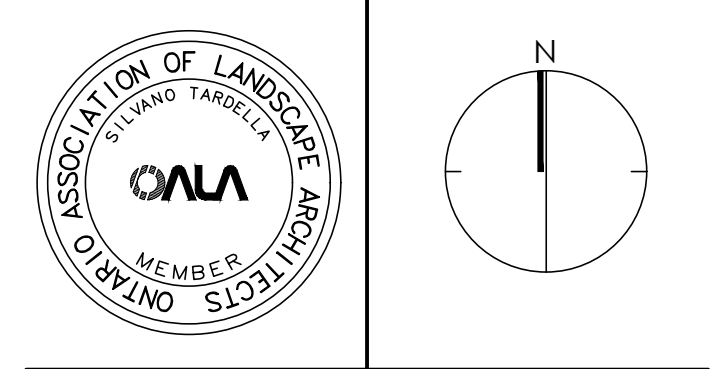

**NAK**  
design strategies  
1285 Wellington St. W. OTTAWA, ON K1N 6B3 CANADA  
T 613.237.2345 F 613.237.4423 [NAKDESIGNSTRATEGIES.COM](http://NAKDESIGNSTRATEGIES.COM)  
Project

265 CATHERINE STREET  
OTTAWA, ONTARIO

Title		LANDSCAPE PLAN ROOF TERRACES
Date	2023-02-03	Sheet
Scale	1:250	<b>L4.0</b>
Drawn	AM	
Checked	SC	
Job No.	23-015	



Contractor shall check all dimensions on the work and report any discrepancy to the Landscape Architect before proceeding. All drawings and specifications are the property of the Landscape Architect and must be returned at the completion of the work. This drawing is not to be used for construction until signed by the Landscape Architect.

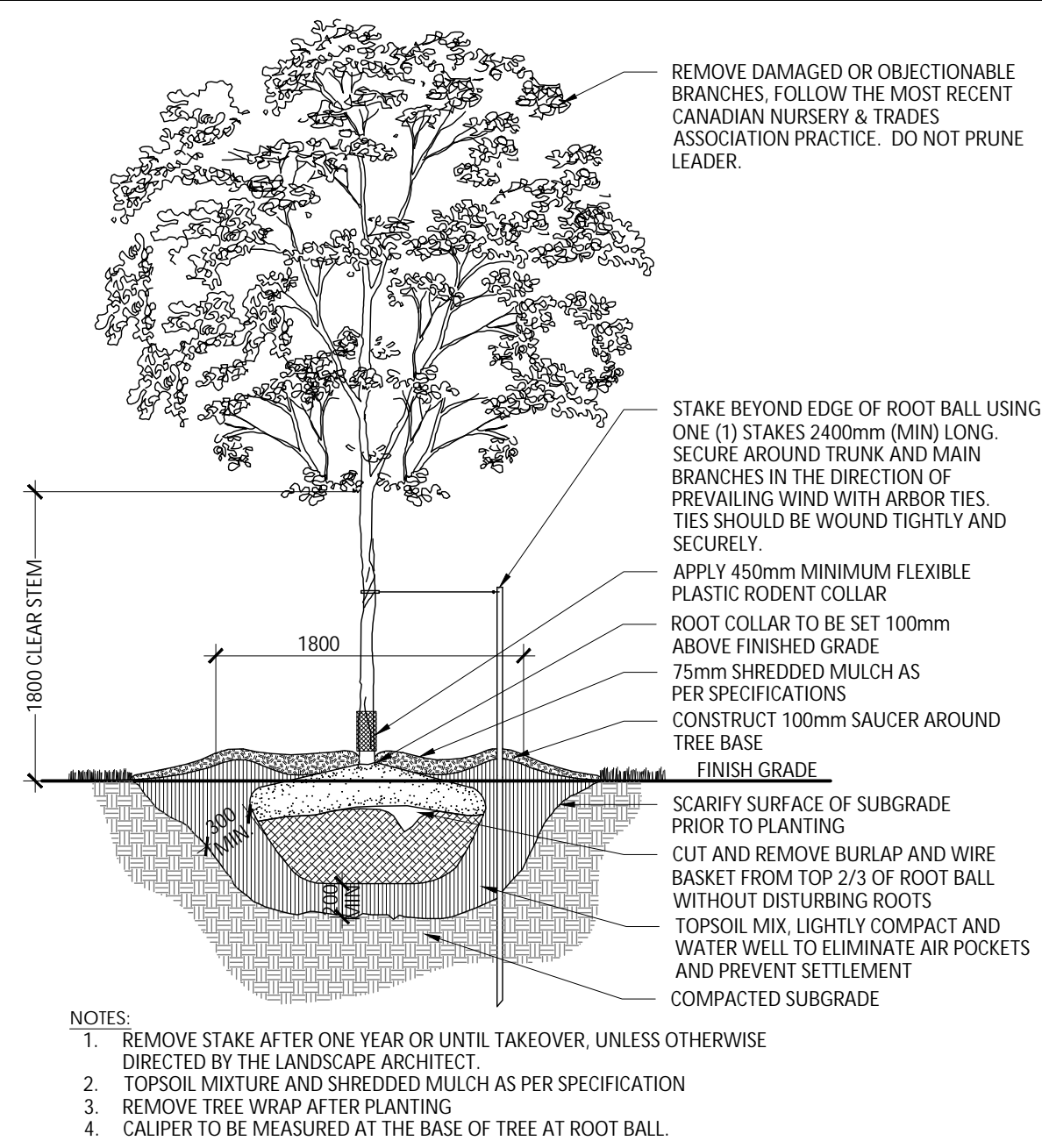

- NOTES:
1. REMOVE STAKE AFTER ONE YEAR OR UNTIL TAKEOVER, UNLESS OTHERWISE DIRECTED BY THE LANDSCAPE ARCHITECT.
  2. TOPSOIL MIXTURE AND SHREDDED MULCH AS PER SPECIFICATION
  3. REMOVE TREE WRAP AFTER PLANTING
  4. CALIPER TO BE MEASURED AT THE BASE OF TREE AT ROOT BALL.

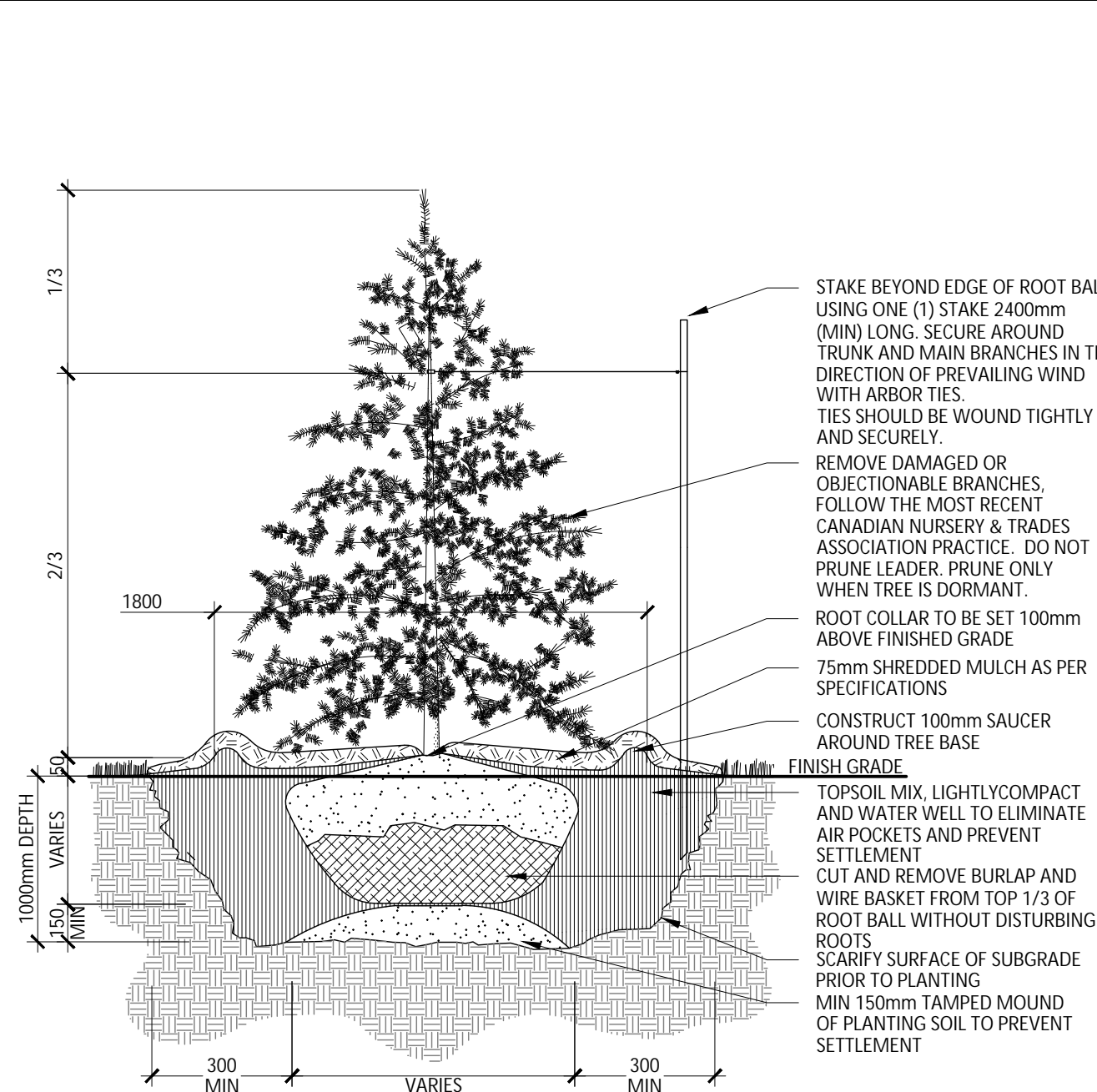

- NOTES:
1. REMOVE STAKE AFTER ONE YEAR OR UNTIL TAKEOVER UNLESS OTHERWISE DIRECTED BY THE LANDSCAPE ARCHITECT.
  2. TOPSOIL MIXTURE AND SHREDDED MULCH AS PER SPECIFICATION

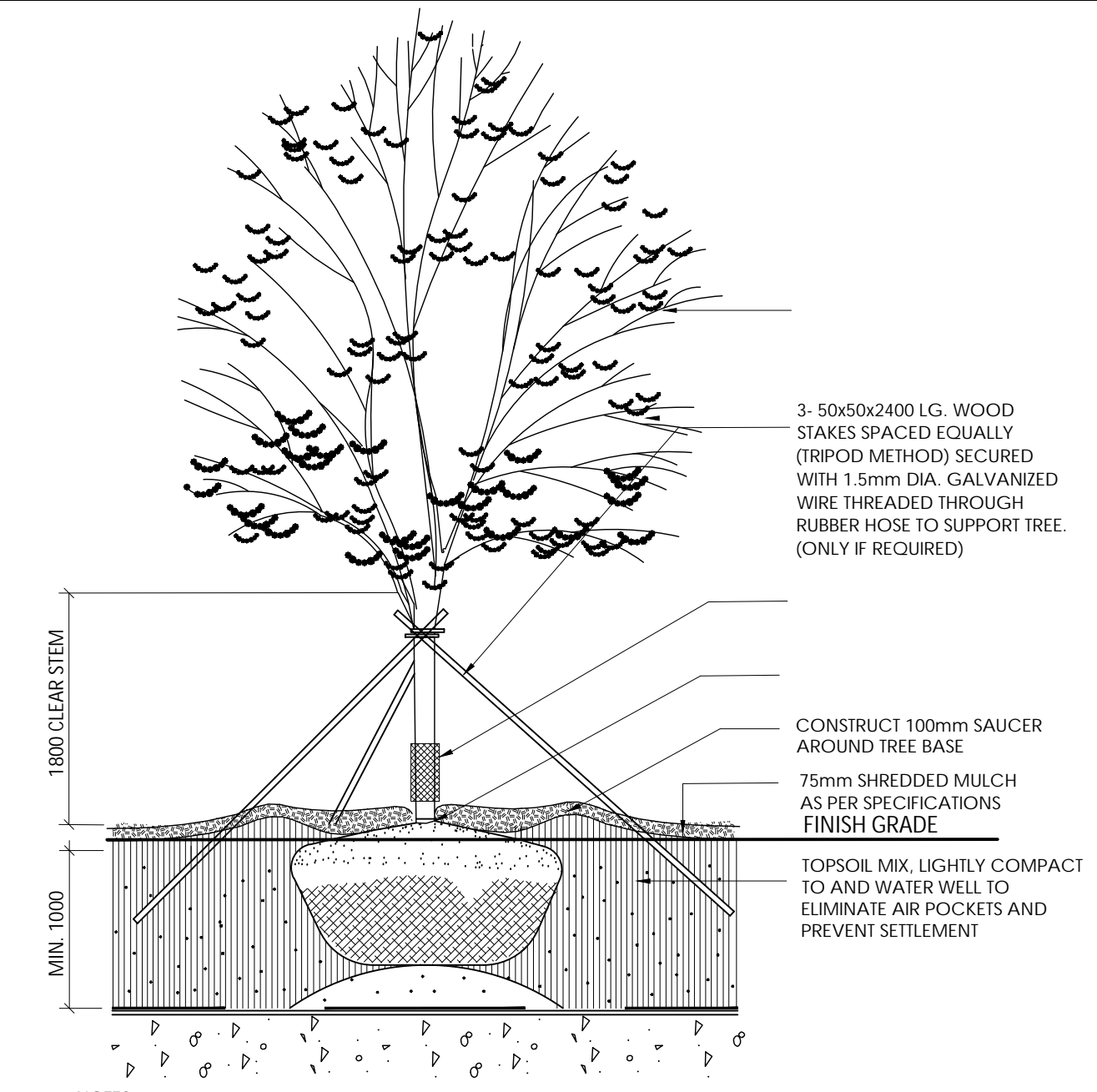

- NOTES:
1. REMOVE STAKES AND RODENT GUARD AFTER ONE YEAR OR UNTIL TAKEOVER, UNLESS OTHERWISE DIRECTED BY THE LANDSCAPE ARCHITECT.
  2. TOPSOIL MIXTURE AND SHREDDED MULCH AS PER SPECIFICATION
  3. REMOVE TREE WRAP AFTER PLANTING
  4. CALIPER TO BE MEASURED AT THE BASE OF TREE AT ROOT BALL.

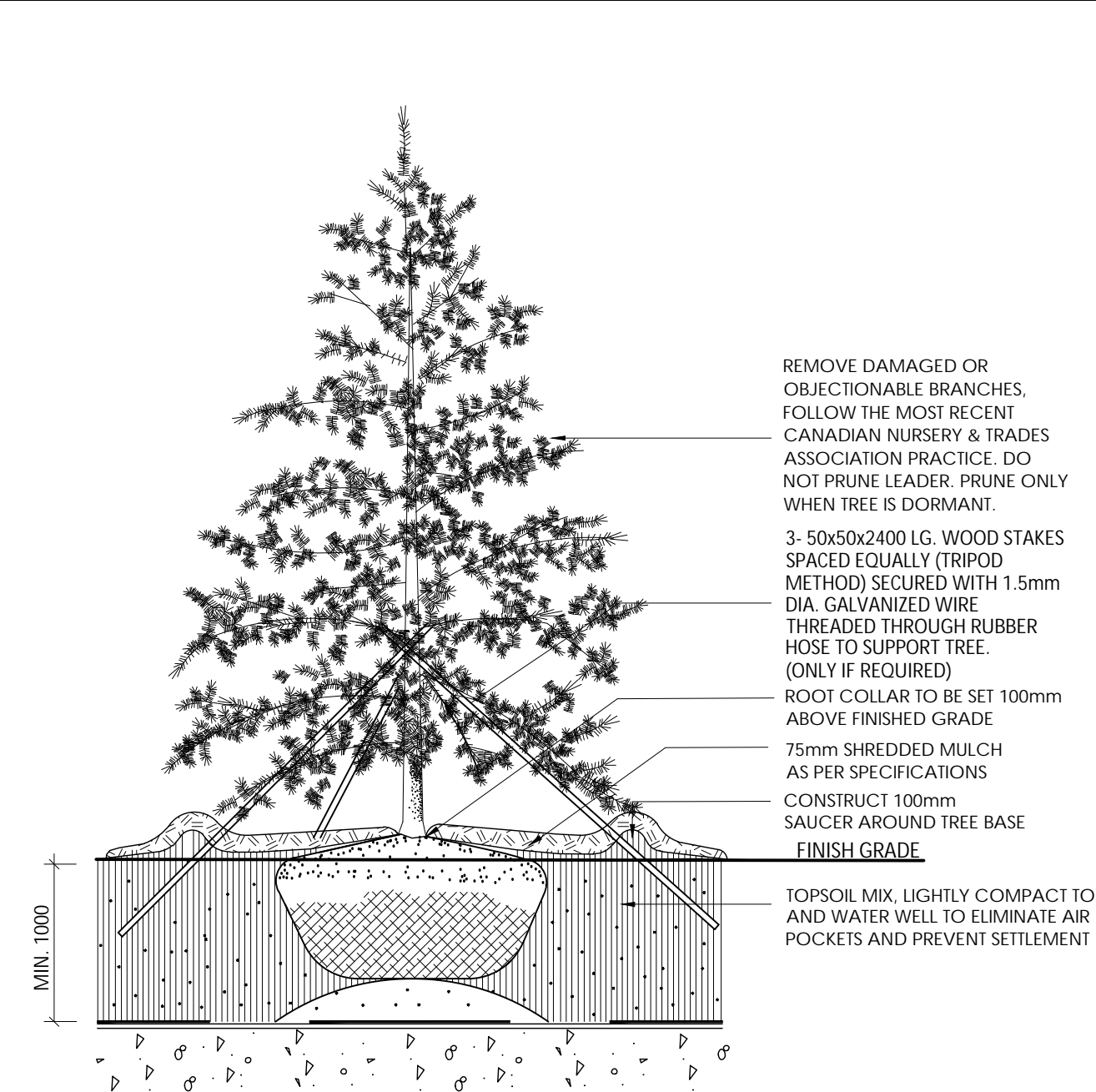

- NOTES:
1. REMOVE STAKES AFTER ONE YEAR OR UNTIL TAKEOVER UNLESS OTHERWISE DIRECTED BY THE LANDSCAPE ARCHITECT
  2. TOPSOIL MIXTURE AND SHREDDED MULCH AS PER SPECIFICATION.

DECIDUOUS TREE PLANTING (ONE STAKE W/ARBOR TIES)  
N.T.S.

CONIFEROUS TREE PLANTING (ONE STAKE W/ARBOR TIES)  
N.T.S.

DECIDUOUS TREE PLANTING - ON SLAB  
N.T.S.

CONIFEROUS TREE PLANTING - ON SLAB  
N.T.S.

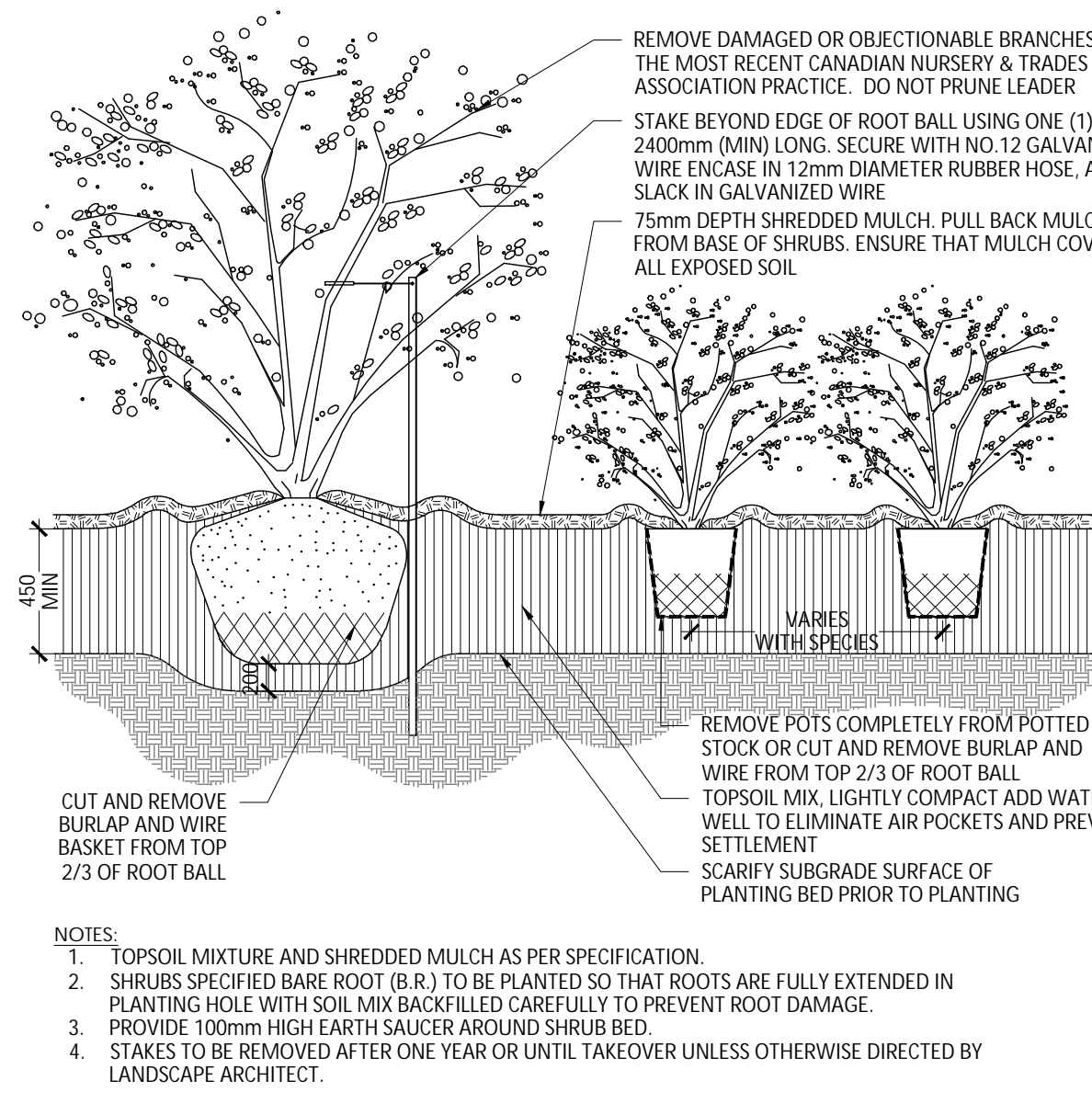

- NOTES:
1. TOPSOIL MIXTURE AND SHREDDED MULCH AS PER SPECIFICATION.
  2. SHRUBS SPECIFIED BARE ROOT (B.R.) TO BE PLANTED SO THAT ROOTS ARE FULLY EXTENDED IN PLANTING HOLE WITH SOIL MIX BACKFILLED CAREFULLY TO PREVENT ROOT DAMAGE.
  3. PROVIDE 100mm HIGH EARTH SAUCER AROUND SHRUB BED.
  4. STAKES TO BE REMOVED AFTER ONE YEAR OR UNTIL TAKEOVER UNLESS OTHERWISE DIRECTED BY LANDSCAPE ARCHITECT.

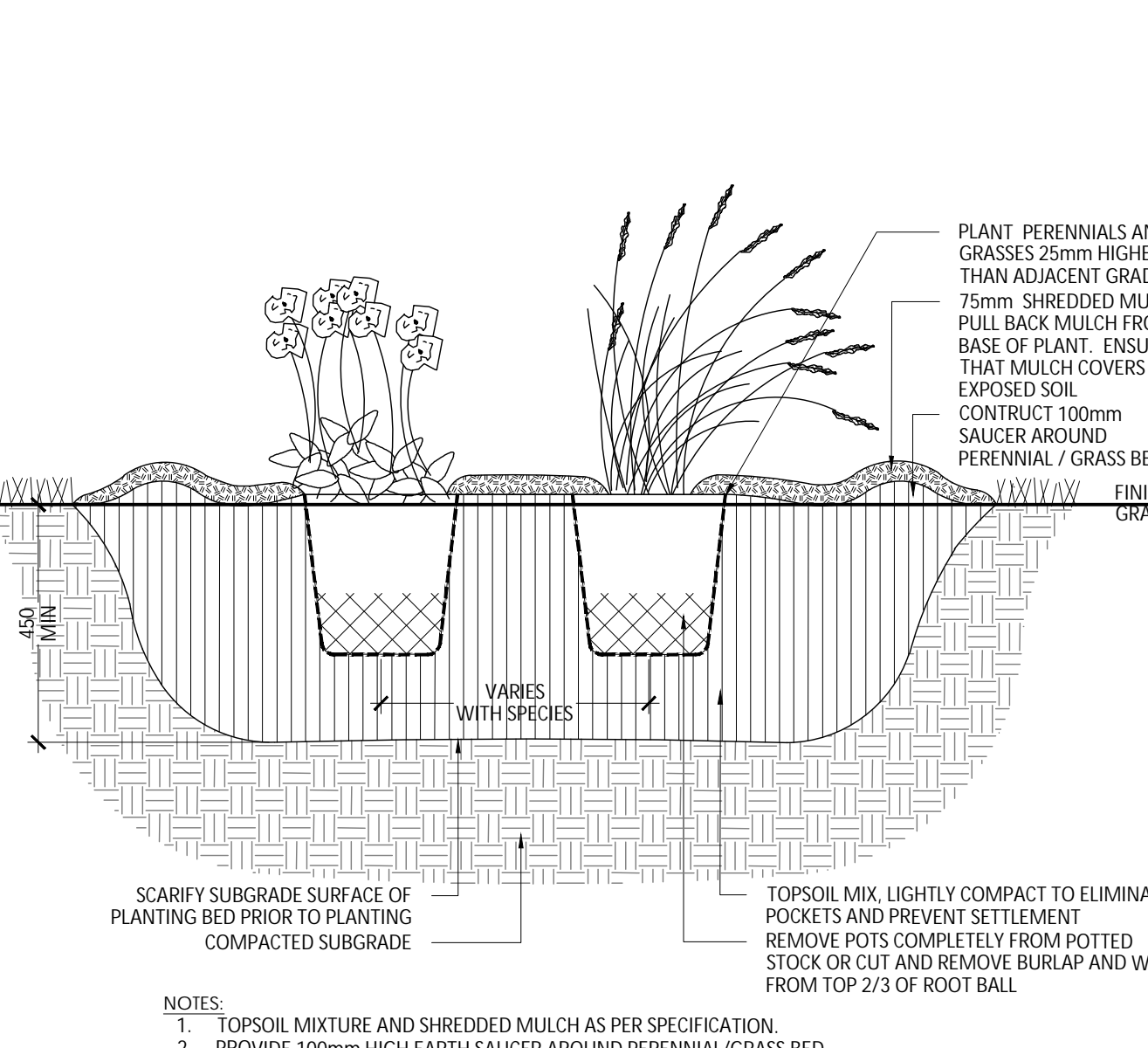

- NOTES:
1. TOPSOIL MIXTURE AND SHREDDED MULCH AS PER SPECIFICATION.
  2. PROVIDE 100mm HIGH EARTH SAUCER AROUND PERENNIAL/GRASS BED.

SHRUB BED PLANTING  
N.T.S.

PERENNIAL AND ORNAMENTAL GRASS PLANTING  
N.T.S.

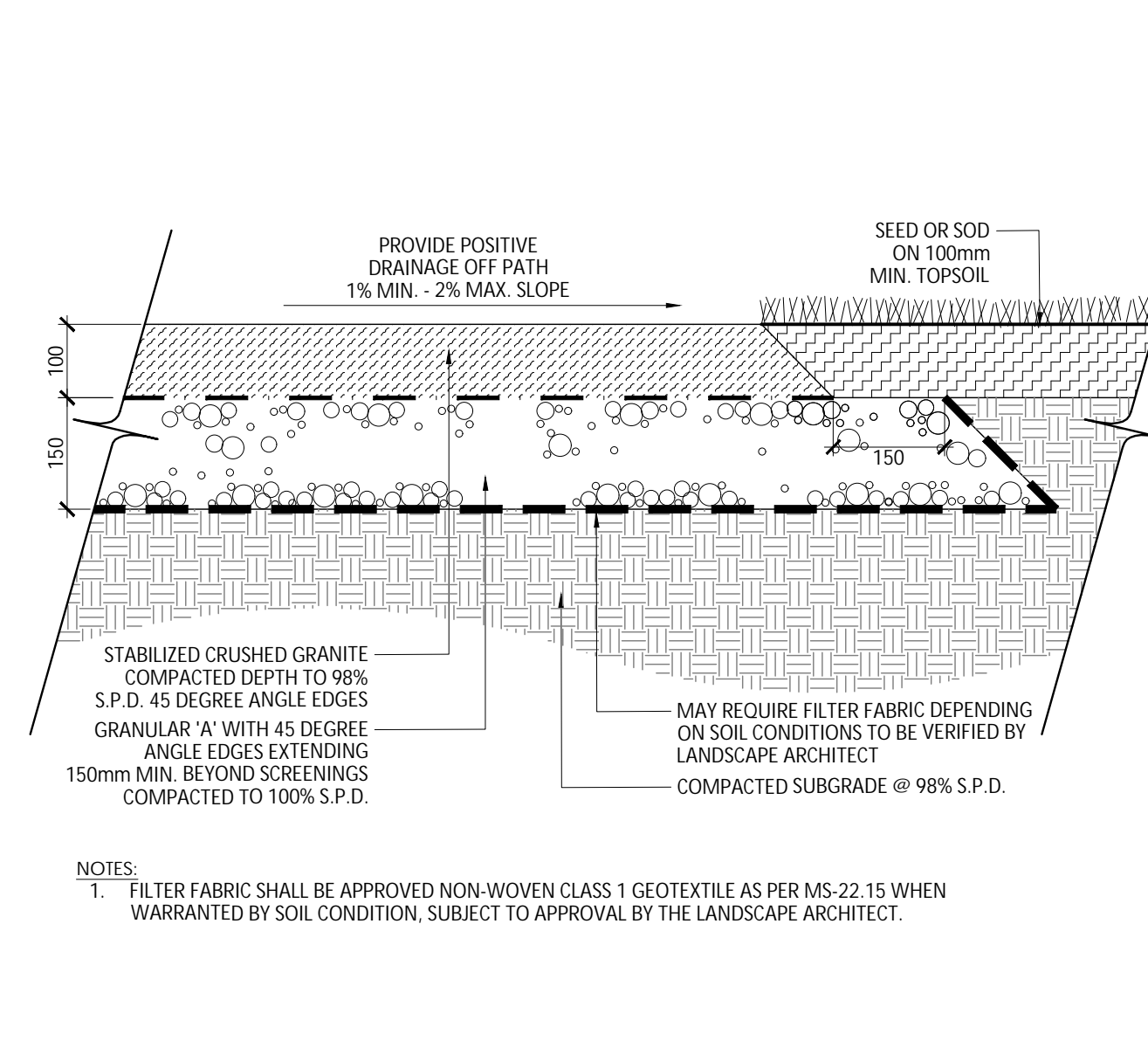

- NOTES:
1. FILTER FABRIC SHALL BE APPROVED NON-WOVEN CLASS 1 GEOTEXTILE AS PER MS-22.15 WHEN WARRANTED BY SOIL CONDITION, SUBJECT TO APPROVAL BY THE LANDSCAPE ARCHITECT.

1 CRUSHED GRANITE PATH  
N.T.S.

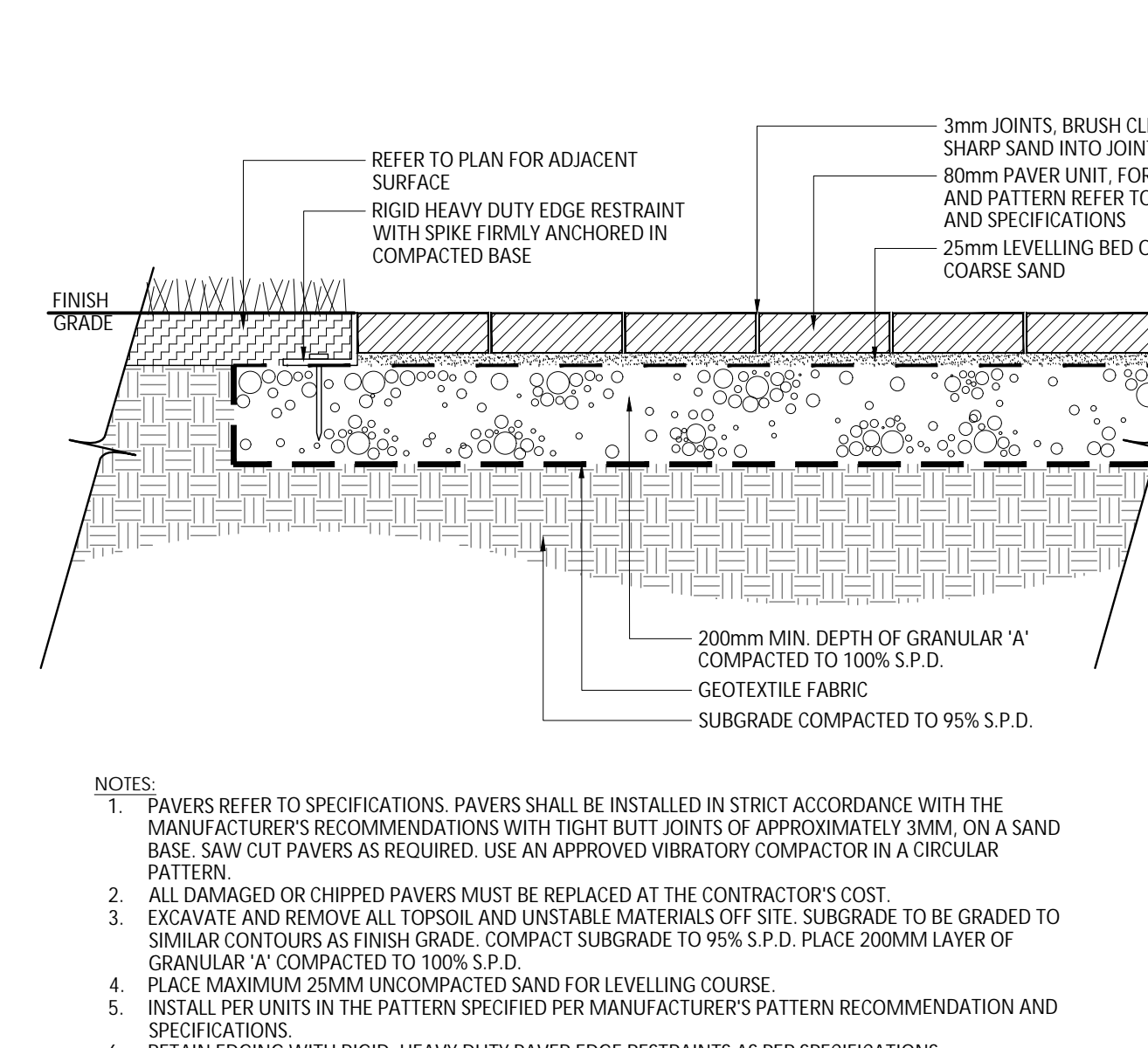

- NOTES:
1. PAVERS REFER TO SPECIFICATIONS. PAVERS SHALL BE INSTALLED IN STRICT ACCORDANCE WITH THE MANUFACTURER'S RECOMMENDATIONS WITH TIGHT BUTT JOINTS OF APPROXIMATELY 3MM, ON A SAND BASE. SAW CUT PAVERS AS REQUIRED. USE AN APPROVED VIBRATORY COMPACTOR IN A CIRCULAR PATTERN.
  2. ALL DAMAGED OR CHIPPED PAVERS MUST BE REPLACED AT THE CONTRACTOR'S COST.
  3. EXCAVATE AND REMOVE ALL TOPSOIL AND UNSTABLE MATERIALS OFF SITE. SUBGRADE TO BE GRADED TO SIMILAR CONTOURS AS FINISH GRADE. COMPACT SUBGRADE TO 95% S.P.D. PLACE 200MM LAYER OF GRANULAR 'A' COMPACTED TO 100% S.P.D.
  4. PLACE MAXIMUM 25MM UNCOMPACTED SAND FOR LEVELLING COURSE.
  5. INSTALL PER UNITS IN THE PATTERN AS SPECIFIED PER MANUFACTURER'S PATTERN RECOMMENDATION AND SPECIFICATIONS.
  6. RETAIN EDGING WITH RIGID, HEAVY DUTY PAVEMENT EDGE RESTRAINTS AS PER SPECIFICATIONS.
  7. ALL MEASUREMENTS ARE IN MILLIMETRES UNLESS NOTED OTHERWISE.

2 VEHICULAR UNIT PAVING  
N.T.S.

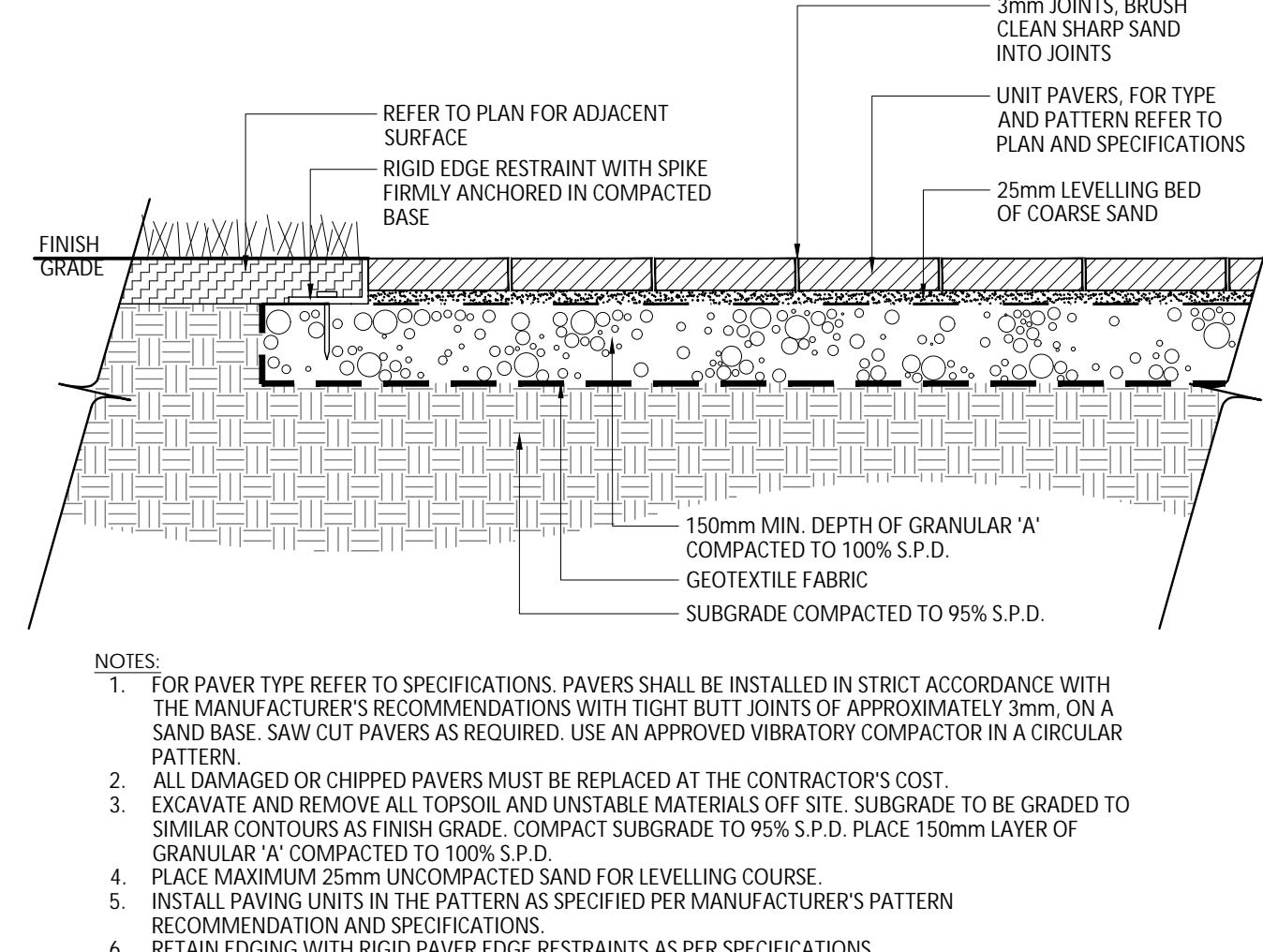

- NOTES:
1. FOR PAVEMENT TYPE REFER TO SPECIFICATIONS. PAVERS SHALL BE INSTALLED IN STRICT ACCORDANCE WITH THE MANUFACTURER'S RECOMMENDATIONS WITH TIGHT BUTT JOINTS OF APPROXIMATELY 3MM, ON A SAND BASE. SAW CUT PAVERS AS REQUIRED. USE AN APPROVED VIBRATORY COMPACTOR IN A CIRCULAR PATTERN.
  2. ALL DAMAGED OR CHIPPED PAVERS MUST BE REPLACED AT THE CONTRACTOR'S COST.
  3. EXCAVATE AND REMOVE ALL TOPSOIL AND UNSTABLE MATERIALS OFF SITE. SUBGRADE TO BE GRADED TO SIMILAR CONTOURS AS FINISH GRADE. COMPACT SUBGRADE TO 95% S.P.D. PLACE 150MM LAYER OF GRANULAR 'A' COMPACTED TO 100% S.P.D.
  4. PLACE MAXIMUM 25MM UNCOMPACTED SAND FOR LEVELLING COURSE.
  5. INSTALL PAVING UNITS IN THE PATTERN AS SPECIFIED PER MANUFACTURER'S PATTERN RECOMMENDATION AND SPECIFICATIONS.
  6. RETAIN EDGING WITH RIGID PAVEMENT EDGE RESTRAINTS AS PER SPECIFICATIONS.

3 PEDESTRIAN UNIT PAVING  
N.T.S.

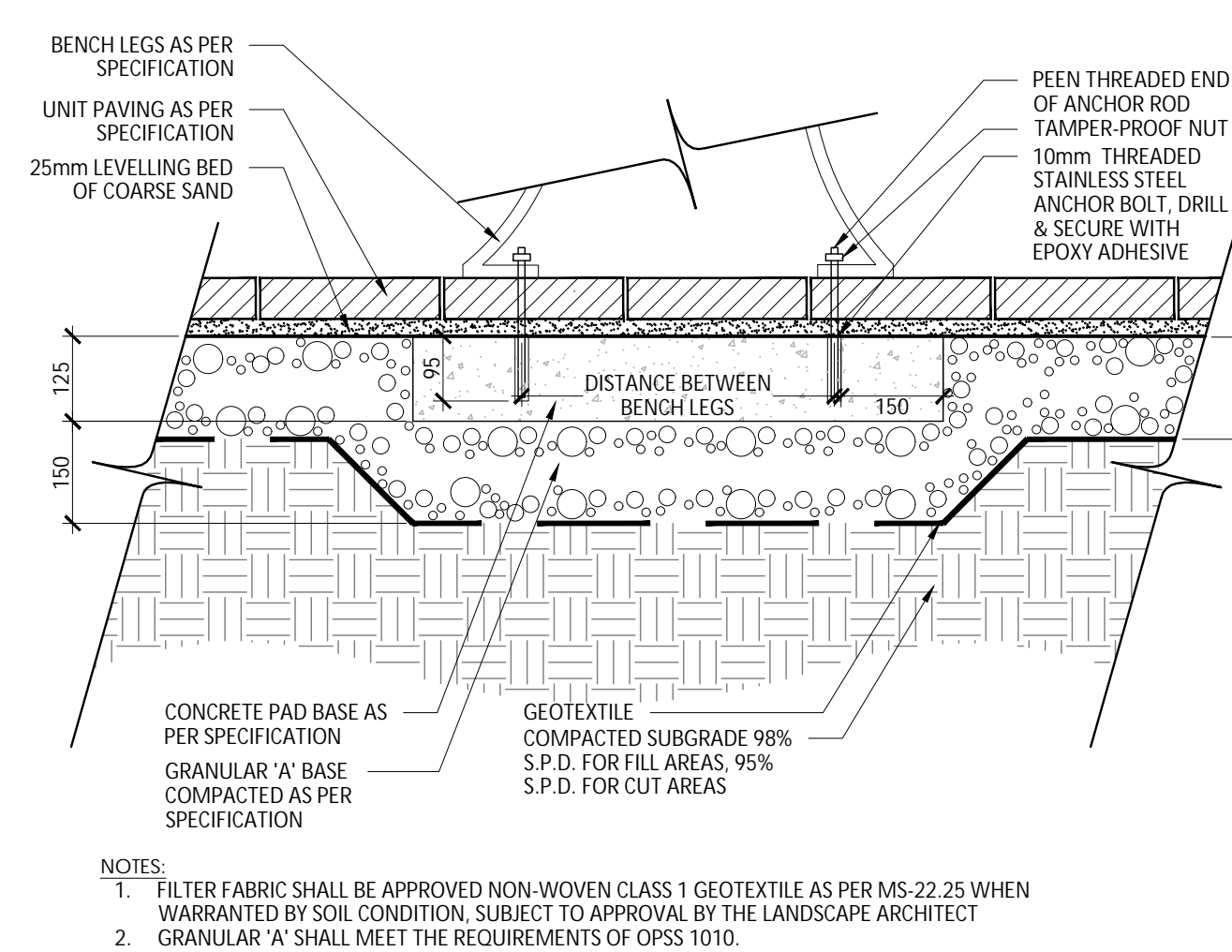

- NOTES:
1. FILTER FABRIC SHALL BE APPROVED NON-WOVEN CLASS 1 GEOTEXTILE AS PER MS-22.15 WHEN WARRANTED BY SOIL CONDITION, SUBJECT TO APPROVAL BY THE LANDSCAPE ARCHITECT
  2. GRANULAR 'A' SHALL MEET THE REQUIREMENTS OF OPSS 1010.

4 BENCH MOUNTING ON UNIT PAVING WITH CONCRETE PAD  
N.T.S.

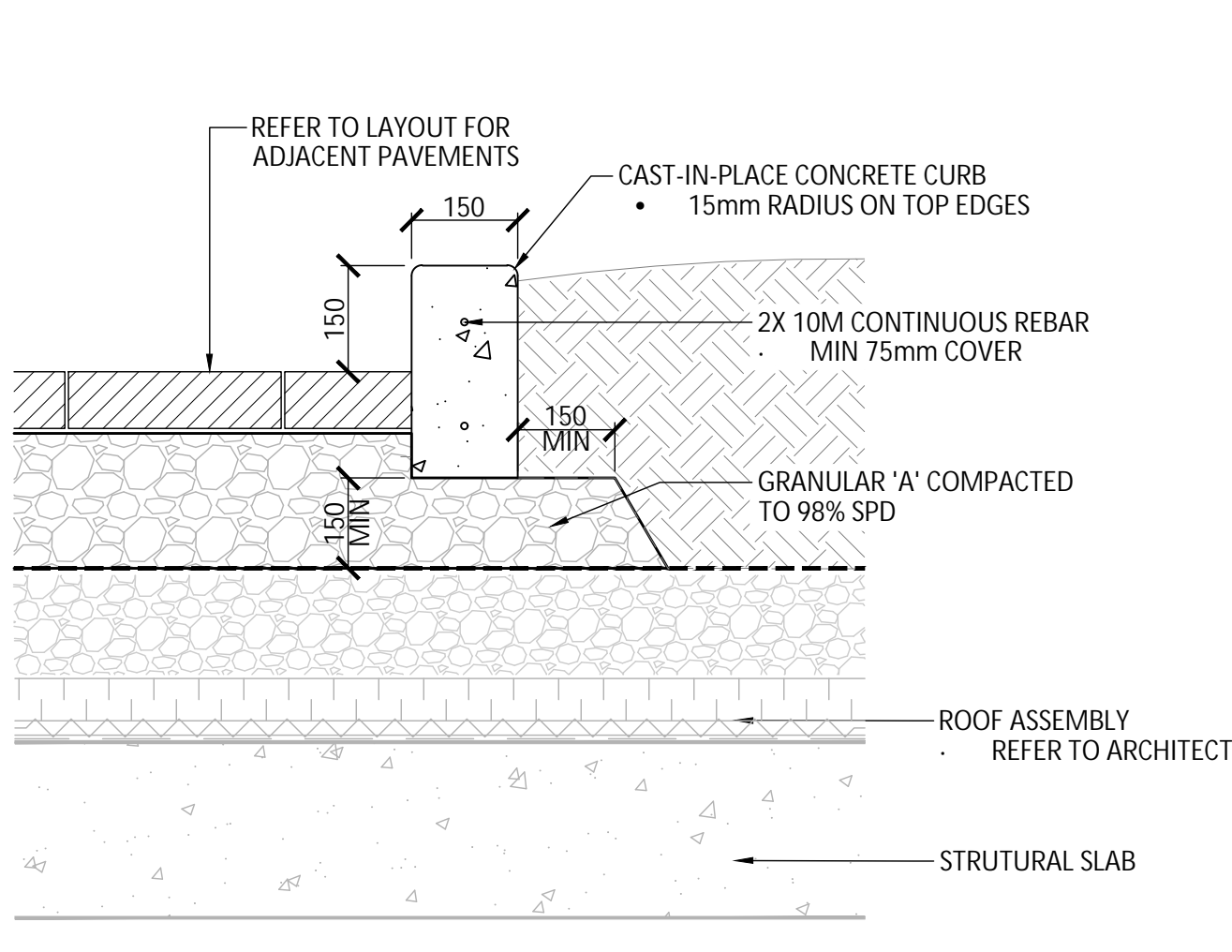

- NOTES:
1. FILTER FABRIC SHALL BE APPROVED NON-WOVEN CLASS 1 GEOTEXTILE AS PER MS-22.15 WHEN WARRANTED BY SOIL CONDITION, SUBJECT TO APPROVAL BY THE LANDSCAPE ARCHITECT
  2. GRANULAR 'A' SHALL MEET THE REQUIREMENTS OF OPSS 1010.

5 CONCRETE PLANTER CURB  
N.T.S.

No.	Description	Date
1	Issued for Site Plan Approval	23-05-15
Revision		
City Approval Stamp		

**NAK**  
design strategies  
1285 WELLINGTON STREET, OTTAWA, ON K1Y 3A8 CANADA  
613.237.2345  
NAKDESIGNSTRATEGIES.COM  
Project

256 CATHERINE STREET  
OTTAWA ONTARIO

Date	2023-02-03	Sheet
Scale	N.T.S.	L5.0
Drawn		
Checked		
Job No.	23-015	