

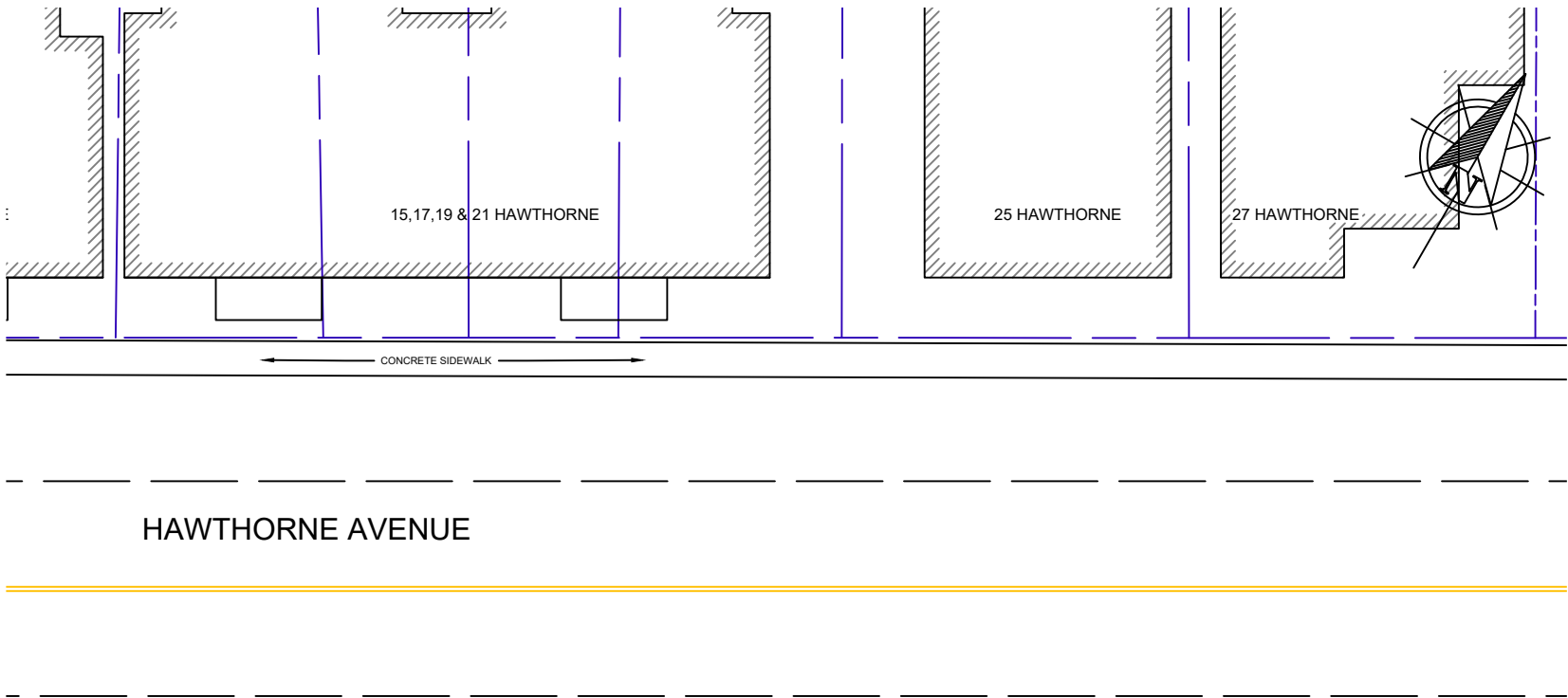

LOCATION PLAN (SCALE N.T.S)



- LEGEND
- PROPERTY BOUNDARY
 - SUBJECT SITE
 - BUILDINGS TO BE DEMOLISHED
 - EXISTING FENCES

NOTES:
SITE LOCATION MAP FROM CITY OF
OTTAWA GEO OTTAWA MAP 2017 AIR
PHOTO

LEGAL DESCRIPTION:
PIN 041260014
PLAN 220 PT LOTS 5 & 6

Scale 1:250
0 2 4 6 8
(Approx. When plotted 11x17)



CM3 ENVIRONMENTAL
5710 AKINS ROAD, OTTAWA, ON
K2S 1B8

MARILYN STEINBERG

CURRENT SITE LAYOUT
FOR
24 HAWTHORNE AVENUE
OTTAWA, ONTARIO

Project:	BDC1148	Drawn By:	KS
Date:	OCT 2019	Reviewed By:	BC
Scale:	1:250	Figure:	1

THIS DRAWING IS FOR INFORMATION PURPOSES ONLY. NOT ALL STRUCTURES,
UTILITIES OR SITE FEATURES ARE SHOWN. THIS DRAWING IS THE PROPERTY OF CM3
ENVIRONMENTAL LOANED TO THE RECIPIENT WHO AGREES THAT IT SHALL NOT BE
GIVEN OUT, COPIED OR DUPLICATED FOR THE USE OF ANOTHER BUT SHALL BE USED
ONLY BY THE RECIPIENT FOR THE PURPOSE TO WHICH IT REFERS.