

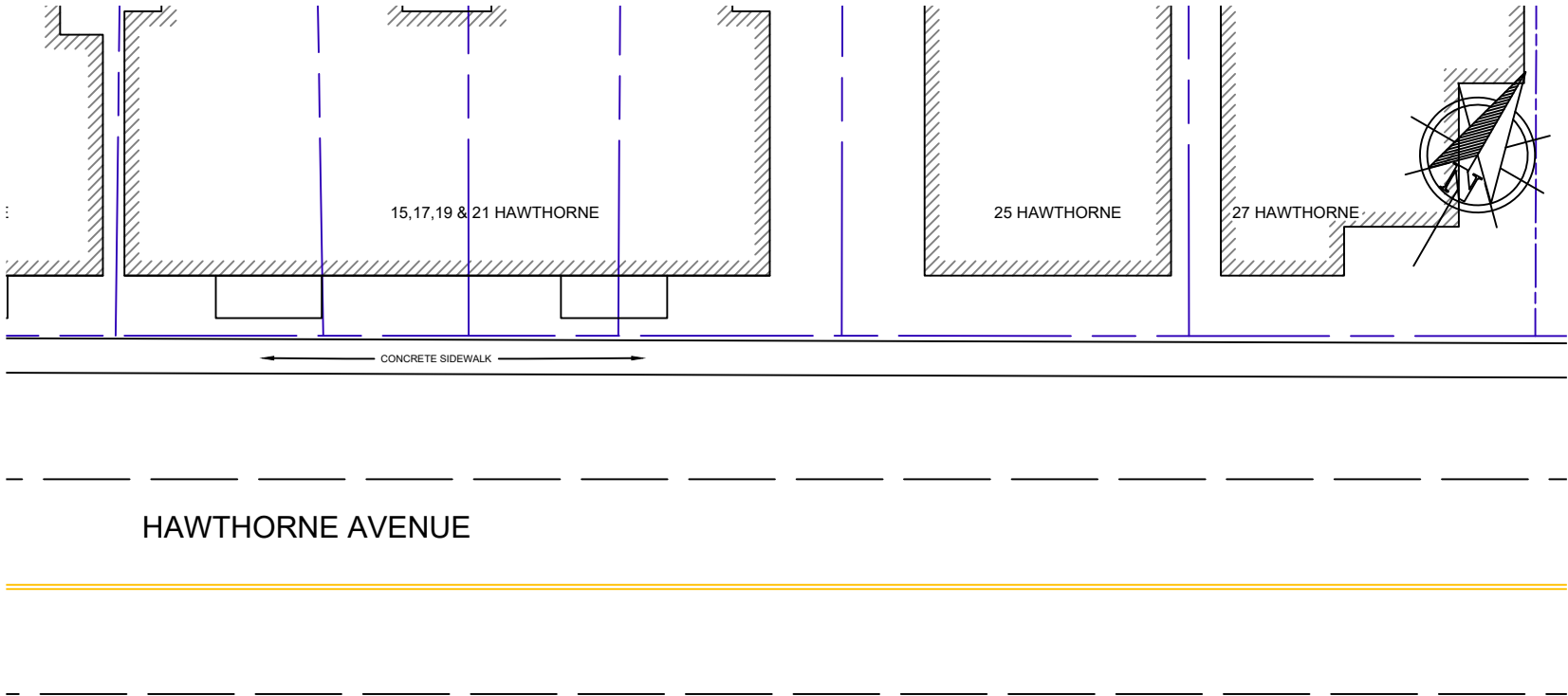

LOCATION PLAN (SCALE N.T.S)



- LEGEND**
- PROPERTY BOUNDARY
  - SUBJECT SITE
  - BUILDINGS TO BE DEMOLISHED
  - EXISTING FENCES

**NOTES:**  
SITE LOCATION MAP FROM CITY OF OTTAWA GEO OTTAWA MAP 2017 AIR PHOTO

**LEGAL DESCRIPTION:**  
PIN 041260013  
PLAN 220 LOT 4 W4 PT LOT 5

Scale 1:250  
0 2 4 6 8  
(Approx. When plotted 11x17)



CM3 ENVIRONMENTAL  
5710 AKINS ROAD, OTTAWA, ON  
K2S 1B8

MARILYN STEINBERG

CURRENT SITE LAYOUT  
FOR  
20 & 22 HAWTHORNE AVENUE  
OTTAWA, ONTARIO

Project:	BDC1148	Drawn By:	KS
Date:	OCT 2019	Reviewed By:	BC
Scale:	1:250	Figure:	1

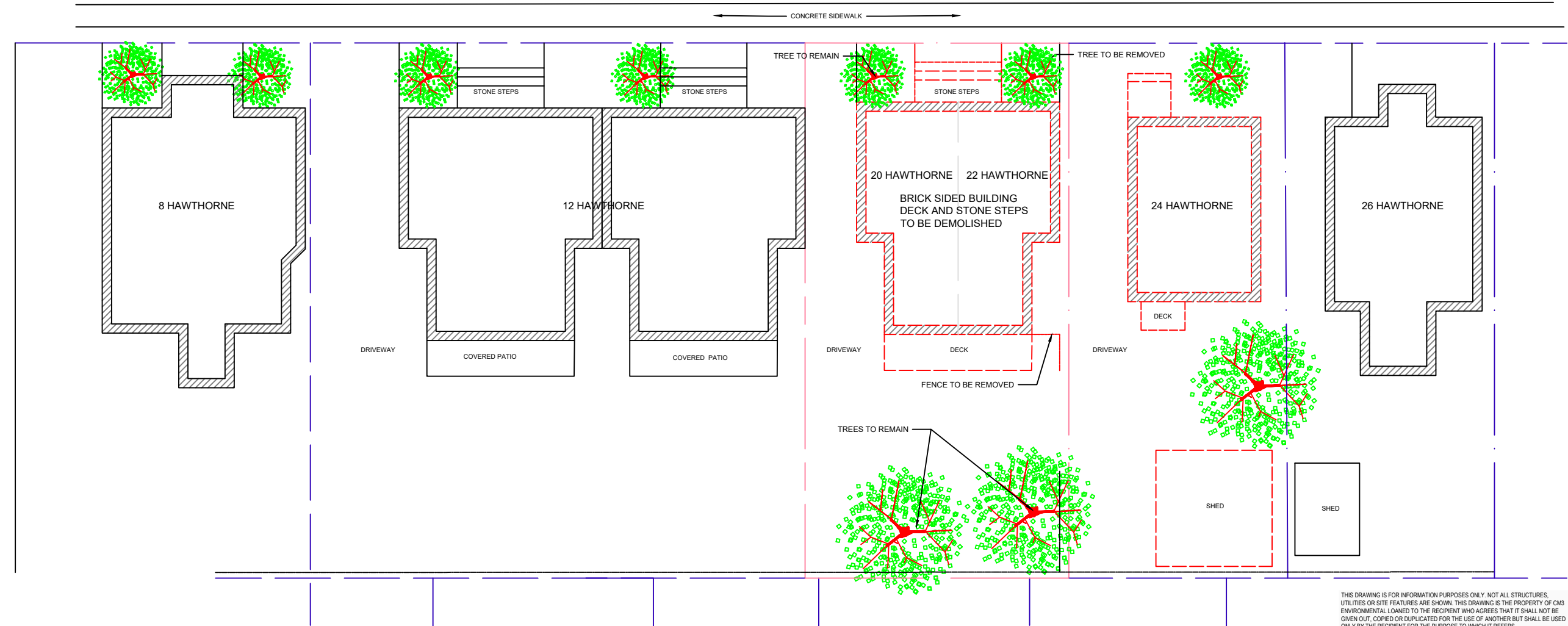

THIS DRAWING IS FOR INFORMATION PURPOSES ONLY. NOT ALL STRUCTURES, UTILITIES OR SITE FEATURES ARE SHOWN. THIS DRAWING IS THE PROPERTY OF CM3 ENVIRONMENTAL LOANED TO THE RECIPIENT WHO AGREES THAT IT SHALL NOT BE GIVEN OUT, COPIED OR DUPLICATED FOR THE USE OF ANOTHER BUT SHALL BE USED ONLY BY THE RECIPIENT FOR THE PURPOSE TO WHICH IT REFERS.