

NO.	REVISION	DATE
1	ISSUED FOR SITE PLAN APPROVAL	FEB. 10/09
2	RE-ISSUED FOR SITE PLAN APPROVAL	SEPT. 15/09
5	ISSUED FOR REVIEW	JAN. 27/10
7	ISSUED FOR SITE PLAN MYLAR	JUNE 08/10

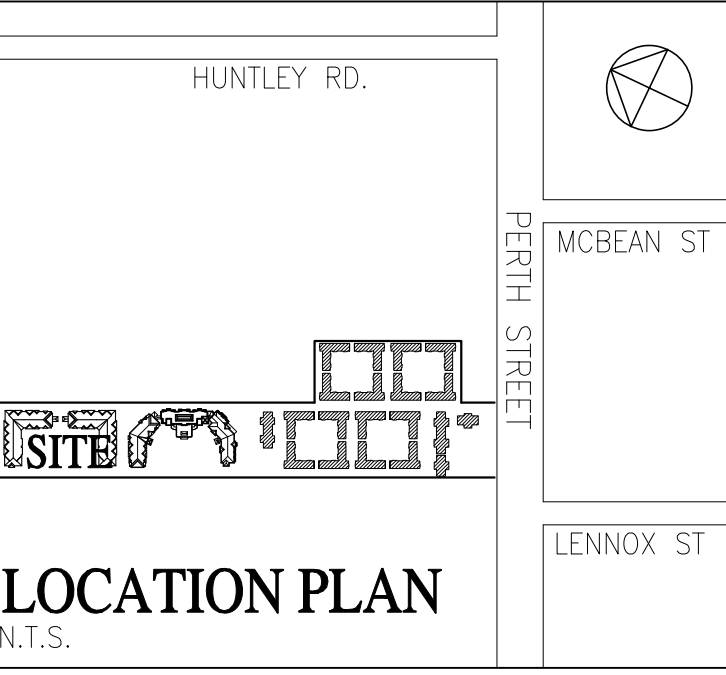

CONTACTS:
OWNER/DEVELOPER: HYDE PARK RESIDENCES INC.
 ADDRESS: 1 NEELY STREET, R9F1, DUNROBIN, ONT. M0A 1T0
 PHONE: (613) 838-2992 (FAX) (613) 838-2099
 EMAIL: hyde.steve@hydeparkresidences.com

ARCHITECT: RALPH VANDENBERG ARCHITECT INC.
 ADDRESS: 160 FLAMBROUGH WAY, KANATA, ONT. K2K 3H9
 PHONE: (613) 287-0144 (FAX) (613) 271-8609
 EMAIL: mail@vandenbergarchitect.com

LANDSCAPE ARCHITECT: GLA Landscape Architect
 ADDRESS: 50 CAMERLOT DR., NEPEAN, ONTARIO K2C 5X8
 PHONE: (613) 852-1343 (FAX) (613) 692-4672
 EMAIL: gj@glalandscape.com

CIVIL ENGINEERS: DAVID MCMANUS ENGINEERING
 ADDRESS: 400-30 CAMELOT DR., NEPEAN, ONT. K2C 5X8
 PHONE: (613) 225-1929 (FAX) (613) 225-7330
 EMAIL: kcmccorcoran@dmel.on.ca

SURVEYORS: FARLEY, SMITH & DENIS SURVEYING LTD.
 ADDRESS: 180 COLUMBIE ROAD, NEPEAN, ONTARIO K2E 7J5
 PHONE: TEL (613) 727-8226 FAX (613) 727-1823
 NOTE: SURVEY INFORMATION SHOWN BASED ON WORK BY: FARLEY, SMITH & DENIS SURVEYING LTD.
 ONTARIO LAND SURVEYORS
 REFER TO SURVEY DRAWING FOR PRECISE REFERENCE

ELECTRICAL/MECHANICAL ENGINEERS: MCKEE ENGINEERING
 ADDRESS: 1785 WOODWARD DR., OTTAWA, ONT. K2C 0P9
 PHONE: (613) 723-9585 (FAX) (613) 2) 723-9584
 EMAIL: chris.fraley@mckeeottawa.ca

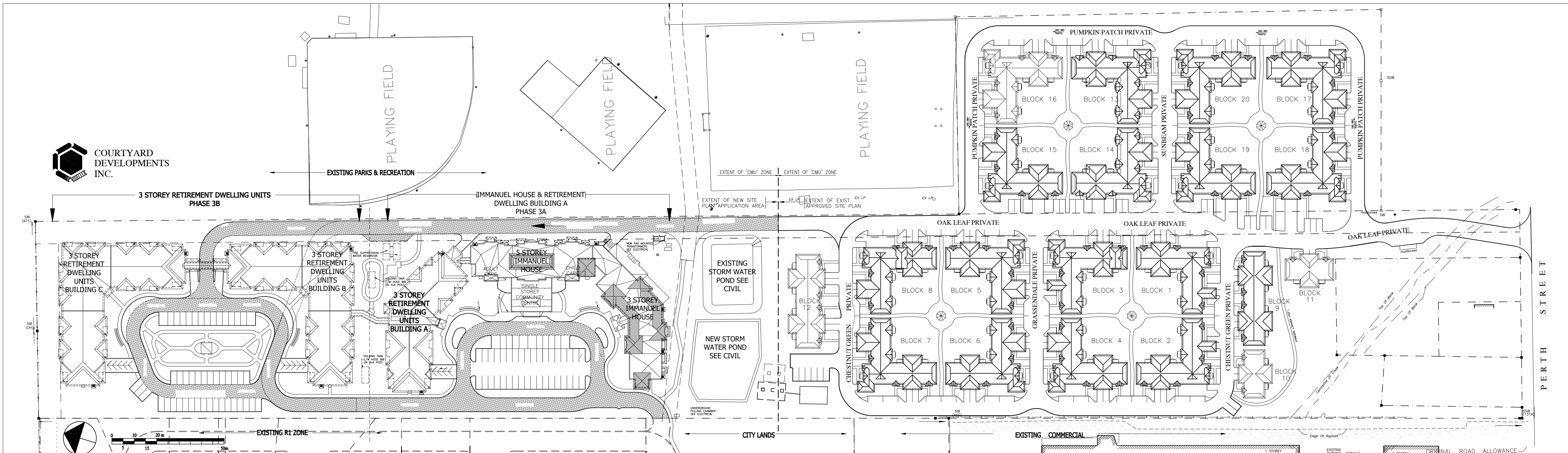

1 KEY PLAN
 A100.3 SCALE: 1:1000

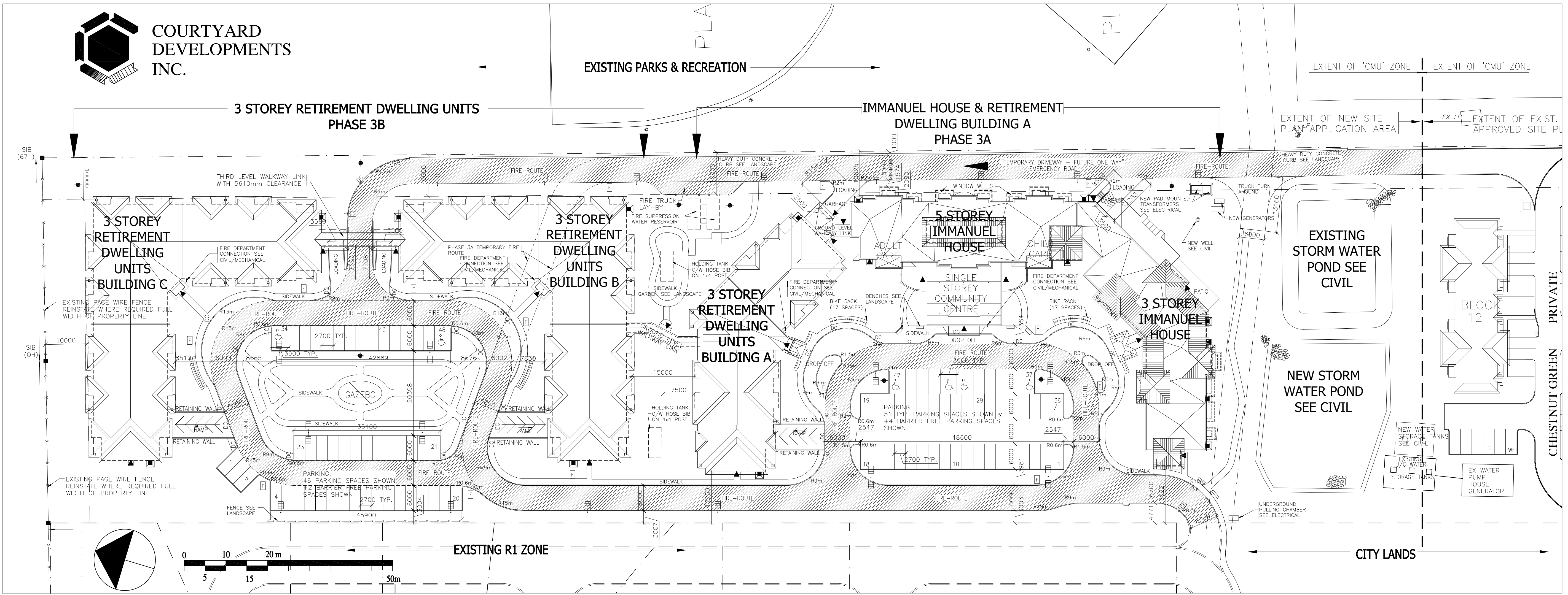

2 SITE PLAN
 A100 SCALE: 1:500

- PHASE 3A: IMMANUEL HOUSE**
- RESIDENTIAL CARE FACILITY UNITS: 17 (ON 3RD FLOOR) PARKING REQUIRED: 0.25 SPACES/UNIT 17 x 0.25 = 4.25 SPACES
 - RETIREMENT HOME UNITS: 88 PARKING REQUIRED: 0.25 SPACES/UNIT 88 x 0.25 = 22 SPACES
 - RETIREMENT HOME (PERSONAL SERVICES) LOWER LEVEL: HALL GALLERY (42m²) COUNSELLING (42m²) TOTAL AREA: 84m² PARKING REQUIRED: 1 SPACE PER 100m² 82m² / 100m² x 1 = 0.82 SPACES
 - DAY CARE (SENIORS & CHILDREN) GROUND FLOOR SENIORS (19m²) CHILDREN (100m²) TOTAL AREA: 119m² / 100m² x 2 = 3.9 SPACES
 - COMMUNITY CENTRE LOWER LEVEL: POOL/EXERCISE (390m²) MEDICAL FACILITY (350m²) GROUND FLOOR MULTI-PURPOSE SPACE (285m²) TOTAL AREA: 1025m² PARKING REQUIRED: 4 SPACES PER 100m² 1025m² / 100m² x 4 = 41 SPACES
- RETIREMENT DWELLING UNITS BUILDING A (3 STOREY)**
- UNITS: 33
 PARKING REQUIRED: 0.25 SPACES/UNIT 33 x 0.25 = 8.25
 UNDERGROUND PARKING PROVIDED: 27

- PHASE 3B: RETIREMENT DWELLING UNITS (3 STOREY)**
- RETIREMENT DWELLING UNITS BUILDING B (3 STOREY) UNITS: 53 PARKING REQUIRED: 0.25 SPACES/UNIT 53 x 0.25 = 13.25 UNDERGROUND PARKING PROVIDED: 49
 - RETIREMENT DWELLING UNITS BUILDING C (3 STOREY) UNITS: 53 PARKING REQUIRED: 0.25 SPACES/UNIT 53 x 0.25 = 13.25 UNDERGROUND PARKING PROVIDED: 49

PARKING SUMMARY:

PHASE 3A	PHASE 3B	TOTALS
RETIREMENT HOME	22 + 8.75 = 30.75	57.25
RETIREMENT HOME PERSONAL SERVICES	0.82	0.82
RESIDENTIAL CARE FACILITY	4.25	4.25
DAYCARE (SENIORS & CHILDREN)	3.9	3.9
COMMUNITY CENTRE	41	41
TOTAL REQUIRED	82.72	107.22
PARKING SHOWN		
ON SURFACE	51	97
BARRIER FREE ON SURFACE	4	6
BELOW GRADE	26	127
BARRIER FREE BELOW GRADE	2	2
TOTAL	82	146

LEGEND

- Barrier Free Parking Space
- Radius 9 METERS
- Building Entry/Access
- Depressed Curb
- Fire Route Sign
- Single Light Pole See Electrical
- Double Light Pole See Electrical

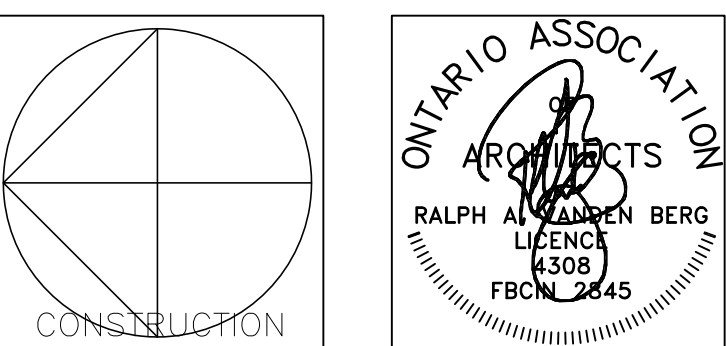

RALPH VANDENBERG ARCHITECTS
 A · R · C · H · I · T · E · C · T

TEL: (613) 287-0144 FAX: (613) 271-8609 E-MAIL: mail@vandenbergarchitect.com
 THE OLD STONE LODGE • 160 FLAMBROUGH WAY • KANATA • ONTARIO • K2K 3H9

PROJECT TITLE:
 HYDE PARK RESIDENCES - PHASE 3
 RICHMOND, ON

DRAWING TITLE:
 SITE PLAN

DESIGNED BY: RVA
 DRAWN BY: JK
 START DATE: ---
 SCALE: AS SHOWN
 PROJECT NO. 24040

A100.3